



PERMIT NO.
23738

CITY OF NEW BEDFORD
SEWER AND/OR STORM DRAIN PERMIT

DATE 8/26/05
EXP. 8/26/05

This certifies that permission is granted to

Property Owner Brian Dupras Address 28 Oakdale Ave. Marion MA Tel. 508-889-5713

To connect a sewer and/or storm drain located at Chaffee St. (ns) 570' Ex Acushnet Ave.

Assessor's Plot 130A Lot 804, to the sewer and/or storm drain in Chaffee St. Street

To be laid in accordance with the conditions in this application and the City of New Bedford ordinances.

TYPE OF USE: RESIDENTIAL COMMERCIAL INDUSTRIAL OTHER 330 GPD

If applicant other than actual property owner, attach Letter of Authorization from Property Owner.

Name..... Tel.....

Mailing Address.....

The Bonded Contractor/Drain Layer authorized to perform this work is:

Name..... Address..... Tel.....

Type of Pipe Required: PRC - 2" Sch 21

PERMIT EXPIRES ONE YEAR AFTER DATE OF ISSUE

- Requires separate connections for sewage and storm drain where applicable. Storm water cannot be discharged to a sanitary sewer.
 - All work must be inspected and approved by a D.P.I. inspector before backfilling.
 - If this connection is to be part of a private service shared jointly with other building owners, attach copy of Recorded Joint Maintenance Agreement.
 - Permits can be issued to Industrial and/or Commercial Applicants only upon receipt and approval by the Commissioner of Public Infrastructure of required plans and supplemental information.
 - In addition, a City-issued Industrial User Discharge Permit and/or a Sewer Extension/Connection Permit issued by the Commonwealth of Massachusetts D.E.P. shall be required by the City for Industrial Discharge into the sewer system.
- Industrial User Discharge Permit No. Date

Comm. Mass. Sewer Conn./Ext. Permit No. Date

A Filing and Inspection Fee of \$ 150., plus an Entrance Fee of \$ 690., where applicable, must accompany this application.

Bank# St. Anne's C. U. Check# 1749 Date 8/26/05 Receipt# 5287

Other requirements: Insp Only - Connect to exist SMH, Install 345' of 2" F.M.
with c.o. + sub. Flowable Fill in trench.

Connection made to Sewer Part of jointly-shared private line YES NO
Storm Drain

Applicant agrees to abide by the above terms, as well as all pertinent ordinances of the City of New Bedford, and such other special rules as the Commissioner of Public Infrastructure and/or City Engineer may deem necessary

Duarte M. Andrade (ms)
Acting City Engineer

[Signature]
Signature of Property Owner or Representative

INSPECTOR'S REPORT

INSPECTED BY: Kevin Cornell
DATE: 2/3/2006
COMMENTS:

APPROVED

DISAPPROV

Kevin J. Cornell
SIGNATURE

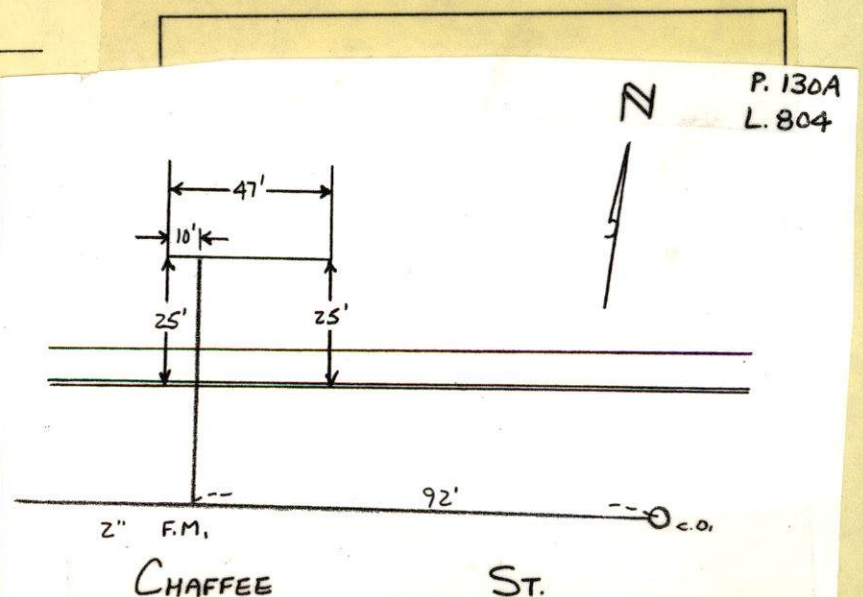

PERMIT
23738

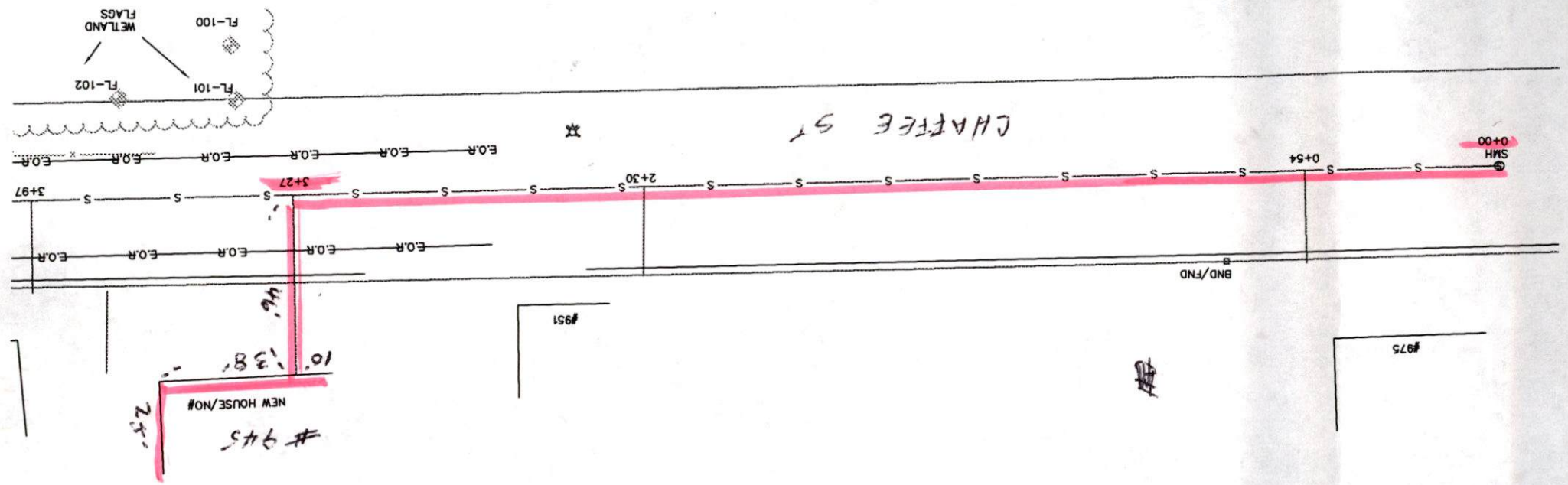



PERMIT NO.
23738

CITY OF NEW BEDFORD
SEWER AND/OR STORM DRAIN PERMIT

DATE 8/26/05
EXP. 8/26/05

This certifies that permission is granted to

Brian Dupras 28 Oakdale Ave. Marion, MA 508-889-5713
Property Owner Address Tel.

To connect a sewer and/or storm drain located at Chaffee St. (WS) 570' Ex Acushnet Ave.

Assessor's Plot 130A Lot 804, to the sewer and/or storm drain in Chaffee St. Street

To be laid in accordance with the conditions in this application and the City of New Bedford ordinances.

TYPE OF USE: RESIDENTIAL COMMERCIAL INDUSTRIAL OTHER 330
GPD

If applicant other than actual property owner, attach Letter of Authorization from Property Owner.

Name Mailing Address Tel.

The Bonded Contractor/Drain Layer authorized to perform this work is:

Brian Dupras 28 Oakdale St. Marion
Name Address Tel.
Type of Pipe Required: PVC - 2" Sch. 21

PERMIT EXPIRES ONE YEAR AFTER DATE OF ISSUE

- Requires separate connections for sewage and storm drain where applicable. Storm water cannot be discharged to a sanitary sewer.
- All work must be inspected and approved by a D.P.I. inspector before backfilling.
- If this connection is to be part of a private service shared jointly with other building owners, attach copy of Recorded Joint Maintenance Agreement.
- Permits can be issued to Industrial and/or Commercial Applicants only upon receipt and approval by the Commissioner of Public Infrastructure of required plans and supplemental information.
- In addition, a City-issued Industrial User Discharge Permit and/or a Sewer Extension/Connection Permit issued by the Commonwealth of Massachusetts D.E.P. shall be required by the City for Industrial Discharge into the sewer system.

Industrial User Discharge Permit No. Date.

Comm. Mass. Sewer Conn./Ext. Permit No. Date.

A Filing and Inspection Fee of \$150, plus an Entrance Fee of \$690, where applicable, must accompany this application.

Bank# St. Anne's C. U. Check# 1749 Date 8/26/05 Receipt# 5287

Other requirements: Insp. Only - Connect to exist SMH, Install 345' of 2" F.M.
with c.c. + Stbb. Flowable Fill in trench.

Connection made to Sewer Part of jointly-shared private line YES NO
Storm Drain

Applicant agrees to abide by the above terms, as well as all pertinent ordinances of the City of New Bedford, and such other special rules as the Commissioner of Public Infrastructure and/or City Engineer may deem necessary

Duarte M. Andrade (ms)
Acting City Engineer

X
Signature of Property Owner or Representative

INSPECTOR'S REPORT

INSPECTED BY:
DATE:
COMMENTS:

APPROVED DISAPPROVED

SIGNATURE

Friday 2/3/06 11 AM
at stub

SKETCH PLAN



PERMIT NO.
23738

CITY OF NEW BEDFORD
SEWER AND/OR STORM DRAIN PERMIT

DATE 8/26/05
EXP. 8/26/05

This certifies that permission is granted to

Brian Dupras 28 Oakdale Ave Marion, MA 508-889-5713
Property Owner Address Tel.

To connect a sewer and/or storm drain located at Chaffee St. (Ns) 570' Ex Acushnet Ave.

Assessor's Plot 130A Lot 804, to the sewer and/or storm drain in Chaffee St Street

To be laid in accordance with the conditions in this application and the City of New Bedford ordinances.

TYPE OF USE: RESIDENTIAL COMMERCIAL INDUSTRIAL OTHER 330
GPD

If applicant other than actual property owner, attach Letter of Authorization from Property Owner.

Name..... Tel.....

Mailing Address.....

The Bonded Contractor/Drain Layer authorized to perform this work is:

Brian Dupras 28 Oakdale St Marion
Name Address Tel.

Type of Pipe Required: PRC - 2" Sch 21

PERMIT EXPIRES ONE YEAR AFTER DATE OF ISSUE

- Requires separate connections for sewage and storm drain where applicable. Storm water cannot be discharged to a sanitary sewer.
- All work must be inspected and approved by a D.P.I. inspector before backfilling.
- If this connection is to be part of a private service shared jointly with other building owners, attach copy of Recorded Joint Maintenance Agreement.
- Permits can be issued to Industrial and/or Commercial Applicants only upon receipt and approval by the Commissioner of Public Infrastructure of required plans and supplemental information.
- In addition, a City-issued Industrial User Discharge Permit and/or a Sewer Extension/Connection Permit issued by the Commonwealth of Massachusetts D.E.P. shall be required by the City for Industrial Discharge into the sewer system.

Industrial User Discharge Permit No.....Date.....

Comm. Mass. Sewer Conn./Ext. Permit No.....Date.....

A Filing and Inspection Fee of \$ 150, plus an Entrance Fee of \$ 690, where applicable, must accompany this application.

Bank# St. Anne's C. U. Check# 1749 Date 8/26/05 Receipt# 5287

Other requirements: Insp Only - Connect to exist SMH, Install 345' of 2" F.M.

with c.o. + stub. Flowable Fill in trench

Connection made to Sewer Part of jointly-shared private line YES NO
Storm Drain

Applicant agrees to abide by the above terms, as well as all pertinent ordinances of the City of New Bedford, and such other special rules as the Commissioner of Public Infrastructure and/or City Engineer may deem necessary

Dwight M. Andrade (ms)
Acting City Engineer

X
Signature of Property Owner or Representative

INSPECTOR'S REPORT

INSPECTED BY: _____
DATE: _____
COMMENTS: _____

APPROVED _____ DISAPPROVED _____

SIGNATURE

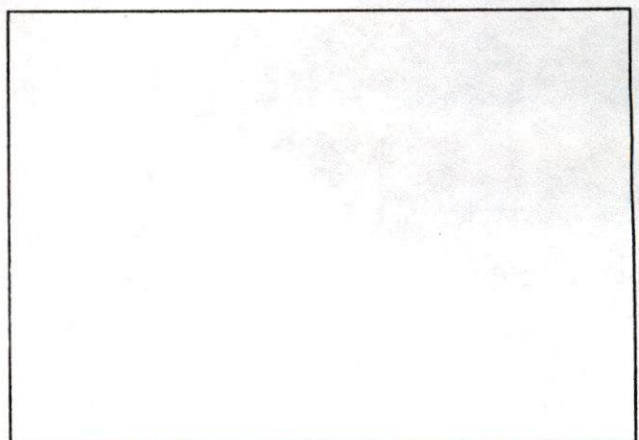

SKETCH PLAN



CITY OF NEW BEDFORD

801

NO. 959 05 LICENSE NO. _____DATE 6/10/05 20__

FOUNDATION PERMIT

MSBC Sect. 111.8 – Any permit issued shall be deemed abandoned and invalid unless the work authorized by it shall have been commenced within six (6) months after its issuance.

This certifies that Brian Dupres, owner/contractor
has permission to Install Foundation
on Lot 804 CHAFFEE ST

providing that the person accepting this permit shall in every respect conform to the terms of the application therefor on file in this office; to the provisions of the Statute of the Commonwealth and to the By-Laws of the City of New Bedford relating to the Inspection, Erection, Enlarging, Altering, Raising, Moving, Repairing or Tearing Down of a Building.

WIRING INSPECTOR

PLUMBING INSPECTOR

BUILDING INSPECTOR

ROUGH FINISH

YOUR AREA INSPECTOR IS: _____

– Tel. 979-1540 Between 8:00 AM – 9:00 AM

NOTICE: NOTIFY INSPECTOR 48 HOURS
IN ADVANCE OF APPLYING
SHEATING OR LATHING

OCCUPANCY PERMIT REQUIRED BEFORE OCCUPANCY

No Building or Structure shall be used or occupied until the Certificate of Use and Occupancy shall have been issued by the Building Commissioner – MSBC. Sect. 120.1 – N.B. Zoning Ord. Sect. 9-269

THIS CARD MUST BE DISPLAYED IN A CONSPICUOUS PLACE ON THE PREMISES
AND NOT TORN DOWN OR REMOVED UNTIL COMPLETION OF WORK

SUBJECT TO MASSACHUSETTS STATE
BUILDING CODE REQUIREMENTS

[Signature]
BUILDING INSPECTOR

He will get a credit on the betterment bill.
\$1900 was only an estimate.

CITY OF NEW BEDFORD

DEPARTMENT OF PUBLIC WORKS

MEMORANDUM

508 8895713

2 3738

DATE 1/25/06

TO D. A.

31-298

Brian Dupras received
a \$1900⁺ sewer betterment
invoice from the City
because D.P.I. installed
the force main.

REPLY:

He would like a refund
from the sewer permit
when he paid ~~\$690~~ \$690.
He was going to have a contractor
install it.