



PERMIT NO.

23696

CITY OF NEW BEDFORD  
SEWER AND/OR STORM DRAIN PERMIT

DATE 6/10/05

This certifies that permission is granted to

Antonio Caldera 15 Ruby Ct. Dartmouth 508-994-7459  
Property Owner Address Tel.

To connect a sewer and/or storm drain located at Acushnet Ave (formerly #3015 Acushnet Ave)

Assessor's Plot 132 Lot 878, to the sewer and/or storm drain in Acushnet Ave Street

To be laid in accordance with the conditions in this application and the City of New Bedford ordinances.

TYPE OF USE: RESIDENTIAL COMMERCIAL INDUSTRIAL OTHER

oil change facility

If applicant other than actual property owner, attach Letter of Authorization from Property Owner.

Name J. S. Lujan 3rd Tel. 508-995-3535

Mailing Address 13 Dartmouth St, N. Dartmouth, Ma.

The Bonded Contractor/Drain Layer authorized to perform this work is:

J. S. Lujan Name Address Tel.

Type of Pipe Required: PVC SDR-35

PERMIT EXPIRES ONE YEAR AFTER DATE OF ISSUE

- Requires separate connections for sewage and storm drain where applicable. Storm water cannot be discharged to a sanitary sewer.
- All work must be inspected and approved by a D.P.I. inspector before backfilling.
- If this connection is to be part of a private service shared jointly with other building owners, attach copy of Recorded Joint Maintenance Agreement.
- Permits can be issued to Industrial and/or Commercial Applicants only upon receipt and approval by the Commissioner of Public Infrastructure of required plans and supplemental information.
- In addition, a City-issued Industrial User Discharge Permit and/or a Sewer Extension/Connection Permit issued by the Commonwealth of Massachusetts D.E.P. shall be required by the City for Industrial Discharge into the sewer system.

Industrial User Discharge Permit No. Date.

Comm. Mass. Sewer Conn./Ext. Permit No. Date.

A Filing and Inspection Fee of \$150, plus an Entrance Fee of \$ where applicable, must accompany this application.

Bank# Sovereign Bank Check# 37450 Date 6/10/05 Receipt#

Other requirements: Deep only - connect to 8" sewer

12" storm - flowable fill in trenches, 24 hr notice for all inspections

Connection made to Sewer Part of jointly-shared private line YES NO plan attached to DW#9774

Applicant agrees to abide by the above terms, as well as all pertinent ordinances of the City of New Bedford, and such other special rules as the Commissioner of Public Infrastructure and/or City Engineer may deem necessary

Antonio M. Andrade Jr. City Engineer Signature of Property Owner or Representative

INSPECTOR'S REPORT

INSPECTED BY: Kevin J. Conell  
DATE: 8-24-05  
COMMENTS:

P. 132  
L. 878

APPROVED DISAPPROVED

Kevin J. Conell  
SIGNATURE

SEE PLAN ATTACHED  
TO PERMIT

SKETCH PLAN





PERMIT NO.

23696

CITY OF NEW BEDFORD  
SEWER AND/OR STORM DRAIN PERMIT

DATE 6/10/05

This certifies that permission is granted to

Antonio Caldera 15 Ruby Ct. Dartmouth 508-994-7459  
Property Owner Address Tel.

To connect a sewer and/or storm drain located at Acushnet Ave (formerly #3015 Acushnet Ave)

Assessor's Plot 132 Lot 878, to the sewer and/or storm drain in Acushnet Ave Street

To be laid in accordance with the conditions in this application and the City of New Bedford ordinances.

TYPE OF USE: RESIDENTIAL COMMERCIAL INDUSTRIAL OTHER

oil change facility

If applicant other than actual property owner, attach Letter of Authorization from Property Owner.

Name J. S. Luig 3rd Tel. 508-995-3535

Mailing Address 12 Ventura Dr, N. Dartmouth, Ma

The Bonded Contractor/Drain Layer authorized to perform this work is:

J. S. Luig Name Address Tel.

Type of Pipe Required: PVC SDR-35

PERMIT EXPIRES ONE YEAR AFTER DATE OF ISSUE

- Requires separate connections for sewage and storm drain where applicable. Storm water cannot be discharged to a sanitary sewer.
- All work must be inspected and approved by a D.P.I. inspector before backfilling.
- If this connection is to be part of a private service shared jointly with other building owners, attach copy of Recorded Joint Maintenance Agreement.
- Permits can be issued to Industrial and/or Commercial Applicants only upon receipt and approval by the Commissioner of Public Infrastructure of required plans and supplemental information.
- In addition, a City-issued Industrial User Discharge Permit and/or a Sewer Extension/Connection Permit issued by the Commonwealth of Massachusetts D.E.P. shall be required by the City for Industrial Discharge into the sewer system.

Industrial User Discharge Permit No. Date

Comm. Mass. Sewer Conn./Ext. Permit No. Date

A Filing and Inspection Fee of \$150, plus an Entrance Fee of \$, where applicable, must accompany this application.

Bank# Sovereign Bank Check# 37450 Date 6/10/05 Receipt#

Other requirements: Shop only - connect to 8" sewer

12" storm - flowable fill in trenches, 24 hr notice for all inspections

Connection made to Sewer Part of jointly-shared private line YES NO plan attached to DW#9774

Applicant agrees to abide by the above terms, as well as all pertinent ordinances of the City of New Bedford, and such other special rules as the Commissioner of Public Infrastructure and/or City Engineer may deem necessary

Quate M. Andrade City Engineer

Signature of Property Owner or Representative

INSPECTOR'S REPORT

INSPECTED BY:

DATE:

COMMENTS:

APPROVED

DISAPPROVED

SIGNATURE

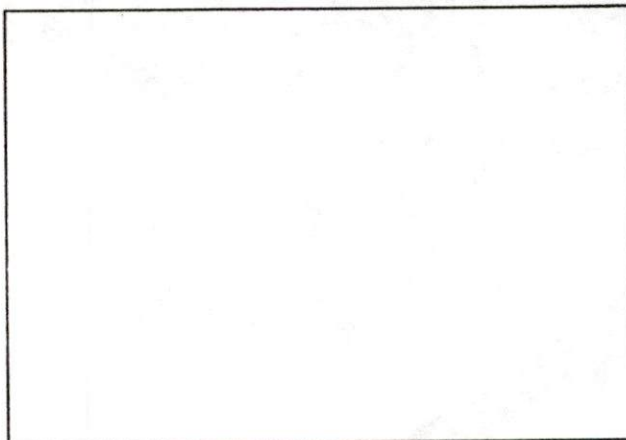

SKETCH PLAN





Duarte M. Andrade,  
Acting City Engineer

# CITY OF NEW BEDFORD MASSACHUSETTS

Engineering Department, Rm. 303

133 William Street

New Bedford, Ma. 02740

Tel: 508-979-1527

Fax: 508-961-3043

To Whom It May Concern:

I Antonio Caldera 15 Ruby Court, Dartmouth, MA, being  
(Name) (Mailing Address)

Owner of property located at 3015 Acushnet Avenue New Bedford

Plot 132, Lot 878, hereby agree to allow Joseph S. Luiz 3rd  
(Name)

12 Ventura Drive, N. Dartmouth, MA, to act on my behalf including affixing my  
(Mailing Address)

signature in securing permit for:

<input checked="" type="checkbox"/>	Sewer/Drain Service Permits
<input checked="" type="checkbox"/>	Water Service Permits
<input checked="" type="checkbox"/>	Driveway Installation Permits
<input checked="" type="checkbox"/>	Sidewalk Installation Permits

I further agree to conform to, and abide by, All City rules and ask regulations applicable to the permit (s) being applied for:

Name Antonio L. Caldera  
Signature ANTONIO CALDERA  
12 Ruby Court Dartmouth, MA 02747  
Address  
6/10/05 508-994-7459  
Date Telephone number



# CITY OF NEW BEDFORD

801

NO. 951-05

LICENSE NO. \_\_\_\_\_

DATE 6/10/05 20

## FOUNDATION PERMIT

MSBC Sect. 111.8 – Any permit issued shall be deemed abandoned and invalid unless the work authorized by it shall have been commenced within six (6) months after its issuance.

This certifies that J.S. Luiz Inc, owner/contractor  
has permission to INSTALL FOUNDATION  
on 3015 ACUSHNET AVE

providing that the person accepting this permit shall in every respect conform to the terms of the application therefor on file in this office; to the provisions of the Statute of the Commonwealth and to the By-Laws of the City of New Bedford relating to the Inspection, Erection, Enlarging, Altering, Raising, Moving, Repairing or Tearing Down of a Building.

WIRING INSPECTOR

PLUMBING INSPECTOR

BUILDING INSPECTOR

\_\_\_\_\_  
\_\_\_\_\_  
\_\_\_\_\_

\_\_\_\_\_  
\_\_\_\_\_  
\_\_\_\_\_

\_\_\_\_\_  
\_\_\_\_\_  
\_\_\_\_\_

ROUGH FINISH

YOUR AREA INSPECTOR IS: \_\_\_\_\_

– Tel. 979-1540 Between 8:00 AM – 9:00 AM

NOTICE: NOTIFY INSPECTOR 48 HOURS  
IN ADVANCE OF APPLYING  
SHEATING OR LATHING

### OCCUPANCY PERMIT REQUIRED BEFORE OCCUPANCY

No Building or Structure shall be used or occupied until the Certificate of Use and Occupancy shall have been issued by the Building Commissioner – MSBC. Sect. 120.1 – N.B. Zoning Ord. Sect. 9-269

THIS CARD MUST BE DISPLAYED IN A CONSPICUOUS PLACE ON THE PREMISES  
AND NOT TORN DOWN OR REMOVED UNTIL COMPLETION OF WORK

SUBJECT TO MASSACHUSETTS STATE  
BUILDING CODE REQUIREMENTS

Brian C. B.

BUILDING INSPECTOR

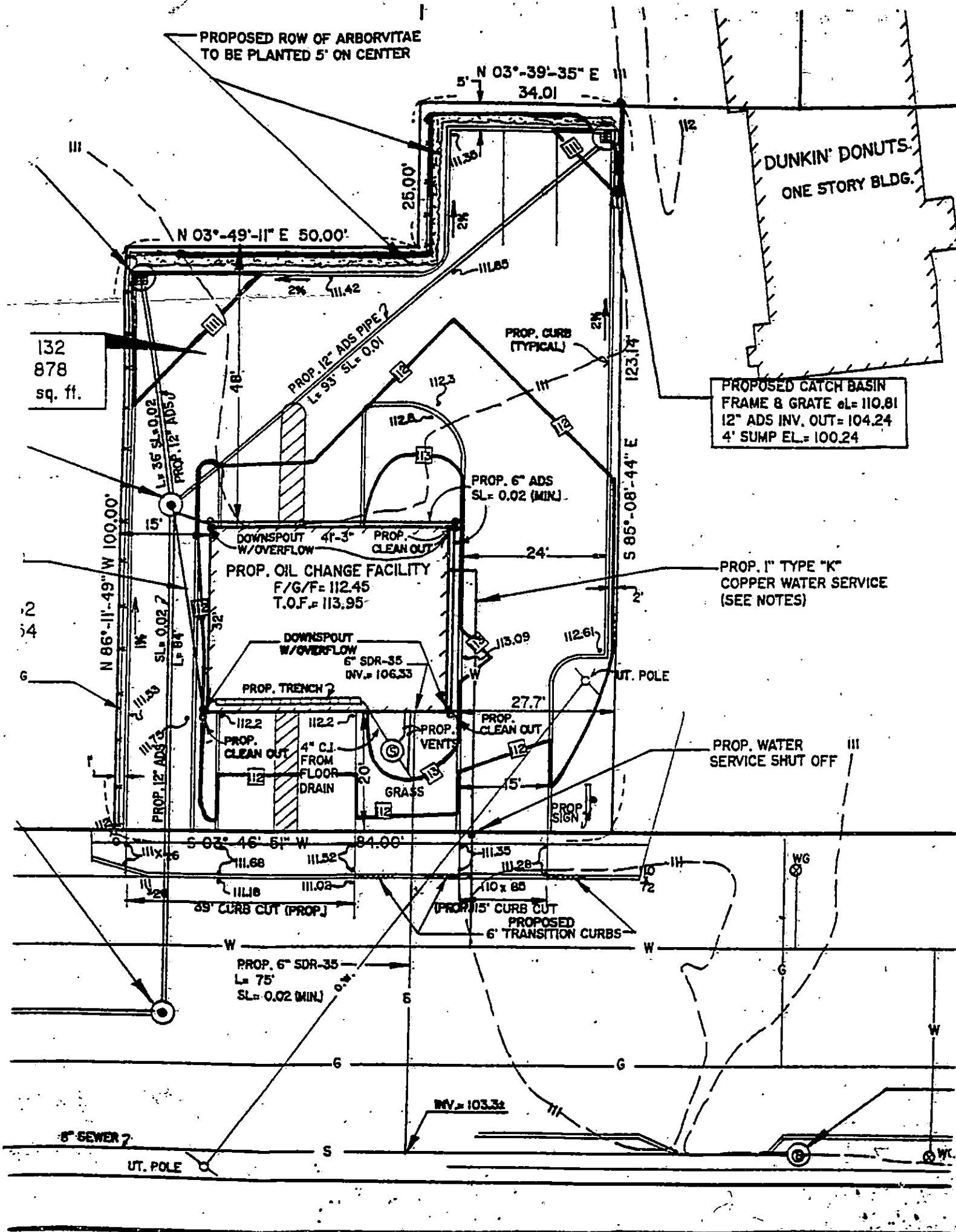



PROPOSED ROW OF ARBORVITAE  
TO BE PLANTED 5' ON CENTER

N 03°-39'-35" E  
34.01

DUNKIN' DONUTS  
ONE STORY BLDG.

N 03°-49'-11" E 50.00'

132  
878  
sq. ft.

PROPOSED CATCH BASIN  
FRAME & GRATE  $\text{eL} = 110.81$   
12" ADS INV. OUT = 104.24  
4' SUMP EL. = 100.24

PROP. 12" ADS PIPE  
 $L = 93'$   $SL = 0.01$

PROP. CURB  
(TYPICAL)

PROP. 6" ADS  
 $SL = 0.02$  (MIN.)

PROP. OIL CHANGE FACILITY  
F/G/F = 112.45  
T.O.F. = 113.95

PROP. 1" TYPE "K"  
COPPER WATER SERVICE  
(SEE NOTES)

DOWNSPOUT  
W/OVERFLOW

PROP. CLEAN OUT

PROP. TRENCH

6" SDR-35  
INV. = 106.33

PROP. CLEAN OUT

4" C.I.  
FROM  
FLOOR  
DRAIN

PROP. VENTS

PROP. CLEAN OUT

PROP. WATER  
SERVICE SHUT OFF

PROP. 6" SDR-35  
 $L = 75'$   
 $SL = 0.02$  (MIN.)

INV. = 103.3±

8" SEWER

UT. POLE

SEWER MH  
3024 ACUSHNET AVE



- 6/29/05 - NEW MH IN STREET - 12" STORM TO PROP LINE - 30' ± - OK TO PLAN  
7/5/05 - 12" STORM SOUTH FROM NEW MH - 40' - OK TO PLAN  
8/10/05 - 12" STORM WEST 60' TO NEW MH - WEST TO STORM-D - 37'  
8/11/05 - 12" STORM NORTHWEST - NEW MH TO STORM-D - 92'  
7/25/05 - 6" SAN - SEWER TO WEST - 21' ± - OK TO PLAN  
7/26/05 - 6" SAN - CONTINUE WEST 26' ± TO CLEANOUT - 1' INSIDE CURBLINE  
8/10/05 - 6" SAN - CLEANOUT WEST TO CAST IRON - 4' - MDC MH - OK TO PLAN

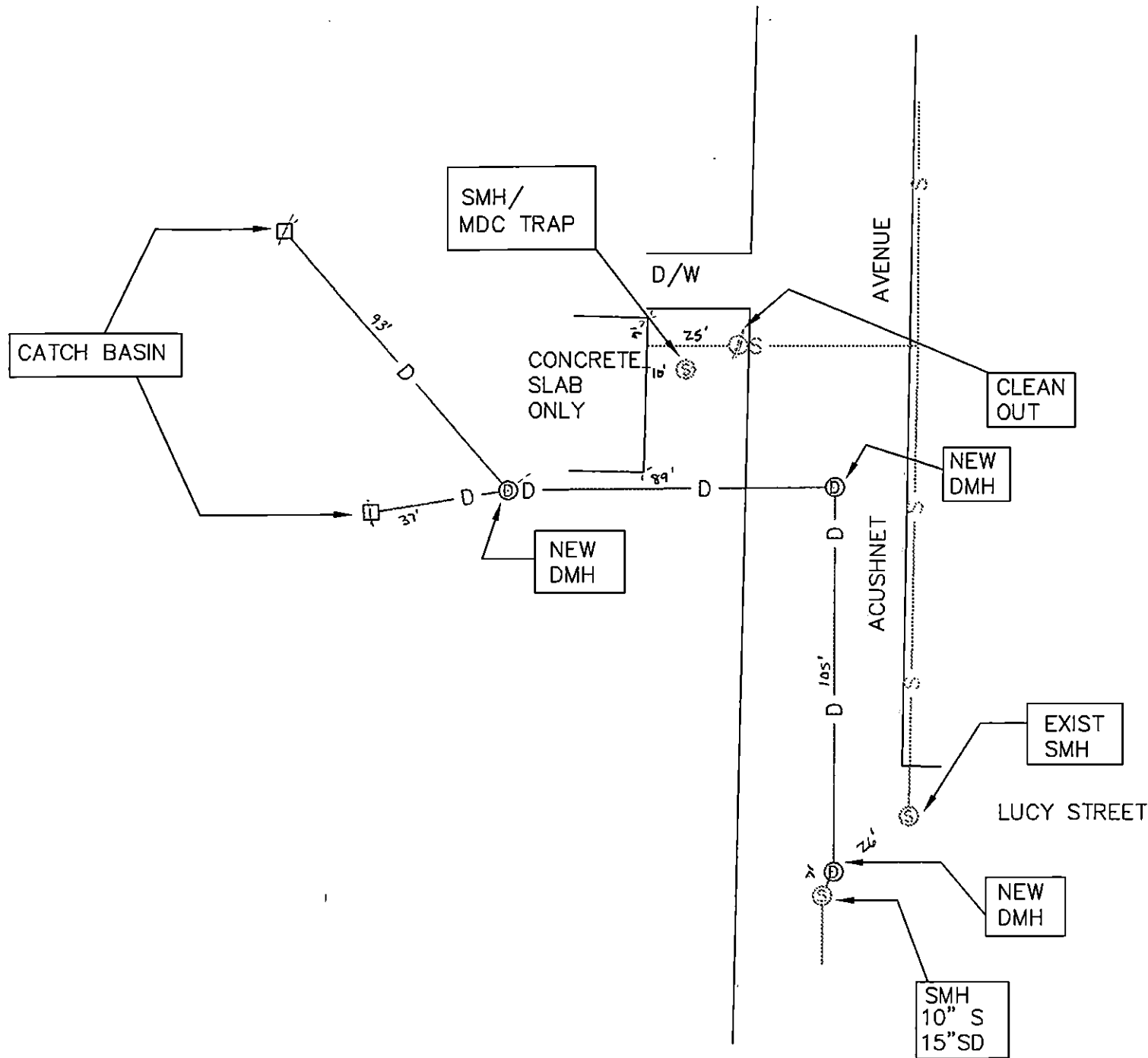

PERMIT # 23696  
SCALE: 1"=40'