



PERMIT NO.
23665

CITY OF NEW BEDFORD
SEWER AND/OR STORM DRAIN PERMIT

DATE 3/15/05
EXP. 3/15/06

This certifies that permission is granted to

Michael Panagakos 914 Mt. Pleasant St. NB. MA
Property Owner Address Tel.

To connect a sewer and/or storm drain located at Conway St.

Assessor's Plot 37 Lot 292, to the sewer and/or storm drain in NE CORNER OF Conway + Rte. 18 Street

To be laid in accordance with the conditions in this application and the City of New Bedford ordinances.

TYPE OF USE: RESIDENTIAL COMMERCIAL INDUSTRIAL OTHER Prop Fast Food

If applicant other than actual property owner, attach Letter of Authorization from Property Owner.

Name JB Lanagan + Co. Inc. (James B. Lanagan III) Tel. 508-984-1668

Mailing Address 21 E. River Dr. Dartmouth MA 02747

The Bonded Contractor/Drain Layer authorized to perform this work is:

JB Lanagan 21 E. River Dr. Dartmouth MA

Name Address Tel.

Type of Pipe Required: PVC SDR-35

PERMIT EXPIRES ONE YEAR AFTER DATE OF ISSUE

- Requires separate connections for sewage and storm drain where applicable. Storm water cannot be discharged to a sanitary sewer.
 - All work must be inspected and approved by a D.P.I. inspector before backfilling.
 - If this connection is to be part of a private service shared jointly with other building owners, attach copy of Recorded Joint Maintenance Agreement.
 - Permits can be issued to Industrial and/or Commercial Applicants only upon receipt and approval by the Commissioner of Public Infrastructure of required plans and supplemental information.
 - In addition, a City-issued Industrial User Discharge Permit and/or a Sewer Extension/Connection Permit issued by the Commonwealth of Massachusetts D.E.P. shall be required by the City for Industrial Discharge into the sewer system.
- Industrial User Discharge Permit No. _____ Date _____

Comm. Mass. Sewer Conn./Ext. Permit No. _____ Date _____

A Filing and Inspection Fee of \$ 150, plus an Entrance Fee of \$ _____ where applicable, must accompany this application.

Bank# Slade's Ferry Bank Check# 195 Date 3/15/05 Receipt# _____

Other requirements: Insp. Only - Connect to 6" Sewer Stub + 12" Storm Drainage All on Private Property

Connection made to Sewer Part of jointly-shared private line YES NO
Storm Drain

Applicant agrees to abide by the above terms, as well as all pertinent ordinances of the City of New Bedford, and such other special rules as the Commissioner of Public Infrastructure and/or City Engineer may deem necessary

Dante M. Andrade
Acting City Engineer

James B. Lanagan III
Signature of Property Owner or Representative

INSPECTOR'S REPORT

INSPECTED BY: Kevin J. Casella
DATE: 03-17-05
COMMENTS: _____

APPROVED

DISAPPROVED

Kevin J. Casella
SIGNATURE

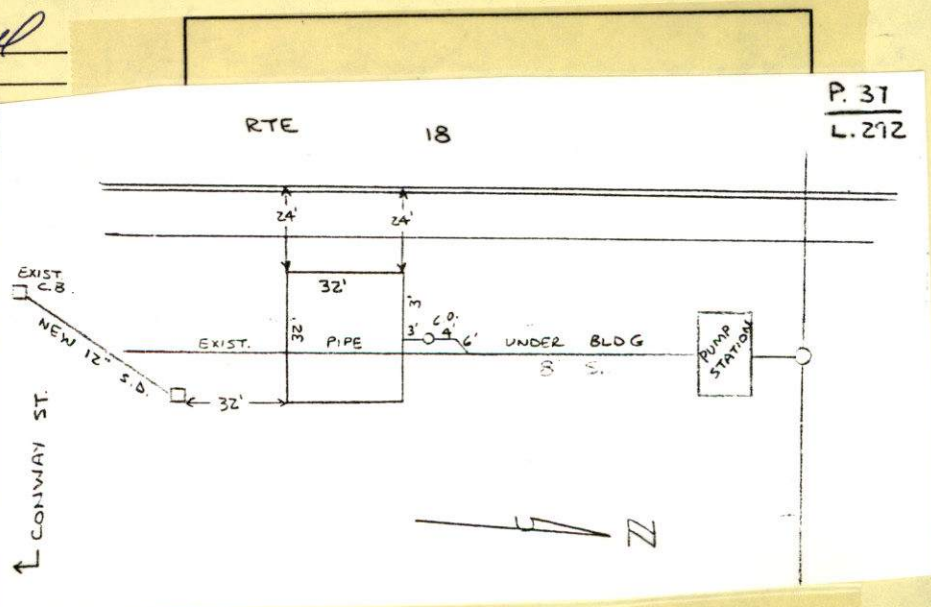



PERMIT NO.

23665

CITY OF NEW BEDFORD
SEWER AND/OR STORM DRAIN PERMIT

DATE 3/15/05
EXP. 3/15/06

This certifies that permission is granted to

Michael Panagakos 914 Mt. Pleasant St. NB, MA
Property Owner Address Tel.

To connect a sewer and/or storm drain located at Conway St.
Assessor's Plot 37 Lot 292, to the sewer and/or storm drain in NE CORNER OF Conway + Rte 18 Street

To be laid in accordance with the conditions in this application and the City of New Bedford ordinances.
TYPE OF USE: RESIDENTIAL COMMERCIAL INDUSTRIAL OTHER Prop Fast Food

If applicant other than actual property owner, attach Letter of Authorization from Property Owner.
Name JB Lanagan + Co. Inc. (James B. Lanagan III) Tel. 508-984-1668
Mailing Address 21 E. River Dr. Dartmouth MA 02747
The Bonded Contractor/Drain Layer authorized to perform this work is:
JB Lanagan 21 E. River Dr. Dartmouth MA
Name Address Tel.
Type of Pipe Required: PVC SDR-35

PERMIT EXPIRES ONE YEAR AFTER DATE OF ISSUE

- Requires separate connections for sewage and storm drain where applicable. Storm water cannot be discharged to a sanitary sewer.
 - All work must be inspected and approved by a D.P.I. inspector before backfilling.
 - If this connection is to be part of a private service shared jointly with other building owners, attach copy of Recorded Joint Maintenance Agreement.
 - Permits can be issued to Industrial and/or Commercial Applicants only upon receipt and approval by the Commissioner of Public Infrastructure of required plans and supplemental information.
 - In addition, a City-issued Industrial User Discharge Permit and/or a Sewer Extension/Connection Permit issued by the Commonwealth of Massachusetts D.E.P. shall be required by the City for Industrial Discharge into the sewer system.
- Industrial User Discharge Permit No. Date

Comm. Mass. Sewer Conn./Ext. Permit No. Date

A Filing and Inspection Fee of \$ 150, plus an Entrance Fee of \$ where applicable, must accompany this application.

Bank# Slade's Ferry Bank Check# 195 Date 3/15/05 Receipt#

Other requirements: Insp Only - Connect to 6" Sewer Stub + 12" Storm Drainage All on Private Property

Connection made to Sewer Part of jointly-shared private line YES NO
Storm Drain

Applicant agrees to abide by the above terms, as well as all pertinent ordinances of the City of New Bedford, and such other special rules as the Commissioner of Public Infrastructure and/or City Engineer may deem necessary

Duarte M. Andrade MS James Lanagan III
Acting City Engineer Signature of Property Owner or Representative

INSPECTOR'S REPORT

INSPECTED BY: _____
DATE: _____
COMMENTS: _____

APPROVED _____ DISAPPROVED _____

SIGNATURE

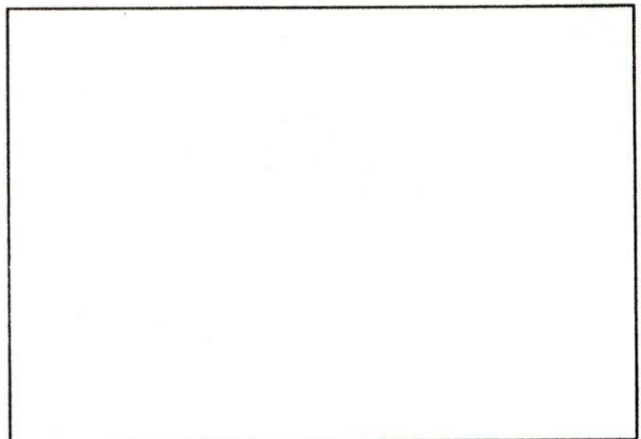

SKETCH PLAN



CITY OF NEW BEDFORD MASSACHUSETTS

Engineering Department, Rm. 303

133 William Street

New Bedford, Ma. 02740

Tel: 508-979-1527

Fax: 508-961-3043

Duarte M. Andrade,
Acting City Engineer

To Whom It May Concern:

I Michael Panagakos 914 Mt Pleasant St, being
(Name) (Mailing Address)

Owner of property located at 113 Conway St.

Plot 37, Lot 292, hereby agree to allow JB Laragan & Co Inc.
(Name)

21 E. River Dr. Dartmouth, to act on my behalf including affixing my
(Mailing Address) Ma 02747

signature in securing permit for:

☒ Sewer/Drain Service Permits
☒ Water Service Permits
☒ Driveway Installation Permits
☒ Sidewalk Installation Permits

I further agree to conform to, and abide by, All City rules and ask regulations applicable to the permit (s) being applied for:

Name

Signature

Address

Date

Telephone number

Michael Panagakos
914 Mt Pleasant St.
3/15/05 (508) 998-3911

ARTERIAL HIGHWAY

Plot 42
Plot 37
R=605
L=44.8

N/F
Lot 290
CITY OF NEW BEDFORD

N 06°55'14" W

24.53'
20.00'
33.93'
N 07°03'45" W
69.38'
Prop. Sewer Easement
PARCEL "A" 1386 Sq.Ft.

N 7°59'58" W
33.50'
69.37'
35.87'

N/F
Lot 106
CITY OF NEW BEDFORD

N/F
Lot 105
CITY OF NEW BEDFORD

TER. LEASE LIMITED

PANAGAKOS

43.99'
S 81°05'01" W

N 6°55'14" W
20.01'
20.00'

716
SqFt

N 06°55'14" W

N 81°05'01" E
16.05'

Prop. Water Easements

PARCEL "B"

33.50'
20.00'

763
SqFt

N 8°00'16" W
36.29'

N/F
Lot 323
LYNN INC.

N/F
Lot 291
CITY OF NEW BEDFORD

PARCEL "C"

EXISTING
COMMONWEALTH
ELECTRIC EASEMENT

32.93'
44.93'
S 81°29'37" W

S 21°27'08" E
12.82'

S 81°29'37" W
12.00'

(public

MAC ARTHUR

D

GRAPHIC SCALE

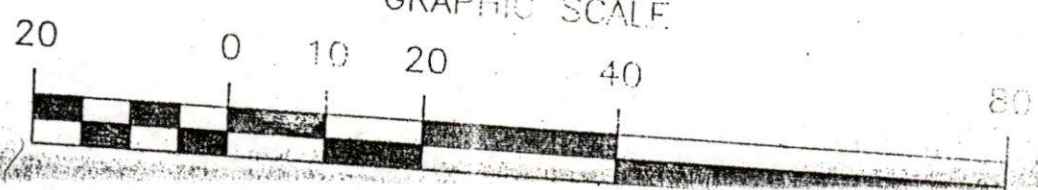

SUNNY 40° (27)

03-17-05 THURSDAY

CONWAY ST- SEWER & DRAIN
INTERSECTION

PERMIT # 23665

PLOT 37 LOT 292

CONTRACTOR J.B. LANAGAN

JO8-984-1668

DETAIL

PROPERTY
LINE

NEW
BLDG

CLEAN
OUT

SADDLE

SWH

WATER
MAIN

8" PVC RUNS UNDER NEW BLDG

SEWER FOR DUNKIN DONUTS
SEWER 17' DEEP, NEW 6"
FOR BLDG RUNS ON TOP OF
8" PIPE

CONWAY ST

CURB
LINE

RT# 18

197'

32'

106

BND
BND

EXISTING
CATCH BASIN

NEW CATCH
BASIN

12" RCP

32'

32'

NEW
BLDG

8" SEWER

PUMPING
STATION

SEE DETAIL
FOR SEWER
CONNECTION

MCCARTHR DR

JAMES B. LANAGAN III

J.B. LANAGAN & COMPANY INC.

Site Development

21 East River Drive
North Dartmouth, MA 02747-3540
Email - jblanagan@attbi.com

(508) 984-1668
Fax (508) 992-4400
Cell (508) 326-8757