



PERMIT NO.
23653

CITY OF NEW BEDFORD
SEWER AND/OR STORM DRAIN PERMIT

DATE 11/21/2005
EXP. 11/21/2006

This certifies that permission is granted to West End Asse.

Robert A. Watkins, Jr. 6 Whitealder Way Dartmouth, MA 508-979-4646
Property Owner Address Tel.

To connect a sewer and/or storm drain located at Phillips Rd. (ES) 160' N x Heritage Drive North
Assessor's Plot 1346 Lot 368, to the sewer and/or storm drain in Phillips Rd. Street

To be laid in accordance with the conditions in this application and the City of New Bedford ordinances.

TYPE OF USE: RESIDENTIAL 48 units COMMERCIAL INDUSTRIAL OTHER 4800 GPD

If applicant other than actual property owner, attach Letter of Authorization from Property Owner.

Name Stanley P. Cieplik Bufftree Bldg Co, Inc. Tel. 508-997-5357
Mailing Address 193-R Pope's Island New Bedford, MA

The Bonded Contractor/Drain Layer authorized to perform this work is:

Bufftree Building Co, Inc. 193R Pope's Island NB, MA 508-997-5357
Name Address Tel.
Type of Pipe Required: PVC SDR-35

PERMIT EXPIRES ONE YEAR AFTER DATE OF ISSUE

- Requires separate connections for sewage and storm drain where applicable. Storm water cannot be discharged to a sanitary sewer.
 - All work must be inspected and approved by a D.P.I. inspector before backfilling.
 - If this connection is to be part of a private service shared jointly with other building owners, attach copy of Recorded Joint Maintenance Agreement.
 - Permits can be issued to Industrial and/or Commercial Applicants only upon receipt and approval by the Commissioner of Public Infrastructure of required plans and supplemental information.
 - In addition, a City-issued Industrial User Discharge Permit and/or a Sewer Extension/Connection Permit issued by the Commonwealth of Massachusetts D.E.P. shall be required by the City for Industrial Discharge into the sewer system.
- Industrial User Discharge Permit No. Date

Comm. Mass. Sewer Conn./Ext. Permit No. Date

A Filing and Inspection Fee of \$150, plus an Entrance Fee of \$ where applicable, must accompany this application.

Bank# Sovereign Bank Check# 25518 Date 11/21/2005 Receipt# 5107

Other requirements: Insp Only - Connect to 8" Sewer in Sidewalk Area + 27" Storm
Drain in Sidewalk Area. 24 hrs. notice for all inspections 508-979-1527

Connection made to Sewer Part of jointly-shared private line YES NO
Storm Drain

Applicant agrees to abide by the above terms, as well as all pertinent ordinances of the City of New Bedford, and such other special rules as the Commissioner of Public Infrastructure and/or City Engineer may deem necessary

Diante M. Andrade Acting City Engineer

Signature of Property Owner or Representative
Stanley Cieplik

INSPECTOR'S REPORT

INSPECTED BY: Kevin Cornell
DATE: 2/24/05
COMMENTS:

APPROVED

DISAPPROVED

Kevin J. Cornell
SIGNATURE

SEE PLAN ATTACHED
TO PERMIT

SKETCH PLAN

2-24-05 THURSDAY

PHILLIPS RD - PLOT 1346 LOT 368
100' NORTH OF HERITAGE DRIVE
SEWER & DRAIN INSP
PERMIT # 20653

CONTRACTOR - BUELTREE BUILDING INC
508-997-5357

45R82

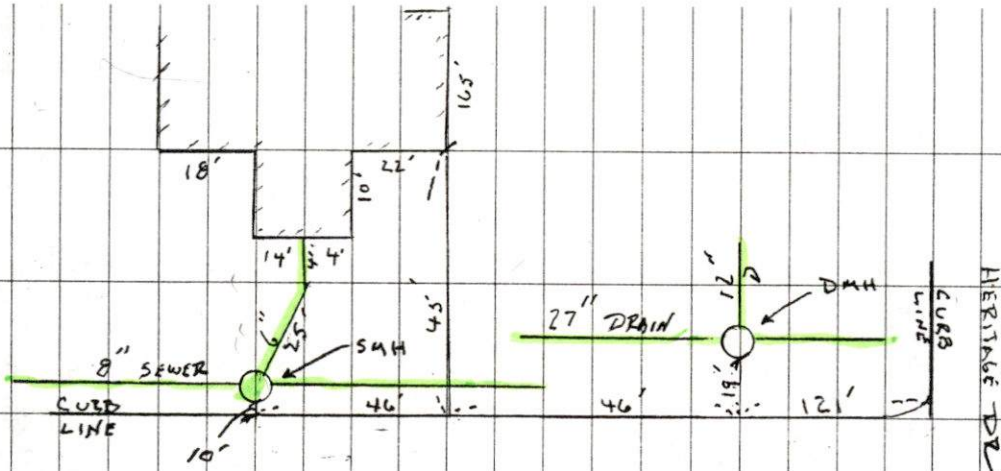

PHILLIPS ROAD



PERMIT NO.
23653

CITY OF NEW BEDFORD
SEWER AND/OR STORM DRAIN PERMIT

DATE 1/12/2005
EXP. 1/12/2006

This certifies that permission is granted to West End Asse.

Robert A. Watkins, Jr. 6 White alder Way Dartmouth, MA. 508-979-4646
Property Owner Address Tel.

To connect a sewer and/or storm drain located at Phillips Rd. (Es) 160' N x Heritage Drive North

Assessor's Plot 134G Lot 368, to the sewer and/or storm drain in Phillips Rd. Street

To be laid in accordance with the conditions in this application and the City of New Bedford ordinances.

TYPE OF USE: RESIDENTIAL 48 units 4800 GPD
COMMERCIAL INDUSTRIAL OTHER

If applicant other than actual property owner, attach Letter of Authorization from Property Owner.

Name Stanley P. Cieplik Bufftree Bldg Co, Inc. Tel. 508-997-5357

Mailing Address 193-R Pope's Island New Bedford, MA

The Bonded Contractor/Drain Layer authorized to perform this work is:

Bufftree Building Co, Inc. 193R Pope's Island NB, MA 508-997-5357
Name Address Tel.

Type of Pipe Required: PVC SDR-35

PERMIT EXPIRES ONE YEAR AFTER DATE OF ISSUE

- Requires separate connections for sewage and storm drain where applicable. Storm water cannot be discharged to a sanitary sewer.
 - All work must be inspected and approved by a D.P.I. inspector before backfilling.
 - If this connection is to be part of a private service shared jointly with other building owners, attach copy of Recorded Joint Maintenance Agreement.
 - Permits can be issued to Industrial and/or Commercial Applicants only upon receipt and approval by the Commissioner of Public Infrastructure of required plans and supplemental information.
 - In addition, a City-issued Industrial User Discharge Permit and/or a Sewer Extension/Connection Permit issued by the Commonwealth of Massachusetts D.E.P. shall be required by the City for Industrial Discharge into the sewer system.
- Industrial User Discharge Permit No. _____ Date _____

Comm. Mass. Sewer Conn./Ext. Permit No. _____ Date _____

A Filing and Inspection Fee of \$150., plus an Entrance Fee of \$ _____ where applicable, must accompany this application.

Bank# Sovereign Bank Check# 25518 Date 1/12/2005 Receipt# 5107

Other requirements: Insp Only - Connect to 8" Sewer in Sidewalk Area + 27" Storm
Drain in Sidewalk Area. 24 hrs. notice for all inspections. 508-979-1527

Connection made to Sewer Part of jointly-shared private line YES NO
Storm Drain

Applicant agrees to abide by the above terms, as well as all pertinent ordinances of the City of New Bedford, and such other special rules as the Commissioner of Public Infrastructure and/or City Engineer may deem necessary

Dwight M. Andrade MS
Acting City Engineer

Stanley Cieplik
Signature of Property Owner or Representative

INSPECTOR'S REPORT

INSPECTED BY: _____
DATE: _____
COMMENTS: _____

APPROVED _____ DISAPPROVED _____

SIGNATURE

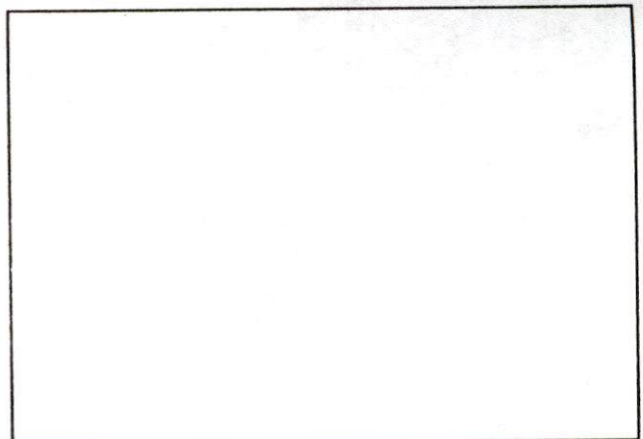

SKETCH PLAN



**CITY OF NEW BEDFORD
MASSACHUSETTS**

Engineering Department, Rm. 303

133 William Street

New Bedford, Ma. 02740

Tel: 508-979-1527

Fax: 508-961-3043

Duarte M. Andrade,
Acting City Engineer

To Whom It May Concern:

I ROBERT A. WATKINS, JR 6 WHITE ALDER WAY, being
(Name) (Mailing Address)

Owner of property located at 2062 Phillips Road

Plot 134G, Lot 368, hereby agree to allow Stanley P. Cieplik,
(Name)

Bufftree Building Company, Inc.
193-R Pope's Island, New Bedford, to act on my behalf including affixing my
(Mailing Address) MA 02740

signature in securing permit for:

☒ Sewer/Drain Service Permits
☒ Water Service Permits
☒ Driveway Installation Permits
☒ Sidewalk Installation Permits

I further agree to conform to, and abide by, All City rules and ask regulations applicable to the permit (s) being applied for:

Name Robert A. Watkins, Jr.
Signature
6 WHITE ALDER WAY
Address
12-29-04 508-979-4646
Date Telephone number