



PERMIT NO.

CITY OF NEW BEDFORD
SEWER AND/OR STORM DRAIN PERMIT

DATE 8-17-04

23592

This certifies that permission is granted to

Wayland Development Corp. 867 Middle Rd. Acushnet, MA 508-763-8868
Property Owner Address Tel.

To connect a sewer and/or storm drain located at E. of Larsen Drive

Assessor's Plot 132 J Lot 58, to the sewer and/or storm drain in 24 Katelyn Way 10" sewer Street

To be laid in accordance with the conditions in this application and the City of New Bedford ordinances.

TYPE OF USE: ☒ RESIDENTIAL ☐ COMMERCIAL ☐ INDUSTRIAL ☐ OTHER 330gpd.

If applicant other than actual property owner, attach Letter of Authorization from Property Owner.

Name Ralph Chip Mulford Tel. _____

Mailing Address 158 Chas. McCombs Blvd. N.B.

The Bonded Contractor/Drain Layer authorized to perform this work is:

D.W. White Construction Inc. 867 Middle Rd. Acushnet 508-763-8868

Name Address Tel.

Type of Pipe Required: PVC SDR 35

PERMIT EXPIRES ONE YEAR AFTER DATE OF ISSUE

- Requires separate connections for sewage and storm drain where applicable. Storm water cannot be discharged to a sanitary sewer.
 - All work must be inspected and approved by a D.P.I. inspector before backfilling.
 - If this connection is to be part of a private service shared jointly with other building owners, attach copy of Recorded Joint Maintenance Agreement.
 - Permits can be issued to Industrial and/or Commercial Applicants only upon receipt and approval by the Commissioner of Public Infrastructure of required plans and supplemental information.
 - In addition, a City-issued Industrial User Discharge Permit and/or a Sewer Extension/Connection Permit issued by the Commonwealth of Massachusetts D.E.P. shall be required by the City for Industrial Discharge into the sewer system.
- Industrial User Discharge Permit No. _____ Date _____

Comm. Mass. Sewer Conn./Ext. Permit No. _____ Date _____

A Filing and Inspection Fee of \$150.00, plus an Entrance Fee of \$ _____ where applicable, must accompany this application.

Bank# bcp bank Check# 2710 Date 8-17-04 Receipt# 4970

Other requirements: to be built according to approved subdivision plans.

24 hr. inspection notice

Connection made to Sewer Part of jointly-shared private line YES ☒ NO ☐
Storm Drain

Applicant agrees to abide by the above terms, as well as all pertinent ordinances of the City of New Bedford, and such other special rules as the Commissioner of Public Infrastructure and/or City Engineer may deem necessary

Duante M. Andrade Chip Mulford
Acting City Engineer Signature of Property Owner or Representative

INSPECTOR'S REPORT

INSPECTED BY: _____
DATE: _____
COMMENTS: _____

APPROVED _____ DI _____

SIGNATURE _____

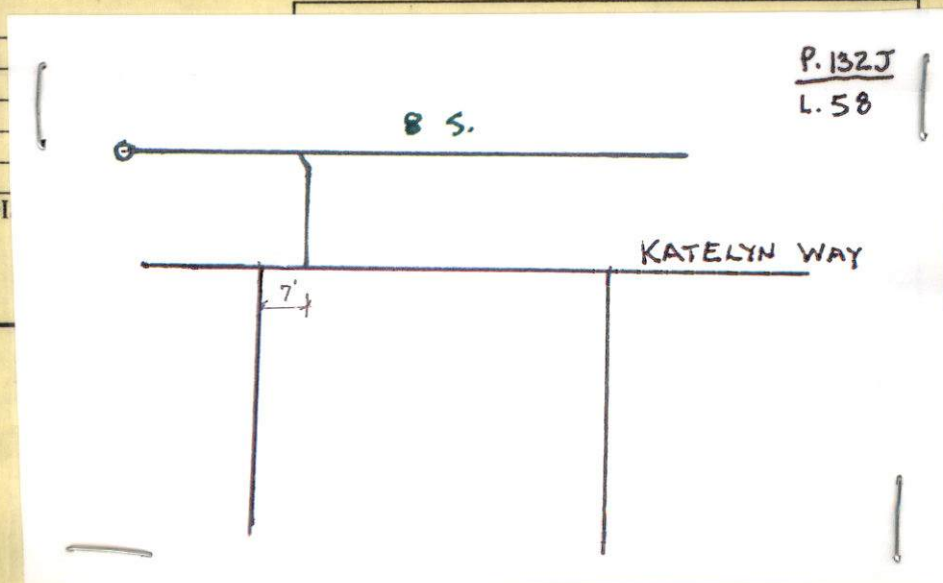



PERMIT NO.

23592

CITY OF NEW BEDFORD
SEWER AND/OR STORM DRAIN PERMIT

DATE 8-17-04

This certifies that permission is granted to

Wayland Development Corp. 867 Middle Rd. Acushnet, MA 508-763-8868
Property Owner Address Tel.

To connect a sewer and/or storm drain located at E. of Lauren Drive

Assessor's Plot 132 J Lot 58, to th sewer and/or storm drain in 24 Katelyn Way 10" sewer Street

To be laid in accordance with the conditions in this application and the City of New Bedford ordinances.

TYPE OF USE: ☒ RESIDENTIAL ☐ COMMERCIAL ☐ INDUSTRIAL ☐ OTHER

3309 pd.

If applicant other than actual property owner, attach Letter of Authorization from Property Owner.

Name Chip Ralph Mulford Tel.

Mailing Address 158 Ches. McCombs Blvd. NB. MA.

The Bonded Contractor/Drain Layer authorized to perform this work is:

D. W. White Construction Inc. 867 Middle Rd. Acushnet 508-763-8868

Name Address Tel.

Type of Pipe Required: PVC SDR 35

PERMIT EXPIRES ONE YEAR AFTER DATE OF ISSUE

- Requires separate connections for sewage and storm drain where applicable. Storm water cannot be discharged to a sanitary sewer.
 - All work must be inspected and approved by a D.P.I. inspector before backfilling.
 - If this connection is to be part of a private service shared jointly with other building owners, attach copy of Recorded Joint Maintenance Agreement.
 - Permits can be issued to Industrial and/or Commercial Applicants only upon receipt and approval by the Commissioner of Public Infrastructure of required plans and supplemental information.
 - In addition, a City-issued Industrial User Discharge Permit and/or a Sewer Extension/Connection Permit issued by the Commonwealth of Massachusetts D.E.P. shall be required by the City for Industrial Discharge into the sewer system.
- Industrial User Discharge Permit No. Date

Comm. Mass. Sewer Conn./Ext. Permit No. Date

A Filing and Inspection Fee of \$150.00 plus an Entrance Fee of \$..... where applicable, must accompany this application.

Bank# bap bank Check# 2710 Date 8-17-04 Receipt# 4970

Other requirements: to be built according to approved subdivision plans.

24 hr. inspection notice

Connection made to ☒ Sewer ☐ Storm Drain Part of jointly-shared private line YES ☒ NO

Applicant agrees to abide by the above terms, as well as all pertinent ordinances of the City of New Bedford, and such other special rules as the Commissioner of Public Infrastructure and/or City Engineer may deem necessary

Duarte M. Andrade Acting City Engineer 1 mn Signature of Property Owner or Representative

INSPECTOR'S REPORT

INSPECTED BY: _____

DATE: _____

COMMENTS: _____

APPROVED _____ DISAPPROVED _____

SIGNATURE

SKETCH PLAN

TELEPHONE (508) 763-8868
OFFICE FAX (508) 997-9998

Wayland Development Corporation

867 MIDDLE ROAD-ACUSHNET, MA 02743

December 8, 2003

Mr. Duarte Andrade
Acting Chief Engineer
Engineering Department
City of New Bedford, MA 02740

Re: Authorization of Agent

Dear Mr. Andrade,

This letter will confirm that Ralph K. "Chip" Mulford, an attorney and the Corporate Counsel for Long Built Homes/Long Realty, Inc., is authorized to act on Wayland Development Corporation's behalf, including affixing the Corporation's signature, when applying for and securing permits for the Woodford Estates Subdivision from your Department, including but not limited to the following:

1. Sewer/Drain Service Permits;
2. Water Service Permits;
3. Driveway Installation Permits; and
4. Sidewalk Installation Permits.

Wayland Development Corp., acting through Mr. Mulford, its Agent for these limited purposes, agrees to conform to and abide by all City rules and regulations applicable to any permits being applied for.

Thank you in advance for your cooperation.

Sincerely,
Wayland Development Corp.

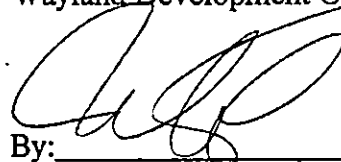

By: _____

Mark W. White
Treasurer
Hereunto Duly Authorized