



PERMIT NO.

23562

CITY OF NEW BEDFORD  
SEWER AND/OR STORM DRAIN PERMITDATE 6/8/2004  
EXP. 6/8/2005

This certifies that permission is granted to

Property Owner Davis LeRoux Address 929 Maplewood St. NB. Tel. \_\_\_\_\_To connect a sewer and/or storm drain located at 929 Maplewood St.Assessor's Plot 130A Lot 486, to the sewer and/or storm drain in Maplewood St. Street

To be laid in accordance with the conditions in this application and the City of New Bedford ordinances.

TYPE OF USE: RESIDENTIAL COMMERCIAL INDUSTRIAL OTHER 330 GPD

If applicant other than actual property owner, attach Letter of Authorization from Property Owner.

Name Robert Canessa Tel. 508-763-4827Mailing Address PO Box 51643 New Bedford, MA

The Bonded Contractor/Drain Layer authorized to perform this work is:

R.J. Canessa PO Box 51643 New Bedford, MA 508-763-4827

Name \_\_\_\_\_ Address \_\_\_\_\_ Tel. \_\_\_\_\_

Type of Pipe Required: 1 1/2" PVC SDR-21

## PERMIT EXPIRES ONE YEAR AFTER DATE OF ISSUE

- Requires separate connections for sewage and storm drain where applicable. Storm water cannot be discharged to a sanitary sewer.
  - All work must be inspected and approved by a D.P.I. inspector before backfilling.
  - If this connection is to be part of a private service shared jointly with other building owners, attach copy of Recorded Joint Maintenance Agreement.
  - Permits can be issued to Industrial and/or Commercial Applicants only upon receipt and approval by the Commissioner of Public Infrastructure of required plans and supplemental information.
  - In addition, a City-issued Industrial User Discharge Permit and/or a Sewer Extension/Connection Permit issued by the Commonwealth of Massachusetts D.E.P. shall be required by the City for Industrial Discharge into the sewer system.
- Industrial User Discharge Permit No. \_\_\_\_\_ Date \_\_\_\_\_

Comm. Mass. Sewer Conn./Ext. Permit No. \_\_\_\_\_ Date \_\_\_\_\_

A Filing and Inspection Fee of \$ 150, plus an Entrance Fee of \$ \_\_\_\_\_ where applicable, must accompany this application.Bank# Bank of Fall River Check# 2622 Date 6/8/04 Receipt# 4912Other requirements: Insp. Only - Connect to 2" Force Main + install curb box + check valve @ property line. See attached planConnection made to Sewer Part of jointly-shared private line YES NO  
Storm Drain

Applicant agrees to abide by the above terms, as well as all pertinent ordinances of the City of New Bedford, and such other special rules as the Commissioner of Public Infrastructure and/or City Engineer may deem necessary

Duarte M. Andrade MA  
Acting City EngineerRobert J. Canessa  
Signature of Property Owner or Representative  
Robert Canessa

## INSPECTOR'S REPORT

INSPECTED BY: 6-10-04  
DATE: Kevin J. Corral  
COMMENTS: \_\_\_\_\_

APPROVED \_\_\_\_\_ DISAPPROVED \_\_\_\_\_

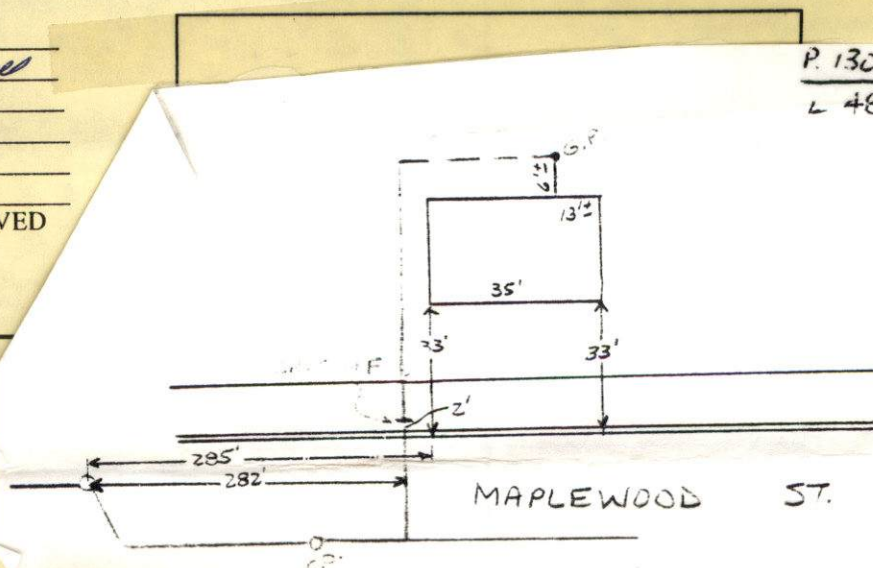
Kevin J. Corral  
SIGNATUREP. 130A  
L 486





PERMIT NO.

23562

CITY OF NEW BEDFORD  
SEWER AND/OR STORM DRAIN PERMIT

DATE 6/8/2004

EXP. 6/8/2005

This certifies that permission is granted to

Property Owner DAVID LE ROUX Address 929 Maplewood St NB Tel. \_\_\_\_\_To connect a sewer and/or storm drain located at 929 Maplewood StAssessor's Plot 130A Lot 486, to the sewer and/or storm drain in Maplewood St Street

To be laid in accordance with the conditions in this application and the City of New Bedford ordinances.

TYPE OF USE: RESIDENTIAL COMMERCIAL INDUSTRIAL OTHER 330 GPD

If applicant other than actual property owner, attach Letter of Authorization from Property Owner.

Name Robert Canessa Tel. 508-763-4827Mailing Address PO Box 51643 New Bedford, MA

The Bonded Contractor/Drain Layer authorized to perform this work is:

RJ Canessa PO Box 51643 New Bedford, MA 508-763-4827

Name Address Tel.

Type of Pipe Required: 1 1/2" PVC SDR-21

## PERMIT EXPIRES ONE YEAR AFTER DATE OF ISSUE

- Requires separate connections for sewage and storm drain where applicable. Storm water cannot be discharged to a sanitary sewer.
  - All work must be inspected and approved by a D.P.I. inspector before backfilling.
  - If this connection is to be part of a private service shared jointly with other building owners, attach copy of Recorded Joint Maintenance Agreement.
  - Permits can be issued to Industrial and/or Commercial Applicants only upon receipt and approval by the Commissioner of Public Infrastructure of required plans and supplemental information.
  - In addition, a City-issued Industrial User Discharge Permit and/or a Sewer Extension/Connection Permit issued by the Commonwealth of Massachusetts D.E.P. shall be required by the City for Industrial Discharge into the sewer system.
- Industrial User Discharge Permit No. \_\_\_\_\_ Date \_\_\_\_\_

Comm. Mass. Sewer Conn./Ext. Permit No. \_\_\_\_\_ Date \_\_\_\_\_

A Filing and Inspection Fee of \$ 150, plus an Entrance Fee of \$ \_\_\_\_\_ where applicable, must accompany this application.Bank# Bank of Fall River Check# 2622 Date 6/8/04 Receipt# 4912Other requirements: Insp. Only - Connect to 2" Force Main + install curb box + check valve @ property line. See attached planConnection made to Sewer Part of jointly-shared private line YES NO  
Storm Drain

Applicant agrees to abide by the above terms, as well as all pertinent ordinances of the City of New Bedford, and such other special rules as the Commissioner of Public Infrastructure and/or City Engineer may deem necessary

Quante M. Andrade ms  
Acting City EngineerX Robert J. Canessa  
Signature of Property Owner or Representative  
Robert Canessa

## INSPECTOR'S REPORT

INSPECTED BY: \_\_\_\_\_  
DATE: \_\_\_\_\_  
COMMENTS: \_\_\_\_\_

APPROVED

DISAPPROVED

SIGNATURE

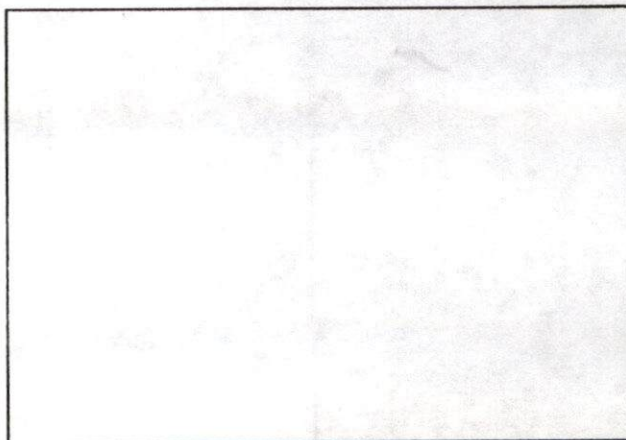

SKETCH PLAN



DAVID A. LEBLOUX  
J. J. A. LeRant authorizes Robert J.  
Conessa to Pull permits related to Permits  
for the sewer correction at 929 Maplewood St.  
J. J. A. LeRant  
5/28/04

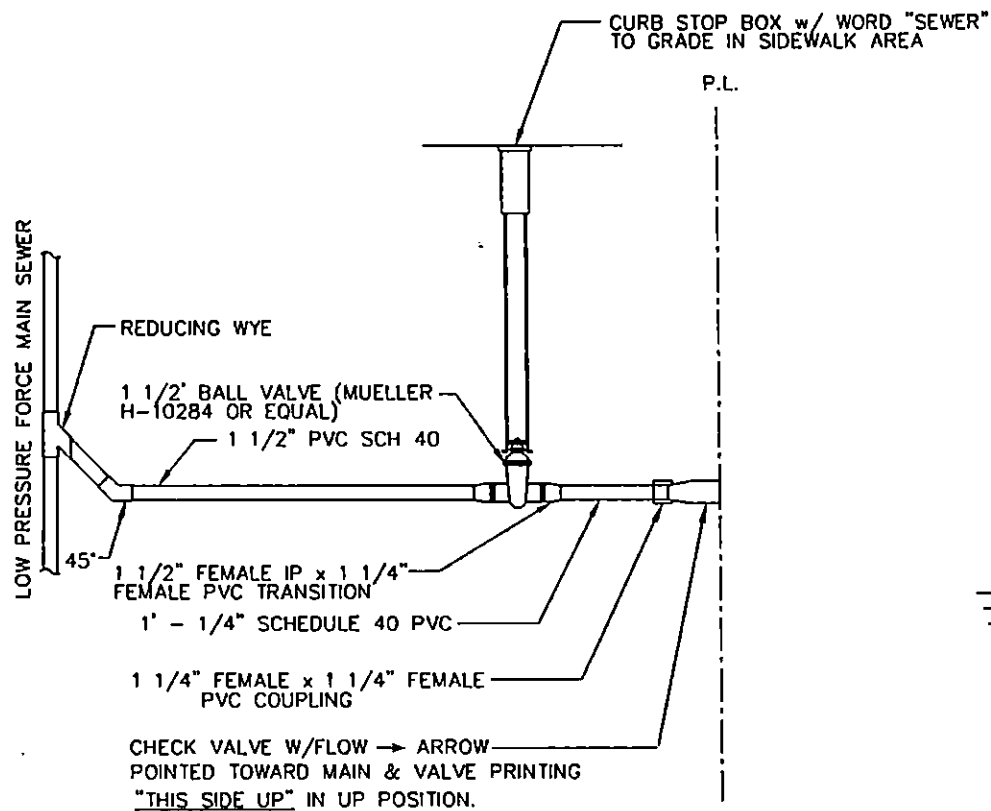

## LOW PRESURE SEWER CURB STOP

NOT TO SCALE

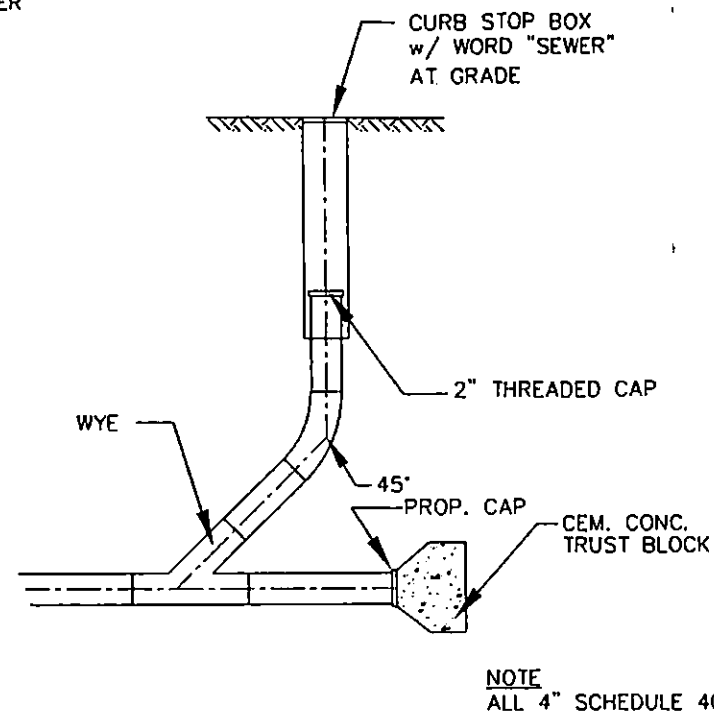

## SEWER CLEAN OUT

NOT TO SCALE



(57)

CLOUDY 60°  
6-10-04 THURSDAY

#929 MAPLEWOOD ST-SEWER WSP

PERMIT #23562

CONTRACTOR R J CANWESSA

500-763-4827

