



PERMIT NO.

23549

CITY OF NEW BEDFORD  
SEWER AND/OR STORM DRAIN PERMIT

DATE 5/4/04

EXP.

This certifies that permission is granted to

Property Owner Helena S. Pereira Address 934 Glen St. NB, MA Tel. 508-995-1697To connect a sewer and/or storm drain located at 934 Glen St.Assessor's Plot 130D Lot 87, to the sewer and/or storm drain in Glen St. Street

To be laid in accordance with the conditions in this application and the City of New Bedford ordinances.

TYPE OF USE: RESIDENTIAL COMMERCIAL INDUSTRIAL OTHER 220 GPD

If applicant other than actual property owner, attach Letter of Authorization from Property Owner.

Name Martin, Inc. (Richard Arruda) Tel. 508-673-8712Mailing Address 28 Sawdy Pond Ave. Fall River, MA 02721

The Bonded Contractor/Drain Layer authorized to perform this work is:

Martin, Inc. 28 Sawdy Pond Ave. Fall River, MA 508-673-8712

Name Address Tel.

Type of Pipe Required: PVC - SDR 2" L.P.

## PERMIT EXPIRES ONE YEAR AFTER DATE OF ISSUE

- Requires separate connections for sewage and storm drain where applicable. Storm water cannot be discharged to a sanitary sewer.
- All work must be inspected and approved by a D.P.I. inspector before backfilling.
- If this connection is to be part of a private service shared jointly with other building owners, attach copy of Recorded Joint Maintenance Agreement.
- Permits can be issued to Industrial and/or Commercial Applicants only upon receipt and approval by the Commissioner of Public Infrastructure of required plans and supplemental information.
- In addition, a City-issued Industrial User Discharge Permit and/or a Sewer Extension/Connection Permit issued by the Commonwealth of Massachusetts D.E.P. shall be required by the City for Industrial Discharge into the sewer system.

Industrial User Discharge Permit No. Date

Comm. Mass. Sewer Conn./Ext. Permit No. Date

A Filing and Inspection Fee of \$ 150, plus an Entrance Fee of \$ where applicable, must accompany this application.Bank# Fleet Check# 4884 Date 5/4/04 Receipt#Other requirements: Insp. Only - Connect to 2" Force Main - Stub at Property Line\$ 1,553.50 betterment fee to be waived (for the time) per Ron Labelle (MS)Connection made to Sewer Part of jointly-shared private line YES NO  
Storm Drain

Applicant agrees to abide by the above terms, as well as all pertinent ordinances of the City of New Bedford, and such other special rules as the Commissioner of Public Infrastructure and/or City Engineer may deem necessary

Diante M. Andrade (MS) Richard Arruda

City Engineer

Signature of Property Owner or Representative

Acting City Engineer

Richard Arruda

## INSPECTOR'S REPORT

INSPECTED BY: 203ADATE: 5/21/04

COMMENTS:

APPROVED

DISAPPROVED

SIGNATURE

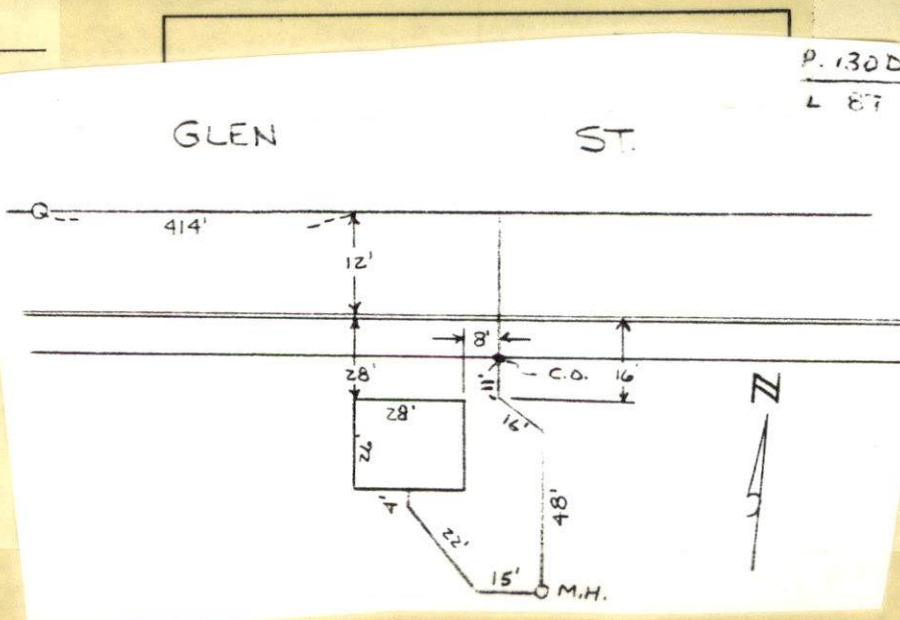





PERMIT NO.

23549

CITY OF NEW BEDFORD  
SEWER AND/OR STORM DRAIN PERMITDATE 5/4/04  
EXP.

This certifies that permission is granted to

Property Owner Helena S. Pereira Address 934 Glen St. NB, MA Tel. 508-995-1697To connect a sewer and/or storm drain located at 934 Glen St.Assessor's Plot 130D Lot 87, to the sewer and/or storm drain in Glen St. Street

To be laid in accordance with the conditions in this application and the City of New Bedford ordinances.

TYPE OF USE: RESIDENTIAL COMMERCIAL INDUSTRIAL OTHER 220 GPD

If applicant other than actual property owner, attach Letter of Authorization from Property Owner.

Name Martin, Inc. (Richard Arruda) Tel. 508-673-8712Mailing Address 28 Sandy Pond Ave. Fall River, MA 02721

The Bonded Contractor/Drain Layer authorized to perform this work is:

Martin, Inc. 28 Sandy Pond Ave. Fall River, MA 508-673-8712Name Martin, Inc. Address 28 Sandy Pond Ave. Fall River, MA Tel. 508-673-8712Type of Pipe Required: PVC - SDR 2" L.P.

## PERMIT EXPIRES ONE YEAR AFTER DATE OF ISSUE

- Requires separate connections for sewage and storm drain where applicable. Storm water cannot be discharged to a sanitary sewer.
  - All work must be inspected and approved by a D.P.I. inspector before backfilling.
  - If this connection is to be part of a private service shared jointly with other building owners, attach copy of Recorded Joint Maintenance Agreement.
  - Permits can be issued to Industrial and/or Commercial Applicants only upon receipt and approval by the Commissioner of Public Infrastructure of required plans and supplemental information.
  - In addition, a City-issued Industrial User Discharge Permit and/or a Sewer Extension/Connection Permit issued by the Commonwealth of Massachusetts D.E.P. shall be required by the City for Industrial Discharge into the sewer system.
- Industrial User Discharge Permit No. \_\_\_\_\_ Date \_\_\_\_\_

Comm. Mass. Sewer Conn./Ext. Permit No. \_\_\_\_\_ Date \_\_\_\_\_

A Filing and Inspection Fee of \$ 150, plus an Entrance Fee of \$ \_\_\_\_\_ where applicable, must accompany this application.Bank# Fleet Check# 4884 Date 5/4/04 Receipt# \_\_\_\_\_Other requirements: Insp Only - Connect to 2" Force Main - Stub at Property Line\$1,553.50 betterment fee to be waived (for the time) per Ron Labelle (MS)Connection made to Sewer Part of jointly-shared private line YES NO  
Storm Drain

Applicant agrees to abide by the above terms, as well as all pertinent ordinances of the City of New Bedford, and such other special rules as the Commissioner of Public Infrastructure and/or City Engineer may deem necessary

Duarte M. Andrade (MS)

City Engineer

Acting City Engineer

Richard Arruda  
Signature of Property Owner or Representative  
Richard Arruda

## INSPECTOR'S REPORT

INSPECTED BY: \_\_\_\_\_

DATE: \_\_\_\_\_

COMMENTS: \_\_\_\_\_

APPROVED

DISAPPROVED

SIGNATURE

SKETCH PLAN





# CITY OF NEW BEDFORD MASSACHUSETTS

Engineering Department, Rm. 303

133 William Street

New Bedford, Ma. 02740

Tel: 508-979-1527

Fax: 508-961-3043

Duarte M. Andrade,  
Acting City Engineer

To Whom It May Concern:

I Helena S Pereira 934 Glen St. New Bedford MA 02745, being  
(Name) (Mailing Address)

Owner of property located at 934 Glen Street

Plot 130-D, Lot \*87, hereby agree to allow Martin Inc.  
(Name)

\_\_\_\_\_, to act on my behalf including affixing my  
(Mailing Address)

signature in securing permit for:

☒ Sewer/Drain Service Permits  
☐ Water Service Permits  
☐ Driveway Installation Permits  
☐ Sidewalk Installation Permits

I further agree to conform to, and abide by, All City rules and ask regulations applicable to the permit (s) being applied for:

Name Helena S Pereira  
Signature

934 GLEN ST.  
Address

5/4/04 508-995-1697  
Date Telephone number

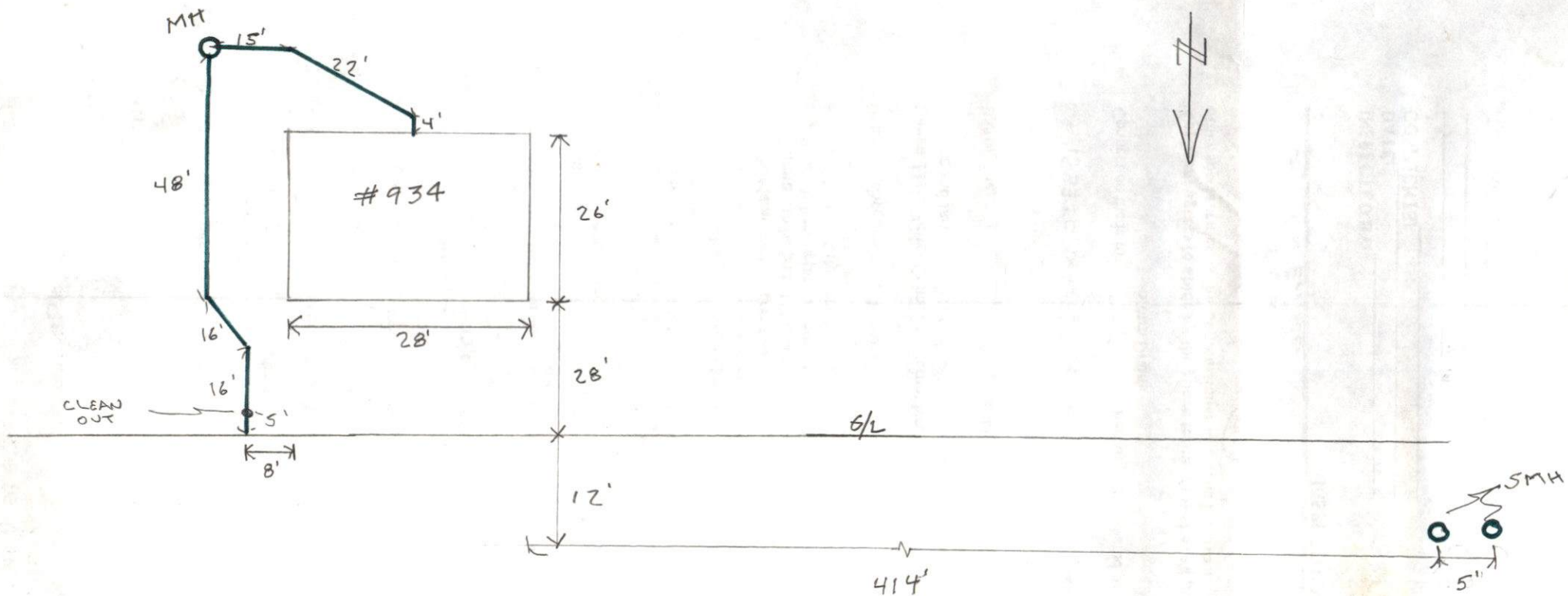

GLEN ST.

8' SW'S

NTS.

48' / 8' / 0.77

**Michele Avila-Silva**

---

**To:** Ronald Labelle  
**Subject:** 934 Glen Street Sewer Connection

Hi Ron,

I just issued the contractor the sewer permit for 934 Glen Street, per our telephone conversation the betterment fee of \$1,553.50 is being waived.

Duarte needs a letter from you stating the City is waiving this fee, so if you could please get that to me asap, I would really appreciate it.

Thanks,

Michele

23549



PERMIT NO.

23549

CITY OF NEW BEDFORD  
SEWER AND/OR STORM DRAIN PERMIT

DATE 5/4/04

EXP

This certifies that permission is granted to

Helena S. Pereira 931 Glen St NB MA 028-995-1697  
 Property Owner Address Tel.

To connect a sewer and/or storm drain located at 931 Glen St.Assessor's Plot 13052 Lot 87, to the sewer and/or storm drain in Glen St. Street

To be laid in accordance with the conditions in this application and the City of New Bedford ordinances.

TYPE OF USE: RESIDENTIAL COMMERCIAL INDUSTRIAL OTHER 220 6PD

If applicant other than actual property owner, attach Letter of Authorization from Property Owner.

Name Martin Inc. (Richard Arruda) Tel. 508-673-8712  
 Mailing Address 38 Sandy Pond Ave Fall River MA 02721  
 The Bonded Contractor/Drain Layer authorized to perform this work is:  
 Martin Inc. 38 Sandy Pond Ave Fall River MA 508-673-8712  
 Name Address Tel.  
 Type of Pipe Required: PVC - 500 2" L.P.

## PERMIT EXPIRES ONE YEAR AFTER DATE OF ISSUE

- Requires separate connections for sewage and storm drain where applicable. Storm water cannot be discharged to a sanitary sewer.
  - All work must be inspected and approved by a D.P.I. inspector before backfilling.
  - If this connection is to be part of a private service shared jointly with other building owners, attach copy of Recorded Joint Maintenance Agreement.
  - Permits can be issued to Industrial and/or Commercial Applicants only upon receipt and approval by the Commissioner of Public Infrastructure of required plans and supplemental information.
  - In addition, a City-issued Industrial User Discharge Permit and/or a Sewer Extension/Connection Permit issued by the Commonwealth of Massachusetts D.E.P. shall be required by the City for Industrial Discharge into the sewer system.
- Industrial User Discharge Permit No. \_\_\_\_\_ Date \_\_\_\_\_

Comm. Mass. Sewer Conn./Ext. Permit No. \_\_\_\_\_ Date \_\_\_\_\_  
 A Filing and Inspection Fee of \$150, plus an Entrance Fee of \$ \_\_\_\_\_ where applicable, must accompany this application.

Bank# Fleet Check# 4894 Date 5/4/04 Receipt#

Other requirements: Insp. Only - Connect to 2" Force Main - Stub at Property Line  
 \$1,553.50 betterment fee to be waived (for the time) per Ron Labella (ms)

Connection made to Sewer Part of jointly-shared private line YES NO  
 Storm Drain

Applicant agrees to abide by the above terms, as well as all pertinent ordinances of the City of New Bedford, and such other special rules as the Commissioner of Public Infrastructure and/or City Engineer may deem necessary

Richard M. Arruda (ms)  
 City Engineer  
 Acting City Engineer

Richard Arruda  
 Signature of Property Owner or Representative

## INSPECTOR'S REPORT

INSPECTED BY: \_\_\_\_\_  
 DATE: \_\_\_\_\_  
 COMMENTS: \_\_\_\_\_

APPROVED

DISAPPROVED

Inspection 5/21/04  
 10:00 A.M.

Martin Inc.  
 508-673-8712