

PERMIT NO.
23545

CITY OF NEW BEDFORD SEWER AND/OR STORM DRAIN PERMIT

DATE 4/23/04
EXP. 4/23/05

This certifies that permission is granted to

GEORGE SMITH 302 GARDNER ST. N.B. (508) 993 5192
Property Owner Address Tel.

To connect a sewer and/or storm drain located at 302 GARDNER ST.

Assessor's Plot 80 Lot 44 to the sewer and/or storm drain in GARDNER ST. (8" PVC) Street

To be laid in accordance with the conditions in this application and the City of New Bedford ordinances.

TYPE OF USE: RESIDENTIAL COMMERCIAL INDUSTRIAL OTHER 220 GPD

If applicant other than actual property owner, attach Letter of Authorization from Property Owner.

Name..... Tel.....

Mailing Address.....

The Bonded Contractor/Drain Layer authorized to perform this work is:
ANTOINE MEDEIROS 318 ALDEN RD FAIRHAVEN (508) 993-3609

[illegible]

Type of Pipe Required: SDR 35 PVC

PERMIT EXPIRES ONE YEAR AFTER DATE OF ISSUE

- Requires separate connections for sewage and storm drain where applicable. Storm water cannot be discharged to a sanitary sewer.
 - All work must be inspected and approved by a D.P.I. inspector before backfilling.
 - If this connection is to be part of a private service shared jointly with other building owners, attach copy of Recorded Joint Maintenance Agreement.
 - Permits can be issued to Industrial and/or Commercial Applicants only upon receipt and approval by the Commissioner of Public Infrastructure of required plans and supplemental information.
 - In addition, a City-issued Industrial User Discharge Permit is required from the Commonwealth of Massachusetts D.E.P. s
- Industrial User Discharge Permit No.
- P. 8*
L. 4
- 8" S.*
- SMH*
- P. 8*
L. 4

Comm. Mass. Sewer Conn./Ext. Permit No.....

A Filing and Inspection Fee of \$150.00, plus an

Bank# New Bedford Credit Union Check#

Other requirements: 24 hr. insp

Connection made to Sewer Part of
~~Storm Drain~~

Applicant agrees to abide by the above terms and other special rules as the Commissioner of L

Acting City Engineer

Signature of Property Owner or Representative

INSPECTOR'S REPORT

INSPECTED BY: KEN REBELLO

DATE: 3/22/06

COMMENTS:

APPROVED

DISAPPRO

Ken Kehl
SIGNATURE

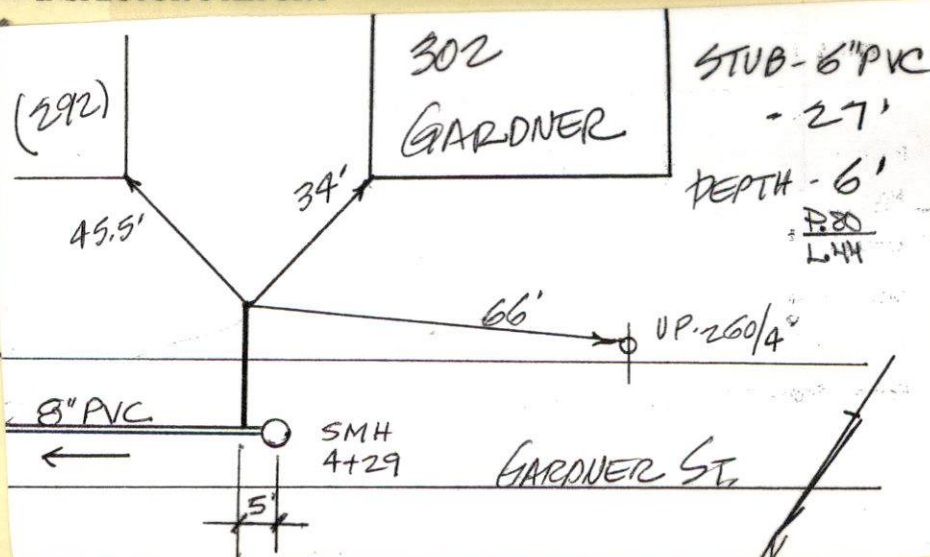

Mary T. Neves

From: Sarah Porter
Sent: Monday, March 13, 2006 5:08 PM
To: Mary T. Neves
Subject: RE: SEWER PERMIT

ok Mary they can hook up -
I am still waiting to here back from you/Duarte about the one on acuhstnet ave (permit # 23797)

-----Original Message-----

From: Mary T. Neves
Sent: Monday, March 13, 2006 11:37 AM
To: Sarah Porter
Subject: SEWER PERMIT

Hi Sarah,

The resident at 302 Gardner St. wants to tie into the sewer. We have a stub at plot 80 lot 44.

The permit was issued in 2004 but the work was not done. Can he commence?

Mary

3/22/06 - 302 GARDNER ST. - ANTONIO MEDEIROS

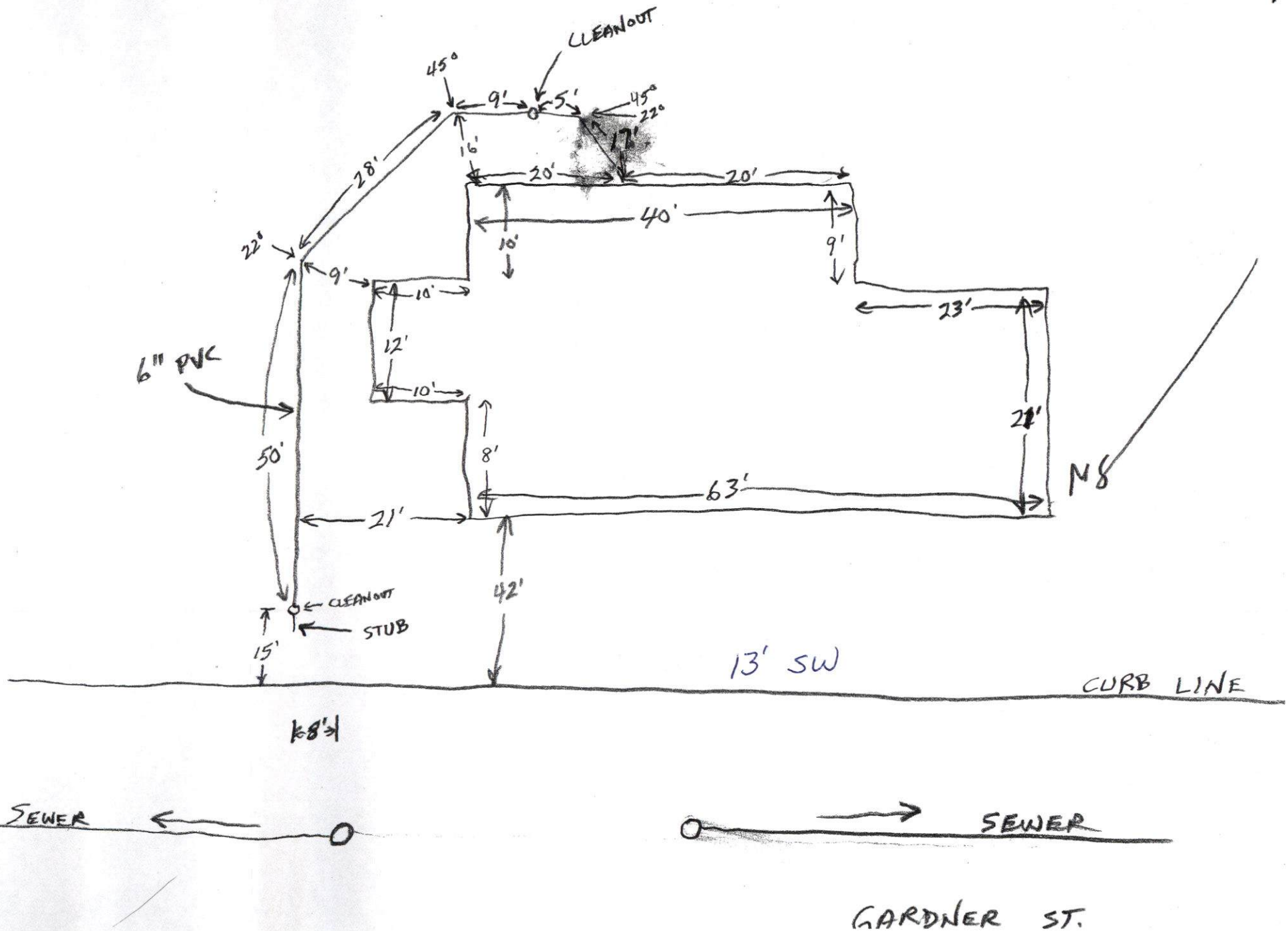



PERMIT NO.

23545

CITY OF NEW BEDFORD
SEWER AND/OR STORM DRAIN PERMIT

DATE 4/23/04

EXP. 4/23/05

extended to 4/30/06

This certifies that permission is granted to

GEORGE SMITH 302 GARDNER ST. N.B. (508) 993 5192
Property Owner Address Tel. d.a. / umm

To connect a sewer and/or storm drain located at 302 GARDNER ST.

Assessor's Plot 80 Lot 44, to the sewer and/or storm drain in GARDNER ST. (8" PVC) Street

To be laid in accordance with the conditions in this application and the City of New Bedford ordinances.

TYPE OF USE: RESIDENTIAL COMMERCIAL INDUSTRIAL OTHER 220 GPD

If applicant other than actual property owner, attach Letter of Authorization from Property Owner.

Name..... Tel.....

Mailing Address.....

The Bonded Contractor/Drain Layer authorized to perform this work is:

ANTONE MEDEIROS 318 ALDEN RD FAIRHAVEN (508) 993-3609

Name..... Address..... Tel.....

Type of Pipe Required: SDR 35 PVC

PERMIT EXPIRES ONE YEAR AFTER DATE OF ISSUE

- Requires separate connections for sewage and storm drain where applicable. Storm water cannot be discharged to a sanitary sewer.
- All work must be inspected and approved by a D.P.I. inspector before backfilling.
- If this connection is to be part of a private service shared jointly with other building owners, attach copy of Recorded Joint Maintenance Agreement.
- Permits can be issued to Industrial and/or Commercial Applicants only upon receipt and approval by the Commissioner of Public Infrastructure of required plans and supplemental information.
- In addition, a City-issued Industrial User Discharge Permit and/or a Sewer Extension/Connection Permit issued by the Commonwealth of Massachusetts D.E.P. shall be required by the City for Industrial Discharge into the sewer system.

Industrial User Discharge Permit No..... Date.....

Comm. Mass. Sewer Conn./Ext. Permit No..... Date.....

A Filing and Inspection Fee of \$150.00, plus an Entrance Fee of \$396.90 where applicable, must accompany this application.

Bank# New Bedford Credit Union Check# 3244 Date 4/23/04 Receipt# 4872

Other requirements: 24 hr inspection notice
Total \$546.90

Connection made to Sewer Part of jointly-shared private line YES NO
~~Storm Drain~~

Applicant agrees to abide by the above terms, as well as all pertinent ordinances of the City of New Bedford, and such other special rules as the Commissioner of Public Infrastructure and/or City Engineer may deem necessary

Acting City Engineer

Signature of Property Owner or Representative

INSPECTOR'S REPORT

INSPECTED BY: _____
DATE: _____
COMMENTS: _____

APPROVED _____ DISAPPROVED _____

SIGNATURE

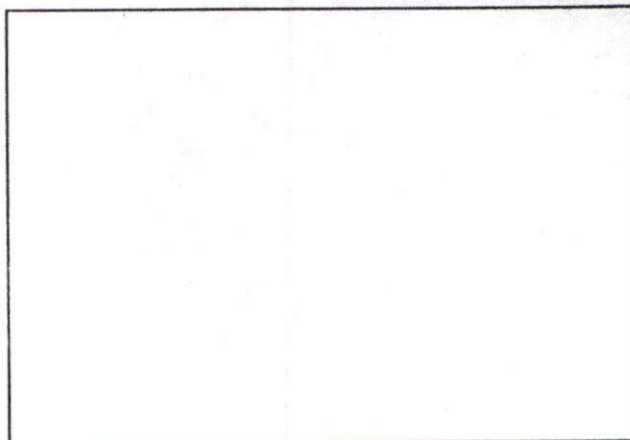

SKETCH PLAN