



PERMIT NO.
23513

CITY OF NEW BEDFORD
SEWER AND/OR STORM DRAIN PERMIT

DATE 1/9/04
EXP. 1/9/05

This certifies that permission is granted to

Paul DeBortoli 68 Duncan St. New Bedford (508) 863-3550
Property Owner Address Tel.

To connect a ^{1 1/2"} sewer and/or storm drain located at #957 McGee St. (480' ± E. of Acushnet Ave - Northside)

Assessor's Plot 130A Lot 596, to the ^{2"} sewer and/or storm drain in McGee St. (2" Force Main) Street

To be laid in accordance with the conditions in this application and the City of New Bedford ordinances.

TYPE OF USE: RESIDENTIAL COMMERCIAL INDUSTRIAL OTHER 330 GPD

If applicant other than actual property owner, attach Letter of Authorization from Property Owner.

Name N/A Tel.

Mailing Address

The Bonded Contractor/Drain Layer authorized to perform this work is:

W.C. Smith & Sons, Inc. 58 Ridgewood Rd. N.B. Tel. (508) 995-1449

Name Address Tel.

Type of Pipe Required: 1 1/2" PVC Force Main

PERMIT EXPIRES ONE YEAR AFTER DATE OF ISSUE

- Requires separate connections for sewage and storm drain where applicable. Storm water cannot be discharged to a sanitary sewer.
 - All work must be inspected and approved by a D.P.I. inspector before backfilling.
 - If this connection is to be part of a private service shared jointly with other building owners, attach copy of Recorded Joint Maintenance Agreement.
 - Permits can be issued to Industrial and/or Commercial Applicants only upon receipt and approval by the Commissioner of Public Infrastructure of required plans and supplemental information.
 - In addition, a City-issued Industrial User Discharge Permit and/or a Sewer Extension/Connection Permit issued by the Commonwealth of Massachusetts D.E.P. shall be required by the City for Industrial Discharge into the sewer system.
- Industrial User Discharge Permit No. Date

Comm. Mass. Sewer Conn./Ext. Permit No. Date

A Filing and Inspection Fee of \$150.00 plus an Entrance Fee of \$ where applicable, must accompany this application.

Bank# Check# Date Receipt#

Other requirements: Insp. Only - 1 1/2" PVC connect to 2" Force main on McGee St. Must call 24 hrs prior for inspection

Connection made to Sewer Part of jointly-shared private line YES NO Storm Drain

Applicant agrees to abide by the above terms, as well as all pertinent ordinances of the City of New Bedford, and such other special rules as the Commissioner of Public Infrastructure and/or City Engineer may deem necessary

City Engineer

Paul DeBortoli
Signature of Property Owner or Representative

INSPECTOR'S REPORT

INSPECTED BY: Kevin S. Coyle
DATE: 3-12-04
COMMENTS:

APPROVED DISAPPROVE

Kevin S. Coyle
SIGNATURE

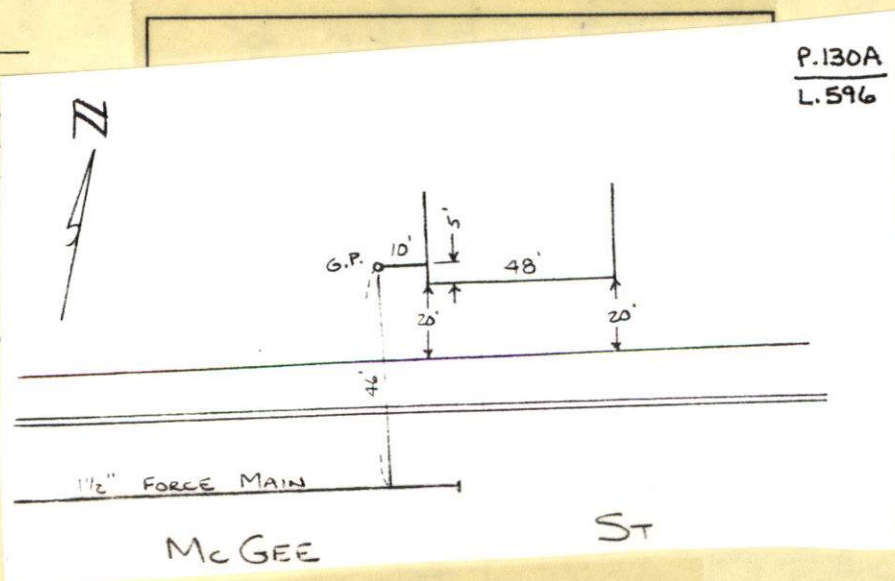

609

E

18534-68

22307-94

20757-83

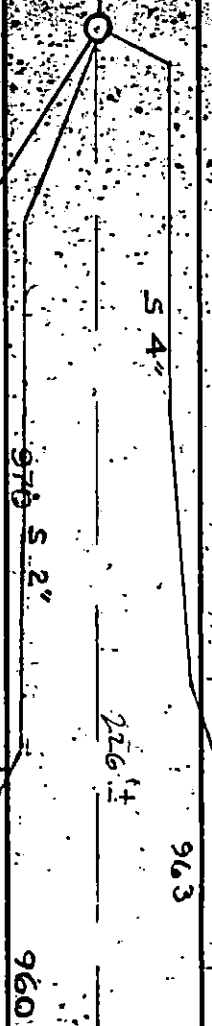



PERMIT NO.
23513

CITY OF NEW BEDFORD
SEWER AND/OR STORM DRAIN PERMIT

DATE 1/9/04
EXP. 1/9/05

This certifies that permission is granted to

Paul DeBortoli 68 Duncan St. New Bedford (508) 863-3550
Property Owner Address Tel.

To connect a 1 1/2" sewer and/or storm drain located at McGee St (480' E. of Acushnet Ave - Northside)

Assessor's Plot 130A Lot 596, to the 2" sewer and/or storm drain in McGee St (2" Force Main) Street

To be laid in accordance with the conditions in this application and the City of New Bedford ordinances.

TYPE OF USE: RESIDENTIAL COMMERCIAL INDUSTRIAL OTHER 330 GPD

If applicant other than actual property owner, attach Letter of Authorization from Property Owner.

Name N/A Tel. _____

Mailing Address _____

The Bonded Contractor/Drain Layer authorized to perform this work is:

W.C. Smith & Sons, Inc. 58 Ridgewood Rd. N.B.
Name Address Tel. (508) 995-1449

Type of Pipe Required: 1 1/2" PVC Force Main

PERMIT EXPIRES ONE YEAR AFTER DATE OF ISSUE

- Requires separate connections for sewage and storm drain where applicable. Storm water cannot be discharged to a sanitary sewer.
- All work must be inspected and approved by a D.P.I. inspector before backfilling.
- If this connection is to be part of a private service shared jointly with other building owners, attach copy of Recorded Joint Maintenance Agreement.
- Permits can be issued to Industrial and/or Commercial Applicants only upon receipt and approval by the Commissioner of Public Infrastructure of required plans and supplemental information.
- In addition, a City-issued Industrial User Discharge Permit and/or a Sewer Extension/Connection Permit issued by the Commonwealth of Massachusetts D.E.P. shall be required by the City for Industrial Discharge into the sewer system.

Industrial User Discharge Permit No. _____ Date _____

Comm. Mass. Sewer Conn./Ext. Permit No. _____ Date _____

A Filing and Inspection Fee of \$ 150.00, plus an Entrance Fee of \$ _____ where applicable, must accompany this application.

Bank# _____ Check# _____ Date _____ Receipt# _____

Other requirements: Inspection Only - 1 1/2" PVC connect to 2" Force main
on McGee St.
Must call 24 hrs prior for inspection

Connection made to Sewer Part of jointly-shared private line YES NO
Storm Drain

Applicant agrees to abide by the above terms, as well as all pertinent ordinances of the City of New Bedford, and such other special rules as the Commissioner of Public Infrastructure and/or City Engineer may deem necessary

[Signature]
City Engineer

Paul DeBortoli
Signature of Property Owner or Representative

INSPECTOR'S REPORT

INSPECTED BY: _____

DATE: _____

COMMENTS: _____

APPROVED

DISAPPROVED

SIGNATURE

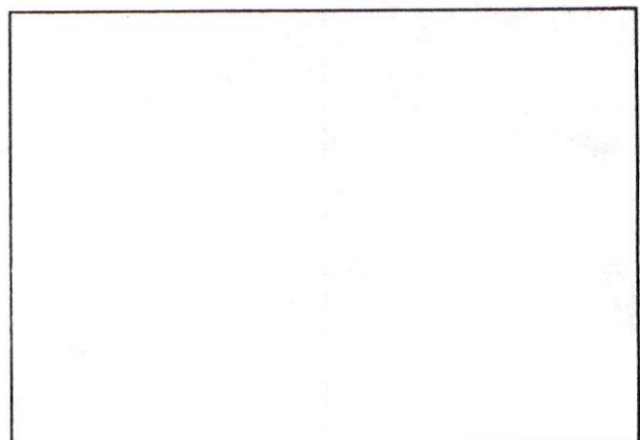

SKETCH PLAN