



PERMIT NO.

23493

CITY OF NEW BEDFORD
SEWER AND/OR STORM DRAIN PERMIT

DATE 11/4/03

EXP. 11/4/04

This certifies that permission is granted to

Long Realty, Inc. 158 Charles McCombs Blvd NB, MA 508-995-8240
Property Owner Address Tel.

To connect a sewer and/or storm drain located at 58 Katelyn Way (ss) 130' W x Lauren Dr.

Assessor's Plot 132 J Lot 61, to the sewer and/or storm drain in Katelyn Way Street

To be laid in accordance with the conditions in this application and the City of New Bedford ordinances.

TYPE OF USE: RESIDENTIAL COMMERCIAL INDUSTRIAL OTHER 330 GPD

If applicant other than actual property owner, attach Letter of Authorization from Property Owner.

Name Atty. Chip Mulford Tel. 508-995-8240

Mailing Address P.O. Box 817 Fairhaven MA

The Bonded Contractor/Drain Layer authorized to perform this work is:

DW White 817 Middle Rd Acushnet, MA 508-763-8868
Name Address Tel.

Type of Pipe Required: PVC SDR-35

PERMIT EXPIRES ONE YEAR AFTER DATE OF ISSUE

- Requires separate connections for sewage and storm drain where applicable. Storm water cannot be discharged to a sanitary sewer.
 - All work must be inspected and approved by a D.P.I. inspector before backfilling.
 - If this connection is to be part of a private service shared jointly with other building owners, attach copy of Recorded Joint Maintenance Agreement.
 - Permits can be issued to Industrial and/or Commercial Applicants only upon receipt and approval by the Commissioner of Public Infrastructure of required plans and supplemental information.
 - In addition, a City-issued Industrial User Discharge Permit and/or a Sewer Extension/Connection Permit issued by the Commonwealth of Massachusetts D.E.P. shall be required by the City for Industrial Discharge into the sewer system.
- Industrial User Discharge Permit No. Date

Comm. Mass. Sewer Conn./Ext. Permit No. Date

A Filing and Inspection Fee of \$150, plus an Entrance Fee of \$..... where applicable, must accompany this application.

Bank# Compass Bank Check# 31811 Date 11/4/03 Receipt# 4776

Other requirements: Insp. Only - Connect to 10" Sewer + 18" Storm Drain
To be built according to Approved Subdivision PlansConnection made to Sewer Part of jointly-shared private line YES NO
Storm Drain

Applicant agrees to abide by the above terms, as well as all pertinent ordinances of the City of New Bedford, and such other special rules as the Commissioner of Public Infrastructure and/or City Engineer may deem necessary

Duarte M. Andrade (ms)
City EngineerSignature of Property Owner or Representative
Atty. Chip Mulford

INSPECTOR'S REPORT

INSPECTED BY: _____

DATE: _____

COMMENTS: _____

APPROVED _____

DI: _____

SIGNATURE _____

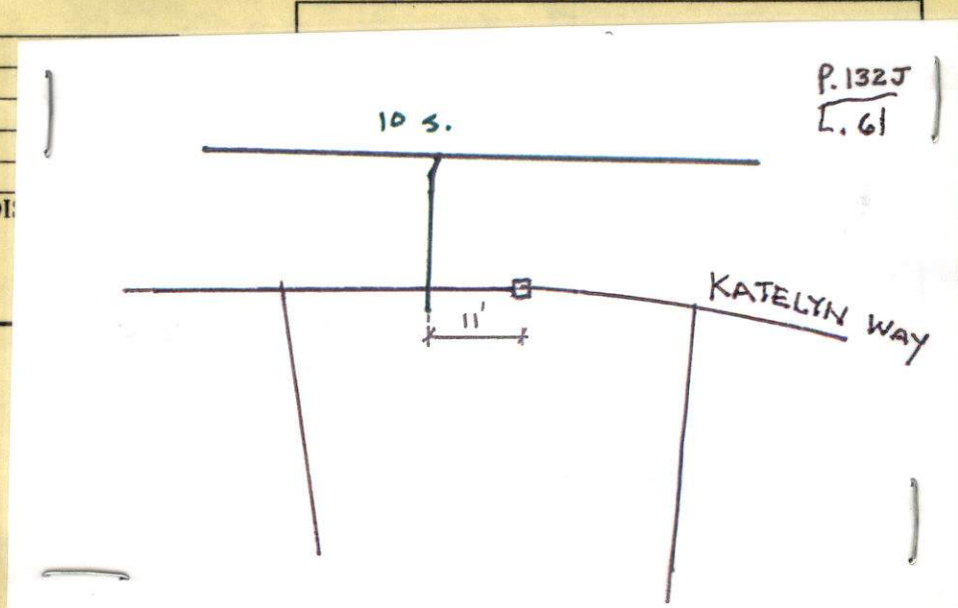



PERMIT NO.

23493

CITY OF NEW BEDFORD
SEWER AND/OR STORM DRAIN PERMIT

DATE 11/4/03

EXP. 11/4/04

This certifies that permission is granted to

Long Realty, Inc. 158 Charles McCombs Blvd NB, MA 508-995-8240
Property Owner Address Tel.

To connect a sewer and/or storm drain located at 58 Katelyn Way (ss) 130' W x Lauren Dr

Assessor's Plot 132 J Lot 41, to the sewer and/or storm drain in Katelyn Way Street

To be laid in accordance with the conditions in this application and the City of New Bedford ordinances.

TYPE OF USE: RESIDENTIAL COMMERCIAL INDUSTRIAL OTHER 330 GPD

If applicant other than actual property owner, attach Letter of Authorization from Property Owner.

Name Atty. Chip Mulford Tel. 508-995-8240

Mailing Address PO Box 817 Fairhaven MA

The Bonded Contractor/Drain Layer authorized to perform this work is:

DW White 867 Middle Rd Acushnet, MA 508-763-8868

Name Address Tel.

Type of Pipe Required: PVC SDR-35

PERMIT EXPIRES ONE YEAR AFTER DATE OF ISSUE

- Requires separate connections for sewage and storm drain where applicable. Storm water cannot be discharged to a sanitary sewer.
- All work must be inspected and approved by a D.P.I. inspector before backfilling.
- If this connection is to be part of a private service shared jointly with other building owners, attach copy of Recorded Joint Maintenance Agreement.
- Permits can be issued to Industrial and/or Commercial Applicants only upon receipt and approval by the Commissioner of Public Infrastructure of required plans and supplemental information.
- In addition, a City-issued Industrial User Discharge Permit and/or a Sewer Extension/Connection Permit issued by the Commonwealth of Massachusetts D.E.P. shall be required by the City for Industrial Discharge into the sewer system.

Industrial User Discharge Permit No. Date

Comm. Mass. Sewer Conn./Ext. Permit No. Date

A Filing and Inspection Fee of \$150, plus an Entrance Fee of \$ where applicable, must accompany this application.

Bank# Compass Bank Check# 31811 Date 11/4/03 Receipt# 4776

Other requirements: Insp. Only - Connect to 10" Sewer + 18" Storm Drain
To be built according to Approved Subdivision Plans

Connection made to Sewer Storm Drain Part of jointly-shared private line YES NO

Applicant agrees to abide by the above terms, as well as all pertinent ordinances of the City of New Bedford, and such other special rules as the Commissioner of Public Infrastructure and/or City Engineer may deem necessary

Duarte M. Andrade City Engineer

Signature of Property Owner or Representative
Atty. Chip Mulford

INSPECTOR'S REPORT

INSPECTED BY: DATE: COMMENTS:

APPROVED DISAPPROVED

SIGNATURE

SKETCH PLAN



"Long" on Quality

A Division of Long Realty Inc.

(508) 995-8240 158 CHARLES MCCOMBS BOULEVARD, NEW BEDFORD, MA 02745 FAX: (508) 995-3275

July 14, 2003

Mr. Duarte Andrade
Acting Chief Engineer
Engineering Department
City of New Bedford
133 William Street
New Bedford, MA 02740

Re: Authorization of Agent

Dear Mr. Andrade:

This letter will confirm that Chip Mulford, Long Realty Inc./Long Built Homes' Corporate Attorney, is authorized to act on the Corporation's behalf, including affixing its Corporate signature, when applying for and securing permits from your Department, including but not limited to the following:

1. Sewer/Drain Service Permits;
2. Water Service Permits;
3. Driveway Installation Permits; and
4. Sidewalk Installation Permits.

Long Realty Inc./Long Built Homes, acting through Mr. Mulford, its Agent, agrees to conform to and abide by all City rules and regulations applicable to any permits being applied for.

Thank you in advance for your cooperation.

Sincerely,

Long Realty Inc./Long Built Homes

By: 
Robert F. Long
President & Treasurer

158 Charles McCombs Boulevard
New Bedford, MA 02745
(508) 995-8240



CITY OF NEW BEDFORD

645

NO. 2030-03

LICENSE NO. _____

DATE 11-4 2003

FOUNDATION PERMIT

MSBC Sect. 111.8 – Any permit issued shall be deemed abandoned and invalid unless the work authorized by it shall have been commenced within six (6) months after its issuance.

This certifies that LONG BUILT, owner/contractor
has permission to FOUND.
on #58 KATELYN Wy. LOT 61 (ss) 130' W x Lauren Dr.
providing that the person accepting this permit shall in every respect conform to the terms of the application therefor on file in this office; to the provisions of the Statute of the Commonwealth and to the By-Laws of the City of New Bedford relating to the Inspection, Erection, Enlarging, Altering, Raising, Moving, Repairing or Tearing Down of a Building.

WIRING INSPECTOR

PLUMBING INSPECTOR

BUILDING INSPECTOR

YOUR AREA INSPECTOR IS: _____

– Tel. 979-1540 Between 8:00 AM – 9:00 AM

NOTICE: NOTIFY INSPECTOR 48 HOURS
IN ADVANCE OF APPLYING
SHEATING OR LATHING

OCCUPANCY PERMIT REQUIRED BEFORE OCCUPANCY

No Building or Structure shall be used or occupied until the Certificate of Use and Occupancy shall have been issued by the Building Commissioner – MSBC. Sect. 120.1 – N.B. Zoning Ord. Sect. 9-269

THIS CARD MUST BE DISPLAYED IN A CONSPICUOUS PLACE ON THE PREMISES
AND NOT TORN DOWN OR REMOVED UNTIL COMPLETION OF WORK

SUBJECT TO MASSACHUSETTS STATE
BUILDING CODE REQUIREMENTS

R. Brown