



PERMIT NO.

23482

CITY OF NEW BEDFORD  
SEWER AND/OR STORM DRAIN PERMITDATE 10/15/03  
EXP. 10/15/04

This certifies that permission is granted to

Property Owner LONG REALTY, INC. Address 158 CHARLES McCOMBS BLVD, NB MA 01901-824 Tel. 508-995-824To connect a sewer and/or storm drain located at Katelyn Way (SS) 50' Wx Lauren DriveAssessor's Plot 132J Lot 60, to the sewer and/or storm drain in Katelyn Way Street

To be laid in accordance with the conditions in this application and the City of New Bedford ordinances.

TYPE OF USE: RESIDENTIAL COMMERCIAL INDUSTRIAL OTHER 330 GPD

If applicant other than actual property owner, attach Letter of Authorization from Property Owner.

Name Atty. Chip Mulford Tel. \_\_\_\_\_Mailing Address PO Box 817 Fairhaven, MA

The Bonded Contractor/Drain Layer authorized to perform this work is:

DW White 867 Middle St. Acushnet, MA 508-763-8868

Name \_\_\_\_\_ Address \_\_\_\_\_ Tel. \_\_\_\_\_

Type of Pipe Required: PVC SDR-35

## PERMIT EXPIRES ONE YEAR AFTER DATE OF ISSUE

- Requires separate connections for sewage and storm drain where applicable. Storm water cannot be discharged to a sanitary sewer.
- All work must be inspected and approved by a D.P.I. inspector before backfilling.
- If this connection is to be part of a private service shared jointly with other building owners, attach copy of Recorded Joint Maintenance Agreement.
- Permits can be issued to Industrial and/or Commercial Applicants only upon receipt and approval by the Commissioner of Public Infrastructure of required plans and supplemental information.
- In addition, a City-issued Industrial User Discharge Permit and/or a Sewer Extension/Connection Permit issued by the Commonwealth of Massachusetts D.E.P. shall be required by the City for Industrial Discharge into the sewer system.

Industrial User Discharge Permit No. \_\_\_\_\_ Date \_\_\_\_\_

Comm. Mass. Sewer Conn./Ext. Permit No. \_\_\_\_\_ Date \_\_\_\_\_

A Filing and Inspection Fee of \$150.00, plus an Entrance Fee of \$\_\_\_\_\_ where applicable, must accompany this application.

Bank# Compass Bank Check# 31514 Date 10/15/03 Receipt# 4758Other requirements: Insp. Only - Connect to 10" Sewer + 24" Storm DrainTo be built according to Approved Subdivision PlansConnection made to Sewer Part of jointly-shared private line YES NO  
Storm Drain

Applicant agrees to abide by the above terms, as well as all pertinent ordinances of the City of New Bedford, and such other special rules as the Commissioner of Public Infrastructure and/or City Engineer may deem necessary

Duarte M. Andrade  
ACTING City EngineerChip Mulford  
Signature of Property Owner or Representative  
Atty. Chip Mulford

## INSPECTOR'S REPORT

INSPECTED BY: \_\_\_\_\_  
DATE: \_\_\_\_\_  
COMMENTS: \_\_\_\_\_

APPROVED \_\_\_\_\_ DI \_\_\_\_\_

SIGNATURE

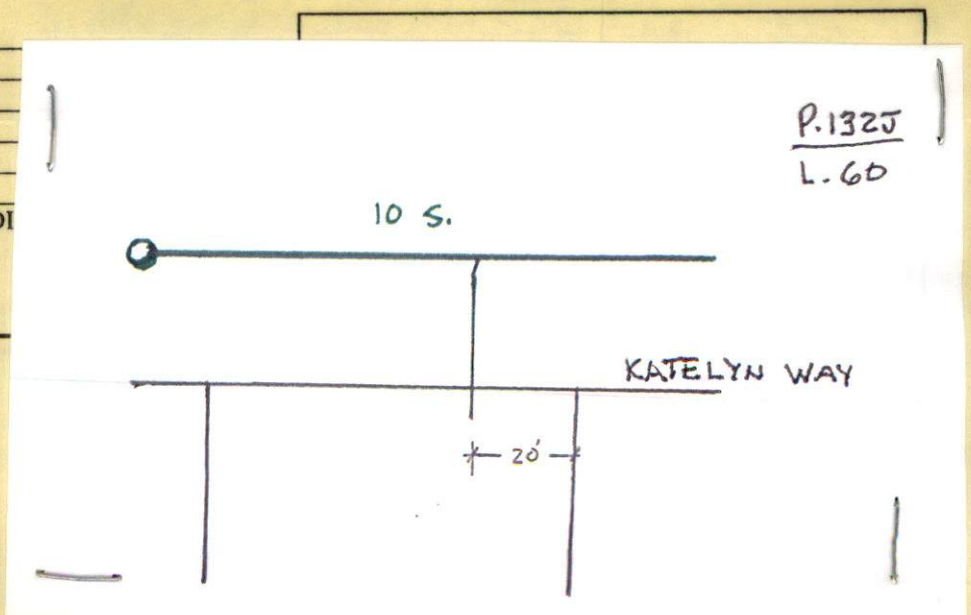

PERMIT NO.

23482

CITY OF NEW BEDFORD  
SEWER AND/OR STORM DRAIN PERMIT

DATE 10/15/03  
EXP. 10/15/04

This certifies that permission is granted to

LONG REALTY, INC. 158 CHARLES McCombs Bldg, NB, MA 508-995-824  
Property Owner Address Tel.

To connect a sewer and/or storm drain located at Katelyn Way (ss) 50' Wx Lauren Drive

Assessor's Plot 132J Lot 60, to the sewer and/or storm drain in Katelyn Way Street

To be laid in accordance with the conditions in this application and the City of New Bedford ordinances.

TYPE OF USE: RESIDENTIAL COMMERCIAL INDUSTRIAL OTHER 330 SPD

If applicant other than actual property owner, attach Letter of Authorization from Property Owner.

Name Atty. Chip Mulford Tel.

Mailing Address PO Box 817 Fairhaven, MA

The Bonded Contractor/Drain Layer authorized to perform this work is:

Dw. White 867 Middle St Acushnet, MA 508-763-8868

Name Address Tel.

Type of Pipe Required: PVC SDR-35

PERMIT EXPIRES ONE YEAR AFTER DATE OF ISSUE

- Requires separate connections for sewage and storm drain where applicable. Storm water cannot be discharged to a sanitary sewer.
- All work must be inspected and approved by a D.P.I. inspector before backfilling.
- If this connection is to be part of a private service shared jointly with other building owners, attach copy of Recorded Joint Maintenance Agreement.
- Permits can be issued to Industrial and/or Commercial Applicants only upon receipt and approval by the Commissioner of Public Infrastructure of required plans and supplemental information.
- In addition, a City-issued Industrial User Discharge Permit and/or a Sewer Extension/Connection Permit issued by the Commonwealth of Massachusetts D.E.P. shall be required by the City for Industrial Discharge into the sewer system.

Industrial User Discharge Permit No. Date.

Comm. Mass. Sewer Conn./Ext. Permit No. Date.

A Filing and Inspection Fee of \$150.00, plus an Entrance Fee of \$ where applicable, must accompany this application.

Bank# Compass Bank Check# 31514 Date 10/15/03 Receipt# 4758

Other requirements: Insp. Only - Connect to 10" Sewer + 24" Storm Drain

To be built according to Approved Subdivision Plans

Connection made to Sewer Part of jointly-shared private line YES NO  
Storm Drain

Applicant agrees to abide by the above terms, as well as all pertinent ordinances of the City of New Bedford, and such other special rules as the Commissioner of Public Infrastructure and/or City Engineer may deem necessary

Duarte M. Andrade  
ACTING City Engineer

Signature of Property Owner or Representative  
Atty. Chip Mulford

INSPECTOR'S REPORT

INSPECTED BY:

DATE:

COMMENTS:

APPROVED

DISAPPROVED

SIGNATURE

SKETCH PLAN



"Long" on Quality

A Division of Long Realty Inc.

(508) 995-8240 158 CHARLES MCCOMBS BOULEVARD, NEW BEDFORD, MA 02745 FAX: (508) 995-3275

July 14, 2003

Mr. Duarte Andrade  
Acting Chief Engineer  
Engineering Department  
City of New Bedford  
133 William Street  
New Bedford, MA 02740

Re: Authorization of Agent

Dear Mr. Andrade:

This letter will confirm that Chip Mulford, Long Realty Inc./Long Built Homes' Corporate Attorney, is authorized to act on the Corporation's behalf, including affixing its Corporate signature, when applying for and securing permits from your Department, including but not limited to the following:

1. Sewer/Drain Service Permits;
2. Water Service Permits;
3. Driveway Installation Permits; and
4. Sidewalk Installation Permits.

Long Realty Inc./Long Built Homes, acting through Mr. Mulford, its Agent, agrees to conform to and abide by all City rules and regulations applicable to any permits being applied for.

Thank you in advance for your cooperation.

Sincerely,

Long Realty Inc./Long Built Homes

By:

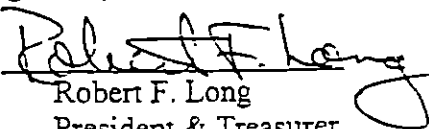
  
Robert F. Long  
President & Treasurer

158 Charles McCombs Boulevard  
New Bedford, MA 02745  
(508) 995-8240