

23459

**CITY OF NEW BEDFORD
SEWER AND/OR STORM DRAIN PERMIT**

DATE 9-16-03

This certifies that permission is granted to

John Mace	381 Dartmouth St.	NB	508-904-1964
Property Owner	Address	Tel.	

To connect a sewer and/or storm drain located at: Matthew St. side

Assessor's Plot 22 Lot 170, to the sewer and/or storm drain in ~~the~~ Matthew Street

To be laid in accordance with the conditions in this application and the City of New Bedford ordinances.

TYPE OF USE: RESIDENTIAL ☒ COMMERCIAL ☐ INDUSTRIAL ☐ OTHER ☐ 200 gpd

If applicant other than actual property owner, attach Letter of Authorization from Property Owner.

Name.....Tel.....

Mailing Address.....

The Bonded Contractor/Drain Layer authorized to perform this work is: 7634827

R. J. Canessa Exc. PO Box 51643 NB 508 ~~9939508~~

Name	Address	Tel.
------	---------	------

Type of Pipe Required: SDR 35 PVC

PERMIT EXPIRES ONE YEAR AFTER DATE OF ISSUE 9.16.04

- Requires separate connections for sewage and storm drain where applicable. Storm water cannot be discharged to a sanitary sewer.
- All work must be inspected and approved by a D.P.I. inspector before backfilling.
- If this connection is to be part of a private service shared jointly with other building owners, attach copy of Recorded Joint Maintenance Agreement.
- Permits can be issued to Industrial and/or Commercial Applicants only upon receipt and approval by the Commissioner of Public Infrastructure of required plans and supplemental information.
- In addition, a City-issued Industrial User Discharge Permit and/or a Sewer Extension/Connection Permit issued by the Commonwealth of Massachusetts D.E.P. shall be required by the City for Industrial Discharge into the sewer system.

Industrial User Discharge Permit No. Date.

Comm. Mass. Sewer Conn./Ext. Permit No. Date

A Filing and Inspection Fee of \$150.00, plus an Entrance Fee of \$..... where applicable, must accompany this application.

Bank# First Fed Check# 1144 Date 9/16/03 Receipt# 4726

Other requirements: 24 hr. inspection notice. Cannot remove curbing

Connecting to 10" sewer

Connection made to Sewer Part of jointly-shared private line YES NO
Storm Drain

Applicant agrees to abide by the above terms, as well as all pertinent ordinances of the City of New Bedford, and such other special rules as the Commissioner of Public Infrastructure and/or City Engineer may deem necessary

Duarte M. Andrade
 City Engineer

Signature of Property Owner or Representative

INSPECTOR'S REPORT

INSPECTED BY: KEVIN CORNWELL

DATE: 9-30-03

COMMENTS:

☒ APPROVED ☐ DISAPPROVED

Kevin S. Cook
SIGNATURE

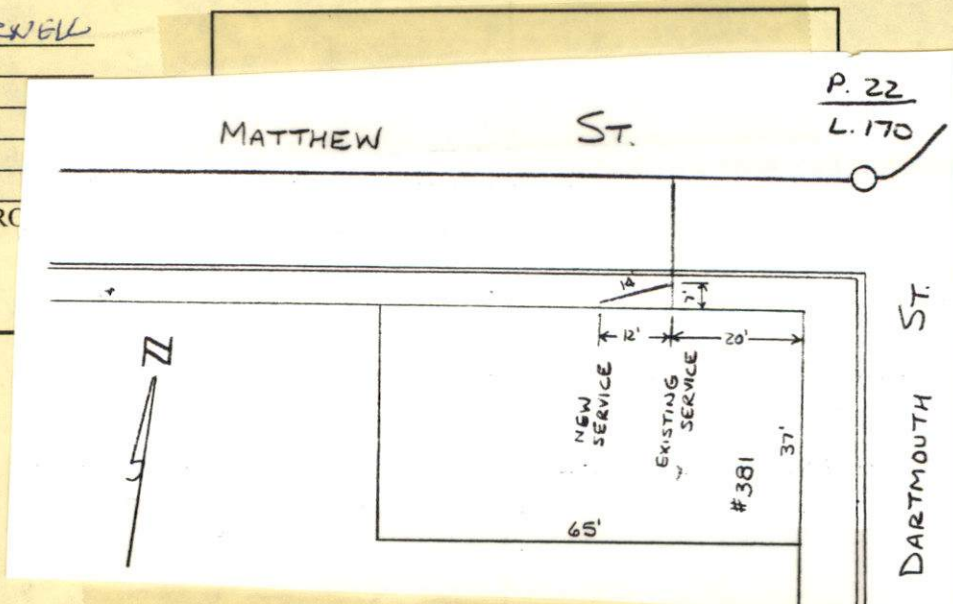



PERMIT NO.

23459

CITY OF NEW BEDFORD
SEWER AND/OR STORM DRAIN PERMIT

DATE 9-16-03

This certifies that permission is granted to

John Mace 381 Dartmouth St. NB 508-904-1964
Property Owner Address Tel.

To connect a sewer and/or storm drain located at Matthew St.

Assessor's Plot 22 Lot 170, to the sewer and/or storm drain in Matthew Street

To be laid in accordance with the conditions in this application and the City of New Bedford ordinances.

TYPE OF USE: RESIDENTIAL ☒ COMMERCIAL INDUSTRIAL OTHER 200 gpd

If applicant other than actual property owner, attach Letter of Authorization from Property Owner.

Name..... Tel.....

Mailing Address.....

The Bonded Contractor/Drain Layer authorized to perform this work is:

R. J. Canessa Exc. P.O. Box 51643 NB 508.99.39508

Name Address Tel.

Type of Pipe Required: SDR 35 PVC

PERMIT EXPIRES ONE YEAR AFTER DATE OF ISSUE 9-16-04

- Requires separate connections for sewage and storm drain where applicable. Storm water cannot be discharged to a sanitary sewer.
 - All work must be inspected and approved by a D.P.I. inspector before backfilling.
 - If this connection is to be part of a private service shared jointly with other building owners, attach copy of Recorded Joint Maintenance Agreement.
 - Permits can be issued to Industrial and/or Commercial Applicants only upon receipt and approval by the Commissioner of Public Infrastructure of required plans and supplemental information.
 - In addition, a City-issued Industrial User Discharge Permit and/or a Sewer Extension/Connection Permit issued by the Commonwealth of Massachusetts D.E.P. shall be required by the City for Industrial Discharge into the sewer system.
- Industrial User Discharge Permit No..... Date.....

Comm. Mass. Sewer Conn./Ext. Permit No..... Date.....

A Filing and Inspection Fee of \$150.00 plus an Entrance Fee of \$..... where applicable, must accompany this application.

Bank# First Fed Check# 1144 Date 9/16/03 Receipt# 4726

Other requirements: 24 hr. inspection notice. Cannot remove curbing

Connecting to 10" sewer

Connection made to ☒ Sewer ☐ Storm Drain
Part of jointly-shared private line YES ☒ NO

Applicant agrees to abide by the above terms, as well as all pertinent ordinances of the City of New Bedford, and such other special rules as the Commissioner of Public Infrastructure and/or City Engineer may deem necessary

Quarte M. Andrade
City Engineer mn

Signature of Property Owner or Representative

INSPECTOR'S REPORT

INSPECTED BY: _____

DATE: _____

COMMENTS: _____

APPROVED

DISAPPROVED

SIGNATURE

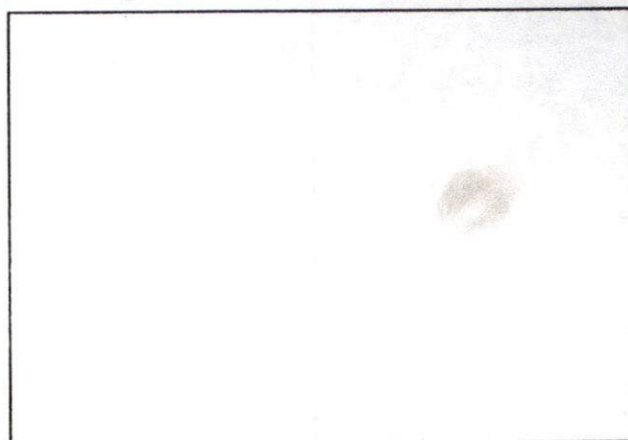

SKETCH PLAN

11487-22 Abandon Sewer Service

9-30-03 SUNNY 70

#381 DARTMOUTH ST
SEWER INSPECTION
① MATHEW ST

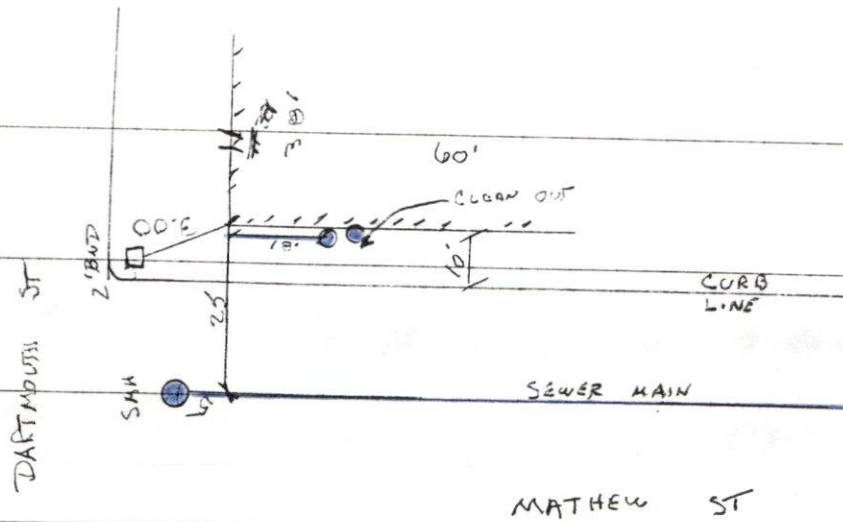

MATHEW ST