

23434 NO SKETCH



SEWER AND/OR STORM DRAIN PERMIT

This certifies that permission is granted to

Long Realty Inc. 158 Chas. McLomb's Blvd. NB 508-995-8240.
 Property Owner Address Tel.

to connect a sewer and/or storm drain located at Katelyn Way
 Assessor's Plot 132 J., Lot 79, to the sewer and/or storm drain in Katelyn Way Street
 to be laid in accordance with the conditions in this application and the City of New Bedford ordinances.

TYPE OF USE: ☒ RESIDENTIAL ☐ COMMERCIAL ☐ INDUSTRIAL ☐ OTHER

330 gpd

If applicant other than actual property owner, attach Letter of Authorization from Property Owner.

Name Ralph Mulford Tel. 508-995-8240

Mailing Address P.O. Box 817 Fairhaven, Ma. 02719

The Bonded Contractor/Drain Layer authorized to perform this work is:

D.W. White Const. Inc. 867 Middle Rd. Acushnet 508-763-8868
 Name Address Tel.

Type of Pipe Required: pvc sdr 35

PERMIT EXPIRES ONE YEAR AFTER DATE OF ISSUE 8-12-04

- * Requires separate connections for sewage and storm drain where applicable. Storm water cannot be discharged to a sanitary sewer.
- * All work must be inspected and approved by a D.P.W. inspector before backfilling.
- * If this connection is to be part of a private service shared jointly with other building owners, attach copy of Recorded Joint Maintenance Agreement.
- * Permits can be issued to Industrial and/or Commercial Applicants only upon receipt and approval by the Commissioner of Public Works of required plans and supplemental information.
- * In addition, a City-issued Industrial User Discharge Permit and/or a Sewer Extension/Connection Permit issued by the Commonwealth of Massachusetts D.E.P. shall be required by the City for Industrial Discharge into the sewer system.

Industrial User Discharge Permit No. Date

Comm. Mass. Sewer Conn./Ext. Permit No. Date

A Filing and Inspection Fee of \$150.00 plus an Entrance Fee of \$... where applicable, must accompany this application.

Bank # Compass Check # Date: 8/1/03 Receipt #

Other requirements: inspection only - per subdivision plans connecting to
 2.4" storm drain + 10" sanitary drain

☒ Sewer

Connection made to

☒ Storm Drain

Part of jointly-shared private line ☐ Yes ☒ No

FOR INSPECTION ONLY, A 24 HOUR
 NOTICE IS REQUIRED AND THE
 CONTRACTOR/APPLICANT IS
 REQUIRED TO NOTIFY THE
 ENGINEERING DIVISION AT 979-1527

Applicant agrees to abide by the above terms, as well as all pertinent ordinances of the City of New Bedford, and such other special rules as the Commissioner of Public Works may deem necessary

Duarte M. Andrade
 Acting City Engineer mn

Chip Purford
 Signature of Property Owner or Representative
 Amy 1st Rep

INSPECTED BY:

DATE:

COMMENTS:

☐ APPROVED ☐ DISAPPROVED

SIGNATURE

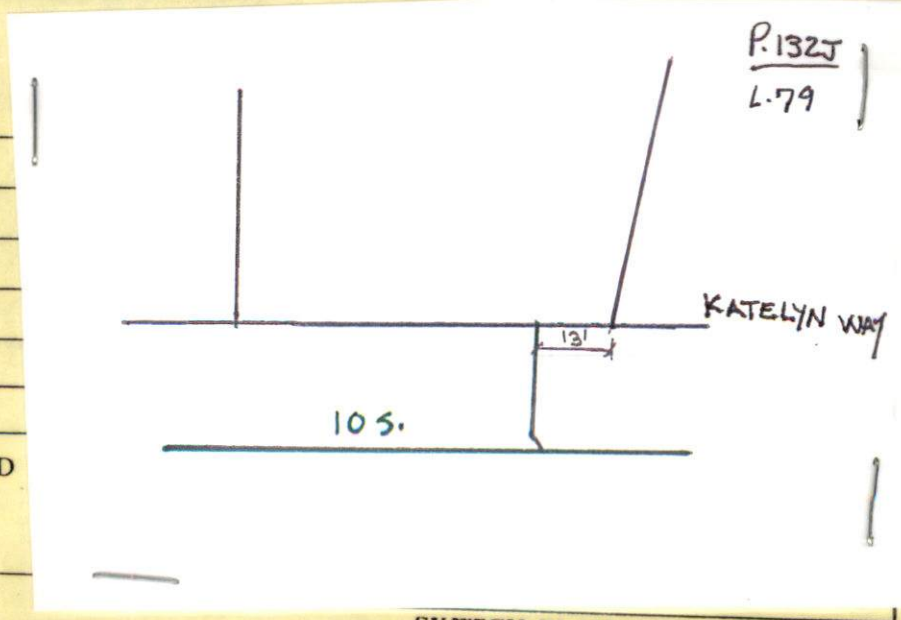

SKETCH PLAN

23434



SEWER AND/OR STORM DRAIN PERMIT

This certifies that permission is granted to

Long Realty Inc. 158 Chas. McLombs Blvd. NB 508-995-8240
 Property Owner Address #67 Tel.

to connect a sewer and/or storm drain located at Katelyn Way
 Assessor's Plot 132g, Lot 79, to the sewer and/or storm drain in Katelyn Way Street
 to be laid in accordance with the conditions in this application and the City of New Bedford ordinances.

TYPE OF USE: ☒ RESIDENTIAL ☐ COMMERCIAL ☐ INDUSTRIAL ☐ OTHER

330 gpd

If applicant other than actual property owner, attach Letter of Authorization from Property Owner.

Name Ralph Mufford Tel. 508-995-8240

Mailing Address P.O. Box 817 Fairhaven, Ma. 02719

The Bonded Contractor/Drain Layer authorized to perform this work is:

D.W. White Const. Inc. 867 Middle Rd. Acushnet 508-763-8868
 Name Address Tel.

Type of Pipe Required: pvc sdr 35

PERMIT EXPIRES ONE YEAR AFTER DATE OF ISSUE 8-12-04

- * Requires separate connections for sewage and storm drain where applicable. Storm water cannot be discharged to a sanitary sewer.
- * All work must be inspected and approved by a D.P.W. inspector before backfilling.
- * If this connection is to be part of a private service shared jointly with other building owners, attach copy of Recorded Joint Maintenance Agreement.
- * Permits can be issued to Industrial and/or Commercial Applicants only upon receipt and approval by the Commissioner of Public Works of required plans and supplemental information.
- * In addition, a City-issued Industrial User Discharge Permit and/or a Sewer Extension/Connection Permit issued by the Commonwealth of Massachusetts D.E.P. shall be required by the City for Industrial Discharge into the sewer system.

Industrial User Discharge Permit No. Date

Comm. Mass. Sewer Conn./Ext. Permit No. Date

A Filing and Inspection Fee of \$150.00 plus an Entrance Fee of \$... where applicable, must accompany this application.

Bank # Compass Check # Date: 8/1/03 Receipt #

Other requirements: inspection only - per subdivision plans connecting to
 24" storm drain + 10" sanitary drain

☒ Sewer

Connection made to

☒ Storm Drain

Part of jointly-shared private line ☐ Yes ☒ No

FOR INSPECTION ONLY, A 24 HOUR
 NOTICE IS REQUIRED AND THE
 CONTRACTOR/APPLICANT IS
 REQUIRED TO NOTIFY THE
 ENGINEERING DIVISION AT 979-1527

Applicant agrees to abide by the above terms, as well as all pertinent ordinances of the City of New Bedford, and such other special rules as the Commissioner of Public Works may deem necessary

Duarte M. Andrade
 Acting City Engineer mn

Chip Rufford
 Signature of Property Owner or Representative
 Amy 1st floor

INSPECTOR'S REPORT

INSPECTED BY: _____

DATE: _____

COMMENTS: _____

☐ APPROVED

☐ DISAPPROVED

SIGNATURE

SKETCH PLAN



CITY OF NEW BEDFORD
MASSACHUSETTS

DEPT. OF PUBLIC WORKS

133 WILLIAM STREET

LAWRENCE D. WORDEN
COMMISSIONER

To Whom It May Concern:

I, Long Realty Inc. 158 Charles McCombs Blvd, being
Name Mailing Address

owner of property located at VARIOUS LOCATIONS IN NEW BEDFORD

Plot 132g, Lot 79, hereby agree to allow Robert K "CHIP" Mulford,
Name

My Attorney, PO Box 517, Fairhaven 02749 to act on my behalf,
Mailing Address

including affixing my signature, in securing permits for:

- ☒ Sewer/Drain Service Permits
- ☒ Water Service Permits
- ☒ Driveway Installation Permits
- ☒ Sidewalk Installation Permits

I further agree to confirm to, and abide by, all City rules and regulations applicable to the permits(s) being applied for.

**NG BUILT
HOMES**

Long on Quality

CHIP MULFORD
CORPORATE COUNSEL &
LAND ACQUISITION

Cell: 508-965-8355
Fax: 508-995-3275

Website: www.longbuilt-homes.com

58 Charles McCombs Blvd., New Bedford, MA 02745

Robert K. Mulford
Print
Long Realty Inc
158 Charles McCombs Blvd
Address
New Bedford, MA 02745
Created 7/2002
Date

508-9958240

To Whom It May Concern:

Chip Mulford is Long Realty Inc's Corporate Attorney, and is authorized to act on the Corporation's behalf in securing permits and any and all other matters involving the DPW.

Robert F. Long
Robert F. Long
Long Realty Inc



CITY OF NEW BEDFORD

NO. 1506-03

LICENSE NO. _____

DATE Aug 12 2003

FOUNDATION PERMIT

MSBC Sect. 111.8 – Any permit issued shall be deemed abandoned and invalid unless the work authorized by it shall have been commenced within six (6) months after its issuance.

This certifies that LONG BUILT HOMES, owner/contractor
has permission to INSTALL 26 X 34 FOUNDATION
on P1325 79 KATELYN WAY (NS) 30' Ex Stephanie Place
providing that the person accepting this permit shall in every respect conform to the terms of the application therefor on file in this office; to the provisions of the Statute of the Commonwealth and to the By-Laws of the City of New Bedford relating to the Inspection, Erection, Enlarging, Altering, Raising, Moving, Repairing or Tearing Down of a Building.

WIRING INSPECTOR

PLUMBING INSPECTOR

BUILDING INSPECTOR

ROUGH FINISH

YOUR AREA INSPECTOR IS: _____

– Tel. 979-1540 Between 8:00 AM – 9:00 AM

NOTICE: NOTIFY INSPECTOR 48 HOURS
IN ADVANCE OF APPLYING
SHEATING OR LATHING

OCCUPANCY PERMIT REQUIRED BEFORE OCCUPANCY

No Building or Structure shall be used or occupied until the Certificate of Use and Occupancy shall have been issued by the Building Commissioner – MSBC. Sect. 120.1 – N.B. Zoning Ord. Sect. 9-269

THIS CARD MUST BE DISPLAYED IN A CONSPICUOUS PLACE ON THE PREMISES
AND NOT TORN DOWN OR REMOVED UNTIL COMPLETION OF WORK

SUBJECT TO MASSACHUSETTS STATE
BUILDING CODE REQUIREMENTS

BUILDING INSPECTOR