

PERMIT NO.

23414



CITY OF NEW BEDFORD

DATE.....7-7-03.....

EXP 7-7-04

SEWER AND/OR STORM DRAIN PERMIT

This certifies that permission is granted to

Long Realty Inc 158 McCombs Blvd NB 508-995-8240
Property Owner Address Tel.

to connect a sewer and/or storm drain located at Phillips Rd. 560' so. of Lauren Dr.
Assessor's Plot 132 J, Lot 15, to the sewer and/or storm drain in Phillips Rd. Street
to be laid in accordance with the conditions in this application and the City of New Bedford ordinances.

TYPE OF USE: ☒ RESIDENTIAL ☐ COMMERICAL ☐ INDUSTRIAL ☐ OTHER

If applicant other than actual property owner, attach Letter of Authorization from Property Owner.

Name Ralph Mulford Tel. 508-965-8355

Mailing Address P.O. Box 817 Fairhaven, MA 02719

The Bonded Contractor/Drain Layer authorized to perform this work is:

D.W. White 867 Middle Rd. Acushnet, MA 508-763-8868
Name Address Tel.

Type of Pipe Required: PVC SDR-35

PERMIT EXPIRES ONE YEAR AFTER DATE OF ISSUE

* Requires separate connections for sewage and storm drain where applicable. Storm water cannot be discharged to a sanitary sewer.

* All work must be inspected and approved by a D.P.W. inspector before backfilling.

* If this connection is to be part of a private service shared jointly with other building owners, attach copy of Recorded Joint Maintenance Agreement.

* Permits can be issued to Industrial and/or Commercial Applicants only upon receipt and approval by the Commissioner of Public Works of required plans and supplemental information.

* In addition, a City-issued Industrial User Discharge Permit and/or a Sewer Extension/Connection Permit issued by the Commonwealth of Massachusetts D.E.P. shall be required by the City for Industrial Discharge into the sewer system.

Industrial User Discharge Permit No. Date

Comm. Mass. Sewer Conn./Ext. Permit No. Date

A Filing and Inspection Fee of \$150.00 plus an Entrance Fee of \$..... where applicable, must accompany this application.

Bank # Compass Bank Check # 30118 Date: 7/8/03 Receipt # 4651

Other requirements: inspection fee only as per subdivision plan
8" sewer

☒ Sewer

Connection made to

Part of jointly-shared private line ☐ Yes ☒ No

☐ Storm Drain

330 G.P.D.

Applicant agrees to abide by the above terms, as well as all pertinent ordinances of the City of New Bedford, and such other special rules as the Commissioner of Public Works may deem necessary

Duarte Andrade (ms)

Commissioner of Public Works

Acting City Engineer

by: Chip Mulford

Signature of Property Owner or Representative

INSPECTOR'S REPORT

INSPECTED BY: NO INSPECTION REPORT

DATE:

COMMENTS:

☐ APPROVED

☐ DISAPPROVED

SIGNATURE

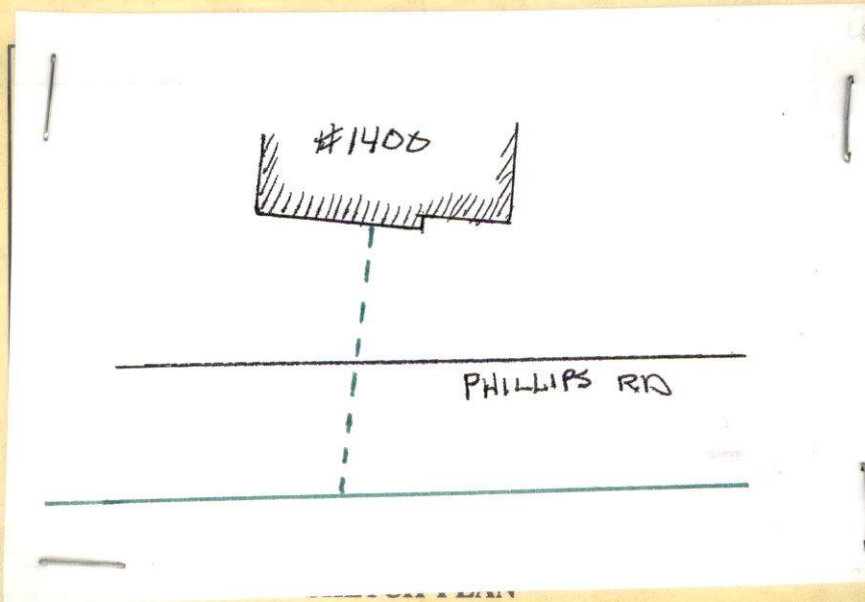

PERMIT NO.

23414



CITY OF NEW BEDFORD

DATE.....7-7-03.....

EXP 7-7-04

SEWER AND/OR STORM DRAIN PERMIT

This certifies that permission is granted to

Long Realty Inc. 158 McCombs Blvd. NB. 508-995-8240.
Property Owner Address Tel.

to connect a sewer and/or storm drain located at Phillips Rd. 560' so of Lauren Dr.
Assessor's Plot 132 J, Lot 15, to the sewer and/or storm drain in Phillips Rd. Street
to be laid in accordance with the conditions in this application and the City of New Bedford ordinances.

TYPE OF USE: ☒ RESIDENTIAL ☐ COMMERICAL ☐ INDUSTRIAL ☐ OTHER

If applicant other than actual property owner, attach Letter of Authorization from Property Owner.

Name Ralph Mulford Tel. 508-965-8355.

Mailing Address P.O. Box 817 Fairhaven, MA. 02719.

The Bonded Contractor/Drain Layer authorized to perform this work is:

D.W. White 867 Middle Rd. Acushnet, MA. 508-763-8868
Name Address Tel.

Type of Pipe Required: PVC SDR-35

PERMIT EXPIRES ONE YEAR AFTER DATE OF ISSUE

* Requires separate connections for sewage and storm drain where applicable. Storm water cannot be discharged to a sanitary sewer.

* All work must be inspected and approved by a D.P.W. inspector before backfilling.

* If this connection is to be part of a private service shared jointly with other building owners, attach copy of Recorded Joint Maintenance Agreement.

* Permits can be issued to Industrial and/or Commercial Applicants only upon receipt and approval by the Commissioner of Public Works of required plans and supplemental information.

* In addition, a City-issued Industrial User Discharge Permit and/or a Sewer Extension/Connection Permit issued by the Commonwealth of Massachusetts D.E.P. shall be required by the City for Industrial Discharge into the sewer system.

Industrial User Discharge Permit No. Date.

Comm. Mass. Sewer Conn./Ext. Permit No. Date.

A Filing and Inspection Fee of \$150.00 plus an Entrance Fee of \$..... where applicable, must accompany this application.

Bank # Compass Bank Check # 30118 Date: 7/8/03 Receipt # 4651

Other requirements: inspection fee only as per subdivision plan
8" sewer

☒ Sewer

Connection made to

Part of jointly-shared private line ☐ Yes ☒ No

330 G.P.D.

☐ Storm Drain

Applicant agrees to abide by the above terms, as well as all pertinent ordinances of the City of New Bedford, and such other special rules as the Commissioner of Public Works may deem necessary

Duarte Andrade

Signature of Property Owner or Representative

Acting City Engineer

INSPECTOR'S REPORT

INSPECTED BY: _____

DATE: _____

COMMENTS: _____

☐ APPROVED

☐ DISAPPROVED

SIGNATURE

SKETCH PLAN

ORIGINAL



CITY OF NEW BEDFORD
MASSACHUSETTS

DEPT. OF PUBLIC WORKS

133 WILLIAM STREET

LAWRENCE D. WORDEN
COMMISSIONER

To Whom It May Concern:

I, Long Built Homes, 158 Charles McCombs Blvd, being
Name Mailing Address

owner of property located at Woodford Estates (where school

Plot 132J, Lot 15, hereby agree to allow Chip Mulford
Name

My Attorney, PO Box 817, FAIRHAVEN CT 06424 to act on my behalf,
Mailing Address

including affixing my signature, in securing permits for:

☒ Sewer/Drain Service Permits
☒ Water Service Permits
☒ Driveway Installation Permits
NONE yet Sidewalk Installation Permits

I further agree to confirm to, and abide by, all City rules and regulations applicable to the permits(s) being applied for.

Name

Chip Mulford
Print

Long Built Homes, Inc
Address

158 Charles McCombs Blvd
Address

New Bedford, MA 02745
Date

LONG BUILT
HOMES

CHIP MULFORD
CORPORATE COUNSEL &
LAND ACQUISITION

"Long" on Quality

Cell: 508-965-8355
Fax: 508-995-3275

Website: www.longbulthomes.com

158 Charles McCombs Blvd., New Bedford, MA 02745



CITY OF NEW BEDFORD

NO. 1216.03

LICENSE NO. _____

DATE JULY 7 2003

FOUNDATION PERMIT

MSBC Sect. 111.8 – Any permit issued shall be deemed abandoned and invalid unless the work authorized by it shall have been commenced within six (6) months after its issuance.

This certifies that LONG BUILT HOMES, owner/contractor
has permission to INSTALL 42 X 28 FOUNDATION
on P1325 15 PHILLIPS RD

providing that the person accepting this permit shall in every respect conform to the terms of the application therefor on file in this office; to the provisions of the Statute of the Commonwealth and to the By-Laws of the City of New Bedford relating to the Inspection, Erection, Enlarging, Altering, Raising, Moving, Repairing or Tearing Down of a Building.

WIRING INSPECTOR

PLUMBING INSPECTOR

BUILDING INSPECTOR

ROUGH FINISH

YOUR AREA INSPECTOR IS: _____

– Tel. 979-1540 Between 8:00 AM – 9:00 AM

NOTICE: NOTIFY INSPECTOR 48 HOURS
IN ADVANCE OF APPLYING
SHEATING OR LATHING

OCCUPANCY PERMIT REQUIRED BEFORE OCCUPANCY

No Building or Structure shall be used or occupied until the Certificate of Use and Occupancy shall have been issued by the Building Commissioner – MSBC, Sect. 120.1 – N.B. Zoning Ord. Sect. 9-269

THIS CARD MUST BE DISPLAYED IN A CONSPICUOUS PLACE ON THE PREMISES
AND NOT TORN DOWN OR REMOVED UNTIL COMPLETION OF WORK

SUBJECT TO MASSACHUSETTS STATE
BUILDING CODE REQUIREMENTS

John P. Roza
BUILDING INSPECTOR