

PERMIT NO.

23408



CITY OF NEW BEDFORD

DATE 6/26/03  
exp. 6/26/04

SEWER AND/OR STORM DRAIN PERMIT

This certifies that permission is granted to

Long Realty, Inc / Robert Long % Chip Mulford 158 Charles McCombs Blvd. NB, MA 02745  
Property Owner Address #81 Way Tel. 508-995-8240

to connect a sewer and/or storm drain located at Katelyn Drive (NS) 90'± Wx Stephanie Place  
Assessor's Plot 132J, Lot 77, to the sewer and/or storm drain in Katelyn Drive Way Street  
to be laid in accordance with the conditions in this application and the City of New Bedford ordinances.

TYPE OF USE: ☒ RESIDENTIAL ☐ COMMERCIAL ☐ INDUSTRIAL ☐ OTHER

If applicant other than actual property owner, attach Letter of Authorization from Property Owner.

Name Ralph K. Mulford, Atty / Long Build Homes Tel. 508-965-8355 Ext. 12  
Mailing Address PO Box 817 FAIRHAVEN, MA 02719

The Bonded Contractor/Drain Layer authorized to perform this work is:

DW WHITE 867 Middle Rd Acushnet, MA 02743 508-763-8868  
Name Address Tel.

Type of Pipe Required: PVC SDR-35

PERMIT EXPIRES ONE YEAR AFTER DATE OF ISSUE

- \* Requires separate connections for sewage and storm drain where applicable. Storm water cannot be discharged to a sanitary sewer.
- \* All work must be inspected and approved by a D.P.W. inspector before backfilling.
- \* If this connection is to be part of a private service shared jointly with other building owners, attach copy of Recorded Joint Maintenance Agreement.
- \* Permits can be issued to Industrial and/or Commercial Applicants only upon receipt and approval by the Commissioner of Public Works of required plans and supplemental information.
- \* In addition, a City-issued Industrial User Discharge Permit and/or a Sewer Extension/Connection Permit issued by the Commonwealth of Massachusetts D.E.P. shall be required by the City for Industrial Discharge into the sewer system.

Industrial User Discharge Permit No. Date  
Comm. Mass. Sewer Conn./Ext. Permit No. Date

A Filing and Inspection Fee of \$150.00, plus an Entrance Fee of \$ where applicable, must accompany this application.

Bank # Compass Bank Check # 29968 Date: 6/26/03 Receipt # 4642

Other requirements: Insp. Only per Subdivision Plans - Woodford Estate Subdivision  
connecting to 8" Sewer and Storm drain in Katelyn Way

Connection made to ☒ Sewer ☐ Storm Drain  
Part of jointly-shared private line ☐ Yes ☒ No

Applicant agrees to abide by the above terms, as well as all pertinent ordinances of the City of New Bedford, and such other special rules as the Commissioner of Public Works may deem necessary

Lawrence D. Worden (ms)  
Commissioner of Public Works

Long Realty, Inc  
Signature of Property Owner or Representative

INSPECTED BY:  
DATE:  
COMMENTS:

☐ APPROVED ☐ DISAPPROVED

SIGNATURE

SKETCH PLAN

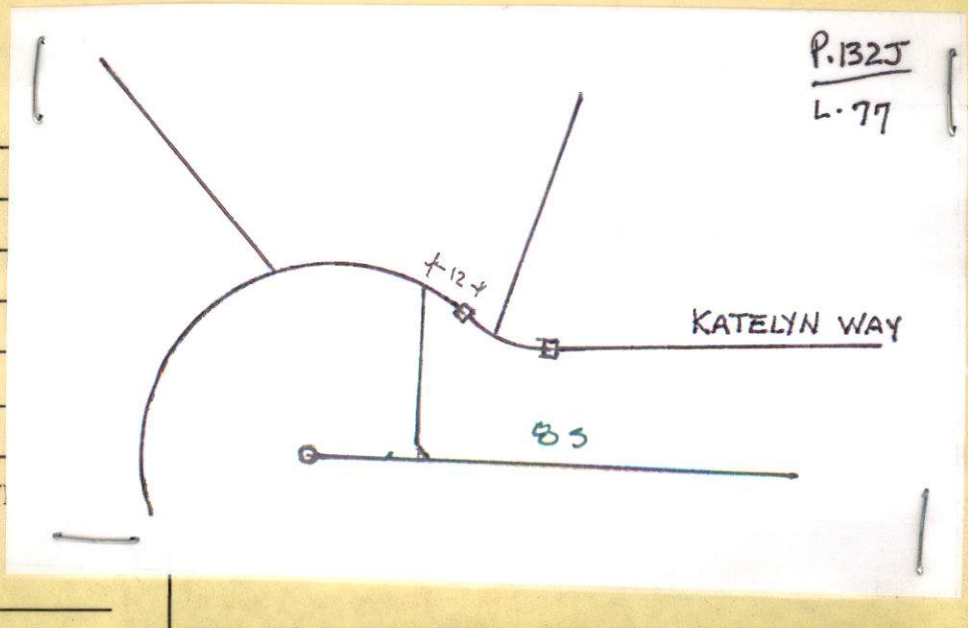



PERMIT NO.

23408



CITY OF NEW BEDFORD

DATE 6/26/03  
exp. 6/26/04

SEWER AND/OR STORM DRAIN PERMIT

This certifies that permission is granted to

Long Realty, Inc./Robert Long 90 Chipmunk 158 Charles McCombs Blvd. NB, MA 02745  
Property Owner Address #81 Tel. 508-995-8240

to connect a sewer and/or storm drain located at Katelyn Way (NS) 90'± Wx Stephanie Place  
Assessor's Plot 132J, Lot 77, to the sewer and/or storm drain in Katelyn Drive Way Street  
to be laid in accordance with the conditions in this application and the City of New Bedford ordinances.

TYPE OF USE: ☒ RESIDENTIAL ☐ COMMERICAL ☐ INDUSTRIAL ☐ OTHER

If applicant other than actual property owner, attach Letter of Authorization from Property Owner.

Name Ralph K. Mulford, Atty. / Long Build Homes Tel. 508-965-8355 Ext. 12

Mailing Address PO Box 817 FAIRHAVEN, MA 02719

The Bonded Contractor/Drain Layer authorized to perform this work is:

DW WHITE 867 Middle Rd Acushnet, MA 02743 508-763-8868  
Name Address Tel.

Type of Pipe Required: PVC SDR-35

PERMIT EXPIRES ONE YEAR AFTER DATE OF ISSUE

- \* Requires separate connections for sewage and storm drain where applicable. Storm water cannot be discharged to a sanitary sewer.
- \* All work must be inspected and approved by a D.P.W. inspector before backfilling.
- \* If this connection is to be part of a private service shared jointly with other building owners, attach copy of Recorded Joint Maintenance Agreement.
- \* Permits can be issued to Industrial and/or Commercial Applicants only upon receipt and approval by the Commissioner of Public Works of required plans and supplemental information.
- \* In addition, a City-issued Industrial User Discharge Permit and/or a Sewer Extension/Connection Permit issued by the Commonwealth of Massachusetts D.E.P. shall be required by the City for Industrial Discharge into the sewer system.

Industrial User Discharge Permit No. Date

Comm. Mass. Sewer Conn./Ext. Permit No. Date

A Filing and Inspection Fee of \$150.00, plus an Entrance Fee of \$ where applicable, must accompany this application.

Bank # Compass Bank Check # 29968 Date: 6/26/03 Receipt # 4642

Other requirements: Insp. Only per Subdivision Plans - Woodford Estate Subdivision  
connecting to 8" Sewer and Storm drain in Katelyn Way

Connection made to ☒ Sewer ☐ Storm Drain Part of jointly-shared private line ☐ Yes ☒ No

Applicant agrees to abide by the above terms, as well as all pertinent ordinances of the City of New Bedford, and such other special rules as the Commissioner of Public Works may deem necessary

Lawrence D. Worden (ms)  
Commissioner of Public Works

Signature of Property Owner or Representative

INSPECTOR'S REPORT

INSPECTED BY:

DATE:

COMMENTS:

☐ APPROVED ☐ DISAPPROVED

SIGNATURE

SKETCH PLAN

ORIGINAL



**CITY OF NEW BEDFORD  
MASSACHUSETTS**

**DEPT. OF PUBLIC WORKS**

133 WILLIAM STREET

LAWRENCE D. WORDEN  
COMMISSIONER

To Whom It May Concern:

I, Long Robert, 158 Charles McCombs Blvd, being  
Name Mailing Address  
owner of property located at Woodford Estates (former Woods)  
Plot \_\_\_\_\_, Lot \_\_\_\_\_, hereby agree to allow Ralph K. "CHIP" Mulford  
Name  
My Attorney, P.O. Box 817, FAIRHAVEN 02749 to act on my behalf,  
Mailing Address

including affixing my signature, in securing permits for:

☒ Sewer/Drain Service Permits  
☒ Water Service Permits  
☒ Driveway Installation Permits  
None yet Sidewalk Installation Permits

I further agree to confirm to, and abide by, all City rules and regulations applicable to the permits(s) being applied for.

Name Robert Long  
Print  
Long Robert, Jr.  
158 Charles McCombs Blvd  
Address  
New Bedford, MA 02745  
March 2, 2002  
Date

**LONG BUILT  
HOMES**

"Long" on Quality

**CHIP MULFORD**  
CORPORATE COUNSEL &  
LAND ACQUISITION

Cell: 508-965-8355  
Fax: 508-995-3275

Website: [www.longbulthomes.com](http://www.longbulthomes.com)

158 Charles McCombs Blvd., New Bedford, MA 02745



# CITY OF NEW BEDFORD

592

NO. **1125-03**

LICENSE NO. \_\_\_\_\_

DATE **JUNE 25** 20**03**

## FOUNDATION PERMIT

MSBC Sect. 111.8 – Any permit issued shall be deemed abandoned and invalid unless the work authorized by it shall have been commenced within six (6) months after its issuance.

This certifies that **LONG BUILT HOME**, owner/contractor  
has permission to **INSTALL 28 X 32 FOUNDATION**  
on **1325 77 KATELYN DR**

providing that the person accepting this permit shall in every respect conform to the terms of the application therefor on file in this office; to the provisions of the Statute of the Commonwealth and to the By-Laws of the City of New Bedford relating to the Inspection, Erection, Enlarging, Altering, Raising, Moving, Repairing or Tearing Down of a Building.

WIRING INSPECTOR

PLUMBING INSPECTOR

BUILDING INSPECTOR

\_\_\_\_\_  
\_\_\_\_\_  
\_\_\_\_\_\_\_\_\_\_  
\_\_\_\_\_  
\_\_\_\_\_\_\_\_\_\_  
\_\_\_\_\_  
\_\_\_\_\_

ROUGH FINISH

YOUR AREA INSPECTOR IS: \_\_\_\_\_

– Tel. 979-1540 Between 8:00 AM – 9:00 AM

NOTICE: NOTIFY INSPECTOR 48 HOURS  
IN ADVANCE OF APPLYING  
SHEATING OR LATHING

### OCCUPANCY PERMIT REQUIRED BEFORE OCCUPANCY

No Building or Structure shall be used or occupied until the Certificate of Use and Occupancy shall have been issued by the Building Commissioner – MSBC. Sect. 120.1 – N.B. Zoning Ord. Sect. 9-269

THIS CARD MUST BE DISPLAYED IN A CONSPICUOUS PLACE ON THE PREMISES  
AND NOT TORN DOWN OR REMOVED UNTIL COMPLETION OF WORK

SUBJECT TO MASSACHUSETTS STATE  
BUILDING CODE REQUIREMENTS