

PERMIT NO.
23361



CITY OF NEW BEDFORD

DATE 5/7/03
EXP 5/7/04

SEWER AND/OR STORM DRAIN PERMIT

This certifies that permission is granted to

JOSE CASTELO

1815 ACUSHNET AVE. N.B. MA. 02746 (508) 995-6291

Property Owner

Address #210

Tel.

to connect a sewer and/or storm drain located at

PITMAN ST. (S.S.) 40' E. / EXH. 100/1 J.

Assessor's Plot 95, Lot 147, to the sewer and/or storm drain in PITMAN ST. Street

to be laid in accordance with the conditions in this application and the City of New Bedford ordinances.

TYPE OF USE: ☒ RESIDENTIAL ☐ COMMERICAL ☐ INDUSTRIAL ☐ OTHER

330 GRD

If applicant other than actual property owner, attach Letter of Authorization from Property Owner.

Name N/A Tel.

Mailing Address

The Bonded Contractor/Drain Layer authorized to perform this work is:

R.T. Carson Draining, P.O. Box 51642, N.B. MA 02710 (508) 993-2508

Name

Address

Tel.

Type of Pipe Required: PVC SDR 35

PERMIT EXPIRES ONE YEAR AFTER DATE OF ISSUE

* Requires separate connections for sewage and storm drain where applicable. Storm water cannot be discharged to a sanitary sewer.

* All work must be inspected and approved by a D.P.W. inspector before backfilling.

* If this connection is to be part of a private service shared jointly with other building owners, attach copy of Recorded Joint Maintenance Agreement.

* Permits can be issued to Industrial and/or Commercial Applicants only upon receipt and approval by the Commissioner of Public Works of required plans and supplemental information.

* In addition, a City-issued Industrial User Discharge Permit and/or a Sewer Extension/Connection Permit issued by the Commonwealth of Massachusetts D.E.P. shall be required by the City for Industrial Discharge into the sewer system.

Industrial User Discharge Permit No. Date

Comm. Mass. Sewer Conn./Ext. Permit No. Date

A Filing and Inspection Fee of \$ 150.00 plus an Entrance Fee of \$ where applicable, must accompany this application.

Bank # Compass Check # 3888 Date: 5/7/03 Receipt # 4580

Other requirements: Inspector Only - connection to storm drain & sewer to be

as per attached plans as approved by Duarte Andrade.

☒ Sewer

Connection made to

Part of jointly-shared private line ☐ Yes ☒ No

☒ Storm Drain

Applicant agrees to abide by the above terms, as well as all pertinent ordinances of the City of New Bedford, and such other special rules as the Commissioner of Public Works may deem necessary

Commissioner of Public Works

Signature of Property Owner or Representative

INSPECTOR'S REPORT

INSPECTED BY: Kevin J. Coughlin

DATE: 9-22-03

COMMENTS:

☒ APPROVED

☐ DISAPPROVED

Kevin J. Coughlin

SIGNATURE

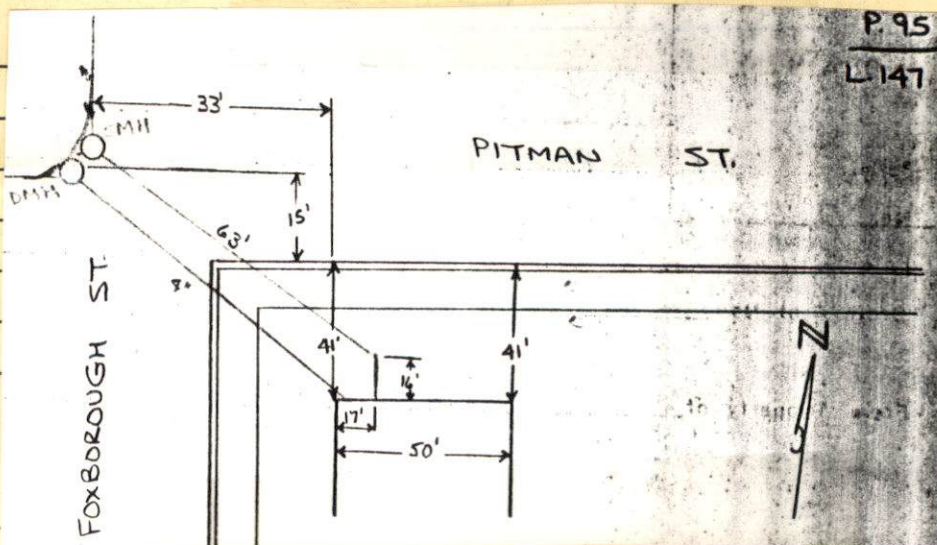

SKETCH PLAN

PERMIT NO.

23361



CITY OF NEW BEDFORD

SEWER AND/OR STORM DRAIN PERMIT

DATE 5/7/03
EXP 5/7/04

This certifies that permission is granted to

JOSE CASTELO

1815 ACUSHNET AVE. N.B. MA. 02746 (508) 995-6291

Property Owner

Address

Tel.

to connect a sewer and/or storm drain located at PITMAN ST. (S.S.) 40' E. Foxborough St.

Assessor's Plot 95, Lot 147, to the sewer and/or storm drain in PITMAN ST + Street

to be laid in accordance with the conditions in this application and the City of New Bedford ordinances.

TYPE OF USE: ☒ RESIDENTIAL ☐ COMMERICAL ☐ INDUSTRIAL ☐ OTHER

330 GRD

If applicant other than actual property owner, attach Letter of Authorization from Property Owner.

Name N/A Tel. _____

Mailing Address _____

The Bonded Contractor/Drain Layer authorized to perform this work is:

R.J. Carerra Excavating

P.O. Box 51645 N.B. MA 02740

(508) 995-9508

Name

Address

Tel.

Type of Pipe Required: PVC SDR 35

PERMIT EXPIRES ONE YEAR AFTER DATE OF ISSUE

* Requires separate connections for sewage and storm drain where applicable. Storm water cannot be discharged to a sanitary sewer.

* All work must be inspected and approved by a D.P.W. inspector before backfilling.

* If this connection is to be part of a private service shared jointly with other building owners, attach copy of Recorded Joint Maintenance Agreement.

* Permits can be issued to Industrial and/or Commercial Applicants only upon receipt and approval by the Commissioner of Public Works of required plans and supplemental information.

* In addition, a City-issued Industrial User Discharge Permit and/or a Sewer Extension/Connection Permit issued by the Commonwealth of Massachusetts D.E.P. shall be required by the City for Industrial Discharge into the sewer system.

Industrial User Discharge Permit No. _____ Date _____

Comm. Mass. Sewer Conn./Ext. Permit No. _____ Date _____

A Filing and Inspection Fee of \$ 150.00 plus an Entrance Fee of \$ _____ where applicable, must accompany this application.

Bank # Compass Check # 3888 Date: 5/7/03 Receipt # 4580

Other requirements: Inspection Only - connection to storm drain & sewer to be
as per attached plan as approved by Duarte Andrade.

☒ Sewer

Connection made to

Part of jointly-shared private line ☐ Yes ☒ No

☒ Storm Drain

Applicant agrees to abide by the above terms, as well as all pertinent ordinances of the City of New Bedford, and such other special rules as the Commissioner of Public Works may deem necessary

Lawrence D. Wodzin

Commissioner of Public Works

Jose S. Castelo

Signature of Property Owner or Representative

INSPECTOR'S REPORT

INSPECTED BY: _____

DATE: _____

COMMENTS: _____

☐ APPROVED

☐ DISAPPROVED

SIGNATURE

SKETCH PLAN

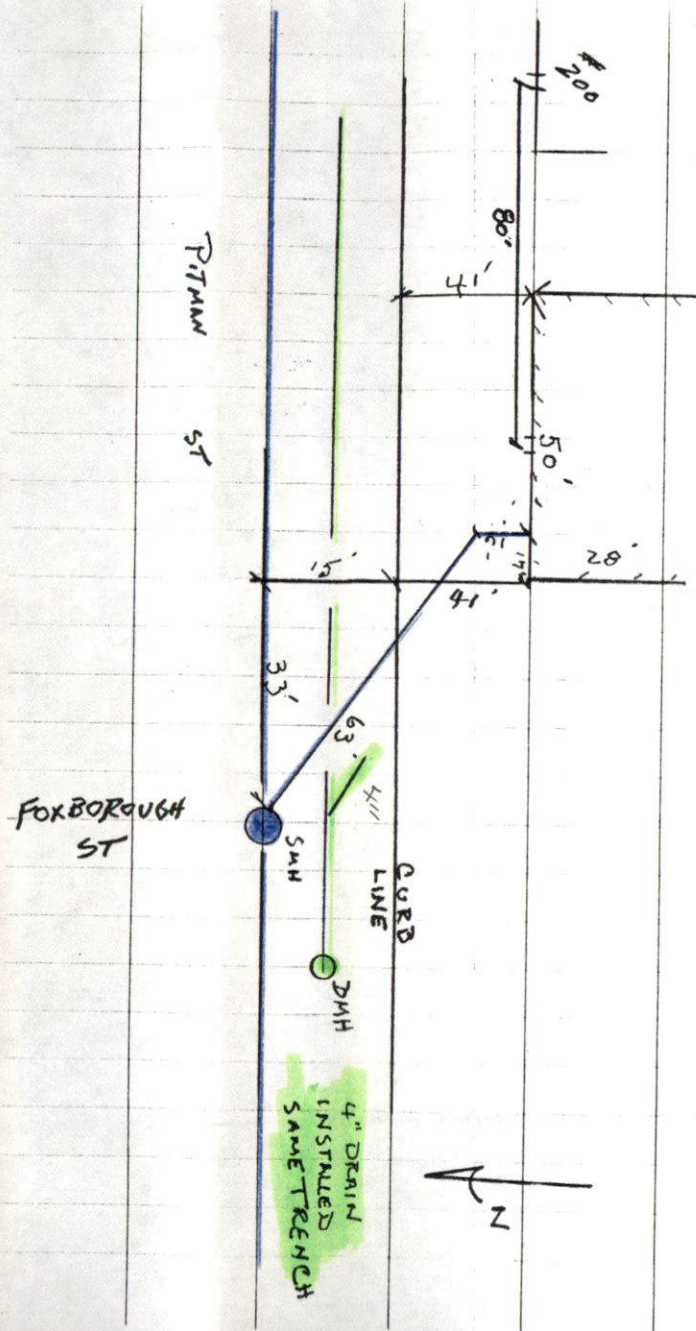

9-22-03
MONDAY - SUNNY 75°

PITMAN, FOXBOROUGH STS -
SEWER INSPECTION

PERMIT #23361

CONTRACTOR RJ CANESSA