

PERMIT NO.

CITY OF NEW BEDFORD

DATE.....4-14-03.....

23353



SEWER AND/OR STORM DRAIN PERMIT

This certifies that permission is granted to

Long Realty Inc. 158 Charles McCombs Blvd NB 508-965-8355  
Property Owner Address 12 Tel.

to connect a sewer and/or storm drain located at Jennifer Lane

Assessor's Plot 132 J, Lot 105, to the sewer and/or storm drain in Jennifer Lane Street

to be laid in accordance with the conditions in this application and the City of New Bedford ordinances.

TYPE OF USE: ☒ RESIDENTIAL ☐ COMMERICAL ☐ INDUSTRIAL ☐ OTHER

330g

If applicant other than actual property owner, attach Letter of Authorization from Property Owner.

Name Atty Ralph Mulford Tel. 508-965-8355

Mailing Address P.O. Box 817 Fairhaven, MA 02719

The Bonded Contractor/Drain Layer authorized to perform this work is:

D.W. White 867 Middle Road Acushnet MA 508-763-8868  
Name Address Tel.

Type of Pipe Required: SDR 35 PVC

PERMIT EXPIRES ONE YEAR AFTER DATE OF ISSUE

\* Requires separate connections for sewage and storm drain where applicable. Storm water cannot be discharged to a sanitary sewer.

\* All work must be inspected and approved by a D.P.W. inspector before backfilling.

\* If this connection is to be part of a private service shared jointly with other building owners, attach copy of Recorded Joint Maintenance Agreement.

\* Permits can be issued to Industrial and/or Commercial Applicants only upon receipt and approval by the Commissioner of Public Works of required plans and supplemental information.

\* In addition, a City-issued Industrial User Discharge Permit and/or a Sewer Extension/Connection Permit issued by the Commonwealth of Massachusetts D.E.P. shall be required by the City for Industrial Discharge into the sewer system.

Industrial User Discharge Permit No. - Date -

Comm. Mass. Sewer Conn./Ext. Permit No. - Date -

A Filing and Inspection Fee of \$150.00 plus an Entrance Fee of \$- where applicable, must accompany this application.

Bank # Compass Check # 29051 Date: 4-14-03 Receipt # 4555

Other requirements: INSPECTION ONLY

☒ Sewer

Connection made to

Part of jointly-shared private line ☐ Yes ☒ No

☐ Storm Drain not available

Applicant agrees to abide by the above terms, as well as all pertinent ordinances of the City of New Bedford, and such other special rules as the Commissioner of Public Works may deem necessary

Commissioner of Public Works

Signature of Property Owner or Representative

INSPECTOR'S REPORT

INSPECTED BY: \_\_\_\_\_

DATE: \_\_\_\_\_

COMMENTS: \_\_\_\_\_

\_\_\_\_\_

\_\_\_\_\_

\_\_\_\_\_

\_\_\_\_\_

☐ APPROVED

☐ DISAPPROVED

SIGNATURE

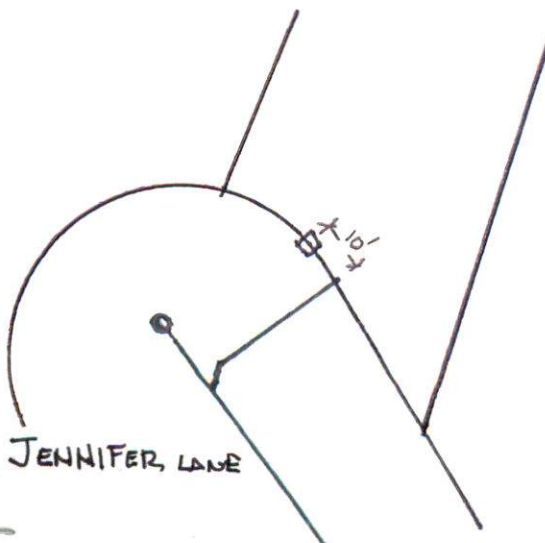

SKETCH PLAN