

PERMIT NO.  
23346



CITY OF NEW BEDFORD

DATE 4-7-03  
EXP 4-7-04

SEWER AND/OR STORM DRAIN PERMIT

This certifies that permission is granted to

Property Owner Christian Mission Fellowship by Faith 1582 ACUSHNET ST. NB, MA 02745 Address #267 Tel. (508) 996-1310  
to connect a sewer and/or storm drain located at POTTER ST (NS) 160' ± E / APACHE CT.  
Assessor's Plot 82, Lot 30, to the sewer and/or storm drain in POTTER ST. Street

to be laid in accordance with the conditions in this application and the City of New Bedford ordinances.

TYPE OF USE: ☐ RESIDENTIAL ☐ COMMERICAL ☐ INDUSTRIAL ☒ OTHER

If applicant other than actual property owner, attach Letter of Authorization from Property Owner.

Name Laurence D. Wadsworth Tel. (508) 320-9133  
Mailing Address P.O. Box 359 E. Falmouth MA 02717

The Bonded Contractor/Drain Layer authorized to perform this work is:

11/13/15  
Name Address Tel.

Type of Pipe Required: PVC SDR 35

PERMIT EXPIRES ONE YEAR AFTER DATE OF ISSUE

- \* Requires separate connections for sewage and storm drain where applicable. Storm water cannot be discharged to a sanitary sewer.
- \* All work must be inspected and approved by a D.P.W. inspector before backfilling.
- \* If this connection is to be part of a private service shared jointly with other building owners, attach copy of Recorded Joint Maintenance Agreement.
- \* Permits can be issued to Industrial and/or Commercial Applicants only upon receipt and approval by the Commissioner of Public Works of required plans and supplemental information.
- \* In addition, a City-issued Industrial User Discharge Permit and/or a Sewer Extension/Connection Permit issued by the Commonwealth of Massachusetts D.E.P. shall be required by the City for Industrial Discharge into the sewer system.

Industrial User Discharge Permit No. N/A Date \_\_\_\_\_  
Comm. Mass. Sewer Conn./Ext. Permit No. N/A Date \_\_\_\_\_

A Filing and Inspection Fee of \$ 150.00, plus an Entrance Fee of \$ \_\_\_\_\_ where applicable, must accompany this application.

Bank # Compo Check # 0520 Date: 4/7/03 Receipt # 4541

Other requirements: Inspection Only - Private Situation  
Connecting 10" sewer & 18" storm drain in Potter St.

Connection made to ☒ Sewer Part of jointly-shared private line ☐ Yes ☒ No  
☒ Storm Drain

Applicant agrees to abide by the above terms, as well as all pertinent ordinances of the City of New Bedford, and such other special rules as the Commissioner of Public Works may deem necessary

Laurence D. Wadsworth  
Commissioner of Public Works

Bernard J. Lainger  
Signature of Property Owner or Representative

INSPECTOR'S REPORT

INSPECTED BY: Kevin S. Canel  
DATE: 10-14-03  
COMMENTS:

☒ APPROVED ☐ DISAPPROVED

Kevin S. Canel  
SIGNATURE

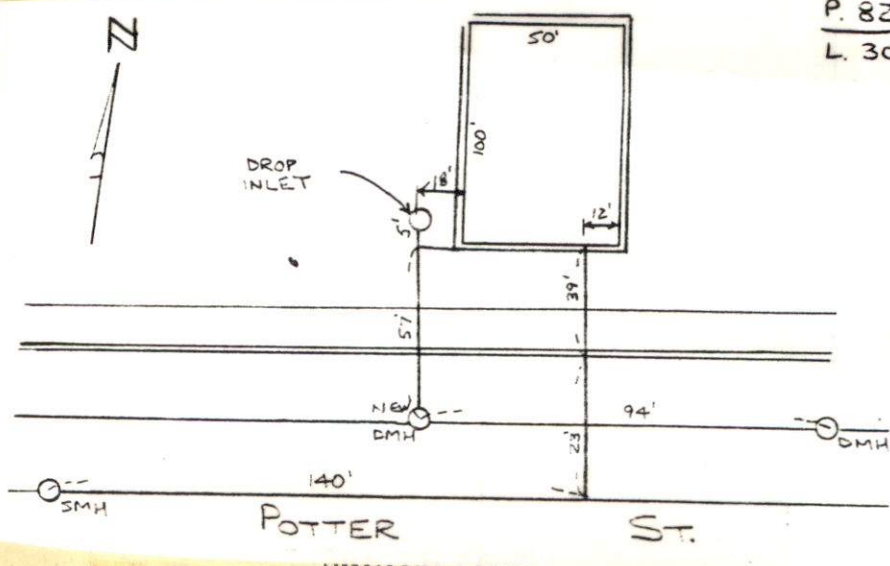



PERMIT NO.

23346



CITY OF NEW BEDFORD

DATE 4-7-03  
EXP 4-7-04

SEWER AND/OR STORM DRAIN PERMIT

#267

This certifies that permission is granted to

Christian Mission Hebrews Flow'n by Faith 260 Potter St. NB MA 02740  
Property Owner 1382 Acushnet Ave. NB, MA 02745 Tel. (508) 996-1340

to connect a sewer and/or storm drain located at POTTER ST (NS) 160' ± E / APACHE CT.

Assessor's Plot 82, Lot 30, to the sewer and/or storm drain in POTTER ST. Street

to be laid in accordance with the conditions in this application and the City of New Bedford ordinances.

TYPE OF USE: ☐ RESIDENTIAL ☐ COMMERCIAL ☐ INDUSTRIAL ☒ OTHER

2 Bedroom

If applicant other than actual property owner, attach Letter of Authorization from Property Owner.

Name Bernard Longmire Tel. (508) 320-9453

Mailing Address P.O. Box 359 E. Freetown MA 02717

The Bonded Contractor/Drain Layer authorized to perform this work is:

W/C/B Name Address Tel.

Type of Pipe Required: PVC SDR 35

PERMIT EXPIRES ONE YEAR AFTER DATE OF ISSUE

- \* Requires separate connections for sewage and storm drain where applicable. Storm water cannot be discharged to a sanitary sewer.
- \* All work must be inspected and approved by a D.P.W. inspector before backfilling.
- \* If this connection is to be part of a private service shared jointly with other building owners, attach copy of Recorded Joint Maintenance Agreement.
- \* Permits can be issued to Industrial and/or Commercial Applicants only upon receipt and approval by the Commissioner of Public Works of required plans and supplemental information.
- \* In addition, a City-issued Industrial User Discharge Permit and/or a Sewer Extension/Connection Permit issued by the Commonwealth of Massachusetts D.E.P. shall be required by the City for Industrial Discharge into the sewer system.

Industrial User Discharge Permit No. N/A Date  
Comm. Mass. Sewer Conn./Ext. Permit No. N/A Date

A Filing and Inspection Fee of \$150.00, plus an Entrance Fee of \$ where applicable, must accompany this application.

Bank # Compad Check # 0520 Date: 4/7/03 Receipt # 4541

Other requirements: Inspection Only - Per attached site plan review  
Connecting to 8" sewer & 18" storm drain in Potter St.

Connection made to ☒ Sewer ☒ Storm Drain Part of jointly-shared private line ☐ Yes ☒ No

Applicant agrees to abide by the above terms, as well as all pertinent ordinances of the City of New Bedford, and such other special rules as the Commissioner of Public Works may deem necessary

Commissioner of Public Works

Signature of Property Owner or Representative

INSPECTOR'S REPORT

INSPECTED BY:

DATE:

COMMENTS:

☐ APPROVED ☐ DISAPPROVED

SIGNATURE

SKETCH PLAN



**CITY OF NEW BEDFORD  
MASSACHUSETTS**

DEPARTMENT OF PUBLIC WORKS  
ENGINEERING DIVISION

133 WILLIAM STREET, ROOM 303  
NEW BEDFORD, MA 02740

Tel: (508) 979-1527

Fax: (508) 961-3043

To Whom It May Concern:

I, Rev. David H. Perry 260 Potter St. N.B. Ma. 02740, being  
(Name) (Mailing Address)

Owner of property located at POTTER ST

Plot 82, Lot 30, hereby agree to allow Bernard J. Lounger  
(Name)

P.O. BOX 359 E. FREETOWN, MA. 02717 to act on my behalf including affixing my  
(Mailing Address)

signature in securing permit for:

- ☒ Sewer/Drain Service Permits
- ☒ Water Service Permits
- ☒ Driveway Installation Permits
- ☒ Sidewalk Installation Permits

I further agree to conform to, and abide by, all City rules and ask regulations applicable to the permit (s) being applied for:

Name Rev. David H. Perry  
(Signature)  
260 Potter St. N.B. Ma. 02740  
(Address)  
4-7-03 508-996-1340  
(Date) (Telephone number)