

PERMIT NO.

23339



CITY OF NEW BEDFORD

DATE 3/14/03
EXP 3/14/04

SEWER AND/OR STORM DRAIN PERMIT

This certifies that permission is granted to

Long Realty Inc. Robert Long 158 Charles St. Apt. 158
Property Owner Address NB MA 02743 Tel. (508) 765-8335 X-1

to connect a sewer and/or storm drain located at Stephanie Pl. (W.S.) 170' (4' - 10' N. of Main St. (W.S.)
Assessor's Plot 132J, Lot 94 to the sewer and/or storm drain in Stephanie Pl. Street
to be laid in accordance with the conditions in this application and the City of New Bedford ordinances.

TYPE OF USE: ☒ RESIDENTIAL ☐ COMMERICAL ☐ INDUSTRIAL ☐ OTHER

3306PD

If applicant other than actual property owner, attach Letter of Authorization from Property Owner.

Name Ralph Chap R. Mulford, My. Prop. Built Homes Tel. (508) 765-8335 X-12
Mailing Address P.O. Box 817 Fairhaven MA 02719

The Bonded Contractor/Drain Layer authorized to perform this work is:

D.W. White 816 Middle Rd. New Bedford MA 02743 (508) 763-8868
Name Address Tel.

Type of Pipe Required: PVC SDR 35

PERMIT EXPIRES ONE YEAR AFTER DATE OF ISSUE

- * Requires separate connections for sewage and storm drain where applicable. Storm water cannot be discharged to a sanitary sewer.
- * All work must be inspected and approved by a D.P.W. inspector before backfilling.
- * If this connection is to be part of a private service shared jointly with other building owners, attach copy of Recorded Joint Maintenance Agreement.
- * Permits can be issued to Industrial and/or Commercial Applicants only upon receipt and approval by the Commissioner of Public Works of required plans and supplemental information.
- * In addition, a City-issued Industrial User Discharge Permit and/or a Sewer Extension/Connection Permit issued by the Commonwealth of Massachusetts D.E.P. shall be required by the City for Industrial Discharge into the sewer system.

Industrial User Discharge Permit No. _____ Date _____
Comm. Mass. Sewer Conn./Ext. Permit No. _____ Date _____

A Filing and Inspection Fee of \$ 50.00 plus an Entrance Fee of \$ _____ where applicable, must accompany this application.

Bank # COMPASS BANK Check # 28731 Date: 3-14-03 Receipt # 4527

Other requirements: Inspection Only - Woodford Estate Subdivision
Connecting to 10" sewer in Stephanie Pl. and storm drain not available.

Connection made to ☒ Sewer ☐ Storm Drain
Part of jointly-shared private line ☐ Yes ☒ No
(Not Available)

Applicant agrees to abide by the above terms, as well as all pertinent ordinances of the City of New Bedford, and such other special rules as the Commissioner of Public Works may deem necessary

Saranne D. Wolcott
Commissioner of Public Works

Long Realty of Cape Cod
Signature of Property Owner or Representative

INSPECTOR'S REPORT

INSPECTED BY: _____

DATE: _____

COMMENTS: _____

☐ APPROVED ☐ DISAPPROVED

SIGNATURE

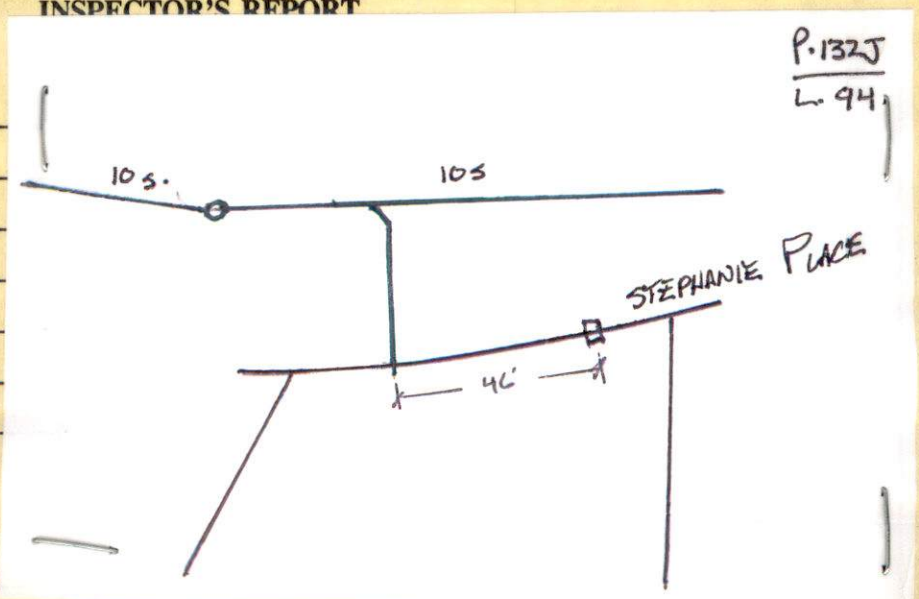

SKETCH PLAN

PERMIT NO. -

23339



CITY OF NEW BEDFORD

SEWER AND/OR STORM DRAIN PERMIT

DATE 3/14/03
EXP 3/14/04

This certifies that permission is granted to

Property Owner Long Realty Inc./Robert Long aka Ralph K. Mulford Atty. 158 Charles McCormick St
Address NB MA 02743 Tel. (508) 765-8355 X-1

to connect a sewer and/or storm drain located at Stephanie Pl. (W.S.) 170' (H) N. / Monica St
Assessor's Plot 132J Lot 94 to the sewer and/or storm drain in Stephanie Pl Street

to be laid in accordance with the conditions in this application and the City of New Bedford ordinances.

TYPE OF USE: ☒ RESIDENTIAL ☐ COMMERCIAL ☐ INDUSTRIAL ☐ OTHER

If applicant other than actual property owner, attach Letter of Authorization from Property Owner.

Name Ralph Chip K. Mulford, Atty. Long Built Homes Tel. (508) 765-8355 X-12

Mailing Address P.O. Box 817 Fairhaven MA 02719

The Bonded Contractor/Drain Layer authorized to perform this work is:

Name D.W. White Address 867 Middle Rd. Acushnet MA 02743 Tel. (508) 763-8868

Type of Pipe Required: PVC SDR 35

PERMIT EXPIRES ONE YEAR AFTER DATE OF ISSUE

- * Requires separate connections for sewage and storm drain where applicable. Storm water cannot be discharged to a sanitary sewer.
- * All work must be inspected and approved by a D.P.W. inspector before backfilling.
- * If this connection is to be part of a private service shared jointly with other building owners, attach copy of Recorded Joint Maintenance Agreement.
- * Permits can be issued to Industrial and/or Commercial Applicants only upon receipt and approval by the Commissioner of Public Works of required plans and supplemental information.
- * In addition, a City-issued Industrial User Discharge Permit and/or a Sewer Extension/Connection Permit issued by the Commonwealth of Massachusetts D.E.P. shall be required by the City for Industrial Discharge into the sewer system.

Industrial User Discharge Permit No. _____ Date _____

Comm. Mass. Sewer Conn./Ext. Permit No. _____ Date _____

A Filing and Inspection Fee of \$ 150.00 plus an Entrance Fee of \$ _____ where applicable, must accompany this application.

Bank # COMPASS BANK Check # 28731 Date: 3-14-03 Receipt # 4527

Other requirements: Inspection Only - Woodford Estate Subdivision

Connecting to 10" sewer in Stephanie Pl. and storm drain not available.

Connection made to ☒ Sewer ☐ Storm Drain
Part of jointly-shared private line ☐ Yes ☒ No
(not available)

Applicant agrees to abide by the above terms, as well as all pertinent ordinances of the City of New Bedford, and such other special rules as the Commissioner of Public Works may deem necessary

Lawrence D. Woodruff
Commissioner of Public Works

Long Realty or: Chip [Signature]
Signature of Property Owner or Representative

INSPECTOR'S REPORT

INSPECTED BY: _____

DATE: _____

COMMENTS: _____

☐ APPROVED ☐ DISAPPROVED

SIGNATURE

SKETCH PLAN



CITY OF NEW BEDFORD
MASSACHUSETTS

DEPT. OF PUBLIC WORKS

133 WILLIAM STREET

LAWRENCE D. WORDEN
COMMISSIONER

To Whom It May Concern:

I, Long Built Homes, 158 Charles McCombs Blvd, being
Name Mailing Address

owner of property located at VARIOUS LOCATIONS IN NEW BEDFORD

Plot _____, Lot _____, hereby agree to allow Robert K. "CHIP" Mulford,
Name

My Attorney, PO Box 517, FAIRHAVEN 02749 to act on my behalf,
Mailing Address

including affixing my signature, in securing permits for:

- ☒ Sewer/Drain Service Permits
- ☒ Water Service Permits
- ☒ Driveway Installation Permits
- ☒ Sidewalk Installation Permits

I further agree to confirm to, and abide by, all City rules and regulations applicable to the permits(s) being applied for.

**LONG BUILT
HOMES**

"Long" on Quality

CHIP MULFORD
CORPORATE COUNSEL &
LAND ACQUISITION

Cell: 508-965-8355
Fax: 508-995-3275

Robert K. "CHIP" Mulford
Print.
Long Built Homes, Inc.
158 CHARLES MCCOMBS BLVD
Address
New Bedford, MA 02745
October 7, 2002
Date

Website: www.longbulthomes.com

158 Charles McCombs Blvd., New Bedford, MA 02745

508-9958240

To Whom It May Concern:

Chip Mulford is Long Realty Inc.'s Corporate Attorney, and is authorized to act on the Corporation's behalf in securing permits and any and all other matters involving the DPW.

Robert F. Long
Robert F. Long
President - Long Realty Inc.