

PERMIT NO.

23333



CITY OF NEW BEDFORD

DATE.....2-13-

SEWER AND/OR STORM DRAIN PERMIT

This certifies that permission is granted to

MARITIME INT. INC. / BRIDGETER INC. 12 FISH ISLAND N.B. MA. 02740

Property Owner

Address

Tel (508) 994-4300

to connect a sewer and/or storm drain located at..... 4 FISH ISLAND

Assessor's Plot..... 60....., Lot..... 30....., to the sewer and/or storm drain in..... FISH ISLAND..... Street

to be laid in accordance with the conditions in this application and the City of New Bedford ordinances.

TYPE OF USE: ☐ RESIDENTIAL ☒ COMMERCIAL ☐ INDUSTRIAL ☐ OTHER

2006 P.D.

If applicant other than actual property owner, attach Letter of Authorization from Property Owner.

Name..... SCOTT FRANKLIN

Tel. (508) 998-8270

Mailing Address..... 4393 ACUSHNET AVE. N.B. MA. 02745

The Bonded Contractor/Drain Layer authorized to perform this work is:

(SC) FRANKLIN BROS

4393 ACUSHNET AVE. N.B. MA.

(508) 998-8270

Name

Address

Tel.

Type of Pipe Required:..... PVC SDR 35 (LOW PRESSURE LINE)

PERMIT EXPIRES ONE YEAR AFTER DATE OF ISSUE

- * Requires separate connections for sewage and storm drain where applicable. Storm water cannot be discharged to a sanitary sewer.
- * All work must be inspected and approved by a D.P.W. inspector before backfilling.
- * If this connection is to be part of a private service shared jointly with other building owners, attach copy of Recorded Joint Maintenance Agreement.
- * Permits can be issued to Industrial and/or Commercial Applicants only upon receipt and approval by the Commissioner of Public Works of required plans and supplemental information.
- * In addition, a City-issued Industrial User Discharge Permit and/or a Sewer Extension/Connection Permit issued by the Commonwealth of Massachusetts D.E.P. shall be required by the City for Industrial Discharge into the sewer system.

Industrial User Discharge Permit No..... N/A..... Date.....

Comm. Mass. Sewer Conn./Ext. Permit No..... N/A..... Date.....

A Filing and Inspection Fee of \$..... 150.00....., plus an Entrance Fee of \$..... N/A..... where applicable, must accompany this application.

Bank #..... CITIZENS BANK..... Check #..... 1294..... Date:..... 2-13-03..... Receipt #..... 4516

Other requirements:..... INSPECTION ONLY..... Per Scott F., all set - dent manhole.....

2" LOW PRESSURE LINE OR PER P.A. Industrial User Permit per Scott F. only hooking up 2 bathrooms.

☒ Sewer

Connection made to

Part of jointly-shared private line ☐ Yes ☒ No

☐ Storm Drain

Applicant agrees to abide by the above terms, as well as all pertinent ordinances of the City of New Bedford, and such other special rules as the Commissioner of Public Works may deem necessary

Commissioner of Public Works

Signature of Property Owner or Representative

INSPECTED BY:..... JOSEPH MART

DATE:..... 3/18/03

COMMENTS:.....

☒ APPROVED

☐ DISAPPROVED

SIGNATURE

31-746

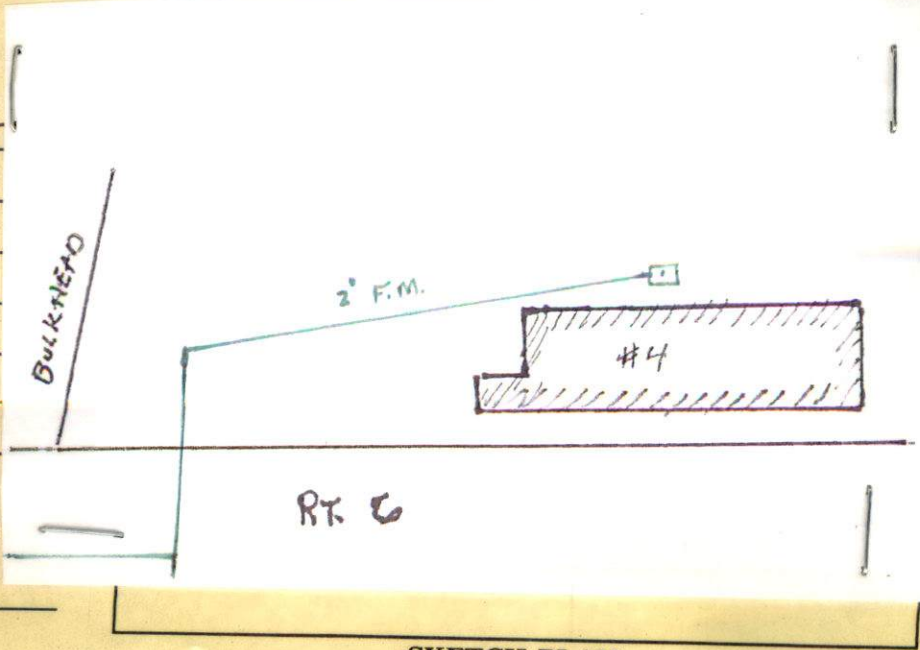

SKETCH PLAN

PERMIT NO.

23333



CITY OF NEW BEDFORD

DATE 2-13-03

SEWER AND/OR STORM DRAIN PERMIT

This certifies that permission is granted to

MARITIME INT. INC / BRIDGETER INC 12 FISH ISLAND N.B. MA 02740
 Property Owner Address Tel (508) 994-4300

to connect a sewer and/or storm drain located at 4 FISH ISLAND
 Assessor's Plot 60, Lot 30, to the sewer and/or storm drain in FISH ISLAND Street
 to be laid in accordance with the conditions in this application and the City of New Bedford ordinances.

TYPE OF USE: ☐ RESIDENTIAL ☒ COMMERCIAL ☐ INDUSTRIAL ☐ OTHER

2006 P.D.

If applicant other than actual property owner, attach Letter of Authorization from Property Owner.

Name SCOTT FRANKLIN Tel (508) 998-8270

Mailing Address 4393 ACUSHNET AVE N.B. MA 02745

The Bonded Contractor/Drain Layer authorized to perform this work is:

(SC) FRANKLIN BROS 4393 ACUSHNET AVE N.B. MA (508) 998-8270
 Name Address Tel

Type of Pipe Required: PVC SDR 35 (2" LOW PRESSURE LINE)

PERMIT EXPIRES ONE YEAR AFTER DATE OF ISSUE

* Requires separate connections for sewage and storm drain where applicable. Storm water cannot be discharged to a sanitary sewer.

* All work must be inspected and approved by a D.P.W. inspector before backfilling.

* If this connection is to be part of a private service shared jointly with other building owners, attach copy of Recorded Joint Maintenance Agreement.

* Permits can be issued to Industrial and/or Commercial Applicants only upon receipt and approval by the Commissioner of Public Works of required plans and supplemental information.

* In addition, a City-issued Industrial User Discharge Permit and/or a Sewer Extension/Connection Permit issued by the Commonwealth of Massachusetts D.E.P. shall be required by the City for Industrial Discharge into the sewer system.

Industrial User Discharge Permit No. N/A Date

Comm. Mass. Sewer Conn./Ext. Permit No. N/A Date

A Filing and Inspection Fee of \$150.00, plus an Entrance Fee of \$ N/A, where applicable, must accompany this application.

Bank CITIZENS BANK Check # 1294 Date 2-13-03 Receipt # 4516

Other requirements: INSPECTION ONLY Per Ron Labelle, all set - don't require
 2" LOW PRESSURE LINE OR PER P.A. Industrial User Permit or related paperwork
 per Scott F., only hooking up 2 bathrooms.

☒ Sewer

Connection made to

Part of jointly-shared private line ☐ Yes ☒ No

☐ Storm Drain

Applicant agrees to abide by the above terms, as well as all pertinent ordinances of the City of New Bedford, and such other special rules as the Commissioner of Public Works may deem necessary

Lawrence D. Warden/for
 Commissioner of Public Works

Signature of Property Owner or Representative

INSPECTOR'S REPORT

INSPECTED BY:

DATE:

COMMENTS:

☐ APPROVED

☐ DISAPPROVED

SIGNATURE

SKETCH PLAN



BRIDGE TERMINAL INC.

12 FISH ISLAND

NEW BEDFORD, MASSACHUSETTS 02740 USA

TELEPHONE #508+994-4300

FAX #508+992-6267

February 5, 2003

City of New Bedford
Department of Public Works
133 Williams Street
New Bedford, MA 02740

To Whom It May Concern:

I Timothy M. Ray, Chief Operating Officer of Bridge Terminal, Inc.
authorize Scott Franklin to apply for a sewer tie in permit, on our behalf, at 4 Fish
Island, New Bedford, MA 02740.

Regards,

Timothy M. Ray
Chief Operating Officer