

PERMIT NO.

23331



CITY OF NEW BEDFORD

DATE 2/13/03
EXP 2/13/04

SEWER AND/OR STORM DRAIN PERMIT

This certifies that permission is granted to

Phillips Rd. Inc. / Monica White Pro. 867 Middle Rd. Acushnet MA 02713
Property Owner Address 30 Tel. (508) 763-8868

to connect a sewer and/or storm drain located at Stephanie Pl. (ES.) 100' 41' S. / Monica's Way
Assessor's Plot 132J Lot 121 to the sewer and/or storm drain in Stephanie Pl. Street

to be laid in accordance with the conditions in this application and the City of New Bedford ordinances.

TYPE OF USE: ☒ RESIDENTIAL ☐ COMMERICAL ☐ INDUSTRIAL ☐ OTHER

If applicant other than actual property owner, attach Letter of Authorization from Property Owner.

Name Larry Mottly Inc. / Robert Henry aka Robert K. "Chip" Mufford Tel. (508) 965-8355 X-12

Mailing Address 138 Charles McCombs Blvd. New Bedford MA 02745

The Bonded Contractor/Drain Layer authorized to perform this work is:

D.W. White 867 Middle Rd. Acushnet MA 02713 (508) 763-8868
Name Address Tel.

Type of Pipe Required: PVC SD16 35

PERMIT EXPIRES ONE YEAR AFTER DATE OF ISSUE

- * Requires separate connections for sewage and storm drain where applicable. Storm water cannot be discharged to a sanitary sewer.
- * All work must be inspected and approved by a D.P.W. inspector before backfilling.
- * If this connection is to be part of a private service shared jointly with other building owners, attach copy of Recorded Joint Maintenance Agreement.
- * Permits can be issued to Industrial and/or Commercial Applicants only upon receipt and approval by the Commissioner of Public Works of required plans and supplemental information.
- * In addition, a City-issued Industrial User Discharge Permit and/or a Sewer Extension/Connection Permit issued by the Commonwealth of Massachusetts D.E.P. shall be required by the City for Industrial Discharge into the sewer system.

Industrial User Discharge Permit No. N/A Date N/A
Comm. Mass. Sewer Conn./Ext. Permit No. N/A Date N/A

A Filing and Inspection Fee of \$ 150.00, plus an Entrance Fee of \$ — where applicable, must accompany this application.

Bank # COMPASS BANK Check # 28333 Date: 2-13-03 Receipt # 4513

Other requirements: Inspection Only - Danson Valley Subdivision - connecting to 8" sewer and 12" storm drain in Stephanie Place

Connection made to ☒ Sewer ☐ Storm Drain
Part of jointly-shared private line ☐ Yes ☒ No

Applicant agrees to abide by the above terms, as well as all pertinent ordinances of the City of New Bedford, and such other special rules as the Commissioner of Public Works may deem necessary

Lavonne D. Woburn
Commissioner of Public Works

Chip Mufford
Signature of Property Owner or Representative

INSPECTOR'S REPORT

INSPECTED BY: _____

DATE: _____

COMMENTS: _____

☐ APPROVED ☐ DISAPPROVED

SIGNATURE

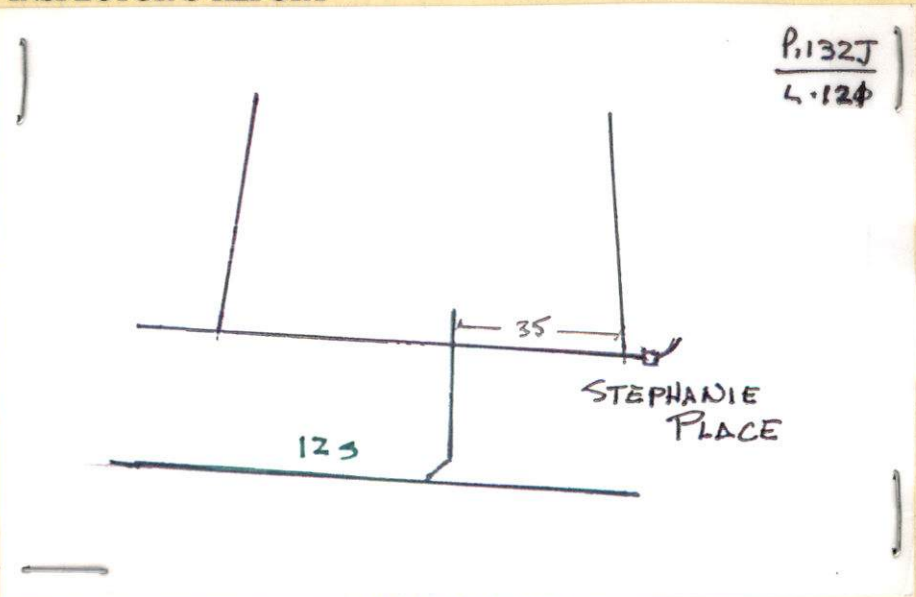

SKETCH PLAN

PERMIT NO.

23331



CITY OF NEW BEDFORD

SEWER AND/OR STORM DRAIN PERMIT

DATE 2/13/03
EXP 2/13/04

This certifies that permission is granted to

Phillips Rd. Inc. / Mark W. White, Pres. 867 Middle Rd. Acushnet MA 02743

Property Owner

Address X30

Tel. (508) 763-8868

to connect a sewer and/or storm drain located at Stephanie Pl. (E.S.) 100' S. / Monica's Way

Assessor's Plot 132J Lot 121 to the sewer and/or storm drain in Stephanie Pl. Street

to be laid in accordance with the conditions in this application and the City of New Bedford ordinances.

TYPE OF USE: ☒ RESIDENTIAL ☐ COMMERCIAL ☐ INDUSTRIAL ☐ OTHER

If applicant other than actual property owner, attach Letter of Authorization from Property Owner.

Name Long Realty Inc. / Robert Long c/o Ralph H. Chipmunk Tel. (508) 965-8355 X-12

Mailing Address 158 Charles McCombs Blvd. New Bedford MA 02745

The Bonded Contractor/Drain Layer authorized to perform this work is:

D.W. White 867 Middle Rd. Acushnet MA 02743 (508) 763-8868

Name

Address

Tel.

Type of Pipe Required: PVC SDR 35

PERMIT EXPIRES ONE YEAR AFTER DATE OF ISSUE

* Requires separate connections for sewage and storm drain where applicable. Storm water cannot be discharged to a sanitary sewer.

* All work must be inspected and approved by a D.P.W. inspector before backfilling.

* If this connection is to be part of a private service shared jointly with other building owners, attach copy of Recorded Joint Maintenance Agreement.

* Permits can be issued to Industrial and/or Commercial Applicants only upon receipt and approval by the Commissioner of Public Works of required plans and supplemental information.

* In addition, a City-issued Industrial User Discharge Permit and/or a Sewer Extension/Connection Permit issued by the Commonwealth of Massachusetts D.E.P. shall be required by the City for Industrial Discharge into the sewer system.

Industrial User Discharge Permit No. N/A Date.

Comm. Mass. Sewer Conn./Ext. Permit No. N/A Date.

A Filing and Inspection Fee of \$150.00, plus an Entrance Fee of \$..... where applicable, must accompany this application.

Bank # COMPASS BANK Check # 28333 Date: 2-13-03 Receipt # 4513

Other requirements: Inspection Only - Danson Valley Subdivision - connecting to 8" sewer and 12" storm drain in Stephanie Pl.

☒ Sewer

Connection made to

Part of jointly-shared private line ☐ Yes ☒ No

☒ Storm Drain

Applicant agrees to abide by the above terms, as well as all pertinent ordinances of the City of New Bedford, and such other special rules as the Commissioner of Public Works may deem necessary

Lawrence D. Worden
Commissioner of Public Works

Chipmunk
Signature of Property Owner or Representative

INSPECTOR'S REPORT

INSPECTED BY: _____

DATE: _____

COMMENTS: _____

☐ APPROVED

☐ DISAPPROVED

SIGNATURE

SKETCH PLAN



CITY OF NEW BEDFORD
MASSACHUSETTS

DEPT. OF PUBLIC WORKS

133 WILLIAM STREET

LAWRENCE D. WORDEN
COMMISSIONER

To Whom It May Concern:

I, Long Built Homes, 158 Charles McCombs Blvd, being
Name Mailing Address

owner of property located at VARIOUS LOCATIONS IN NEW BEDFORD

Plot _____, Lot _____, hereby agree to allow Robert K. "Chip" Mulford
Name

My Attorney, PO Box 517, Fairhaven 02749 to act on my behalf,
Mailing Address

including affixing my signature, in securing permits for:

- ☒ Sewer/Drain Service Permits
- ☒ Water Service Permits
- ☒ Driveway Installation Permits
- ☒ Sidewalk Installation Permits

I further agree to confirm to, and abide by, all City rules and regulations applicable to the permits(s) being applied for.

**LONG BUILT
HOMES**

"Long" on Quality

CHIP MULFORD
CORPORATE COUNSEL &
LAND ACQUISITION

Cell: 508-965-8355
Fax: 508-995-3275

Website: www.longbulthomes.com

158 Charles McCombs Blvd., New Bedford, MA 02745

Robert K. "Chip" Mulford
Print
Long Built Homes, Inc.
158 Charles McCombs Blvd
Address
New Bedford, MA 02745
August 7, 2002
Date

To Whom It May Concern:

Chip Mulford is Long Realty Inc.'s Corporate Attorney, and is authorized to act on the Corporation's behalf in securing permits and any and all other matters involving the DPW.

Robert F. Long
PRESIDENT & TREASURER

Phillips Road Inc.

**867 Middle Road
Acushnet, MA 02743**

(508) 763-8468

City of New Bedford
Various Departments
William Street
New Bedford, MA 02740

To Whom It May Concern:

This letter will certify that Long Realty Inc. has permission from Phillips Road Inc. to draw down the necessary permits and construct new homes on the lots comprising our Dawson Valley subdivision, which is off Phillips Road in New Bedford.

Sincerely,

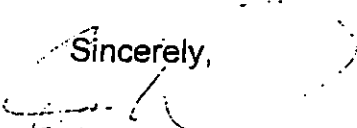
Mark W. White
President
Phillips Road Inc.



CITY OF NEW BEDFORD

532

NO. 166-03

LICENSE NO. _____

DATE 2/13 2003

FOUNDATION PERMIT

MSBC Sect. 111.8 – Any permit issued shall be deemed abandoned and invalid unless the work authorized by it shall have been commenced within six (6) months after its issuance.

This certifies that LONG BUILT HOMES, owner/contractor

has permission to INSTALL FOUNDATION

on STEPHANIE PLACE LOT 121

providing that the person accepting this permit shall in every respect conform to the terms of the application therefor on file in this office; to the provisions of the Statute of the Commonwealth and to the By-Laws of the City of New Bedford relating to the Inspection, Erection, Enlarging, Altering, Raising, Moving, Repairing or Tearing Down of a Building.

WIRING INSPECTOR

PLUMBING INSPECTOR

BUILDING INSPECTOR

ROUGH FINISH

YOUR AREA INSPECTOR IS: _____

– Tel. 979-1540 Between 8:00 AM – 9:00 AM

NOTICE: NOTIFY INSPECTOR 48 HOURS
IN ADVANCE OF APPLYING
SHEATING OR LATHING

OCCUPANCY PERMIT REQUIRED BEFORE OCCUPANCY

No Building or Structure shall be used or occupied until the Certificate of Use and Occupancy shall have been issued by the Building Commissioner – MSBC. Sect. 120.1 – N.B. Zoning Ord. Sect. 9-269

THIS CARD MUST BE DISPLAYED IN A CONSPICUOUS PLACE ON THE PREMISES
AND NOT TORN DOWN OR REMOVED UNTIL COMPLETION OF WORK

SUBJECT TO MASSACHUSETTS STATE
BUILDING CODE REQUIREMENTS

BUILDING INSPECTOR