

PERMIT NO.

23318



CITY OF NEW BEDFORD

DATE.....1-7-03

SEWER AND/OR STORM DRAIN PERMIT

This certifies that permission is granted to

ISABEL H. PERRY, 1143 Tudor Rd. N. Dartmouth MA 02747

Property Owner Casa Sol Address #46

Tel. (508) 993-4552

to connect a sewer and/or storm drain located at WHITELOCK ST. 440' ± W/MT. PLEASANT ST.

Assessor's Plot 123 B, Lot 602, to the sewer and/or storm drain in WHITELOCK ST. Street

to be laid in accordance with the conditions in this application and the City of New Bedford ordinances.

TYPE OF USE: ☒ RESIDENTIAL ☐ COMMERICAL ☐ INDUSTRIAL ☐ OTHER

330 GPD

If applicant other than actual property owner, attach Letter of Authorization from Property Owner.

Name Curt M. Perry Tel. (508) 993-4552

Mailing Address 1143 Tudor Rd. N. Dartmouth MA 02747

The Bonded Contractor/Drain Layer authorized to perform this work is: Sub at R.

CARDOSO CMT.

MAR 14 2003  
DEPT. OF PUBLIC WORKS  
NEW BEDFORD, MASS  
Tel.

Name

Address

Type of Pipe Required: PVC SDR 35

PERMIT EXPIRES ONE YEAR AFTER DATE OF ISSUE

\* Requires separate connections for sewage and storm drain where applicable. Storm water cannot be discharged to a sanitary sewer.

\* All work must be inspected and approved by a D.P.W. inspector before backfilling.

\* If this connection is to be part of a private service shared jointly with other building owners, attach copy of Recorded Joint Maintenance Agreement.

\* Permits can be issued to Industrial and/or Commercial Applicants only upon receipt and approval by the Commissioner of Public Works of required plans and supplemental information.

\* In addition, a City-issued Industrial User Discharge Permit and/or a Sewer Extension/Connection Permit issued by the Commonwealth of Massachusetts D.E.P. shall be required by the City for Industrial Discharge into the sewer system.

Industrial User Discharge Permit No. Date

Comm. Mass. Sewer Conn./Ext. Permit No. Date

A Filing and Inspection Fee of \$150.00 plus an Entrance Fee of \$279.45 where applicable, must accompany this application.

Bank # COMPASS Check # 2078 Date: 1-8-03 Receipt # 4496

Other requirements: SUB 345 @ 8.10/ft = \$279.45 and Inspection Fee = \$150.00

Aviation Way Sewer-Kittanning Project

Total: \$429.45

Connection made to ☒ Sewer Part of jointly-shared private line ☐ Yes ☒ No

☐ Storm Drain

Applicant agrees to abide by the above terms, as well as all pertinent ordinances of the City of New Bedford, and such other special rules as the Commissioner of Public Works may deem necessary

Lawrence D. Mordant  
Commissioner of Public Works

Signature of Property Owner or Representative

INSPECTOR'S REPORT

INSPECTED BY: JOSEPH MARTIN

DATE: 3/12/03

COMMENTS: Inspected by Joe from

prop. line to house. Stub installed

& inspected by CDM on Aviation

Way sewer project. Plotted

4/1/03.

☒ APPROVED ☐ DISAPPROVED

Signature

31-746

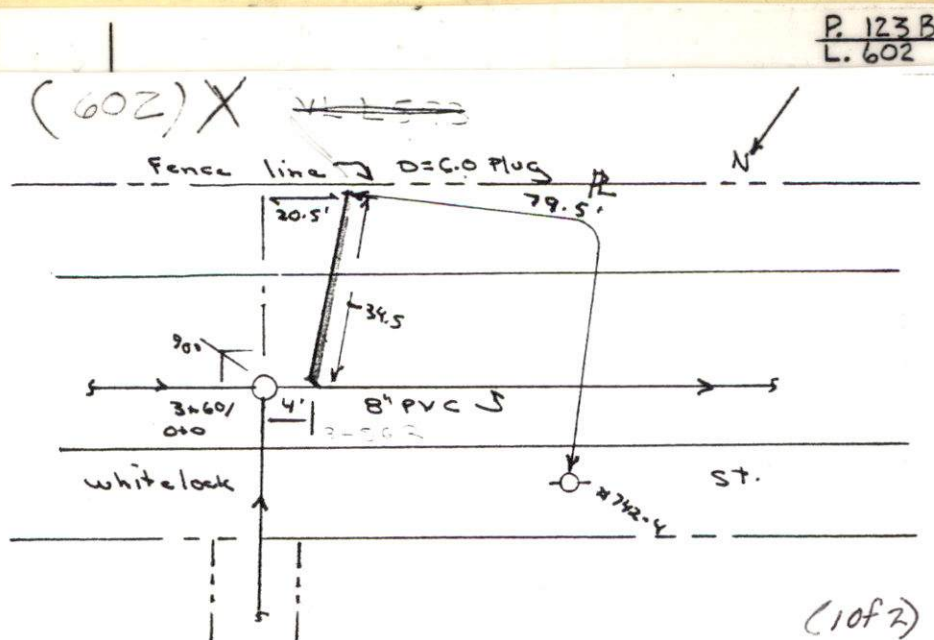



PERMIT NO.:

23318



CITY OF NEW BEDFORD

DATE.....1-7-03.....

SEWER AND/OR STORM DRAIN PERMIT

This certifies that permission is granted to

ISABEL M. PERRY, 1143 Tudor Rd. N. Dartmouth MA 02747

Property Owner Casa Sol Address

Tel. (508) 993-4552

to connect a sewer and/or storm drain located at WHITELOCK ST. 740' ± W/ MT. PLEASANT ST.

Assessor's Plot 123 B, Lot 602, to the sewer and/or storm drain in WHITELOCK ST. Street

to be laid in accordance with the conditions in this application and the City of New Bedford ordinances.

TYPE OF USE: ☒ RESIDENTIAL ☐ COMMERCIAL ☐ INDUSTRIAL ☐ OTHER

330 GPD

If applicant other than actual property owner, attach Letter of Authorization from Property Owner.

Name Curt M. Perry Tel. (508) 993-4552

Mailing Address 1143 Tudor Rd. N. Dartmouth MA 02747

The Bonded Contractor/Drain Layer authorized to perform this work is: Sub at R.

CARDOSO CMT

Name

Address

Tel.

Type of Pipe Required: PVC SDR 35

PERMIT EXPIRES ONE YEAR AFTER DATE OF ISSUE

\* Requires separate connections for sewage and storm drain where applicable. Storm water cannot be discharged to a sanitary sewer.

\* All work must be inspected and approved by a D.P.W. inspector before backfilling.

\* If this connection is to be part of a private service shared jointly with other building owners, attach copy of Recorded Joint Maintenance Agreement.

\* Permits can be issued to Industrial and/or Commercial Applicants only upon receipt and approval by the Commissioner of Public Works of required plans and supplemental information.

\* In addition, a City-issued Industrial User Discharge Permit and/or a Sewer Extension/Connection Permit issued by the Commonwealth of Massachusetts D.E.P. shall be required by the City for Industrial Discharge into the sewer system.

Industrial User Discharge Permit No. Date

Comm. Mass. Sewer Conn./Ext. Permit No. Date

A Filing and Inspection Fee of \$150.00 plus an Entrance Fee of \$279.45 where applicable, must accompany this application.

Bank # COMPASS Check # 2078 Date: 1-8-03 Receipt # 4496

Other requirements: SUB 34.5' @ 8.10/ft = \$279.45 and Inspection Fee = \$150.00

Aviation Way Sewer Reconnect Project

Total \$429.45 ☒ Sewer

Connection made to Part of jointly-shared private line ☐ Yes ☒ No

☐ Storm Drain

Applicant agrees to abide by the above terms, as well as all pertinent ordinances of the City of New Bedford, and such other special rules as the Commissioner of Public Works may deem necessary

Lawrence D. Worden, Jr.  
Commissioner of Public Works

Signature of Property Owner or Representative

INSPECTOR'S REPORT

INSPECTED BY: \_\_\_\_\_

DATE: \_\_\_\_\_

COMMENTS: \_\_\_\_\_

\_\_\_\_\_

\_\_\_\_\_

\_\_\_\_\_

☐ APPROVED

☐ DISAPPROVED

SIGNATURE

SKETCH PLAN



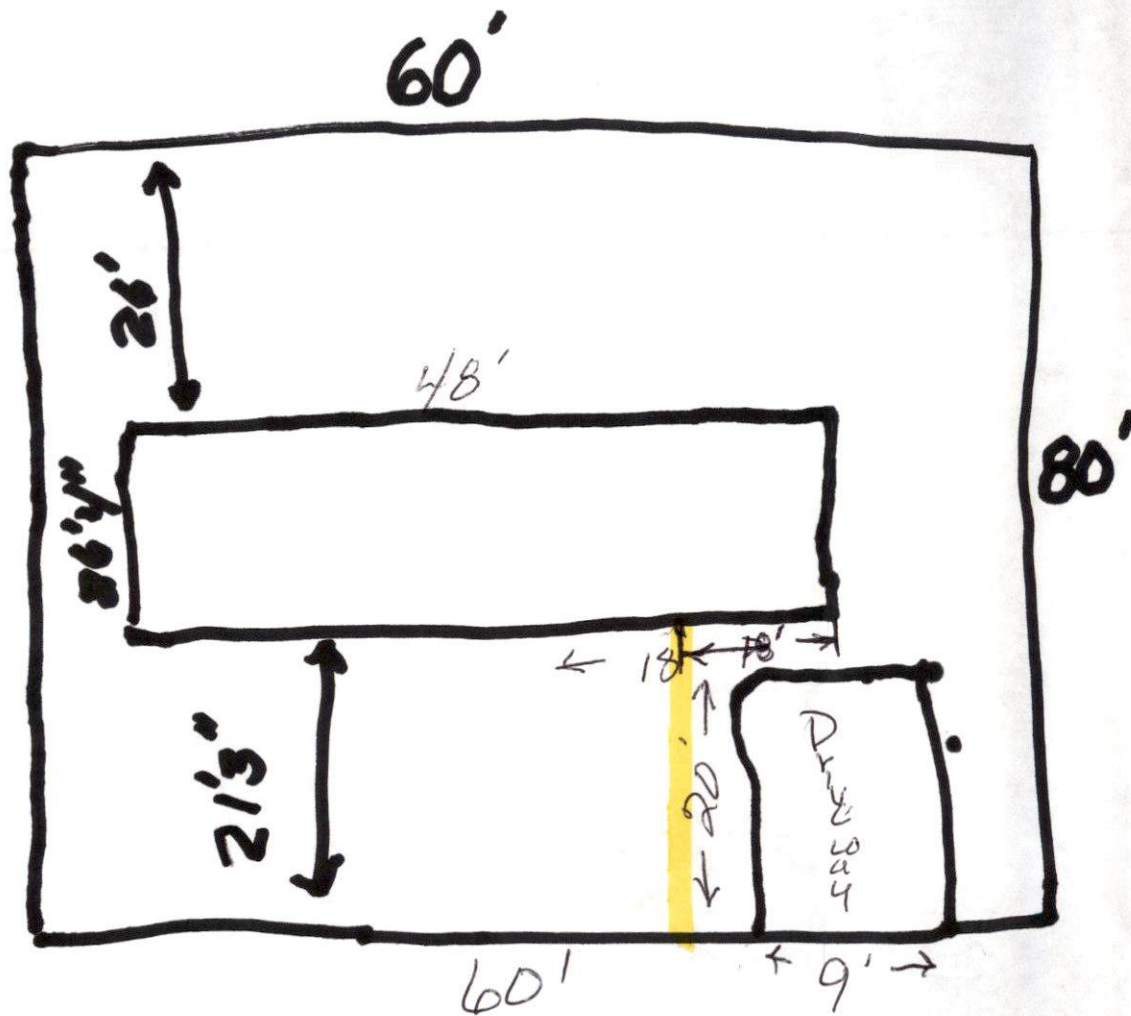

WhiteLock St.  
MAP 123B  
Lot 602

White Lock

8" PVC  
**SEWER**



CITY OF NEW BEDFORD  
MASSACHUSETTS

DEPARTMENT OF PUBLIC WORKS  
ENGINEERING DIVISION  
133 WILLIAM STREET, ROOM 303  
NEW BEDFORD, MA 02740  
Tel: (508) 979-1527  
Fax: (508) 961-3043

To Whom It May Concern:

I, Isabel N. Perry 1143 Tucker Rd. No. Dart, being  
(Name) (Mailing Address)

Owner of property located at White lock St, N.B.

Plot 123B Lot 602, hereby agree to allow Curtis N. Perry  
(Name)

Sane to act on my behalf including affixing my  
(Mailing Address)

signature in securing permit for:

- ☒ Sewer/Drain Service Permits
- ☒ Water Service Permits
- ☒ Driveway Installation Permits
- ☒ Sidewalk Installation Permits

I further agree to conform to, and abide by, all City rules and ask regulations applicable to the permit (s) being applied for:

Name Isabel N. Perry  
(Signature)

1143 Tucker Rd. No. Dart. N.B.  
(Address)

1/7/03  
(Date) (Telephone number)