

PERMIT NO.



CITY OF NEW BEDFORD

DATE 1-6-03

23317

SEWER AND/OR STORM DRAIN PERMIT

This certifies that permission is granted to
LONG BUILT HOMES FOR PHILLIPS RD. INC. 867 MIDDLE RD ACUSHNET MA 07743
 Property Owner Address #10 Tel.
 to connect a sewer and/or storm drain located at MONICA'S WAY 100'± E/PHILLIPS RD.
 Assessor's Plot 132-7, Lot 115, to the sewer and/or storm drain in STEPHANIE PLACE Street
 to be laid in accordance with the conditions in this application and the City of New Bedford ordinances.

TYPE OF USE: ☒ RESIDENTIAL ☐ COMMERICAL ☐ INDUSTRIAL ☐ OTHER 330 GPD

If applicant other than actual property owner, attach Letter of Authorization from Property Owner.
 Name CHIP MULFORD FOR LONG BUILT HOMES Tel. (508) 965-8355
 Mailing Address 158 CHARLES McCOMBS BLVD. N.B. MA.

The Bonded Contractor/Drain Layer authorized to perform this work is:
D.W. WHITE
 Name Address Tel.

Type of Pipe Required: PVC 35
 PERMIT EXPIRES ONE YEAR AFTER DATE OF ISSUE

- * Requires separate connections for sewage and storm drain where applicable. Storm water cannot be discharged to a sanitary sewer.
- * All work must be inspected and approved by a D.P.W. inspector before backfilling.
- * If this connection is to be part of a private service shared jointly with other building owners, attach copy of Recorded Joint Maintenance Agreement.
- * Permits can be issued to Industrial and/or Commercial Applicants only upon receipt and approval by the Commissioner of Public Works of required plans and supplemental information.
- * In addition, a City-issued Industrial User Discharge Permit and/or a Sewer Extension/Connection Permit issued by the Commonwealth of Massachusetts D.E.P. shall be required by the City for Industrial Discharge into the sewer system.

Industrial User Discharge Permit No. N/A Date
 Comm. Mass. Sewer Conn./Ext. Permit No. N/A Date

A Filing and Inspection Fee of \$ 150.00, plus an Entrance Fee of \$ where applicable, must accompany this application.

Bank # COMPASS BANK Check # 27914 Date: 1-6-03 Receipt # 4495

Other requirements: INSPECTION ONLY.

Connection made to ☒ Sewer ☒ Storm Drain Part of jointly-shared private line ☐ Yes ☒ No

Applicant agrees to abide by the above terms, as well as all pertinent ordinances of the City of New Bedford, and such other special rules as the Commissioner of Public Works may deem necessary

[Signature] Commissioner of Public Works
[Signature] Signature of Property Owner or Representative

INSPECTED BY: _____
 DATE: _____
 COMMENTS: _____

☐ APPROVED ☐ DISAPPROVED

SIGNATURE

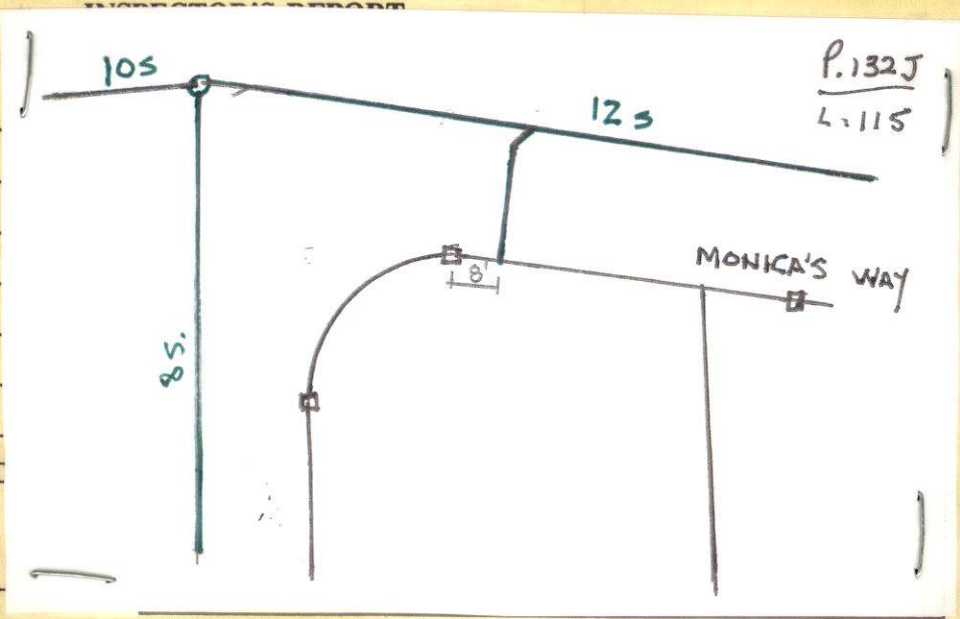

SKETCH PLAN

PERMIT NO. -

23317



CITY OF NEW BEDFORD

DATE...1-6-03

SEWER AND/OR STORM DRAIN PERMIT

This certifies that permission is granted to

LONG BUILT HOMES FOR PHILLIPS RD. INC 867 MIDDLE RD ACUSHNET MA 07743
Property Owner Address X10 Tel.

to connect a sewer and/or storm drain located at MONICAS WAY 100'± E/PHILLIPS RD.
Assessor's Plot 132.7, Lot 115, to the sewer and/or storm drain in STEPHANIE PLACE Street

to be laid in accordance with the conditions in this application and the City of New Bedford ordinances.

TYPE OF USE: ☒ RESIDENTIAL ☐ COMMERICAL ☐ INDUSTRIAL ☐ OTHER

330 GPD

If applicant other than actual property owner, attach Letter of Authorization from Property Owner.

Name CHIP MULFORD FOR LONG BUILT HOMES Tel. (508) 965-8355

Mailing Address 158 CHARLES MCCOMBS BLVD. U.B. MA.

The Bonded Contractor/Drain Layer authorized to perform this work is:

D.W. WHITE
Name Address Tel.

Type of Pipe Required: PVC SDR 35

PERMIT EXPIRES ONE YEAR AFTER DATE OF ISSUE

* Requires separate connections for sewage and storm drain where applicable. Storm water cannot be discharged to a sanitary sewer.

* All work must be inspected and approved by a D.P.W. inspector before backfilling.

* If this connection is to be part of a private service shared jointly with other building owners, attach copy of Recorded Joint Maintenance Agreement.

* Permits can be issued to Industrial and/or Commercial Applicants only upon receipt and approval by the Commissioner of Public Works of required plans and supplemental information.

* In addition, a City-issued Industrial User Discharge Permit and/or a Sewer Extension/Connection Permit issued by the Commonwealth of Massachusetts D.E.P. shall be required by the City for Industrial Discharge into the sewer system.

Industrial User Discharge Permit No. N/A Date.

Comm. Mass. Sewer Conn./Ext. Permit No. N/A Date.

A Filing and Inspection Fee of \$150.00, plus an Entrance Fee of \$ where applicable, must accompany this application.

Bank # COMPASS BANK Check # 27914 Date: 1-6-03 Receipt # 4495

Other requirements: INSPECTION ONLY.

Connection made to ☒ Sewer ☒ Storm Drain Part of jointly-shared private line ☐ Yes ☒ No

Applicant agrees to abide by the above terms, as well as all pertinent ordinances of the City of New Bedford, and such other special rules as the Commissioner of Public Works may deem necessary

Commissioner of Public Works

Signature of Property Owner or Representative

INSPECTOR'S REPORT

INSPECTED BY:

DATE:

COMMENTS:

☐ APPROVED ☐ DISAPPROVED

SIGNATURE

SKETCH PLAN



**CITY OF NEW BEDFORD
MASSACHUSETTS**

DEPT. OF PUBLIC WORKS

133 WILLIAM STREET

**LAWRENCE D. WORDEN
COMMISSIONER**

To Whom It May Concern:

I, Long Built Homes, 158 Charles McCombs Blvd, being
Name Mailing Address

owner of property located at: VARIOUS LOCATIONS IN NEW BEDFORD

Plot 132-J, Lot 115, hereby agree to allow Ralph K "CHIP" Mulford,
Name

My Attorney, PO Box 017, Fairhaven 02749 to act on my behalf,
Mailing Address

including affixing my signature, in securing permits for:

<input checked="" type="checkbox"/>	Sewer/Drain Service Permits
<input checked="" type="checkbox"/>	Water Service Permits
<input checked="" type="checkbox"/>	Driveway Installation Permits
<input checked="" type="checkbox"/>	Sidewalk Installation Permits

I further agree to confirm to, and abide by, all City rules and regulations applicable to the permits(s) being applied for.

**LONG BUILT
HOMES**

"Long" on Quality

CHIP MULFORD
CORPORATE COUNSEL &
LAND ACQUISITION

Cell: 508-965-8355
Fax: 508-995-3275

Website: www.longbuilthomes.com
158 Charles McCombs Blvd., New Bedford, MA 02745

[Signature]
Print
LONG, Robert, Inc
158 CHARLES MC COMBS BLVD
Address
NEW BEDFORD, MA 02745
August 2, 2002
Date

To Whom It May Concern:

Chip Mulford is Long Realty Inc's Corporate Attorney, and is authorized to act on the Corporation's behalf in securing permits and any and all other matters involving the DPW.

[Signature]
ROBERT F. LONG
PRESIDENT & TREASURER

Phillips Road Inc.

**867 Middle Road
Acushnet, MA 02743**

City of New Bedford
Various Departments
William Street
New Bedford, MA 02740

PLOT # 132-A.
LOT # 115

To Whom It May Concern:

This letter will certify that Long Realty Inc. has permission from Phillips Road Inc. to draw down the necessary permits and construct new homes on the lots comprising our Dawson Valley subdivision, which is off Phillips Road in New Bedford.

Sincerely,

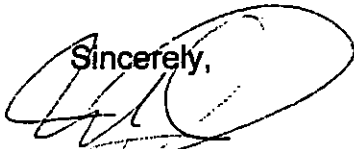

Mark W. White
President
Phillips Road Inc.



CITY OF NEW BEDFORD

016

NO. 10-03

LICENSE NO. _____

DATE 1-3 20 02

FOUNDATION PERMIT

MSBC Sect. 111.8 – Any permit issued shall be deemed abandoned and invalid unless the work authorized by it shall have been commenced within six (6) months after its issuance.

This certifies that LONG BUILT HOMES, owner/contractor
has permission to FOUND
on MONICA'S WY LOT 115

providing that the person accepting this permit shall in every respect conform to the terms of the application therefor on file in this office; to the provisions of the Statute of the Commonwealth and to the By-Laws of the City of New Bedford relating to the Inspection, Erection, Enlarging, Altering, Raising, Moving, Repairing or Tearing Down of a Building.

WIRING INSPECTOR

PLUMBING INSPECTOR

BUILDING INSPECTOR

ROUGH FINISH

YOUR AREA INSPECTOR IS: _____

– Tel. 979-1540 Between 8:00 AM – 9:00 AM --

NOTICE: NOTIFY INSPECTOR 48 HOURS
IN ADVANCE OF APPLYING
SHEATING OR LATHING

OCCUPANCY PERMIT REQUIRED BEFORE OCCUPANCY

No Building or Structure shall be used or occupied until the Certificate of Use and Occupancy shall have been issued by the Building Commissioner – MSBC. Sect. 120.1 – N.B. Zoning Ord. Sect. 9-269

THIS CARD MUST BE DISPLAYED IN A CONSPICUOUS PLACE ON THE PREMISES
AND NOT TORN DOWN OR REMOVED UNTIL COMPLETION OF WORK

SUBJECT TO MASSACHUSETTS STATE
BUILDING CODE REQUIREMENTS

R. Brown

BUILDING INSPECTOR