

PERMIT NO.

23298



CITY OF NEW BEDFORD

DATE 10/16/02

SEWER AND/OR STORM DRAIN PERMIT

This certifies that permission is granted to

ANTONIO ALMEIDA 700 KEMPTON ST. N.B. MA. 02740 (508) 997-1124

Property Owner

Address

Tel.

to connect a sewer and/or storm drain located at HATHAWAY BLVD 465' ± W/ SHAWMUT AVE.

Assessor's Plot 89, Lot 185, to the sewer and/or storm drain in COGGESALL (DENH) & EXTEND Street

to be laid in accordance with the conditions in this application and the City of New Bedford ordinances.

TYPE OF USE: ☒ RESIDENTIAL ☐ COMMERICAL ☐ INDUSTRIAL ☐ OTHER

330 GPD

If applicant other than actual property owner, attach Letter of Authorization from Property Owner.

Name N/A Tel.

Mailing Address.

The Bonded Contractor/Drain Layer authorized to perform this work is:

JOE BRAGA BOBCAT

Name

10/17/02

Address

Tel.

Type of Pipe Required: ~~3" PVC~~ As per attached plan & detail sheet added.

PERMIT EXPIRES ONE YEAR AFTER DATE OF ISSUE by Duane Andrade - Low Pressure Main

\* Requires separate connections for sewage and storm drain where applicable. Storm water cannot be discharged to a sanitary sewer.

\* All work must be inspected and approved by a D.P.W. inspector before backfilling.

\* If this connection is to be part of a private service shared jointly with other building owners, attach copy of Recorded Joint Maintenance Agreement.

\* Permits can be issued to Industrial and/or Commercial Applicants only upon receipt and approval by the Commissioner of Public Works of required plans and supplemental information.

\* In addition, a City-issued Industrial User Discharge Permit and/or a Sewer Extension/Connection Permit issued by the Commonwealth of Massachusetts D.E.P. shall be required by the City for Industrial Discharge into the sewer system.

Industrial User Discharge Permit No. N/A Date.

Comm. Mass. Sewer Conn./Ext. Permit No. N/A Date.

A Filing and Inspection Fee of \$150.00, plus an Entrance Fee of \$..... where applicable, must accompany this application.

Bank # ~~Common Bank~~ Check # 3855 Date: 10/17/02 Receipt # 4452

Other requirements: Inspection Only - To be done as per attached sketch and must have clean out also, as per - ket attached to plan.

☒ Sewer

Connection made to

Part of jointly-shared private line ☐ Yes ☒ No

☐ Storm Drain

Applicant agrees to abide by the above terms, as well as all pertinent ordinances of the City of New Bedford, and such other special rules as the Commissioner of Public Works may deem necessary

Lawrence D. Holmes  
Commissioner of Public Works

*[Signature]*  
Signature of Property Owner or Representative

INSPECTOR'S REPORT

INSPECTED BY: Kevin J. Connel

DATE: 9-10-03

COMMENTS:

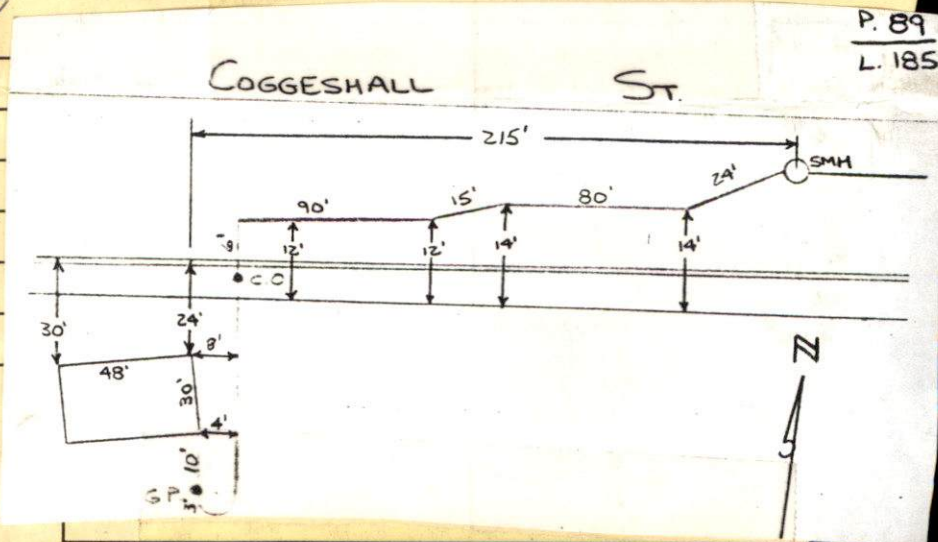

☒ APPROVED

☐ DISAPPROVED

*[Signature]*  
SIGNATURE

SKETCH PLAN



PERMIT NO:

23298



CITY OF NEW BEDFORD

DATE: 10/16/02

SEWER AND/OR STORM DRAIN PERMIT

This certifies that permission is granted to

ANTONIO ALMEIDA 700 KEMPTON ST. N.B. MA. 02740 (508) 997-1124  
Property Owner Address Tel.

to connect a sewer and/or storm drain located at HATHAWAY BLVD 465' ± W / SHAWMUT AVE.  
Assessor's Plot 89, Lot 185, to the sewer and/or storm drain in COGGESHALL (DEMH) & Extnd Street  
to be laid in accordance with the conditions in this application and the City of New Bedford ordinances.

TYPE OF USE: ☒ RESIDENTIAL ☐ COMMERICAL ☐ INDUSTRIAL ☐ OTHER

330 GPD

If applicant other than actual property owner, attach Letter of Authorization from Property Owner.

Name: N/A Tel.

Mailing Address:

The Bonded Contractor/Drain Layer authorized to perform this work is:

JOE BRAGA BOBCAT  
Name 10/17/02 Address Tel.

Type of Pipe Required: ~~SDR 35~~ PVC As per attached plan & detail sheet added.

PERMIT EXPIRES ONE YEAR AFTER DATE OF ISSUE by Duarte Andrade - Low Pressure Main

\* Requires separate connections for sewage and storm drain where applicable. Storm water cannot be discharged to a sanitary sewer.

\* All work must be inspected and approved by a D.P.W. inspector before backfilling.

\* If this connection is to be part of a private service shared jointly with other building owners, attach copy of Recorded Joint Maintenance Agreement.

\* Permits can be issued to Industrial and/or Commercial Applicants only upon receipt and approval by the Commissioner of Public Works of required plans and supplemental information.

\* In addition, a City-issued Industrial User Discharge Permit and/or a Sewer Extension/Connection Permit issued by the Commonwealth of Massachusetts D.E.P. shall be required by the City for Industrial Discharge into the sewer system.

Industrial User Discharge Permit No. N/A Date.

Comm. Mass. Sewer Conn./Ext. Permit No. N/A Date.

A Filing and Inspection Fee of \$150.00, plus an Entrance Fee of \$..... where applicable, must accompany this application.

Bank # Compass Bank Check # 3855 Date: 10/17/02 Receipt # 4452

Other requirements: Inspection Only - To be done as per attached sketch and must have clean out also, as per sketch attached to plan.

☒ Sewer

Connection made to

Part of jointly-shared private line ☐ Yes ☒ No

☐ Storm Drain

Applicant agrees to abide by the above terms, as well as all pertinent ordinances of the City of New Bedford, and such other special rules as the Commissioner of Public Works may deem necessary

Lawrence D. Warden / for  
Commissioner of Public Works

[Signature]  
Signature of Property Owner or Representative

INSPECTOR'S REPORT

INSPECTED BY: \_\_\_\_\_

DATE: \_\_\_\_\_

COMMENTS: \_\_\_\_\_

☐ APPROVED

☐ DISAPPROVED

SIGNATURE

SKETCH PLAN

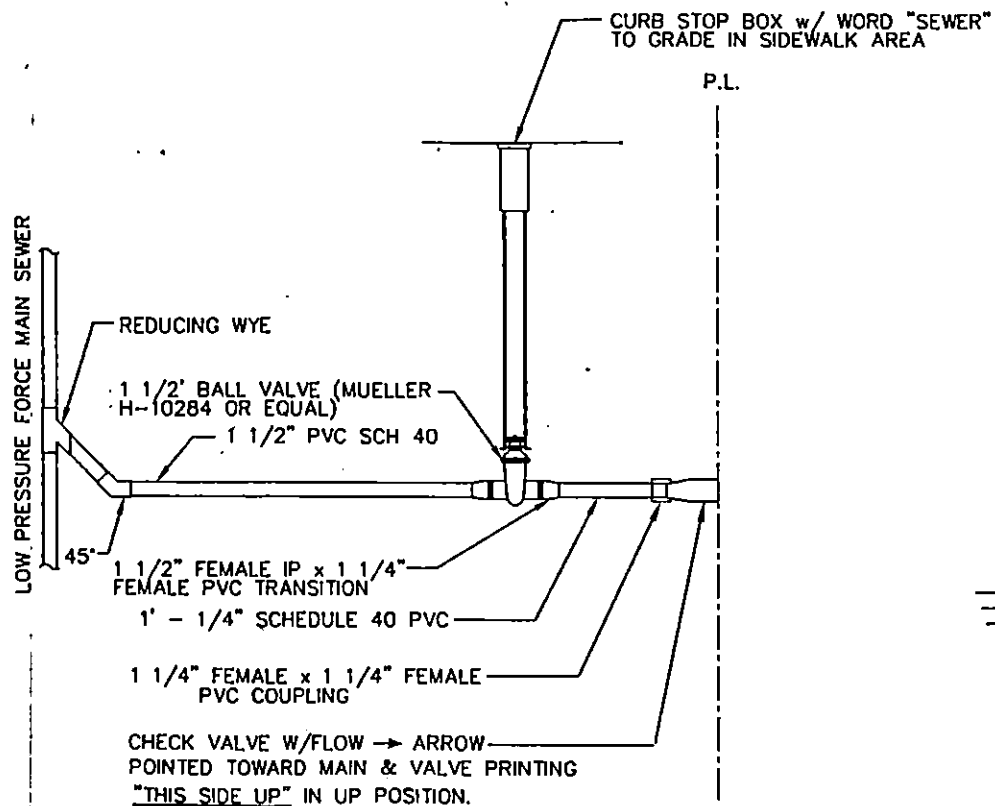

## LOW PRESURE SEWER CURB STOP

NOT TO SCALE

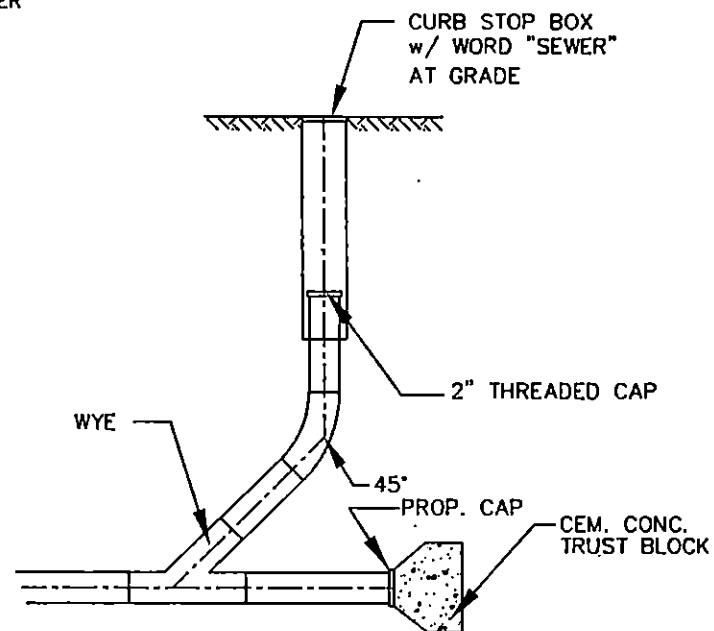

NOTE  
ALL 4" SCHEDULE 40 PVC PIPE



## SEWER CLEAN OUT

NOT TO SCALE



53

ACE BRIDA BOBEAT / CONTRACTOR  
ASSESSOR PLOT# 89

PERMIT 23298

