

PERMIT NO.

23288



CITY OF NEW BEDFORD

SEWER AND/OR STORM DRAIN PERMIT

DATE 9/25/02

RECEIVED

OCT 21 2002

DEPT. OF PUBLIC WORKS
NEW BEDFORD, MASS.

This certifies that permission is granted to

Felix Araujo 1240 Rockdale Avenue 508-992-6100
Property Owner Address Tel.

to connect a sewer and/or storm drain located at Rockdale Avenue (E.S.) 830 N. Potter St.
Assessor's Plot 81, Lot 44, to the sewer and/or storm drain in Rockdale Avenue Street
to be laid in accordance with the conditions in this application and the City of New Bedford ordinances.

TYPE OF USE: ☒ RESIDENTIAL ☐ COMMERICAL ☐ INDUSTRIAL ☐ OTHER

3306PD

If applicant other than actual property owner, attach Letter of Authorization from Property Owner.

Name Joe Braga - the contractor Tel. 508-994-7968

Mailing Address same as below

The Bonded Contractor/Drain Layer authorized to perform this work is:

Braga Bobcat Service 3 East Wendell St. S.D. 508-994-7968
Name Address Tel.

Type of Pipe Required: PVC S.D.R. 35

PERMIT EXPIRES ONE YEAR AFTER DATE OF ISSUE

- * Requires separate connections for sewage and storm drain where applicable. Storm water cannot be discharged to a sanitary sewer.
- * All work must be inspected and approved by a D.P.W. inspector before backfilling.
- * If this connection is to be part of a private service shared jointly with other building owners, attach copy of Recorded Joint Maintenance Agreement.
- * Permits can be issued to Industrial and/or Commercial Applicants only upon receipt and approval by the Commissioner of Public Works of required plans and supplemental information.
- * In addition, a City-issued Industrial User Discharge Permit and/or a Sewer Extension/Connection Permit issued by the Commonwealth of Massachusetts D.E.P. shall be required by the City for Industrial Discharge into the sewer system.

Industrial User Discharge Permit No. n/a Date

Comm. Mass. Sewer Conn./Ext. Permit No. n/a Date

A Filing and Inspection Fee of \$150.00 plus an Entrance Fee of \$308.70 where applicable, must accompany this application.

Bank # Check # Date: 9-25-02 Receipt # 377

Other requirements: inspection only - connecting to existing sewer line at property line

Connection made to ☒ Sewer ☐ Storm Drain Part of jointly-shared private line ☐ Yes ☒ No

bitterment sewer for Rowe St. area

Applicant agrees to abide by the above terms, as well as all pertinent ordinances of the City of New Bedford, and such other special rules as the Commissioner of Public Works may deem necessary

Laurence D. Worden, Jr.
Commissioner of Public Works

Signature of Property Owner or Representative

INSPECTED BY: KEN REBELLO

DATE: 9/30/02

COMMENTS: Stub to R installed & inspected by CDM-Rowe St. Sewer project. Ken Rebello inspected from stub to house.

☒ APPROVED ☐ DISAPPROVED

Ken Rebello

SIGNATURE

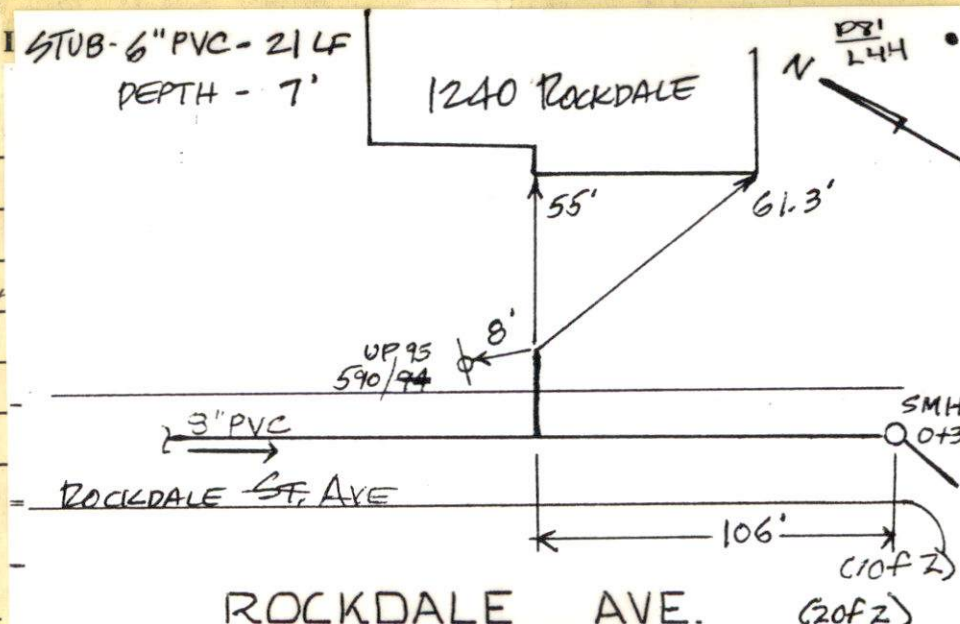

ROCKDALE AVE.

SKETCH PLAN

PERMIT NO.

23288



CITY OF NEW BEDFORD

DATE.....9/25/02.....

SEWER AND/OR STORM DRAIN PERMIT

This certifies that permission is granted to

.....Felix Araujo.....1240 Rockdale Avenue.....508-992-6708.....
Property Owner Address Tel.

to connect a sewer and/or storm drain located at.....Rockdale Avenue.....
Assessor's Plot.....81....., Lot.....44....., to the sewer and/or storm drain in.....Rockdale Avenue..... Street
to be laid in accordance with the conditions in this application and the City of New Bedford ordinances.

TYPE OF USE: ☒ RESIDENTIAL ☐ COMMERICAL ☐ INDUSTRIAL ☐ OTHER

3306PD

If applicant other than actual property owner, attach Letter of Authorization from Property Owner.

Name.....Joe Braga - the contractor.....Tel.....508-994-7968.....

Mailing Address.....same as below.....

The Bonded Contractor/Drain Layer authorized to perform this work is:

Braga Bobcat Service.....3 East Woodell St.....S.D. 508-994-7968
Name Address Tel.

Type of Pipe Required:.....P.V.C.....S.D.R.....3.5.....

PERMIT EXPIRES ONE YEAR AFTER DATE OF ISSUE

* Requires separate connections for sewage and storm drain where applicable. Storm water cannot be discharged to a sanitary sewer.

* All work must be inspected and approved by a D.P.W. inspector before backfilling.

* If this connection is to be part of a private service shared jointly with other building owners, attach copy of Recorded Joint Maintenance Agreement.

* Permits can be issued to Industrial and/or Commercial Applicants only upon receipt and approval by the Commissioner of Public Works of required plans and supplemental information.

* In addition, a City-issued Industrial User Discharge Permit and/or a Sewer Extension/Connection Permit issued by the Commonwealth of Massachusetts D.E.P. shall be required by the City for Industrial Discharge into the sewer system.

Industrial User Discharge Permit No.....n/a.....Date.....

Comm. Mass. Sewer Conn./Ext. Permit No.....n/a.....Date.....

A Filing and Inspection Fee of \$150.00 plus an Entrance Fee of \$308.70 where applicable, must accompany this application.

Bank # _____ Check # _____ Date: 9-25-02 Receipt # 377

Other requirements: inspection only - connecting to existing sewer line at.....
property line.....

Connection made to ☒ Sewer ☐ Storm Drain
Part of jointly-shared private line ☐ Yes ☒ No

betterment sewer for
Rowe St. area

Applicant agrees to abide by the above terms, as well as all pertinent ordinances of the City of New Bedford, and such other special rules as the Commissioner of Public Works may deem necessary

.....Laurence D. Worden, Jr.....
Commissioner of Public Works

.....[Signature].....
Signature of Property Owner or Representative

INSPECTOR'S REPORT

INSPECTED BY: _____

DATE: _____

COMMENTS: _____

☐ APPROVED ☐ DISAPPROVED

SIGNATURE

FOR INSPECTION ONLY, A 24 HOUR
NOTICE IS REQUIRED AND THE
CONTRACTOR/APPLICANT IS
REQUIRED TO NOTIFY THE
WASTEWATER DIVISION AT 991-6158

SKETCH PLAN



CITY OF NEW BEDFORD
MASSACHUSETTS

DEPARTMENT OF PUBLIC WORKS
ENGINEERING DIVISION
133 WILLIAM STREET, ROOM 303
NEW BEDFORD, MA 02740
Tel: (508) 979-1527
Fax: (508) 961-3043

To Whom It May Concern:

I, Felix ARAUJO 1240 Rockdale Ave., being
(Name) (Mailing Address)

Owner of property located at 1240 Rockdale Ave

Plot 81, Lot 44, hereby agree to allow JOE BRAGA
(Name)

3 East Worrell St. to act on my behalf including affixing my
(Mailing Address)

signature in securing permit for:

☒ Sewer/Drain Service Permits
☐ Water Service Permits
☐ Driveway Installation Permits
☐ Sidewalk Installation Permits

I further agree to conform to, and abide by, all City rules and ask regulations applicable to the
permit(s)-being-applied for:

Name Felix Araujo
(Signature)

1240 Rockdale Ave.
(Address)

9/25/02 (508) 9926708
(Date) (Telephone number)