

PERMIT NO.

23258



CITY OF NEW BEDFORD

SEWER AND/OR STORM DRAIN PERMIT

DATE

7-24-02  
**RECEIVED**

SEP 17 2002

DEPT. OF PUBLIC WORKS  
NEW BEDFORD, MASS 01902

This certifies that permission is granted to

DAVID G. PRENTISS TRUSTEE OF CABRAL TRUST

Property Owner

Address 700 PLEASANT ST N.3 MA. 02740 Tel.

to connect a sewer and/or storm drain located at 424 POTTER ST. (S.S.) 50' (41') E. of Rowe St.

Assessor's Plot 81, Lot 49, to the sewer and/or storm drain in POTTER Street

to be laid in accordance with the conditions in this application and the City of New Bedford ordinances.

TYPE OF USE: ☒ RESIDENTIAL ☐ COMMERICAL ☐ INDUSTRIAL ☐ OTHER

330 GPD.

If applicant other than actual property owner, attach Letter of Authorization from Property Owner.

Name.....Tel.....

Mailing Address.....

The Bonded Contractor/Drain Layer authorized to perform this work is:

TBCI.....

Name

Address

Tel.

Type of Pipe Required: PVC SDR 35

PERMIT EXPIRES ONE YEAR AFTER DATE OF ISSUE

\* Requires separate connections for sewage and storm drain where applicable. Storm water cannot be discharged to a sanitary sewer.

\* All work must be inspected and approved by a D.P.W. inspector before backfilling.

\* If this connection is to be part of a private service shared jointly with other building owners, attach copy of Recorded Joint Maintenance Agreement.

\* Permits can be issued to Industrial and/or Commercial Applicants only upon receipt and approval by the Commissioner of Public Works of required plans and supplemental information.

\* In addition, a City-issued Industrial User Discharge Permit and/or a Sewer Extension/Connection Permit issued by the Commonwealth of Massachusetts D.E.P. shall be required by the City for Industrial Discharge into the sewer system.

Industrial User Discharge Permit No. N/A Date.....

Comm. Mass. Sewer Conn./Ext. Permit No. N/A Date.....

A Filing and Inspection Fee of \$150.00, plus an Entrance Fee of \$352.80 where applicable, must accompany this application.

Bank # FIRST CITIZENS Check # 101203 Date: 7-24-02 Receipt # 4373

Other requirements: SEPTIC ABANDONEMENT ROWE ST. PERMIT. 24' X \$14.70/ft = \$352.80

+ Inspection Fee of \$150.00 Total = \$502.80

Owner/contractor to contact Health Dept. re: septic.

☒ Sewer

Connection made to

Part of jointly-shared private line ☐ Yes ☒ No

☐ Storm Drain

Applicant agrees to abide by the above terms, as well as all pertinent ordinances of the City of New Bedford, and such other special rules as the Commissioner of Public Works may deem necessary

Lawrence D. W... ..

Commissioner of Public Works

D. G. Prentiss TRUSTEE

Signature of Property Owner or Representative

INSPECTED BY: JOSEPH MARTIN

DATE: 7/30/02

COMMENTS:

STUB CONNECTION  
INFO:

6" PVC = 24'

DEPTH = 5.6'

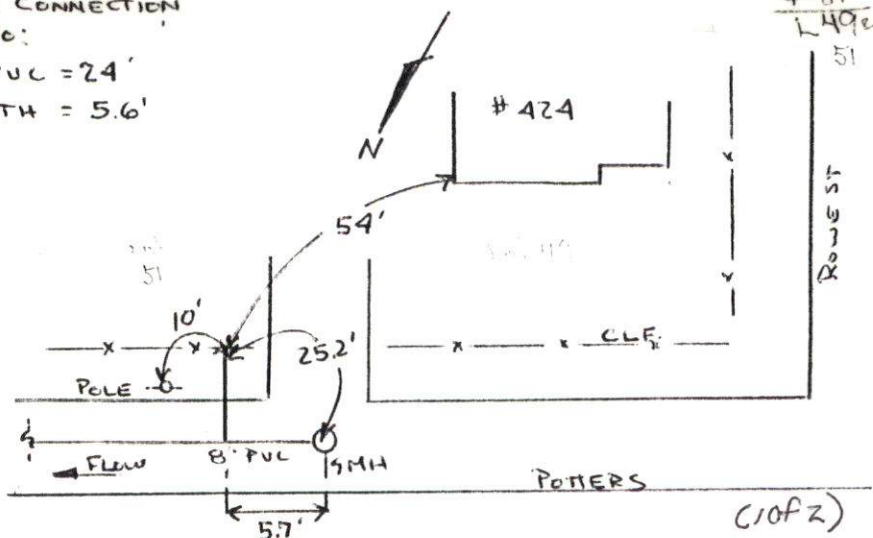

☒ APPROVED

☐ DISAPPROVED

SIGNATURE

SKETCH PLAN



PERMIT NO.

23258



CITY OF NEW BEDFORD

DATE 7-24-02

SEWER AND/OR STORM DRAIN PERMIT

This certifies that permission is granted to  
DAVID G. PRENTISS TRUSTEE OF CABRAL TRUST (508) 996-9229  
Property Owner Address 700 PLEASANT ST N.3 MA 02740 Tel.

to connect a sewer and/or storm drain located at 424 POTTER ST.  
Assessor's Plot 81, Lot 49, to the sewer and/or storm drain in POTTER Street

to be laid in accordance with the conditions in this application and the City of New Bedford ordinances.

TYPE OF USE: ☒ RESIDENTIAL ☐ COMMERICAL ☐ INDUSTRIAL ☐ OTHER 330 G.P.D.

If applicant other than actual property owner, attach Letter of Authorization from Property Owner.

Name Tel.

Mailing Address

The Bonded Contractor/Drain Layer authorized to perform this work is:

MIKE ANDRADE  
Name Address Tel.

Type of Pipe Required: PVC SDR 35

PERMIT EXPIRES ONE YEAR AFTER DATE OF ISSUE

- \* Requires separate connections for sewage and storm drain where applicable. Storm water cannot be discharged to a sanitary sewer.
- \* All work must be inspected and approved by a D.P.W. inspector before backfilling.
- \* If this connection is to be part of a private service shared jointly with other building owners, attach copy of Recorded Joint Maintenance Agreement.
- \* Permits can be issued to Industrial and/or Commercial Applicants only upon receipt and approval by the Commissioner of Public Works of required plans and supplemental information.
- \* In addition, a City-issued Industrial User Discharge Permit and/or a Sewer Extension/Connection Permit issued by the Commonwealth of Massachusetts D.E.P. shall be required by the City for Industrial Discharge into the sewer system.

Industrial User Discharge Permit No. N/A Date

Comm. Mass. Sewer Conn./Ext. Permit No. N/A Date

A Filing and Inspection Fee of \$150.00, plus an Entrance Fee of \$352.80 where applicable, must accompany this application.

Bank # FIRST CITIZENS Check # 101203 Date: 7-24-02 Receipt # 4373

Other requirements: SEPTIC ABANDONEMENT ROWE ST. PROJ. 24' X \$14.70/ft = \$352.80

+ Inspection Fee of \$150.00 Total = \$502.80

Owner/contractor to contact Health Dept. re: septic.

Connection made to ☒ Sewer Part of jointly-shared private line ☐ Yes ☒ No  
☐ Storm Drain

Applicant agrees to abide by the above terms, as well as all pertinent ordinances of the City of New Bedford, and such other special rules as the Commissioner of Public Works may deem necessary

Lawrence D. Warden  
Commissioner of Public Works

D. G. Prentiss TRUSTEE  
Signature of Property Owner or Representative

INSPECTOR'S REPORT

INSPECTED BY:

DATE:

COMMENTS:

☐ APPROVED ☐ DISAPPROVED

SIGNATURE

SKETCH PLAN