

PERMIT NO.

23255



CITY OF NEW BEDFORD

DATE 7-22-02 RECEIVED

SEWER AND/OR STORM DRAIN PERMIT

Str 1 / 2002

DEPT. OF PUBLIC WORKS
NEW BEDFORD, MASS

This certifies that permission is granted to

RUSSELL L ABBE

245 BONIN ST N.B. MA. 02745

998-1981

Property Owner

Address

Tel.

to connect a sewer and/or storm drain located at

245 BONIN ST. (N.S.)

450 (CH-)

W. Mt. Pleasant St

Assessor's Plot 123B, Lot 321, to the sewer and/or storm drain in BONIN ST Street

to be laid in accordance with the conditions in this application and the City of New Bedford ordinances.

TYPE OF USE: ☒ RESIDENTIAL ☐ COMMERICAL ☐ INDUSTRIAL ☐ OTHER

220 GPD

If applicant other than actual property owner, attach Letter of Authorization from Property Owner.

Name..... Tel.....

Mailing Address.....

The Bonded Contractor/Drain Layer authorized to perform this work is:

SCOTT FRANKLIN BROTHERS

Name

Address

Tel.

Type of Pipe Required: PVC SDR 35

PERMIT EXPIRES ONE YEAR AFTER DATE OF ISSUE

* Requires separate connections for sewage and storm drain where applicable. Storm water cannot be discharged to a sanitary sewer.

* All work must be inspected and approved by a D.P.W. inspector before backfilling.

* If this connection is to be part of a private service shared jointly with other building owners, attach copy of Recorded Joint Maintenance Agreement.

* Permits can be issued to Industrial and/or Commercial Applicants only upon receipt and approval by the Commissioner of Public Works of required plans and supplemental information.

* In addition, a City-issued Industrial User Discharge Permit and/or a Sewer Extension/Connection Permit issued by the Commonwealth of Massachusetts D.E.P. shall be required by the City for Industrial Discharge into the sewer system.

Industrial User Discharge Permit No. N/A Date.....

Comm. Mass. Sewer Conn./Ext. Permit No. N/A Date.....

A Filing and Inspection Fee of \$150.00, plus an Entrance Fee of \$162.81 where applicable, must accompany this application.

Bank # FIRST FED Check # 1122 Date: 7-22-02 Receipt # 4369

Other requirements: NOTIFY HEALTH DEPT. OF SEPTIC ABANDONEMENT JAIL FEE =

20.1' X \$8.10/ft = \$162.81 + \$150. Inspection Fee (Aviation Way Sewer Project)
Total \$312.81

☒ Sewer

Connection made to

Part of jointly-shared private line ☐ Yes ☒ No

☐ Storm Drain

Applicant agrees to abide by the above terms, as well as all pertinent ordinances of the City of New Bedford, and such other special rules as the Commissioner of Public Works may deem necessary

Lawrence D. Woburn

Commissioner of Public Works

Russell L. Abbe

Signature of Property Owner or Representative

INSPECTED BY: PETER SCIEZKA

DATE: 8/19/02

COMMENTS: Inspected from stub to house by Peter on 8/19/02. Stub from main to R - Aviation Way Sewer Project - CDM inspected.

☒ APPROVED

☐ DISAPPROVED

Signature

SIGNATURE

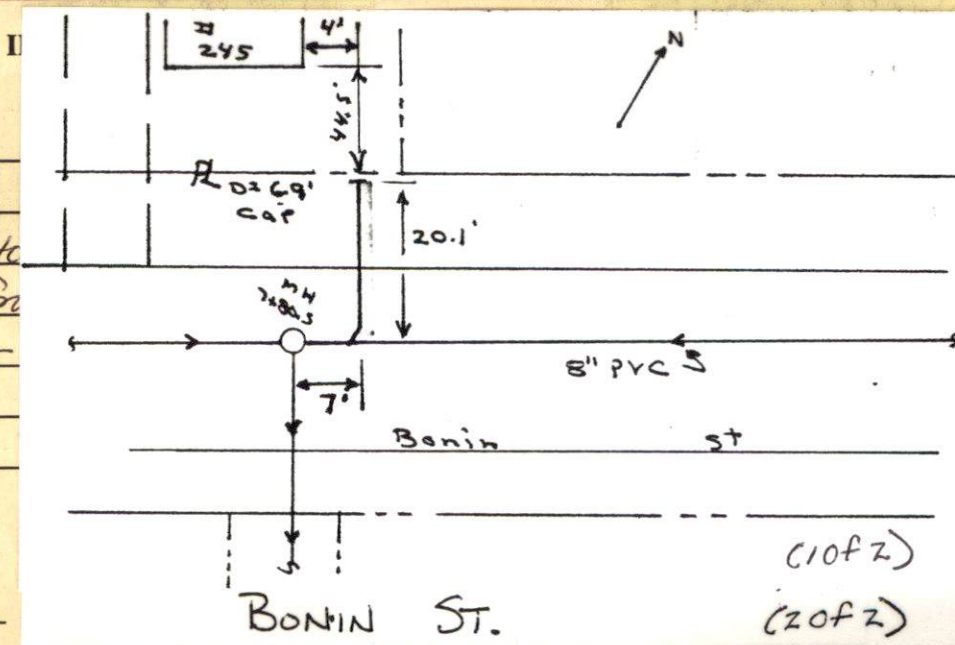

SKETCH PLAN

PERMIT NO.

23255



CITY OF NEW BEDFORD

DATE.....7-22-02

SEWER AND/OR STORM DRAIN PERMIT

This certifies that permission is granted to

RUSSELL L'ABBE

245 BONIN ST N.B. MA. 02745 (508) 998-1981

Property Owner

Address

Tel.

to connect a sewer and/or storm drain located at.....245 BONIN ST.

Assessor's Plot. 123 B., Lot. 321, to the sewer and/or storm drain in.....BONIN ST..... Street

to be laid in accordance with the conditions in this application and the City of New Bedford ordinances.

TYPE OF USE: ☒ RESIDENTIAL ☐ COMMERCIAL ☐ INDUSTRIAL ☐ OTHER

If applicant other than actual property owner, attach Letter of Authorization from Property Owner.

220 GPD

Name.....Tel.....

Mailing Address.....

The Bonded Contractor/Drain Layer authorized to perform this work is:

SCOTT FRANKLIN BROTHERS

Name

Address

Tel.

Type of Pipe Required:.....PVC SDR 35

PERMIT EXPIRES ONE YEAR AFTER DATE OF ISSUE

* Requires separate connections for sewage and storm drain where applicable. Storm water cannot be discharged to a sanitary sewer.

* All work must be inspected and approved by a D.P.W. inspector before backfilling.

* If this connection is to be part of a private service shared jointly with other building owners, attach copy of Recorded Joint Maintenance Agreement.

* Permits can be issued to Industrial and/or Commercial Applicants only upon receipt and approval by the Commissioner of Public Works of required plans and supplemental information.

* In addition, a City-issued Industrial User Discharge Permit and/or a Sewer Extension/Connection Permit issued by the Commonwealth of Massachusetts D.E.P. shall be required by the City for Industrial Discharge into the sewer system.

Industrial User Discharge Permit No.....N/A.....Date.....

Comm. Mass. Sewer Conn./Ext. Permit No.....N/A.....Date.....

A Filing and Inspection Fee of \$150.00, plus an Entrance Fee of \$162.81 where applicable, must accompany this application.

Bank # FIRST FED Check # 1122 Date: 7-22-02 Receipt # 4369

Other requirements: NOTIFY HEALTH DEPT. OF SEPTIC ABANDONEMENT Stub Fee =

20.1' X \$8.10/ft = \$162.81 + \$150. Inspection Fee (Aviation Way Sewer Project)
Total \$312.81

☒ Sewer

Connection made to

Part of jointly-shared private line ☐ Yes ☒ No

☐ Storm Drain

Applicant agrees to abide by the above terms, as well as all pertinent ordinances of the City of New Bedford, and such other special rules as the Commissioner of Public Works may deem necessary

Lawrence D. Mondrison
Commissioner of Public Works

Russell A. L'Abbe
Signature of Property Owner or Representative

INSPECTOR'S REPORT

INSPECTED BY:.....

DATE:.....

COMMENTS:.....

☐ APPROVED

☐ DISAPPROVED

SIGNATURE

SKETCH PLAN