

PERMIT NO.

23215



CITY OF NEW BEDFORD

SEWER AND/OR STORM DRAIN PERMIT

RECEIVED

SEP 17 2002

DEPT. OF PUBLIC WORKS
NEW BEDFORD, MASS.

This certifies that permission is granted to

Joan Wheelden 243 WILBUR ST. NEW BEDFORD MA. (508) 993-5948

Property Owner

Address

Tel.

to connect a sewer and/or storm drain located at 243 WILBUR ST. (N.S.) 160' (H) W. Rockdale Ave
Assessor's Plot 80, Lot 70, to the sewer and/or storm drain in WILBUR ST Street

to be laid in accordance with the conditions in this application and the City of New Bedford ordinances.

TYPE OF USE: ☒ RESIDENTIAL ☐ COMMERICAL ☐ INDUSTRIAL ☐ OTHER

If applicant other than actual property owner, attach Letter of Authorization from Property Owner.

Name Tel.

Mailing Address.

The Bonded Contractor/Drain Layer authorized to perform this work is:

Stub at Property line

LABOINE BROS

Name

Address

Tel.

Type of Pipe Required: SDR 35 (PVC)

PERMIT EXPIRES ONE YEAR AFTER DATE OF ISSUE

* Requires separate connections for sewage and storm drain where applicable. Storm water cannot be discharged to a sanitary sewer.

* All work must be inspected and approved by a D.P.W. inspector before backfilling.

* If this connection is to be part of a private service shared jointly with other building owners, attach copy of Recorded Joint Maintenance Agreement.

* Permits can be issued to Industrial and/or Commercial Applicants only upon receipt and approval by the Commissioner of Public Works of required plans and supplemental information.

* In addition, a City-issued Industrial User Discharge Permit and/or a Sewer Extension/Connection Permit issued by the Commonwealth of Massachusetts D.E.P. shall be required by the City for Industrial Discharge into the sewer system.

Industrial User Discharge Permit No. N/A Date.

Comm. Mass. Sewer Conn./Ext. Permit No. Date.

A Filing and Inspection Fee of \$150.00, plus an Entrance Fee of \$382.20 where applicable, must accompany this application.

Bank # Compass Bank Check # 2137 Date: 5-20-02 Receipt # 4309

Other requirements: INSPECTION ONLY CONTACT HEALTH DEPT. FOR SEPTIC ABAND.

Rowe St. Sewer Pipe 26' Stub @ \$14.70/ft = \$382.20

Total \$532.20

☒ Sewer

Connection made to

Part of jointly-shared private line ☐ Yes ☒ No

☐ Storm Drain

Applicant agrees to abide by the above terms, as well as all pertinent ordinances of the City of New Bedford, and such other special rules as the Commissioner of Public Works may deem necessary

Lawrence D. Wickham
Commissioner of Public Works

Joan Wheelden
Signature of Property Owner or Representative

INSPECTED BY: JOSEPH MARTIN

DATE: 5/22/02

COMMENTS: Inspected by Joe M.
5/22/02 from R to house. Stub
from repair to R - Rowe St.
sewer project - inspected by
CDM.

☒ APPROVED

☐ DISAPPROVED

Joseph Martin
SIGNATURE

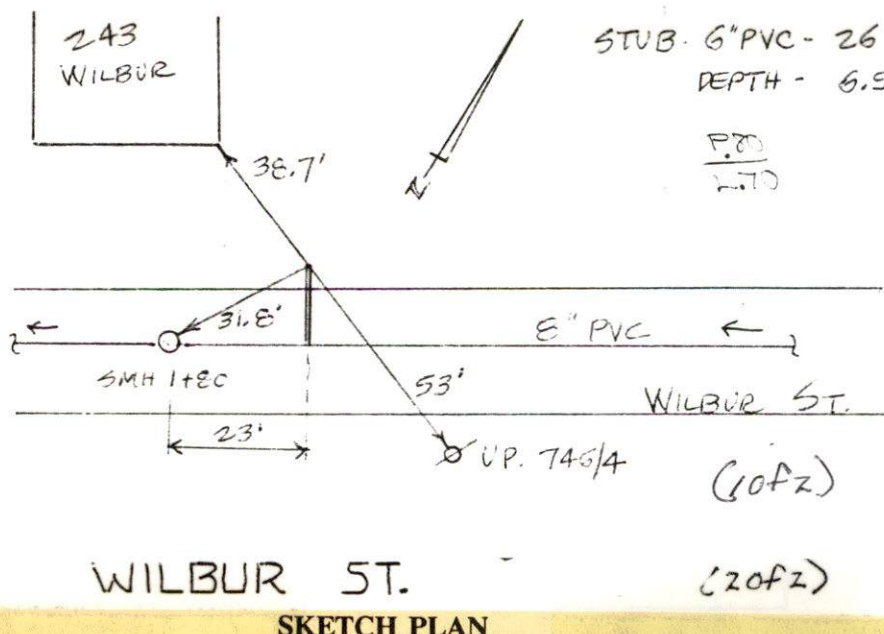

PERMIT NO.

23215



CITY OF NEW BEDFORD

DATE... 5-20-02

SEWER AND/OR STORM DRAIN PERMIT

This certifies that permission is granted to

Joan Wheelden 243 WILBUR ST. NEW BEDFORD MA 02740 (508) 993-5948
Property Owner Address Tel.

to connect a sewer and/or storm drain located at 243 WILBUR ST.

Assessor's Plot 80, Lot 70, to the sewer and/or storm drain in WILBUR ST Street

to be laid in accordance with the conditions in this application and the City of New Bedford ordinances.

TYPE OF USE: ☒ RESIDENTIAL ☐ COMMERCIAL ☐ INDUSTRIAL ☐ OTHER

If applicant other than actual property owner, attach Letter of Authorization from Property Owner.

Name.....Tel.....

Mailing Address.....

The Bonded Contractor/Drain Layer authorized to perform this work is:

Stub at Property line

LABONNE BROS

Name

Address

Tel.

Type of Pipe Required: SDR 35 (PVC)

PERMIT EXPIRES ONE YEAR AFTER DATE OF ISSUE

* Requires separate connections for sewage and storm drain where applicable. Storm water cannot be discharged to a sanitary sewer.

* All work must be inspected and approved by a D.P.W. inspector before backfilling.

* If this connection is to be part of a private service shared jointly with other building owners, attach copy of Recorded Joint Maintenance Agreement.

* Permits can be issued to Industrial and/or Commercial Applicants only upon receipt and approval by the Commissioner of Public Works of required plans and supplemental information.

* In addition, a City-issued Industrial User Discharge Permit and/or a Sewer Extension/Connection Permit issued by the Commonwealth of Massachusetts D.E.P. shall be required by the City for Industrial Discharge into the sewer system.

Industrial User Discharge Permit No. N/A Date.....

Comm. Mass. Sewer Conn./Ext. Permit No.....Date.....

A Filing and Inspection Fee of \$150.00, plus an Entrance Fee of \$382.20 where applicable, must accompany this application.

Bank # Compass Bank Check # 2137 Date: 5-20-02 Receipt # 4309

Other requirements: INSPECTION ONLY CONTACT HEALTH DEPT. FOR SEPTIC ABAND.

Rowe St. Sewer Proj. 26' Stub @ \$14.70/ft = \$382.20

Total \$ 532.20

☒ Sewer

Connection made to

Part of jointly-shared private line ☐ Yes ☒ No

☐ Storm Drain

Applicant agrees to abide by the above terms, as well as all pertinent ordinances of the City of New Bedford, and such other special rules as the Commissioner of Public Works may deem necessary

Lawrence D. Wozniak
Commissioner of Public Works

Joan Wheelden
Signature of Property Owner or Representative

INSPECTOR'S REPORT

INSPECTED BY: _____

DATE: _____

COMMENTS: _____

☐ APPROVED

☐ DISAPPROVED

SIGNATURE

SKETCH PLAN