

PERMIT NO.

23212



CITY OF NEW BEDFORD

SEWER AND/OR STORM DRAIN PERMIT

DATE 4-29-02

EXN 4-29-03

This certifies that permission is granted to
J.M.P. DEV. CORP. 24 Jocelyn St. 02745 (508) 998-2969
 Property Owner Address # 3266 Tel.
 to connect a sewer and/or storm drain located at Acushnet Ave. (ES) at North side of Forbes St.
 Assessor's Plot 132-I, Lot 55, to the sewer and/or storm drain in Acushnet Ave. (ES) Street
 to be laid in accordance with the conditions in this application and the City of New Bedford ordinances.

TYPE OF USE: ☒ RESIDENTIAL ☐ COMMERICAL ☐ INDUSTRIAL ☐ OTHER

If applicant other than actual property owner, attach Letter of Authorization from Property Owner.

Name N/A Tel. 2640 G.P.D.

Mailing Address DEC 17 2002

The Bonded Contractor/Drain Layer authorized to perform this work is:

R.J. CONESSA 915 Hathaway Rd. (508) 993-9508
 Name Address Tel.

Type of Pipe Required: PVC SDR 35 8"

PERMIT EXPIRES ONE YEAR AFTER DATE OF ISSUE

- * Requires separate connections for sewage and storm drain where applicable. Storm water cannot be discharged to a sanitary sewer.
- * All work must be inspected and approved by a D.P.W. inspector before backfilling.
- * If this connection is to be part of a private service shared jointly with other building owners, attach copy of Recorded Joint Maintenance Agreement.
- * Permits can be issued to Industrial and/or Commercial Applicants only upon receipt and approval by the Commissioner of Public Works of required plans and supplemental information.
- * In addition, a City-issued Industrial User Discharge Permit and/or a Sewer Extension/Connection Permit issued by the Commonwealth of Massachusetts D.E.P. shall be required by the City for Industrial Discharge into the sewer system.

Industrial User Discharge Permit No. — Date —

Comm. Mass. Sewer Conn./Ext. Permit No. Exempt Date —

A Filing and Inspection Fee of \$ 150.00, plus an Entrance Fee of \$ — where applicable, must accompany this application.

Bank # Citizens Bank MA Check # 1258 Date: 4/29/02 Receipt # 4296

Other requirements: pending Eng. Review of G.P.D. / Line size = 8" Line required

INSPECTION BY W.W.D.

Connection made to ☒ Sewer ☐ Storm Drain Part of jointly-shared private line ☐ Yes ☒ No

At S.D. in street - drainage to be as per attached plan.

Applicant agrees to abide by the above terms, as well as all pertinent ordinances of the City of New Bedford, and such other special rules as the Commissioner of Public Works may deem necessary

[Signature]
 Commissioner of Public Works

[Signature]
 Signature of Property Owner or Representative

INSPECTOR'S REPORT

INSPECTED BY: JOSEPH MARTIN

DATE: 11/12/02

COMMENTS: —

☒ APPROVED ☐ DISAPPROVED

[Signature]
 SIGNATURE

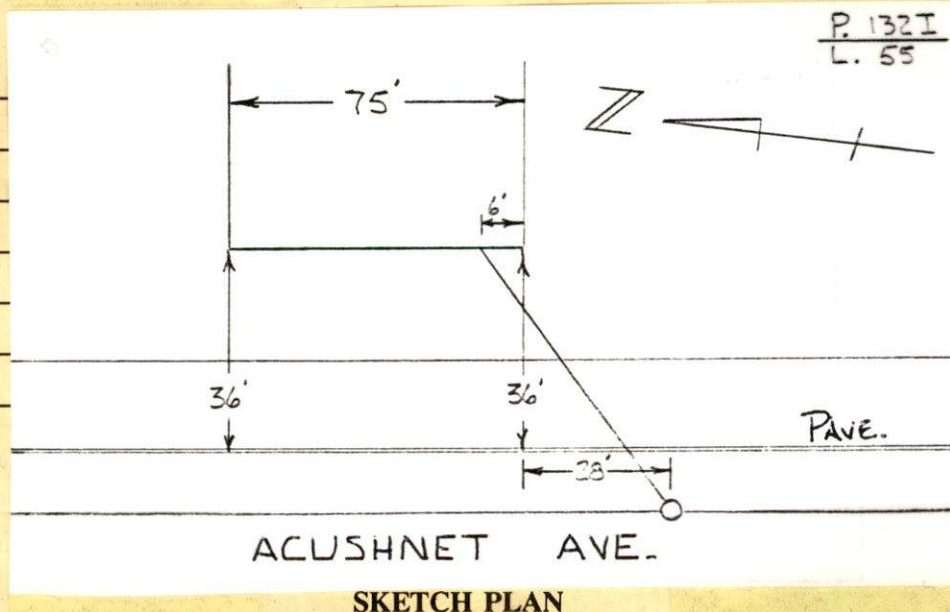

P. 132 I
 L. 55

ACUSHNET AVE.

SKETCH PLAN

PERMIT NO.
23312



CITY OF NEW BEDFORD

DATE **11-27-02**

SEWER AND/OR STORM DRAIN PERMIT

This certifies that permission is granted to
Roland Letender **84 Gifford St.** **(508) 999-9900**
Property Owner Address Tel.

to connect a sewer and/or storm drain located at **Harbor St. Building #30**
Assessor's Plot **21**, Lot **30**, to the sewer and/or storm drain in **Harbor St** Street

to be laid in accordance with the conditions in this application and the City of New Bedford ordinances.

TYPE OF USE: ☐ RESIDENTIAL ☐ COMMERICAL ☒ INDUSTRIAL ☐ OTHER

If applicant other than actual property owner, attach Letter of Authorization from Property Owner.

Name **Roland Letender** Tel. **508 999-9900**
Mailing Address **84 Gifford St.**

The Bonded Contractor/Drain Layer authorized to perform this work is:
Bufftree Building Co. **193-R Popes Island** **(508) 75357**
Name Address Tel.

Type of Pipe Required: **PVC S.D.R. 35**

PERMIT EXPIRES ONE YEAR AFTER DATE OF ISSUE

- * Requires separate connections for sewage and storm drain where applicable. Storm water cannot be discharged to a sanitary sewer.
- * All work must be inspected and approved by a D.P.W. inspector before backfilling.
- * If this connection is to be part of a private service shared jointly with other building owners, attach copy of Recorded Joint Maintenance Agreement.
- * Permits can be issued to Industrial and/or Commercial Applicants only upon receipt and approval by the Commissioner of Public Works of required plans and supplemental information.
- * In addition, a City-issued Industrial User Discharge Permit and/or a Sewer Extension/Connection Permit issued by the Commonwealth of Massachusetts D.E.P. shall be required by the City for Industrial Discharge into the sewer system.

Industrial User Discharge Permit No. Date

Comm. Mass. Sewer Conn./Ext. Permit No. Date

A Filing and Inspection Fee of \$ **150.00**, plus an Entrance Fee of \$ where applicable, must accompany this application.

Bank # **FIRST FED** Check # **3248** Date: **11-27-02** Receipt # **4486**

Other requirements: **Saw Cut Roadway Connecting**
into SMH Insp. 24 hrs. in advance

Connection made to ☒ Sewer ☐ Storm Drain
Part of jointly-shared private line ☐ Yes ☐ No

Applicant agrees to abide by the above terms, as well as all pertinent ordinances of the City of New Bedford, and such other special rules as the Commissioner of Public Works may deem necessary

Lawrence D. Worden (ms)
Commissioner of Public Works

Reel LA
Signature of Property Owner or Representative

INSPECTOR'S REPORT

INSPECTED BY: _____

DATE: _____

COMMENTS: _____

☐ APPROVED ☐ DISAPPROVED

SIGNATURE

SKETCH PLAN



BAYLINE EXCAVATION

EQUIPMENT RENTAL & SALES

3 Tripp Street • P.O. Box 207

Fairhaven, MA 02719

Phone: 508-994-4949 • Fax: 508-994-4644

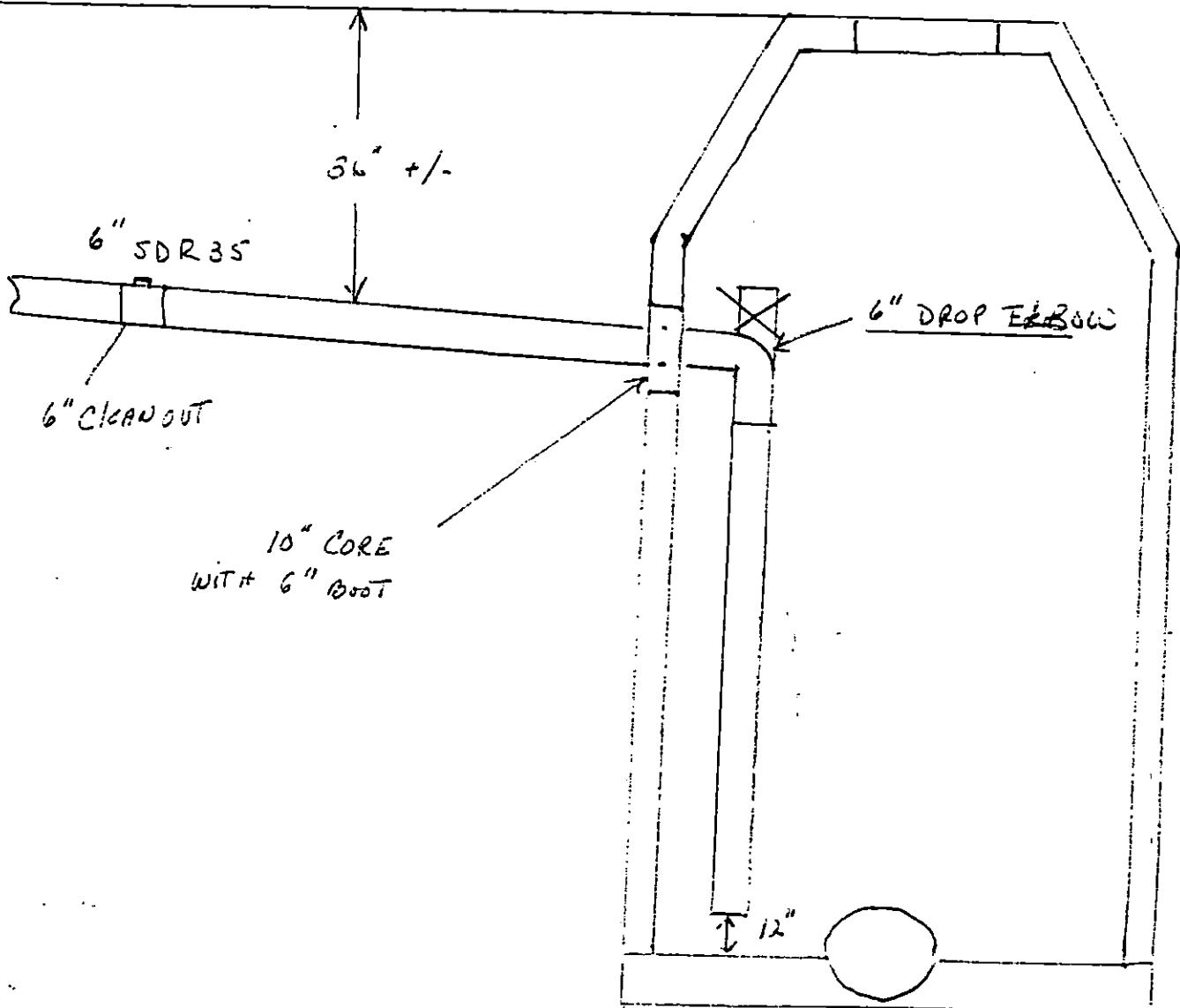
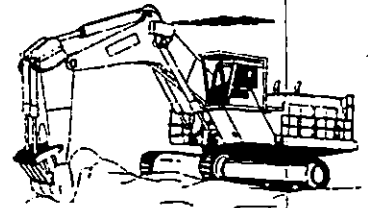

97 COVE ST

WORK TO BE DONE ON HARBOR ST. BUILD #30 HATHAWAY MILLS

DIG SAFE # 2002 4800 783

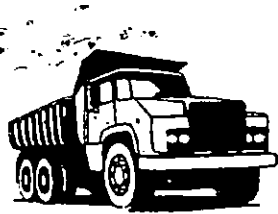

BAYLINE EXCAVATION

EQUIPMENT RENTAL & SALES

3 Tripp Street • P.O. Box 207

Fairhaven, MA 02719

Phone: 508-994-4949 • Fax: 508-994-4644

