

PERMIT NO.

23211



CITY OF NEW BEDFORD

SEWER AND/OR STORM DRAIN PERMIT

DATE **RECEIVED**

SEP 17 2002

DEPT. OF PUBLIC WORKS
NEW BEDFORD, MASS

This certifies that permission is granted to

RAYMOND C. COTTULI 1116 BEVERLY ST. N.B. MA. 02745 (508)

Property Owner

Address

Tel.

to connect a sewer and/or storm drain located at 1116 BEVERLY ST. (S.S.) 150' (41-) W. Barnard St.

Assessor's Plot 134A, Lot 10, to the sewer and/or storm drain in BEVERLY ST. Street

to be laid in accordance with the conditions in this application and the City of New Bedford ordinances.

TYPE OF USE: ☒ RESIDENTIAL ☐ COMMERICAL ☐ INDUSTRIAL ☐ OTHER

3306PD

If applicant other than actual property owner, attach Letter of Authorization from Property Owner.

Name SCOTT FRANKLIN Tel. (508) 998-8270

Mailing Address 4393 ACUSHNET AVE N.B. MA. 02745

The Bonded Contractor/Drain Layer authorized to perform this work is:

FRANKLIN BROS - STUB AT PROP. LINE

Name

Address

Tel.

Type of Pipe Required: PVC SDR 35

PERMIT EXPIRES ONE YEAR AFTER DATE OF ISSUE

- * Requires separate connections for sewage and storm drain where applicable. Storm water cannot be discharged to a sanitary sewer.
- * All work must be inspected and approved by a D.P.W. inspector before backfilling.
- * If this connection is to be part of a private service shared jointly with other building owners, attach copy of Recorded Joint Maintenance Agreement.
- * Permits can be issued to Industrial and/or Commercial Applicants only upon receipt and approval by the Commissioner of Public Works of required plans and supplemental information.
- * In addition, a City-issued Industrial User Discharge Permit and/or a Sewer Extension/Connection Permit issued by the Commonwealth of Massachusetts D.E.P. shall be required by the City for Industrial Discharge into the sewer system.

Industrial User Discharge Permit No. N/A Date

Comm. Mass. Sewer Conn./Ext. Permit No. N/A Date

A Filing and Inspection Fee of \$ 150.00, plus an Entrance Fee of \$ 150.00 where applicable, must accompany this application.

Bank # First Citizens Check # 1140 Date: 4-24-02 Receipt # 4291

Other requirements: inspection only stub at property line

☒ Sewer

Connection made to

Part of jointly-shared private line ☐ Yes ☒ No

☐ Storm Drain

Applicant agrees to abide by the above terms, as well as all pertinent ordinances of the City of New Bedford, and such other special rules as the Commissioner of Public Works may deem necessary

Lawrence D. Worden (ms)
Commissioner of Public Works

Scott Franklin
Signature of Property Owner or Representative

INSPECTOR'S REPORT

INSPECTED BY: JOSEPH MARTIN

DATE: 5/1/02

COMMENTS: Joe Martin inspected from R.R. to house. Stub installed from main to R.R. under C.N.B. project.

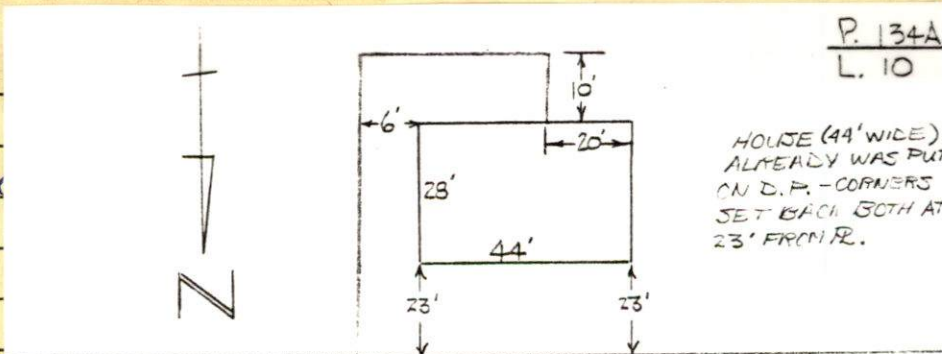

☒ APPROVED

☐ DISAPPROVED

Joseph Martin
SIGNATURE

BEVERLY ST.

SKETCH PLAN

PAVE.

STORM DRAIN 18" PIPE
SEWER 10" PIPE
BEVERLY

19653-74

19673-74
DRAIN
LOCATION
UNKNOWN

19652-74

19704-74
DRAIN
LOCATION
UNKNOWN

19720-74

19685-74

19692-74

NO PERMIT
ISSUED
1974

21750-88

19683-74

NO PERMIT
ISSUED
1974
21667-88

22945-00

BARNARD

PERMIT NO.
23211



CITY OF NEW BEDFORD

DATE 4-24-02

SEWER AND/OR STORM DRAIN PERMIT

This certifies that permission is granted to
RAYMOND C. COTTULI 1116 BEVERLY ST. N.B. MA. 02745 (508)
Property Owner Address Tel.

to connect a sewer and/or storm drain located at 1116 BEVERLY ST.
Assessor's Plot 134A, Lot 10, to the sewer and/or storm drain in BEVERLY ST. Street
to be laid in accordance with the conditions in this application and the City of New Bedford ordinances.

TYPE OF USE: ☒ RESIDENTIAL ☐ COMMERICAL ☐ INDUSTRIAL ☐ OTHER 3306PD

If applicant other than actual property owner, attach Letter of Authorization from Property Owner.
Name SCOTT FRANKLIN Tel. (508) 998-8270
Mailing Address 4393 ACUSHNET AVE N.B. MA. 02745

The Bonded Contractor/Drain Layer authorized to perform this work is:
FRANKLIN BROS - STUB AT PROP. LINE
Name Address Tel.

Type of Pipe Required: PVC SDR 35
PERMIT EXPIRES ONE YEAR AFTER DATE OF ISSUE

- * Requires separate connections for sewage and storm drain where applicable. Storm water cannot be discharged to a sanitary sewer.
- * All work must be inspected and approved by a D.P.W. inspector before backfilling.
- * If this connection is to be part of a private service shared jointly with other building owners, attach copy of Recorded Joint Maintenance Agreement.
- * Permits can be issued to Industrial and/or Commercial Applicants only upon receipt and approval by the Commissioner of Public Works of required plans and supplemental information.
- * In addition, a City-issued Industrial User Discharge Permit and/or a Sewer Extension/Connection Permit issued by the Commonwealth of Massachusetts D.E.P. shall be required by the City for Industrial Discharge into the sewer system.

Industrial User Discharge Permit No. N/A Date _____
Comm. Mass. Sewer Conn./Ext. Permit No. N/A Date _____
A Filing and Inspection Fee of \$ 150.00, plus an Entrance Fee of \$ 150.00 where applicable, must accompany this application.
Bank # First Citizens Check # 1140 Date: 4-24-02 Receipt # 4291
Other requirements: inspection only stub at property line

☒ Sewer
Connection made to Part of jointly-shared private line ☐ Yes ☒ No
☐ Storm Drain

Applicant agrees to abide by the above terms, as well as all pertinent ordinances of the City of New Bedford, and such other special rules as the Commissioner of Public Works may deem necessary
Lawrence D. Worden (ms) Scott Franklin
Commissioner of Public Works Signature of Property Owner or Representative

INSPECTOR'S REPORT

INSPECTED BY: _____
DATE: _____
COMMENTS: _____

☐ APPROVED ☐ DISAPPROVED

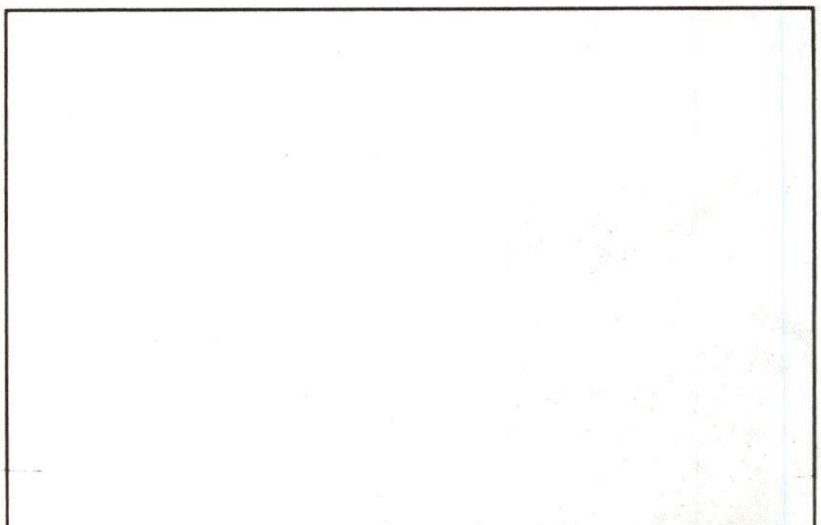



**CITY OF NEW BEDFORD
MASSACHUSETTS**

DEPARTMENT OF PUBLIC WORKS
ENGINEERING DIVISION
133 WILLIAM STREET, ROOM 303
NEW BEDFORD, MA 02740
Tel: (508) 979-1527
Fax: (508) 961-3043

To Whom It May Concern:

I, RAYMOND C COTTULI, 1116 BEVERLY ST. N.B., being
(Name) (Mailing Address)

Owner of property located at 1116 BEVERLY ST. NEW BEDFORD

Plot 134A, Lot 10, hereby agree to allow SCOTT FRANKLIN and Brothers
(Name)

4393 ACUSHNET AVE NEW BEDFORD to act on my behalf including affixing my
(Mailing Address) 02745

signature in securing permit for:

☒ Sewer/Drain Service Permits
☐ Water Service Permits
☐ Driveway Installation Permits
☐ Sidewalk Installation Permits

I further agree to conform to, and abide by, all City rules and ask regulations applicable to the permit (s) being applied for:

Name Raymond C Cottuli
(Signature)

1116 BEVERLY ST. N.B.
(Address)

April 4/02 508-995-9409
(Date) (Telephone number)