

PERMIT NO.

23209



CITY OF NEW BEDFORD

DATE 4-19-02

SEWER AND/OR STORM DRAIN PERMIT

RECEIVED

This certifies that permission is granted to

ROBERT ZAGER

339 DUFFEE ST

SEP 17 2002 46-2898

Property Owner

Address

DEPT. OF PUBLIC WORKS
NEW BEDFORD, MASS

to connect a sewer and/or storm drain located at 339 DUFFEE ST, (N.S.) 270 E. ROWE ST
Assessor's Plot 81, Lot 34, to the sewer and/or storm drain in DUFFEE Street

to be laid in accordance with the conditions in this application and the City of New Bedford ordinances.

TYPE OF USE: ☒ RESIDENTIAL ☐ COMMERICAL ☐ INDUSTRIAL ☐ OTHER

440 G.P.I

If applicant other than actual property owner, attach Letter of Authorization from Property Owner.

Name.....Tel.....

Mailing Address.....

The Bonded Contractor/Drain Layer authorized to perform this work is:

Name

Address

Tel.

Type of Pipe Required: PVC SDR 35

PERMIT EXPIRES ONE YEAR AFTER DATE OF ISSUE

* Requires separate connections for sewage and storm drain where applicable. Storm water cannot be discharged to a sanitary sewer.

* All work must be inspected and approved by a D.P.W. inspector before backfilling.

* If this connection is to be part of a private service shared jointly with other building owners, attach copy of Recorded Joint Maintenance Agreement.

* Permits can be issued to Industrial and/or Commercial Applicants only upon receipt and approval by the Commissioner of Public Works of required plans and supplemental information.

* In addition, a City-issued Industrial User Discharge Permit and/or a Sewer Extension/Connection Permit issued by the Commonwealth of Massachusetts D.E.P. shall be required by the City for Industrial Discharge into the sewer system.

Industrial User Discharge Permit No.....Date.....

Comm. Mass. Sewer Conn./Ext. Permit No.....Date.....

A Filing and Inspection Fee of \$150.00, plus an Entrance Fee of \$308.70 where applicable, must accompany this application.

Bank # Compass Bank Check # 579 Date: 4/19/02 Receipt # 4287

Other requirements:.....

21' Stub @ 14.70/15 + Insp. Fee

☒ Sewer

Connection made to

Part of jointly-shared private line ☐ Yes ☒ No

☐ Storm Drain

Applicant agrees to abide by the above terms, as well as all pertinent ordinances of the City of New Bedford, and such other special rules as the Commissioner of Public Works may deem necessary

Lawrence D. Warden (Seal)
Commissioner of Public Works

Robert Zager
Signature of Property Owner or Representative

INSPECTED BY: JOSEPH MARTIN

DATE: 5/20/02

COMMENTS: Inspected by Joseph Martin 5/20/02 from R to house
Stub from main to R - Rowe St.
Sewer project - inspected by C.M.

☒ APPROVED

☐ DISAPPROVED

SIGNATURE

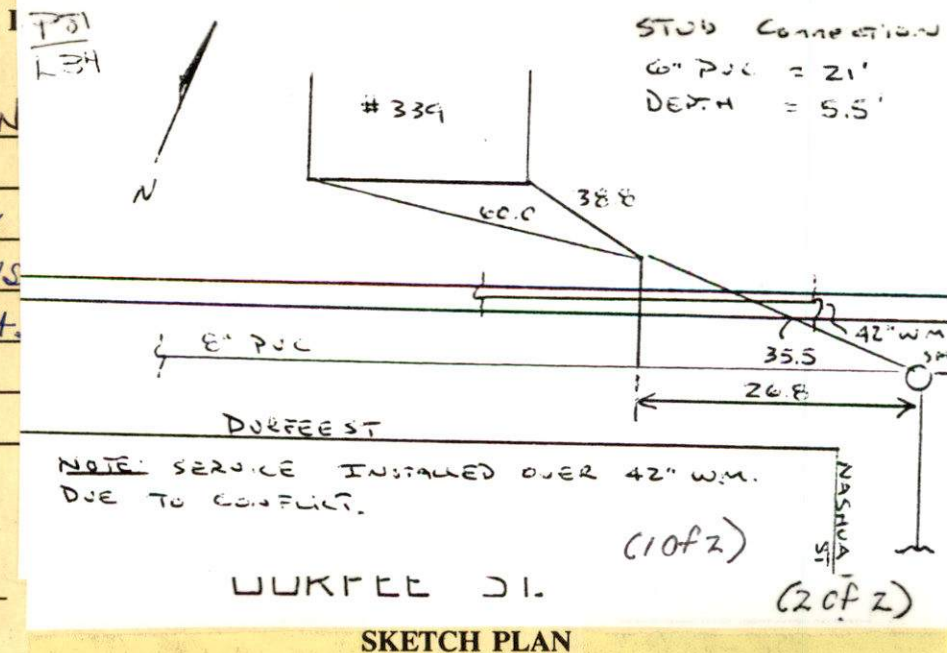

PERMIT NO.

23209



CITY OF NEW BEDFORD

DATE 4-19-02

SEWER AND/OR STORM DRAIN PERMIT

This certifies that permission is granted to

ROBERT ZAGER 339 DURFEE ST (508) 996-2898
Property Owner Address Tel.

to connect a sewer and/or storm drain located at 339 DURFEE ST
Assessor's Plot 81, Lot 34, to the sewer and/or storm drain in DURFEE Street

to be laid in accordance with the conditions in this application and the City of New Bedford ordinances.

TYPE OF USE: ☒ RESIDENTIAL ☐ COMMERCIAL ☐ INDUSTRIAL ☐ OTHER

440 G.P.I

If applicant other than actual property owner, attach Letter of Authorization from Property Owner.

Name Tel.

Mailing Address

The Bonded Contractor/Drain Layer authorized to perform this work is:

Name Address Tel.

Type of Pipe Required: PVC SDR 35

PERMIT EXPIRES ONE YEAR AFTER DATE OF ISSUE

* Requires separate connections for sewage and storm drain where applicable. Storm water cannot be discharged to a sanitary sewer.

* All work must be inspected and approved by a D.P.W. inspector before backfilling.

* If this connection is to be part of a private service shared jointly with other building owners, attach copy of Recorded Joint Maintenance Agreement.

* Permits can be issued to Industrial and/or Commercial Applicants only upon receipt and approval by the Commissioner of Public Works of required plans and supplemental information.

* In addition, a City-issued Industrial User Discharge Permit and/or a Sewer Extension/Connection Permit issued by the Commonwealth of Massachusetts D.E.P. shall be required by the City for Industrial Discharge into the sewer system.

Industrial User Discharge Permit No. Date

Comm. Mass. Sewer Conn./Ext. Permit No. Date

A Filing and Inspection Fee of \$150.00, plus an Entrance Fee of \$308.70, where applicable, must accompany this application.

Bank # Compass Bank Check # 579 Date: 4/19/02 Receipt # 4287

Other requirements:

21' Stub @ 14.70/lf. + Insp. Fee

☒ Sewer

Connection made to

Part of jointly-shared private line ☐ Yes ☒ No

☐ Storm Drain

Applicant agrees to abide by the above terms, as well as all pertinent ordinances of the City of New Bedford, and such other special rules as the Commissioner of Public Works may deem necessary

Lawrence D. Worden
Commissioner of Public Works

Robert Zager
Signature of Property Owner or Representative

INSPECTOR'S REPORT

INSPECTED BY:

DATE:

COMMENTS:

☐ APPROVED

☐ DISAPPROVED

SIGNATURE

SKETCH PLAN