

23207



DATE RECEIVED.....

SEP 17 2002

DEPT. OF PUBLIC WORKS
NEW BEDFORD, MASS.

This certifies that permission is granted to

John Souza 19 Welcome St. New Bedford Ma. (508) 783-6810
Property Owner Address #122 Tel.

to connect a sewer and/or storm drain located at FRANK ST. (SS) 177' W/ Cove Rd.
Assessor's Plot 17, Lot 268, to the sewer and/or storm drain in FRANK Street

to be laid in accordance with the conditions in this application and the City of New Bedford ordinances.

TYPE OF USE: ☒ RESIDENTIAL ☐ COMMERICAL ☐ INDUSTRIAL ☐ OTHER

If applicant other than actual property owner, attach Letter of Authorization from Property Owner.

Name.....Tel.....

Mailing Address.....

The Bonded Contractor/Drain Layer authorized to perform this work is:

Name	Address	Tel.
BRAGA JOSE BOBCAT SERVICES	3E WORDELL ST.	(508) 994-7968

Type of Pipe Required: PVC SDR 35

PERMIT EXPIRES ONE YEAR AFTER DATE OF ISSUE

- * Requires separate connections for sewage and storm drain where applicable. Storm water cannot be discharged to a sanitary sewer.
- * All work must be inspected and approved by a D.P.W. inspector before backfilling.
- * If this connection is to be part of a private service shared jointly with other building owners, attach copy of Recorded Joint Maintenance Agreement.
- * Permits can be issued to Industrial and/or Commercial Applicants only upon receipt and approval by the Commissioner of Public Works of required plans and supplemental information.
- * In addition, a City-issued Industrial User Discharge Permit and/or a Sewer Extension/Connection Permit issued by the Commonwealth of Massachusetts D.E.P. shall be required by the City for Industrial Discharge into the sewer system.

Industrial User Discharge Permit No. 111 Date

Comm. Mass. Sewer Conn./Ext. Permit No. N/A Date _____

A Filing and Inspection Fee of \$150.00, plus an Entrance Fee of \$..... where applicable, must accompany this application.

Bank # S.A.C.U. Check # 206 Date: 4-18-02 Receipt # 4285

Other requirements: INSPECTION ONLY

Connect to 12" S.D. + 10" Sewer

Connection made to ☒ Sewer ☐ Storm Drain Part of jointly-shared private line ☐ Yes ☒ No

Applicant agrees to abide by the above terms, as well as all pertinent ordinances of the City of New Bedford, and such other special rules as the Commissioner of Public Works may deem necessary.

Lawrence D. Worden (ms)
Commissioner of Public Works

Signature of Property Owner or Representative

INSPECTOR'S REPORT

INSPECTED BY: JOSEPH MARTIN

DATE: 5/8/02

COMMENTS:

S.D. CONNECTION

WAIVED PER RON LABELLE

Rocked sign on C.O

although not tied into S.A. inst.

☒ APPROVED ☐ DISAPPROVED

☒ APPROVED ☐ DISAPPROVED

John P. [unclear]

Joseph M. ...

SIGNATURE

31-746

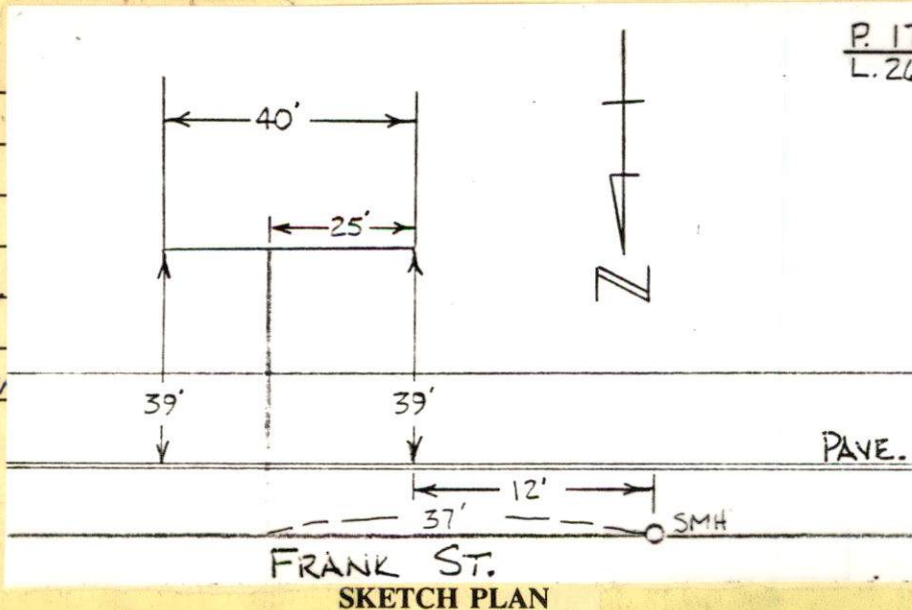

* SEE ATTACHED MEMO

PERMIT NO.

23207



CITY OF NEW BEDFORD

DATE.....4-18-02.....

SEWER AND/OR STORM DRAIN PERMIT

This certifies that permission is granted to

John Souza 19 Welcome St. New Bedford Ma. 02744 (508) 783-6810
Property Owner Address Tel.

to connect a sewer and/or storm drain located at FRANK ST. (SS) 177' W/ Cove Rd.
Assessor's Plot.....17....., Lot.....268....., to the sewer and/or storm drain in.....FRANK..... Street

to be laid in accordance with the conditions in this application and the City of New Bedford ordinances.

TYPE OF USE: ☒ RESIDENTIAL ☐ COMMERICAL ☐ INDUSTRIAL ☐ OTHER

330 G.P.D

If applicant other than actual property owner, attach Letter of Authorization from Property Owner.

Name.....Tel.....

Mailing Address.....

The Bonded Contractor/Drain Layer authorized to perform this work is:

BRAGA JOSE BOBRAT SERVICES 3E WORDELL ST. (508) 994-7968
Name Address Tel.

Type of Pipe Required:.....PVC.....SDR 35.....

PERMIT EXPIRES ONE YEAR AFTER DATE OF ISSUE

- * Requires separate connections for sewage and storm drain where applicable. Storm water cannot be discharged to a sanitary sewer.
- * All work must be inspected and approved by a D.P.W. inspector before backfilling.
- * If this connection is to be part of a private service shared jointly with other building owners, attach copy of Recorded Joint Maintenance Agreement.
- * Permits can be issued to Industrial and/or Commercial Applicants only upon receipt and approval by the Commissioner of Public Works of required plans and supplemental information.
- * In addition, a City-issued Industrial User Discharge Permit and/or a Sewer Extension/Connection Permit issued by the Commonwealth of Massachusetts D.E.P. shall be required by the City for Industrial Discharge into the sewer system.

Industrial User Discharge Permit No.....N/A.....Date.....

Comm. Mass. Sewer Conn./Ext. Permit No.....N/A.....Date.....

A Filing and Inspection Fee of \$150.00, plus an Entrance Fee of \$..... where applicable, must accompany this application.

Bank # S.A.C.U. Check # 206 Date: 4-18-02 Receipt # 4285

Other requirements: INSPECTION ONLY

Connect to 12" S.D. + 10" Sewer

Connection made to ☒ Sewer ☒ Storm Drain Part of jointly-shared private line ☐ Yes ☒ No

Applicant agrees to abide by the above terms, as well as all pertinent ordinances of the City of New Bedford, and such other special rules as the Commissioner of Public Works may deem necessary.

Lawrence D. Worden (ms)
Commissioner of Public Works

Signature of Property Owner or Representative

INSPECTOR'S REPORT

INSPECTED BY: _____

DATE: _____

COMMENTS: _____

☐ APPROVED ☐ DISAPPROVED

SIGNATURE

SKETCH PLAN

PHONE CALL

FOR <u>Duarte</u>		DATE <u>8/21/02</u>	TIME <u>3:32</u> <u>AM</u>
M. <u>Ron Labella</u>			
OF _____		<input checked="" type="checkbox"/>	PHONED
PHONE <u>John Souza</u> <u>P. 17</u> / <u>L. 268</u>		<input type="checkbox"/>	RETURNED YOUR CALL
AREA CODE _____ NUMBER _____ EXTENSION _____		<input type="checkbox"/>	PLEASE CALL
MESSAGE <u>Re: 122 Frank St. O.K.</u>		<input type="checkbox"/>	WILL CALL AGAIN
<u>to sign C.O. even though storm</u>		<input type="checkbox"/>	CAME TO SEE YOU
<u>loaders are not tied in - running</u>		<input type="checkbox"/>	WANTS TO SEE YOU
<u>onto 30 ft. of grass.</u>			
SIGNED _____	<u>Mich S</u>  48003		