

PERMIT NO.

23175



CITY OF NEW BEDFORD

DATE 12-18-01

SEWER AND/OR STORM DRAIN PERMIT

This certifies that permission is granted to

Charles E. Martin 151 Rowe St. N.B. Me. (508) 996-2335

Property Owner

Address

02740 Tel.

RECEIVED

to connect a sewer and/or storm drain located at 151 Rowe St. (W.S.) 120' S. Sample St.

Assessor's Plot. 87, Lot. 36, to the sewer and/or storm drain in Rowe Street

JAN 16 2002

to be laid in accordance with the conditions in this application and the City of New Bedford ordinances

DEPT. OF PUBLIC WORKS
NEW BEDFORD, MASS

TYPE OF USE: ☒ RESIDENTIAL ☐ COMMERICAL ☐ INDUSTRIAL ☐ OTHER

330 6th

If applicant other than actual property owner, attach Letter of Authorization from Property Owner.

Name N/A Tel.

Mailing Address

The Bonded Contractor/Drain Layer authorized to perform this work is:

Stub at P.L.

Reis Asphalt Inc. 476 Hixville Rd. N. Dartmouth Me. (508) 996-0735

Name

Address

Tel.

Type of Pipe Required: PK SDR 35

PERMIT EXPIRES ONE YEAR AFTER DATE OF ISSUE

* Requires separate connections for sewage and storm drain where applicable. Storm water cannot be discharged to a sanitary sewer.

* All work must be inspected and approved by a D.P.W. inspector before backfilling.

* If this connection is to be part of a private service shared jointly with other building owners, attach copy of Recorded Joint Maintenance Agreement.

* Permits can be issued to Industrial and/or Commercial Applicants only upon receipt and approval by the Commissioner of Public Works of required plans and supplemental information.

* In addition, a City-issued Industrial User Discharge Permit and/or a Sewer Extension/Connection Permit issued by the Commonwealth of Massachusetts D.E.P. shall be required by the City for Industrial Discharge into the sewer system.

Industrial User Discharge Permit No. Date

Comm. Mass. Sewer Conn./Ext. Permit No. Date

A Filing and Inspection Fee of \$150.00, plus an Entrance Fee of \$352.80 where applicable, must accompany this application.

Bank # 1030 Community Check # 251 Date: 12/18/01 Receipt # 4223

Other requirements: Inspection Only - 141.70/H-8241

\$352.80; Permit Fee = \$150.00; Total Cost = \$502.80

Must contact Health Dept. re: Sewer System Abandonment.

☒ Sewer

Connection made to

Part of jointly-shared private line ☐ Yes ☒ No

☐ Storm Drain

FOR INSPECTION ONLY, A 24 HOUR NOTICE IS REQUIRED AND THE CONTRACTOR/APPLICANT IS REQUIRED TO NOTIFY THE WASTEWATER DIVISION AT 991-6158

Applicant agrees to abide by the above terms, as well as all pertinent ordinances of the City of New Bedford, and all other special rules as the Commissioner of Public Works may deem necessary

Lawrence L. Warden / 1022

Commissioner of Public Works

Signature of Property Owner or Representative

INSPECTED BY: PETER SCIESZKA

DATE: 12/27/01

COMMENTS: Stub from main to be installed under Rowe St. Area Sewer project and inspected by CDM.

☒ APPROVED

☐ DISAPPROVED

SIGNATURE

1-746

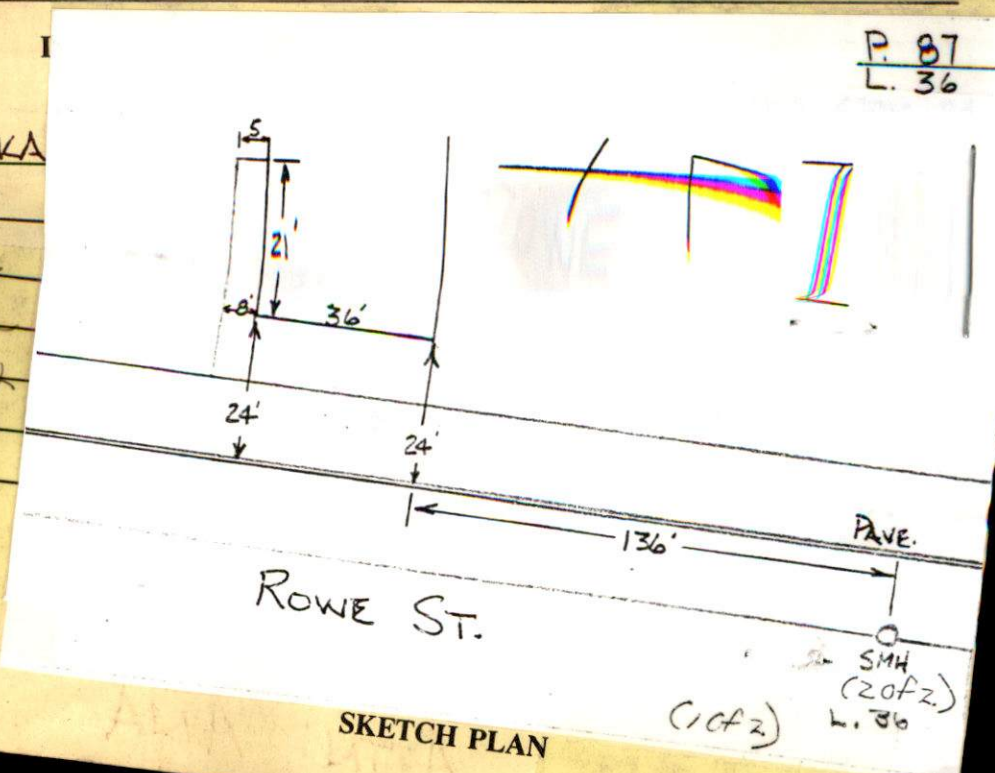

SKETCH PLAN

PERMIT NO.

23175



CITY OF NEW BEDFORD

DATE 12-18-01

SEWER AND/OR STORM DRAIN PERMIT

This certifies that permission is granted to Charles E. Martin 151 Rowe St. N.B. Me. (508) 996-2335
Property Owner Address 02740 Tel.

to connect a sewer and/or storm drain located at 151 Rowe St. (455) 120' (44') S. 1 SAWYER ST.
Assessor's Plot 87, Lot 36, to the sewer and/or storm drain in Rowe Street
to be laid in accordance with the conditions in this application and the City of New Bedford ordinances.

TYPE OF USE: ☒ RESIDENTIAL ☐ COMMERICAL ☐ INDUSTRIAL ☐ OTHER 330 6RD

If applicant other than actual property owner, attach Letter of Authorization from Property Owner.

Name N/A Tel.

Mailing Address.

The Bonded Contractor/Drain Layer authorized to perform this work is: Stub at P.L.
Reis Asphalt Inc. 476 Hixville Rd. N. Dartmouth Me. (508) 996-0735
Name Address Tel.

Type of Pipe Required: PK SDR 35

PERMIT EXPIRES ONE YEAR AFTER DATE OF ISSUE

* Requires separate connections for sewage and storm drain where applicable. Storm water cannot be discharged to a sanitary sewer.

* All work must be inspected and approved by a D.P.W. inspector before backfilling.

* If this connection is to be part of a private service shared jointly with other building owners, attach copy of Recorded Joint Maintenance Agreement.

* Permits can be issued to Industrial and/or Commercial Applicants only upon receipt and approval by the Commissioner of Public Works of required plans and supplemental information.

* In addition, a City-issued Industrial User Discharge Permit and/or a Sewer Extension/Connection Permit issued by the Commonwealth of Massachusetts D.E.P. shall be required by the City for Industrial Discharge into the sewer system.

Industrial User Discharge Permit No. Date.

Comm. Mass. Sewer Conn./Ext. Permit No. Date.

A Filing and Inspection Fee of \$150.00 plus an Entrance Fee of \$352.80 where applicable, must accompany this application.

Bank # Luzon Community Check # 251 Date: 12/18/01 Receipt # 4223

Other requirements: Inspection Only - Rowe St. Sewer Proj. Stub Cost = \$14.70/ft x 24' =

\$352.80; Permit Fee = \$150.00; Total Cost = \$502.80

must contact Health Dept re: Sotic System Abandonment.

Connection made to ☒ Sewer Part of jointly-shared private line ☐ Yes ☒ No
☐ Storm Drain

FOR INSPECTION ONLY, A 24 HOUR NOTICE IS REQUIRED AND THE CONTRACTOR/APPLICANT IS REQUIRED TO NOTIFY THE WASTEWATER DIVISION AT 991-6158

Applicant agrees to abide by the above terms, as well as all pertinent ordinances of the City of New Bedford, and such other special rules as the Commissioner of Public Works may deem necessary

Lawrence D. Warden 1022
Commissioner of Public Works

Signature of Property Owner or Representative

INSPECTOR'S REPORT

INSPECTED BY:

DATE:

COMMENTS:

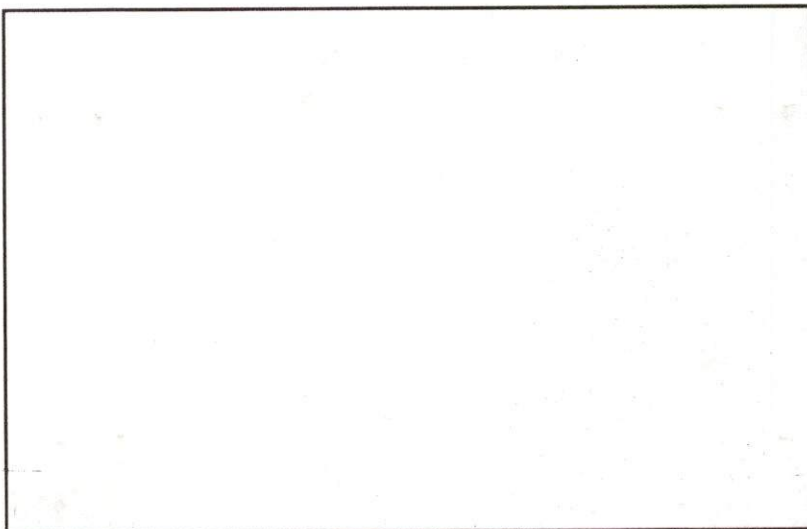

☐ APPROVED ☐ DISAPPROVED

SIGNATURE

SKETCH PLAN

