

PERMIT NO.

23174



CITY OF NEW BEDFORD

DATE 12-14-01

SEWER AND/OR STORM DRAIN PERMIT

This certifies that permission is granted to 837 Paul L. Tomasik 837 Hathaway Rd. (508) 994-2098

Property Owner

Address

Tel.

to connect a sewer and/or storm drain located at 809 Hathaway Rd. (N.S.) W. 1 220 GPD Assessor's Plot 121, Lot 14, to the sewer and/or storm drain in Hathaway Rd. Pinnidge St. Street to be laid in accordance with the conditions in this application and the City of New Bedford ordinances.

TYPE OF USE: ☒ RESIDENTIAL ☐ COMMERICAL ☐ INDUSTRIAL ☐ OTHER

If applicant other than actual property owner, attach Letter of Authorization from Property Owner.

RECEIVED

Name (N.S.) W. 1 Pinnidge St. Tel. JAN 25 2002

Mailing Address

DEPT. OF PUBLIC WORKS
NEW BEDFORD, MASS.

The Bonded Contractor/Drain Layer authorized to perform this work is:

Rago Construction 129 High Hill Rd. No Dartmouth (508) 995-1700

Name

Address

Tel.

Type of Pipe Required: PVC SDR-35

PERMIT EXPIRES ONE YEAR AFTER DATE OF ISSUE

* Requires separate connections for sewage and storm drain where applicable. Storm water cannot be discharged to a sanitary sewer.

* All work must be inspected and approved by a D.P.W. inspector before backfilling.

* If this connection is to be part of a private service shared jointly with other building owners, attach copy of Recorded Joint Maintenance Agreement.

* Permits can be issued to Industrial and/or Commercial Applicants only upon receipt and approval by the Commissioner of Public Works of required plans and supplemental information.

* In addition, a City-issued Industrial User Discharge Permit and/or a Sewer Extension/Connection Permit issued by the Commonwealth of Massachusetts D.E.P. shall be required by the City for Industrial Discharge into the sewer system.

Industrial User Discharge Permit No. N/A Date

Comm. Mass. Sewer Conn./Ext. Permit No. N/A Date

A Filing and Inspection Fee of \$150.00, plus an Entrance Fee of \$660.00 where applicable, must accompany this application.

Bank # Citizens Bank Check # 858 Date: 12-14-01 Receipt # 4222

Other requirements: Insp only, connection to the stub at property line

☒ Sewer

Connection made to

Part of jointly-shared private line ☐ Yes ☒ No

☐ Storm Drain

Applicant agrees to abide by the above terms, as well as all pertinent ordinances of the City of New Bedford, and such other special rules as the Commissioner of Public Works may deem necessary

Commissioner of Public Works

Signature of Property Owner or Representative

INSPECTED BY: JOSEPH MARTIN

DATE: 12/19/01

COMMENTS:

☒ APPROVED

☐ DISAPPROVED

SIGNATURE

31-746

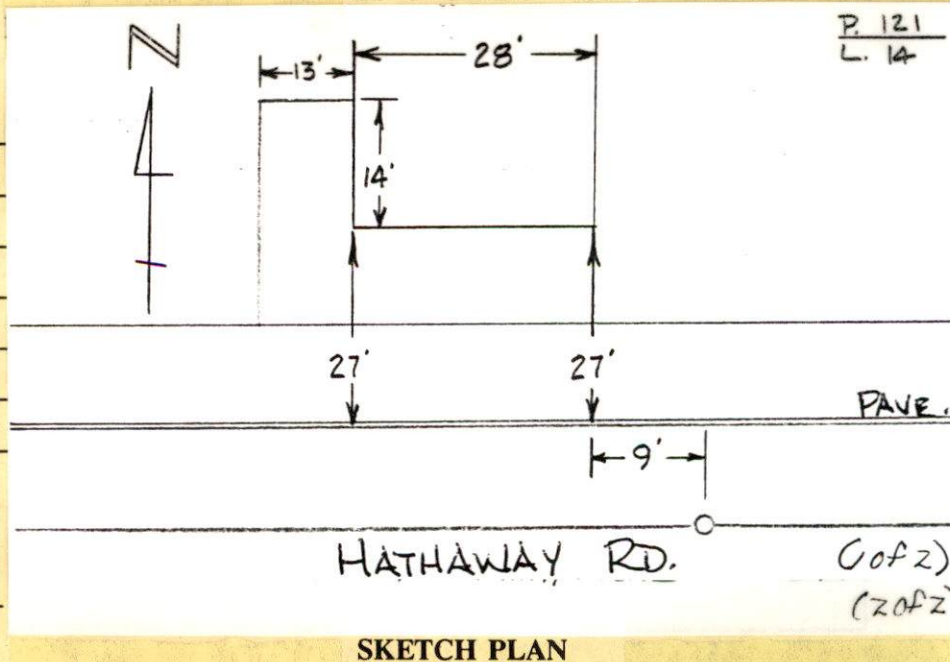

PERMIT NO.

23174



CITY OF NEW BEDFORD

DATE 12-14-01

SEWER AND/OR STORM DRAIN PERMIT

This certifies that permission is granted to 837

Paul L. Tomasik 837 Hathaway Rd. (508) 994-2098

Property Owner

Address

Tel.

to connect a sewer and/or storm drain located at 809 Hathaway Rd. (N.S.) W. of 220 GPD
Assessor's Plot 121, Lot 14, to the sewer and/or storm drain in Hathaway Rd. Pritchard St. Street

to be laid in accordance with the conditions in this application and the City of New Bedford ordinances.

TYPE OF USE: ☒ RESIDENTIAL ☐ COMMERICAL ☐ INDUSTRIAL ☐ OTHER

If applicant other than actual property owner, attach Letter of Authorization from Property Owner.

Name..... Tel.....

Mailing Address.....

The Bonded Contractor/Drain Layer authorized to perform this work is:

Rago Construction 129 High Hill Rd. No Dartmouth (508) 995-1700

Name

Address

Tel.

Type of Pipe Required: PVC SDR-35

PERMIT EXPIRES ONE YEAR AFTER DATE OF ISSUE

* Requires separate connections for sewage and storm drain where applicable. Storm water cannot be discharged to a sanitary sewer.

* All work must be inspected and approved by a D.P.W. inspector before backfilling.

* If this connection is to be part of a private service shared jointly with other building owners, attach copy of Recorded Joint Maintenance Agreement.

* Permits can be issued to Industrial and/or Commercial Applicants only upon receipt and approval by the Commissioner of Public Works of required plans and supplemental information.

* In addition, a City-issued Industrial User Discharge Permit and/or a Sewer Extension/Connection Permit issued by the Commonwealth of Massachusetts D.E.P. shall be required by the City for Industrial Discharge into the sewer system.

Industrial User Discharge Permit No. N/A Date.....

Comm. Mass. Sewer Conn./Ext. Permit No. N/A Date.....

A Filing and Inspection Fee of \$150.00, plus an Entrance Fee of \$660.00 where applicable, must accompany this application.

Bank # Citizens Bank Check # 858 Date: 12-14-01 Receipt # 4222

Other requirements: Insp. only, connection to the stub at property line

☒ Sewer

Connection made to

Part of jointly-shared private line ☐ Yes ☒ No

☐ Storm Drain

Applicant agrees to abide by the above terms, as well as all pertinent ordinances of the City of New Bedford, and such other special rules as the Commissioner of Public Works may deem necessary

Laurence D. Worden
Commissioner of Public Works

Paul L. Tomasik
Signature of Property Owner or Representative

INSPECTOR'S REPORT

INSPECTED BY: _____

DATE: _____

COMMENTS: _____

☐ APPROVED

☐ DISAPPROVED

SIGNATURE

SKETCH PLAN