

23173



DATE.....12/14/01.....

## SEWER AND/OR STORM DRAIN PERMIT

This certifies that permission is granted to  
Paul Tomasiuk 837 Hathaway Rd. New Bedford 508-994-2098  
 Property Owner Address Tel.

Property Owner \_\_\_\_\_ Address \_\_\_\_\_  
to connect a sewer and/or storm drain located at 837 Hathaway Rd. (N.S.) W. Pineridge St.  
Assessor's Plot 121, Lot 98, to the sewer and/or storm drain in Hathaway Rd. Street

to be laid in accordance with the conditions in this application and the City of New Bedford ordinances

RECEIVED

TYPE OF USE: ☒ RESIDENTIAL ☐ COMMERICAL ☐ INDUSTRIAL ☐ OTHER

**JAN 25 2002**

If applicant other than actual property owner, attach Letter of Authorization from Property Owner.

DEPT. OF PUBLIC WORKS  
NEW BEDFORD, MASS.

Name..... Tel..... NEW BEDFORD, MASS.

Mailing Address.....

The Bonded Contractor/Drain Layer authorized to perform this work is:

Rego Construction 129 High Hill Rd. No. Dartmouth, 508-995-1700

Type of Pipe Required: PVC SDR-35

**PERMIT EXPIRES ONE YEAR AFTER DATE OF ISSUE**

- \* Requires separate connections for sewage and storm drain where applicable. Storm water cannot be discharged to a sanitary sewer.
- \* All work must be inspected and approved by a D.P.W. inspector before backfilling.
- \* If this connection is to be part of a private service shared jointly with other building owners, attach copy of Recorded Joint Maintenance Agreement.
- \* Permits can be issued to Industrial and/or Commercial Applicants only upon receipt and approval by the Commissioner of Public Works of required plans and supplemental information.
- \* In addition, a City-issued Industrial User Discharge Permit and/or a Sewer Extension/Connection Permit issued by the Commonwealth of Massachusetts D.E.P. shall be required by the City for Industrial Discharge into the sewer system.

Industrial User Discharge Permit No.....Date.....

Comm. Mass. Sewer Conn./Ext. Permit No.....Date.....

A Filing and Inspection Fee of \$ 150.00, plus an Entrance Fee of \$ 660.00 where applicable, must accompany this application.

Bank # Citizens Bank Check # 858 Date: ~~8/8~~ 12/14/01 Receipt # 4222

Other requirements: Insp. Only Connection to Stbb

Connection made to ☒ Sewer ☐ Storm Drain Part of jointly-shared private line ☐ Yes ☒ No

**Applicant agrees to abide by the above terms, as well as all pertinent ordinances of the City of New Bedford, and such other special rules as the Commissioner of Public Works may deem necessary**

Lawrence D. Worden (ms)  
Commissioner of Public Works

*Paul L. Yarnall*  
Signature of Property Owner or Representative

INSPECTED BY: JOSEPH MARTIN

DATE: 12/26/01

COMMENTS: CNB put in stub -  
Health Rcl. Sewer Proj.

☒ APPROVED

☐ DISAPPROVED

SIGNATURE

31-746

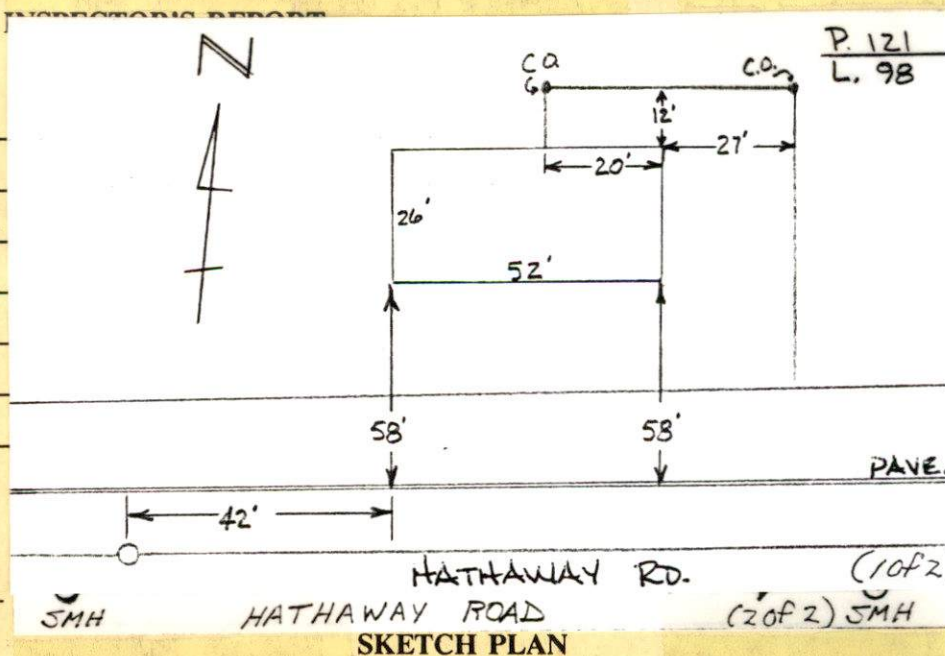



PERMIT NO.

23173



CITY OF NEW BEDFORD

DATE 12/14/01

SEWER AND/OR STORM DRAIN PERMIT

This certifies that permission is granted to

Paul Tomasik 837 Hathaway Rd New Bedford 508-994-2098  
Property Owner Address Tel.

to connect a sewer and/or storm drain located at 837 Hathaway Rd (N.S.) W. / Pine St.  
Assessor's Plot 121, Lot 98, to the sewer and/or storm drain in Hathaway Rd Street  
to be laid in accordance with the conditions in this application and the City of New Bedford ordinances.

TYPE OF USE: ☒ RESIDENTIAL ☐ COMMERICAL ☐ INDUSTRIAL ☐ OTHER

If applicant other than actual property owner, attach Letter of Authorization from Property Owner.

330 GPD

Name Tel.

Mailing Address

The Bonded Contractor/Drain Layer authorized to perform this work is:

Rego Construction 129 High Hill Rd No. Dartmouth 508-995-1700  
Name Address Tel.

Type of Pipe Required: PVC SDR-35

PERMIT EXPIRES ONE YEAR AFTER DATE OF ISSUE

- \* Requires separate connections for sewage and storm drain where applicable. Storm water cannot be discharged to a sanitary sewer.
- \* All work must be inspected and approved by a D.P.W. inspector before backfilling.
- \* If this connection is to be part of a private service shared jointly with other building owners, attach copy of Recorded Joint Maintenance Agreement.
- \* Permits can be issued to Industrial and/or Commercial Applicants only upon receipt and approval by the Commissioner of Public Works of required plans and supplemental information.
- \* In addition, a City-issued Industrial User Discharge Permit and/or a Sewer Extension/Connection Permit issued by the Commonwealth of Massachusetts D.E.P. shall be required by the City for Industrial Discharge into the sewer system.

Industrial User Discharge Permit No. Date

Comm. Mass. Sewer Conn./Ext. Permit No. Date

A Filing and Inspection Fee of \$150.00, plus an Entrance Fee of \$660.00 where applicable, must accompany this application.

Bank # Citizens Bank Check # 858 Date: 12/14/01 Receipt # 4222

Other requirements: Insp. Only Connection to Stb.

☒ Sewer

Connection made to

Part of jointly-shared private line ☐ Yes ☒ No

☐ Storm Drain

Applicant agrees to abide by the above terms, as well as all pertinent ordinances of the City of New Bedford, and such other special rules as the Commissioner of Public Works may deem necessary

Laurence D. Worden  
Commissioner of Public Works

Paul L. Yonail  
Signature of Property Owner or Representative

INSPECTOR'S REPORT

INSPECTED BY:

DATE:

COMMENTS:

☐ APPROVED

☐ DISAPPROVED

SIGNATURE

SKETCH PLAN