

PERMIT NO.

23171



CITY OF NEW BEDFORD

DATE 12/11/01
EXP 12/11/02

SEWER AND/OR STORM DRAIN PERMIT

This certifies that permission is granted to

Property Owner

Address

Tel. (508) 992-0972

to connect a sewer and/or storm drain located at Hathaway Rd. # 834 (S.S.) W. 1. Pinbridge St.

Assessor's Plot 120, Lot 15, to the sewer and/or storm drain in Hathaway Rd. Street

to be laid in accordance with the conditions in this application and the City of New Bedford ordinances.

TYPE OF USE: ☒ RESIDENTIAL ☐ COMMERICAL ☐ INDUSTRIAL ☐ OTHER

If applicant other than actual property owner, attach Letter of Authorization from Property Owner. **RECEIVED**

Name N/A Tel. **JAN 25 2002**

Mailing Address DEPT. OF PUBLIC WORKS
NEW BEDFORD, MASS.

The Bonded Contractor/Drain Layer authorized to perform this work is:

Name Rego Contracting LLC 132 High Hill Rd. N. Dartmouth MA 02717 (508) 715-1700
Address Address Address
Tel. Tel. Tel.

Type of Pipe Required: PVC 500 35

PERMIT EXPIRES ONE YEAR AFTER DATE OF ISSUE

- * Requires separate connections for sewage and storm drain where applicable. Storm water cannot be discharged to a sanitary sewer.
- * All work must be inspected and approved by a D.P.W. inspector before backfilling.
- * If this connection is to be part of a private service shared jointly with other building owners, attach copy of Recorded Joint Maintenance Agreement.
- * Permits can be issued to Industrial and/or Commercial Applicants only upon receipt and approval by the Commissioner of Public Works of required plans and supplemental information.
- * In addition, a City-issued Industrial User Discharge Permit and/or a Sewer Extension/Connection Permit issued by the Commonwealth of Massachusetts D.E.P. shall be required by the City for Industrial Discharge into the sewer system.

Industrial User Discharge Permit No. Date

Comm. Mass. Sewer Conn./Ext. Permit No. Date

A Filing and Inspection Fee of \$150.00, plus an Entrance Fee of \$330.00 where applicable, must accompany this application.

Bank # FNL Bank Check # 0264 Date: 12/11/01 Receipt # 4228

Other requirements: Inspection Only - Stub at P.L. - Hathaway Rd. Sewer Project

Stub = 15' x 22" I.P. = \$330.00; Permit = \$150.00;

Total = \$480.00

Connection made to ☒ Sewer ☐ Storm Drain Part of jointly-shared private line ☐ Yes ☒ No

FOR INSPECTION ONLY, A 24 HOUR NOTICE IS REQUIRED AND THE CONTRACTOR/APPLICANT IS REQUIRED TO NOTIFY THE WASTEWATER DIVISION AT 991-6158

Applicant agrees to abide by the above terms, as well as all pertinent ordinances of the City of New Bedford, and such other special rules as the Commissioner of Public Works may deem necessary

Commissioner of Public Works

Signature of Property Owner or Representative

INSPECTED BY: JOSEPH MARTIN

DATE: 12/21/01

COMMENTS: CMB put in stub -
Hath. Rd. Sewer project.

☒ APPROVED ☐ DISAPPROVED

SIGNATURE

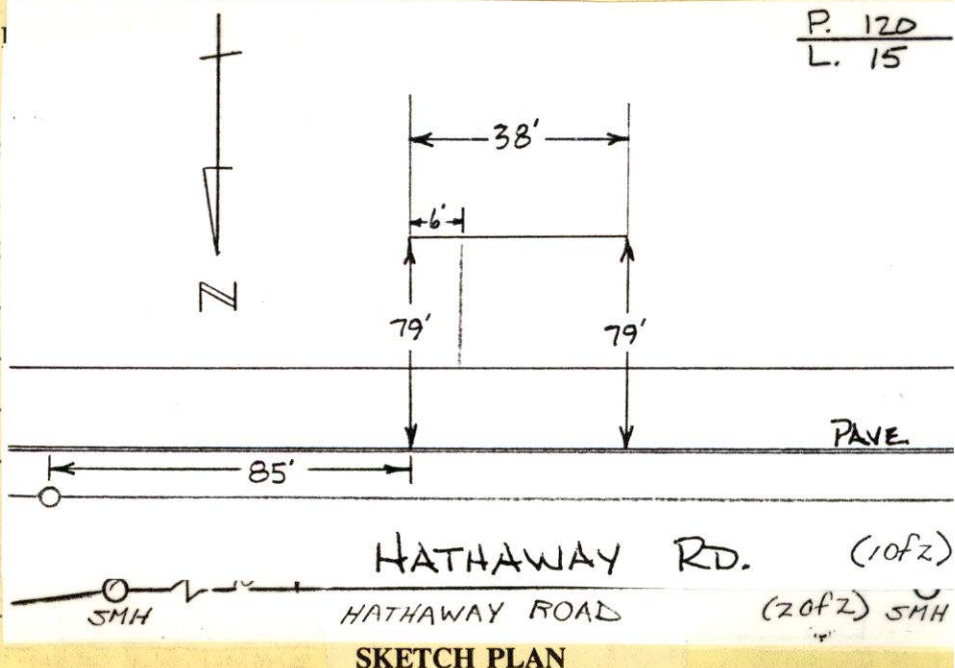

PERMIT NO.
23171



CITY OF NEW BEDFORD
SEWER AND/OR STORM DRAIN PERMIT

DATE 12/14/01
EXP 12/14/02

This certifies that permission is granted to
Ralph W. & Marjorie E. Hall 834 Hathaway Rd. New Bedford MA 02741
Property Owner Address Tel. (508) 992-0972

to connect a sewer and/or storm drain located at Hathaway Rd # 834 (S.S.) W. Prunidge St.
Assessor's Plot. 120, Lot. 15, to the sewer and/or storm drain in Hathaway Rd. Street

to be laid in accordance with the conditions in this application and the City of New Bedford ordinances.

TYPE OF USE: ☒ RESIDENTIAL ☐ COMMERICAL ☐ INDUSTRIAL ☐ OTHER

330 GPD

If applicant other than actual property owner, attach Letter of Authorization from Property Owner.

Name N/A Tel.

Mailing Address

The Bonded Contractor/Drain Layer authorized to perform this work is: Stub at P.L.
Rego Contracting, LLC 129 High Hill Rd. N. Dart MA 02747 (508) 995-1700
Name Michael D. Rego Address Tel.

Type of Pipe Required: PVC SDR 35

PERMIT EXPIRES ONE YEAR AFTER DATE OF ISSUE

- * Requires separate connections for sewage and storm drain where applicable. Storm water cannot be discharged to a sanitary sewer.
- * All work must be inspected and approved by a D.P.W. inspector before backfilling.
- * If this connection is to be part of a private service shared jointly with other building owners, attach copy of Recorded Joint Maintenance Agreement.
- * Permits can be issued to Industrial and/or Commercial Applicants only upon receipt and approval by the Commissioner of Public Works of required plans and supplemental information.
- * In addition, a City-issued Industrial User Discharge Permit and/or a Sewer Extension/Connection Permit issued by the Commonwealth of Massachusetts D.E.P. shall be required by the City for Industrial Discharge into the sewer system.

Industrial User Discharge Permit No. Date

Comm. Mass. Sewer Conn./Ext. Permit No. Date

A Filing and Inspection Fee of \$ 150.00 plus an Entrance Fee of \$ 330.00 where applicable, must accompany this application.

Bank # PNC Bank Check # 0264 Date: 12/14/01 Receipt # 4221

Other requirements: Inspection Only - Stub at P.L. - Hathaway Rd. Sewer Project

Stub = 15' X 22" I.P. = \$330.00; Permit = \$150.00;

Total = \$480.00

Connection made to ☒ Sewer ☐ Storm Drain

Part of jointly-shared private line ☐ Yes ☒ No

FOR INSPECTION ONLY, A 24 HOUR
NOTICE IS REQUIRED AND THE
CONTRACTOR/APPLICANT IS
REQUIRED TO NOTIFY THE
WASTEWATER DIVISION AT 991-6158

Applicant agrees to abide by the above terms, as well as all pertinent ordinances of the City of New Bedford, and such other special rules as the Commissioner of Public Works may deem necessary

Lanorris D. Woodenlase
Commissioner of Public Works

Ralph W. Hall
Signature of Property Owner or Representative

INSPECTOR'S REPORT

INSPECTED BY:

DATE:

COMMENTS:

☐ APPROVED ☐ DISAPPROVED

SIGNATURE

SKETCH PLAN



CITY OF NEW BEDFORD MASSACHUSETTS

DEPARTMENT OF PUBLIC WORKS
ENGINEERING DIVISION
133 WILLIAM STREET, ROOM 303
NEW BEDFORD, MA 02740
Tel: (508) 979-1527
Fax: (508) 961-3043

November 21, 2001

Attn: Ralph W. & Marjorie E. Hall
834 Hathaway Rd.
New Bedford, MA 02740

Re: Hathaway Road Area Sewer Project--Properties for Which Sewer Services Have Been
Approved and Are Available for Connection

This letter serves as notification to you that the following property may now connect to the sewer system:

Owner(s):	Hall, Ralph W. & Marjorie E.
Location:	834 Hathaway Rd.
Plot/Lot:	120/15
Service Pipe Length Installed:	15'
Total Cost of Service Line:	\$330.00

In addition to the cost of the service line provided for the property, which the property owner must reimburse the City for when ready to connect to the sewer system, there is also a "Sewer Permit" fee of \$150.00. Once ready to connect to the sewer system, the property owner must come to City Hall, D.P.W. Engineering office, Room 303, to obtain said permit, at which time both of these amounts are due to the City. If someone other than the property owner is going to obtain the permit, this person must have a signed permission slip from the property owner allowing the entity to sign on behalf of the property owner. Also, if the property owner is abandoning a septic system, they must make arrangements with the Health Department at (508) 991-6273.

The City has brought the sewer service pipe to your property line. The property owner is responsible for making the provisions for any work required and costs incurred on their property. Property owners should make sure that the contractor they hire knows that, although they are working on private property, the D.P.W. Waste Water Division, and possibly other City officials, must inspect all work done before the sewer trench is backfilled.

Should you have any questions or need additional information, please feel free to contact Ana Rosa or Mario Gomes in the Engineering Department at (508) 979-1527.

Sincerely,

Duarte M. Andrade
Supervising Civil Engineer

DMA/asr