

PERMIT NO.

23156



CITY OF NEW BEDFORD

DATE.....11/21/01.....

SEWER AND/OR STORM DRAIN PERMIT

This certifies that permission is granted to

J.M.P. DEVELOPMENT - 24 JOCELYN ST. - N.B. 02745 -
Property Owner Address Tel.

to connect a sewer and/or storm drain located at OHIO ST. - NS 280'± W/PINE GROVE ST.
Assessor's Plot...127C Lot...464, to the sewer and/or storm drain in OHIO ST. - Street

to be laid in accordance with the conditions in this application and the City of New Bedford ordinances.

TYPE OF USE: ☒ RESIDENTIAL ☐ COMMERCIAL ☐ INDUSTRIAL ☐ OTHER

If applicant other than actual property owner, attach Letter of Authorization from Property Owner.

RECEIVED

JAN 16 2002

DEPT. OF PUBLIC WORKS
NEW BEDFORD, MASS

Name.....Tel.....

Mailing Address.....

The Bonded Contractor/Drain Layer authorized to perform this work is:

R.T. CANESSA - (508) 993-9508
Name Address Tel.

Type of Pipe Required: P.V.C. SDR 35

PERMIT EXPIRES ONE YEAR AFTER DATE OF ISSUE

- * Requires separate connections for sewage and storm drain where applicable. Storm water cannot be discharged to a sanitary sewer.
- * All work must be inspected and approved by a D.P.W. inspector before backfilling.
- * If this connection is to be part of a private service shared jointly with other building owners, attach copy of Recorded Joint Maintenance Agreement.
- * Permits can be issued to Industrial and/or Commercial Applicants only upon receipt and approval by the Commissioner of Public Works of required plans and supplemental information.
- * In addition, a City-issued Industrial User Discharge Permit and/or a Sewer Extension/Connection Permit issued by the Commonwealth of Massachusetts D.E.P. shall be required by the City for Industrial Discharge into the sewer system.

Industrial User Discharge Permit No.....Date.....

Comm. Mass. Sewer Conn./Ext. Permit No.....Date.....

A Filing and Inspection Fee of \$150.00, plus an Entrance Fee of \$..... where applicable, must accompany this application.

Bank # CITIZENS BANK Check # 1075 Date: NOV-20-01 Receipt # 4196

Other requirements: 12SP ONLY - 330 GPD

TO BE CONNECTED TO: 8" SEWER & 10" SURF DRAIN

8" ☒ Sewer

Connection made to

10" ☒ Storm Drain

Part of jointly-shared private line ☐ Yes ☒ No

Applicant agrees to abide by the above terms, as well as all pertinent ordinances of the City of New Bedford, and such other special rules as the Commissioner of Public Works may deem necessary

Signature of Commissioner of Public Works

Commissioner of Public Works

Signature of Property Owner or Representative

Signature of Property Owner or Representative

INSPECTOR'S REPORT

INSPECTED BY: JOSEPH MARTIN

DATE: 11/28/01

COMMENTS:

☒ APPROVED

☐ DISAPPROVED

SIGNATURE

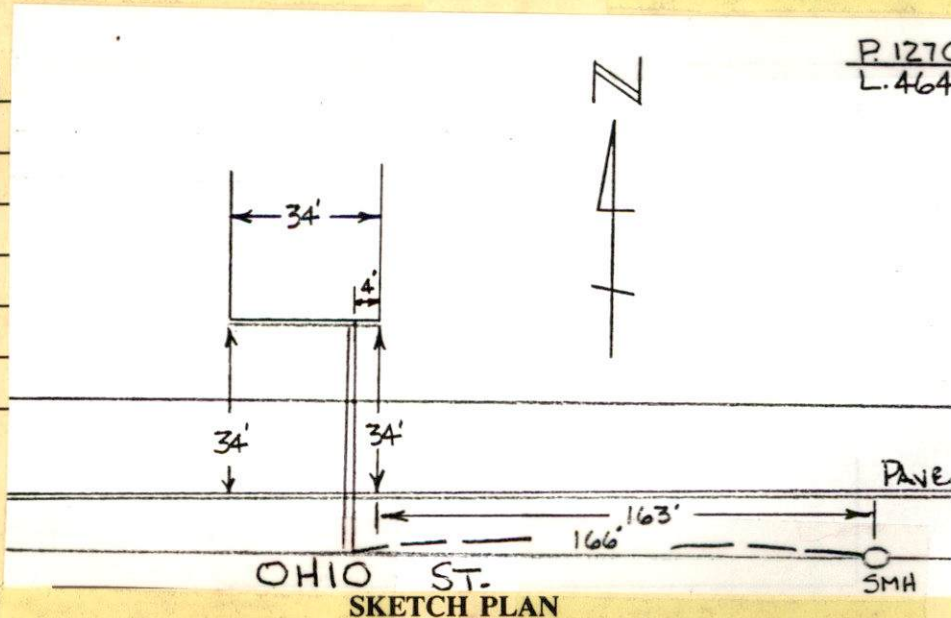

PERMIT NO.

23156



CITY OF NEW BEDFORD

DATE.....11/21/01.....

SEWER AND/OR STORM DRAIN PERMIT

This certifies that permission is granted to

J.M.P. DEVELOPMENT - 24 JOCKLYN ST. - N.B. 02745
Property Owner Address Tel.

to connect a sewer and/or storm drain located at OHIO ST. NS 280'E W/PINE GROVE ST.
Assessor's Plot...137C Lot...464, to the sewer and/or storm drain in OHIO ST. Street
to be laid in accordance with the conditions in this application and the City of New Bedford ordinances.

TYPE OF USE: ☒ RESIDENTIAL ☐ COMMERICAL ☐ INDUSTRIAL ☐ OTHER

If applicant other than actual property owner, attach Letter of Authorization from Property Owner.

Name..... Tel.....

Mailing Address.....

The Bonded Contractor/Drain Layer authorized to perform this work is:

RT CANESSA - (Job) 993-9508
Name Address Tel.

Type of Pipe Required: P.V.C. - SDR 35

PERMIT EXPIRES ONE YEAR AFTER DATE OF ISSUE

- * Requires separate connections for sewage and storm drain where applicable. Storm water cannot be discharged to a sanitary sewer.
- * All work must be inspected and approved by a D.P.W. inspector before backfilling.
- * If this connection is to be part of a private service shared jointly with other building owners, attach copy of Recorded Joint Maintenance Agreement.
- * Permits can be issued to Industrial and/or Commercial Applicants only upon receipt and approval by the Commissioner of Public Works of required plans and supplemental information.
- * In addition, a City-issued Industrial User Discharge Permit and/or a Sewer Extension/Connection Permit issued by the Commonwealth of Massachusetts D.E.P. shall be required by the City for Industrial Discharge into the sewer system.

Industrial User Discharge Permit No..... Date.....

Comm. Mass. Sewer Conn./Ext. Permit No..... Date.....

A Filing and Inspection Fee of \$150.00, plus an Entrance Fee of \$..... where applicable, must accompany this application.

Bank # CITIZENS BANK Check # 1075 Date: NOV-20-01 Receipt # 4196

Other requirements: INSP. ONLY - 330 GPD

TO BE CONNECTED TO: 8" SEWER & 10" SURF. DRAIN

8" ☒ Sewer
Connection made to 10" ☒ Storm Drain
Part of jointly-shared private line ☐ Yes ☒ No

FOR INSPECTION ONLY, A 24 HOUR NOTICE IS REQUIRED AND THE CONTRACTOR/APPLICANT IS REQUIRED TO NOTIFY THE WASTEWATER DIVISION AT 991-6158

Applicant agrees to abide by the above terms, as well as all pertinent ordinances of the City of New Bedford, and such other special rules as the Commissioner of Public Works may deem necessary

Lawrence J. Worden
Commissioner of Public Works

Signature of Property Owner or Representative

INSPECTOR'S REPORT

INSPECTED BY: _____

DATE: _____

COMMENTS: _____

☐ APPROVED ☐ DISAPPROVED

SIGNATURE

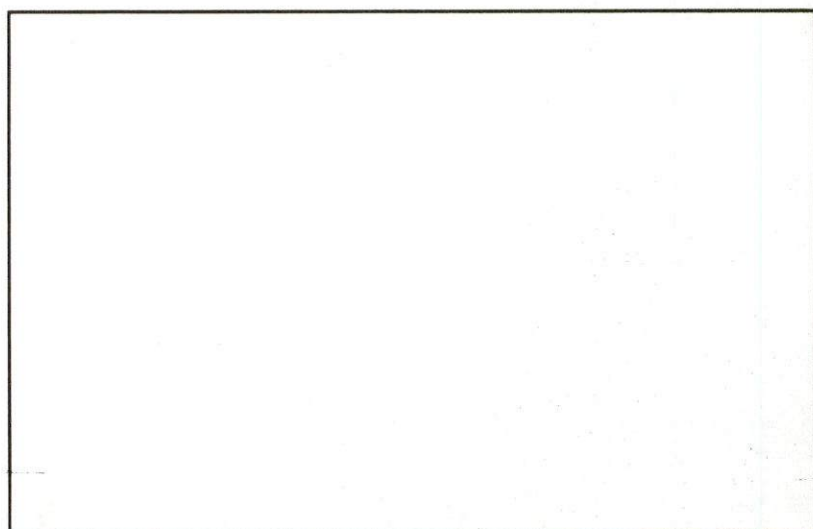

SKETCH PLAN



MAP 127C SUB. LOT 3
4,886 Sq.Ft.

TOP OF FOUNDATION
ELEV 103.4'

53.01'

41'

93.58'

6'

92.61'

12'

20'

52.00'

OHIO STREET

8" SEWER
x100.0 C

10" SURF. DR.

Driveway



certify that the foundation
shown on this plan is in
compliance with the applicable
Building By-Laws in the
City of New Bedford.

Freia's Engineering Inc.

"AS-BUILT"
FOUNDATION PLAN
SUBDIVISION LOT 3
OHIO STREET
in
NEW BEDFORD, MA.