

PERMIT NO.  
23142



CITY OF NEW BEDFORD  
SEWER AND/OR STORM DRAIN PERMIT

DATE 10/26/01  
EXP 10/26/02

This certifies that permission is granted to  
Rockdale Nomine Realty Trust/Mark A. Smith, Trs. 700 Bay 622 Stoughton, MA  
Property Owner Address Tel. (508) 992-7800 MA  
to connect a sewer and/or storm drain located at Rockdale Ave. #1173 (W.S.) N. 1st St. 02071  
Assessor's Plot 74, Lot 183, to the sewer and/or storm drain in Rockdale Ave. Street  
to be laid in accordance with the conditions in this application and the City of New Bedford ordinances.

TYPE OF USE: ☒ RESIDENTIAL ☐ COMMERICAL ☐ INDUSTRIAL ☐ OTHER

If applicant other than actual property owner, attach Letter of Authorization from Property Owner.

Name N/A John D. Maffei Tel. (508) 992-7800

Mailing Address 192 W. 1st St. Stoughton, MA 02072

The Bonded Contractor/Drain Layer authorized to perform this work is: Stub at R.

ACE Asphalt Co., Inc. 18 Nancy St. Fairhaven, MA 02719

Name

Address

Tel.

Type of Pipe Required: PVC SDR 35

PERMIT EXPIRES ONE YEAR AFTER DATE OF ISSUE

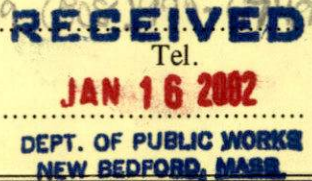

- \* Requires separate connections for sewage and storm drain where applicable. Storm water cannot be discharged to a sanitary sewer.
- \* All work must be inspected and approved by a D.P.W. inspector before backfilling.
- \* If this connection is to be part of a private service shared jointly with other building owners, attach copy of Recorded Joint Maintenance Agreement.
- \* Permits can be issued to Industrial and/or Commercial Applicants only upon receipt and approval by the Commissioner of Public Works of required plans and supplemental information.
- \* In addition, a City-issued Industrial User Discharge Permit and/or a Sewer Extension/Connection Permit issued by the Commonwealth of Massachusetts D.E.P. shall be required by the City for Industrial Discharge into the sewer system.

Industrial User Discharge Permit No. Date

Comm. Mass. Sewer Conn./Ext. Permit No. Date

A Filing and Inspection Fee of \$150.00, plus an Entrance Fee of \$323.40 where applicable, must accompany this application.

Bank # First Citizens Check # 14156 Date: 10/26/02 Receipt # 4167

Other requirements: Inspection Only, Rowe St Sewer Proj. Stub Cost: 22' x \$14.70/ft =

\$323.40 + Permit App: \$150.00 Total = \$473.40

Must contact Health Dept. re: sink system abandonment

Connection made to ☒ Sewer ☐ Storm Drain Part of jointly-shared private line ☐ Yes ☒ No

FOR INSPECTION ONLY, A 24 HOUR NOTICE IS REQUIRED AND THE CONTRACTOR/APPLICANT IS REQUIRED TO NOTIFY THE WASTEWATER DIVISION AT 991-6158

Applicant agrees to abide by the above terms, as well as all pertinent ordinances of the other special rules as the Commissioner of Public Works may deem necessary

Lawrence D. McRedden, Jr.  
Commissioner of Public Works

Signature of Property Owner or Representative

INSPECTOR'S REPORT

INSPECTED BY: JOSEPH MARTIN

DATE: 11/5/01

COMMENTS: Stub from main to R installed under Rowe St Area sewer project and inspected by ODM.

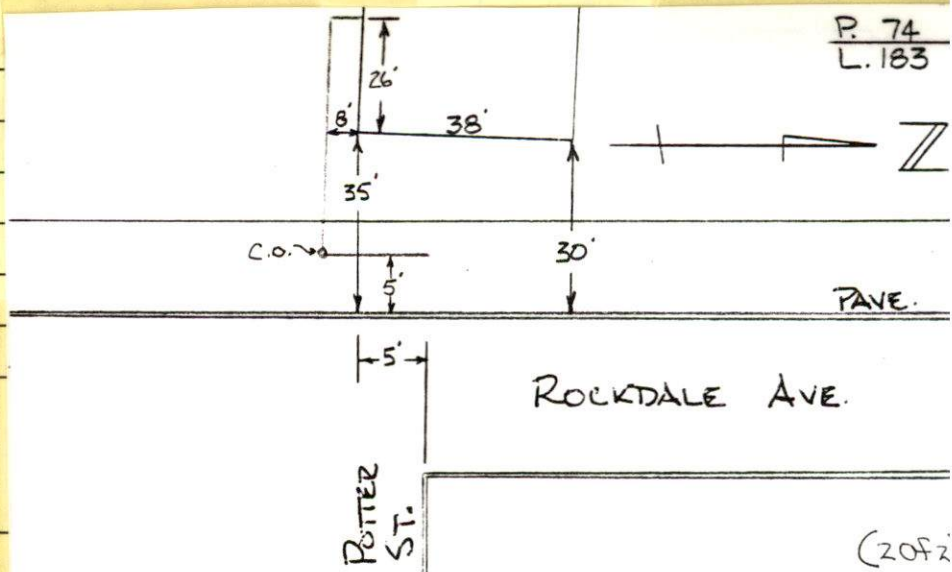

☒ APPROVED ☐ DISAPPROVED

SIGNATURE

(2 of 2)  
(1 of 2)



PERMIT NO.

23142



CITY OF NEW BEDFORD

SEWER AND/OR STORM DRAIN PERMIT

DATE 10/26/01  
EXP 10/26/02

This certifies that permission is granted to

Rockdale Nominee Realty Trust Mark A. Smith, Trs. P.O. Box 622 Stoughton  
Property Owner Address Tel. (508) 992-7800 MA

to connect a sewer and/or storm drain located at Rockdale Ave. #1173 (C.V.S.) N. 12th St. 02071  
Assessor's Plot 74, Lot 183, to the sewer and/or storm drain in Rockdale Ave. Street

to be laid in accordance with the conditions in this application and the City of New Bedford ordinances.

TYPE OF USE: ☒ RESIDENTIAL ☐ COMMERICAL ☐ INDUSTRIAL ☐ OTHER

220 GPD

If applicant other than actual property owner, attach Letter of Authorization from Property Owner.

Name John Maffei Tel. (508) 992-7800

Mailing Address 192 Mystic Dr. Norston Mills MA 02648

The Bonded Contractor/Drain Layer authorized to perform this work is: Stub out R.

Ace Asphalt Co., Inc. 18 Nancy St. Fairhaven, MA 02719 (508) 999-6749

Name

Address

Tel.

Type of Pipe Required: PVC SDR 35

PERMIT EXPIRES ONE YEAR AFTER DATE OF ISSUE

- \* Requires separate connections for sewage and storm drain where applicable. Storm water cannot be discharged to a sanitary sewer.
- \* All work must be inspected and approved by a D.P.W. inspector before backfilling.
- \* If this connection is to be part of a private service shared jointly with other building owners, attach copy of Recorded Joint Maintenance Agreement.
- \* Permits can be issued to Industrial and/or Commercial Applicants only upon receipt and approval by the Commissioner of Public Works of required plans and supplemental information.
- \* In addition, a City-issued Industrial User Discharge Permit and/or a Sewer Extension/Connection Permit issued by the Commonwealth of Massachusetts D.E.P. shall be required by the City for Industrial Discharge into the sewer system.

Industrial User Discharge Permit No. Date

Comm. Mass. Sewer Conn./Ext. Permit No. Date

A Filing and Inspection Fee of \$150.00 plus an Entrance Fee of \$323.40 where applicable, must accompany this application.

Bank # First Citizens Check # 1456 Date: 10/26/02 Receipt # 4167

Other requirements: Inspection Only Rowe St Sewer Proj. Stub Cost: 22' x \$14.70/ft =

\$323.40 + Permit App: \$150.00 Total = \$473.40

must contact Health Dept. re: septic system abandonment.

Connection made to ☒ Sewer ☐ Storm Drain Part of jointly-shared private line ☐ Yes ☒ No

Applicant agrees to abide by the above terms, as well as all pertinent ordinances of other special rules as the Commissioner of Public Works may deem necessary

Lawrence D. Warden / asr  
Commissioner of Public Works

Signature of Property Owner or Representative

INSPECTOR'S REPORT

INSPECTED BY: \_\_\_\_\_

DATE: \_\_\_\_\_

COMMENTS: \_\_\_\_\_

☐ APPROVED ☐ DISAPPROVED

SIGNATURE

SKETCH PLAN

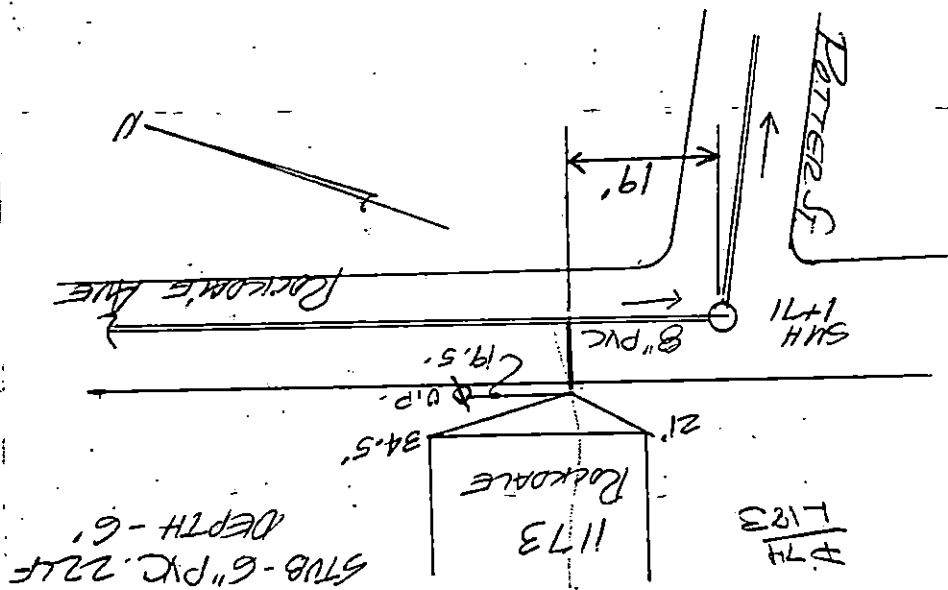

DRAIN	
Permit	No.
ROCKDALE AVE (#1173) WEST SIDE	
ROCKDALE AVE	
Drain Plot No.	
From Property of	





# CITY OF NEW BEDFORD MASSACHUSETTS

DEPARTMENT OF PUBLIC WORKS  
ENGINEERING DIVISION  
133 WILLIAM STREET, ROOM 303  
NEW BEDFORD, MA 02740

Tel: (508) 979-1527

Fax: (508) 961-3043

September 14, 2001

Attn: Mark A. Smith, Trs.  
P.O. Box 622  
Stoughton, MA 02072

Re: Rowe Street Sewer Extensions Project Area—Properties for Which Sewer Services Have  
Been Approved and Are Available for Connection

This letter serves as notification to you that the following property may now connect to the sewer system:

Owner(s):	Rockdale Nominee Realty Trust
Location:	1173 Rockdale Ave.
Plot/Lot:	74/183
Service Pipe Length Installed:	22'
Total Cost of Service Line:	\$323.40

323.40  
150.00  
\$473.40

In addition to the cost of the service line provided for the property, which the property owner must reimburse the City for when ready to connect to the sewer system, there is also a "Sewer Permit" fee of \$150.00. Once ready to connect to the sewer system, the property owner must come to City Hall, D.P.W. Engineering office, Room 303, to obtain said permit, at which time both of these amounts are due to the City. If someone other than the property owner is going to obtain the permit, this person must have a signed permission slip from the property owner allowing the entity to sign on behalf of the property owner. Also, if the property owner is abandoning a septic system, they must make arrangements with the Health Department at (508) 991-6275.

The City has brought the sewer service pipe to your property line. The property owner is responsible for making the provisions for any work required and costs incurred on their property. Property owners should make sure that the contractor they hire knows that, although they are working on private property, the D.P.W. Waste Water Division, and possibly other City officials, must inspect all work done before the sewer trench is backfilled.

Should you have any questions or need additional information, please feel free to contact Ana Rosa or Mario Gomes in the Engineering Department at (508) 979-1527.

Sincerely,

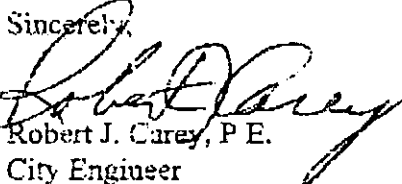
  
Robert J. Carey, P.E.  
City Engineer

RJC/asr



CITY OF NEW BEDFORD  
MASSACHUSETTS

DEPT. OF PUBLIC WORKS

133 WILLIAM STREET

LAWRENCE D. WORDEN  
COMMISSIONER

To Whom It May Concern:

I, ROCKDALE NOMINEE REALTY TRUST, being  
Name (Print) Mailing Address

owner of property located at ROCKDALE AVE.

Plot 74, Lot 183 & 9, hereby agree to allow ROBERT BOCHMAN  
Name

53 WILBUR AVE. DARTMOUTH, MA, 02747 to act on my behalf,  
Mailing Address

including affixing my signature, in securing permits for:

☒ Sewer/Drain Service Permits  
☒ Water Service Permits  
☒ Driveway Installation Permits  
☐ Sidewalk Installation Permits

I further agree to conform to, and abide by, all City rules and regulations applicable to the permits(s) being applied for.

Name Mark A. Smith MARK A. SMITH  
(signature) TRUSTEE  
P.O. Box 622  
Address  
STOUGHTON, MA, 02072  
Date