

PERMIT NO.
23140



CITY OF NEW BEDFORD
SEWER AND/OR STORM DRAIN PERMIT

DATE 11/5/01
EXP 11/5/02

This certifies that permission is granted to

Property Owner John M. Amorale; Frank W. Wolden 40 New Plainville Rd. NB MA 02745
Address (E.S.) 540 N. Plainville Rd. #32-40 Tel. (508) 995-6619

to connect a sewer and/or storm drain located at New Plainville Rd. Assessor's Plot 125, Lot 75, to the sewer and/or storm drain in New Plainville Rd. Street 11/5

to be laid in accordance with the conditions in this application and the City of New Bedford ordinances
TYPE OF USE: ☒ RESIDENTIAL ☐ COMMERICAL ☐ INDUSTRIAL ☐ OTHER
DEPT. OF PUBLIC WORKS
NEW BEDFORD, MASS
2 Credits, Each

If applicant other than actual property owner, attach Letter of Authorization from Property Owner.

Name Scott Franklin Co Franklin Bros., Inc. Tel. (508) 998-8270
Mailing Address 4393 Acushnet Ave. NB MA 02745

The Bonded Contractor/Drain Layer authorized to perform this work is:
Name Franklin Bros., Inc. Address 4393 Acushnet Ave. New Bedford MA 02745 Tel. (508) 998-8270

Type of Pipe Required: PVC 35 on Private Prop. #
PERMIT EXPIRES ONE YEAR AFTER DATE OF ISSUE 6" Ductile Iron Pipe in Road due to being shallow - tying in at 25' MH

- * Requires separate connections for sewage and storm drain where applicable. Storm water cannot be discharged to a sanitary sewer.
- * All work must be inspected and approved by a D.P.W. inspector before backfilling.
- * If this connection is to be part of a private service shared jointly with other building owners, attach copy of Recorded Joint Maintenance Agreement.
- * Permits can be issued to Industrial and/or Commercial Applicants only upon receipt and approval by the Commissioner of Public Works of required plans and supplemental information.
- * In addition, a City-issued Industrial User Discharge Permit and/or a Sewer Extension/Connection Permit issued by the Commonwealth of Massachusetts D.E.P. shall be required by the City for Industrial Discharge into the sewer system.

Industrial User Discharge Permit No. --- Date ---
Comm. Mass. Sewer Conn./Ext. Permit No. --- Date ---

A Filing and Inspection Fee of \$ 150.00, plus an Entrance Fee of \$ --- where applicable, must accompany this application.

Bank # First Fed. Check # 194 Date: 11/5/01 Receipt # 4162

Other requirements: Inspection Only - Connecting to 8" sewer main as per Ken Lohr's (C.W. Joint) specs and sheets provided to applicant by Mr. Lohr. Applicant must contact Matt Sp. regarding Septic System abandonment procedures.

Flowable fill ☒ Sewer ☐ Storm Drain
Connection made to Part of jointly-shared private line ☐ Yes ☒ No

Two septic systems being abandoned.
Applicant agrees to abide by the above terms, as well as all pertinent ordinances of other special rules as the Commissioner of Public Works may deem necessary

FOR INSPECTION ONLY, A 24 HOUR NOTICE IS REQUIRED AND THE CONTRACTOR/APPLICANT IS REQUIRED TO NOTIFY THE WASTEWATER DIVISION AT 991-6158

Lawrence R. Wolden/Asst.
Commissioner of Public Works

Scott - K.L.
Signature of Property Owner or Representative

INSPECTOR'S REPORT

INSPECTED BY: JOSEPH MARTIN
DATE: 11/9/01
COMMENTS:

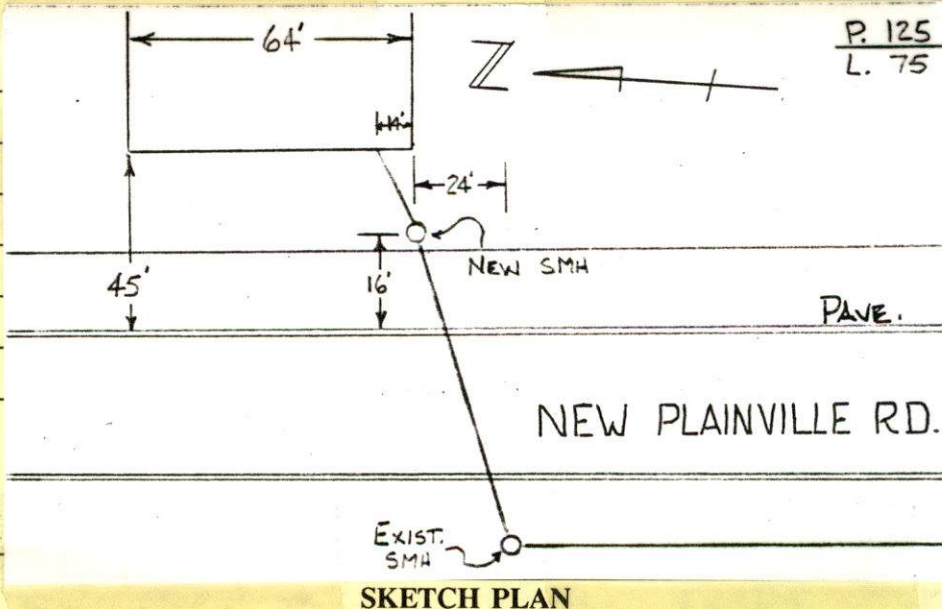

☒ APPROVED ☐ DISAPPROVED

Joseph Martin
SIGNATURE

PERMIT NO.

23140



CITY OF NEW BEDFORD

SEWER AND/OR STORM DRAIN PERMIT

DATE 11/15/01

EXP 11/15/02

This certifies that permission is granted to

John M. Amoral; Frank W. MacLadd 40 New Plainville Rd. NB MA 02745
Property Owner Address Tel. (508) 995-6649

to connect a sewer and/or storm drain located at New Plainville Rd. #38-40

Assessor's Plot 125, Lot 75, to the sewer and/or storm drain in New Plainville Rd. Street

to be laid in accordance with the conditions in this application and the City of New Bedford ordinances.

TYPE OF USE: ☒ RESIDENTIAL ☐ COMMERICAL ☐ INDUSTRIAL ☐ OTHER

4 Units = 880 GPD
2 Bdrms. Each

If applicant other than actual property owner, attach Letter of Authorization from Property Owner.

Name Scott Franklin of Franklin Bros., Inc. Tel. (508) 998-8270

Mailing Address 4393 Acushnet Ave. NB MA 02745

The Bonded Contractor/Drain Layer authorized to perform this work is:

Franklin Bros., Inc. 4393 Acushnet Ave. New Bedford MA 02745
Name Address Tel. (508) 998-8270

Type of Pipe Required: PVC SDR 35 on Private Prop. \$

PERMIT EXPIRES ONE YEAR AFTER DATE OF ISSUE

6" Ductile Iron Pipe in Road due to being shallow - lying in at DEMH

* Requires separate connections for sewage and storm drain where applicable. Storm water cannot be discharged to a sanitary sewer.

* All work must be inspected and approved by a D.P.W. inspector before backfilling.

* If this connection is to be part of a private service shared jointly with other building owners, attach copy of Recorded Joint Maintenance Agreement.

* Permits can be issued to Industrial and/or Commercial Applicants only upon receipt and approval by the Commissioner of Public Works of required plans and supplemental information.

* In addition, a City-issued Industrial User Discharge Permit and/or a Sewer Extension/Connection Permit issued by the Commonwealth of Massachusetts D.E.P. shall be required by the City for Industrial Discharge into the sewer system.

Industrial User Discharge Permit No. _____ Date _____

Comm. Mass. Sewer Conn./Ext. Permit No. _____ Date _____

A Filing and Inspection Fee of \$ 150.00, plus an Entrance Fee of \$ _____ where applicable, must accompany this application.

Bank # First Fed. Check # 194 Date: 11/15/01 Receipt # 4162

Other requirements: Inspection Only - Connecting to 8" sewer main as per Roy Labelle's

(C.W. Supt.) spec. and sketch provided to applicant by Mr. Labelle. Applicant must contact Health Dept. regarding septic system abandonment procedures.

Flowable fill

Connection made to

☐ Storm Drain

Part of jointly-shared private line ☐ Yes ☒ No

FOR INSPECTION ONLY, A 24 HOUR NOTICE IS REQUIRED AND THE CONTRACTOR/APPLICANT IS REQUIRED TO NOTIFY THE WASTEWATER DIVISION AT 991-6158

Two septic systems being abandoned.

Applicant agrees to abide by the above terms, as well as all pertinent ordinances of other special rules as the Commissioner of Public Works may deem necessary

Lawrence D. Wolden / asr
Commissioner of Public Works

Scott Franklin
Signature of Property Owner or Representative

INSPECTOR'S REPORT

INSPECTED BY: _____

DATE: _____

COMMENTS: _____

☐ APPROVED

☐ DISAPPROVED

SIGNATURE

SKETCH PLAN

October 18, 2001

To Whom It May Concern:

Please be advised that I, John M Amaral/38 & 40 New Plainville Rd/New Bedford, Ma 02745, hereby give the City of New Bedford Water/Sewer Dept, permission to issue the sewer permit to Mr. Scott Franklin, on my behalf.

Sincerely

John M. Amaral

FRANKLIN BROS
will pay for
THE PERMIT +
Permission slip.

00

RIM SMH ASSUMED 100.00

101.18
- 45.35
55.83



EXIST. SMH

INV 95.35

21'

8" Pipe

PLAINVILLE RD.

98.36

99.24

98.36

Per South
or Private
Property

OPTION #1

OPTION #2

6" DUCTILE IRON
55'±

Flowable fill & Willow-in roadway.
Bring from SMH to SMH
per South to another

7' SILL 101.18

#38

DIST. FROM SMH TO
SWC OF BLDG = 95.5'

EXIST. 8" SERVICE
FOR "WILLOWS"



**CITY OF NEW BEDFORD
MASSACHUSETTS**

DEPT. OF PUBLIC WORKS

133 WILLIAM STREET

LAWRENCE D. WORDEN
COMMISSIONER

April 12, 2001

Frank Machado
38 New Plainville Road
New Bedford, MA 02745

Dear Mr. Machado:

After taking elevation readings, there appear to be two options for you to get into the sewer system. As shown on the attached sketch, Option 1 is connecting to an existing manhole across Plainville Road. However, due to the lack of ground cover to protect the pipe, ductile iron pipe would have to be used for the portion under the road. A bonded contractor would have to be hired by you to install this service.

Option 2 would involve contacting the owners of "The Willows" and inquire about connecting into their existing sewer service which runs along the West side of their buildings. This may involve a fee, however, it could be offset because it is a much shorter run of pipe.

If you have any questions, please do not hesitate to contact me at (508) 991-6158.

Sincerely,

Ronald H. Labelle
Superintendent
Wastewater Division

Attachment

cc: Lawrence D. Worden,
Commissioner, DPW

Denis Farias,
Councillor Ward One

8:45 AM with Scott
FRANKLIN -
@ this location.

10/19/01 - Left morning
for ^{2:05 p.m.} John Aronson - told him
spoke w/ Scott Franklin
on 10/18 and was to come
in today, but that all under
control.

10/24/01 - Awaiting utility co.
to do work w/in next 2
weeks - will be back for it

NOTES 10/18/01 8:50 - left mess. on mr.

Amorals machine that per Ron, has to provide us w/ copy of sketch of how will connect to sewer and we can issue him permit.

10/18/01 - Late p.m. Scott Forsman - called - said has sketches & letters. Ron said had grades shot and there was a sketch done for the guy. Scott to come in on 10/19 and bring permission slips along

PHONE CALL

FOR File DATE 10/17/01 TIME AM

M Re: John M. Amoral

OF 38-40 New Plainville Rd 4 unit

PHONE apt. - Ron supposedly sent sketch to guys
AREA CODE who gave to Scott Franklin, and Scott can't find
NUMBER Finally spoke w/Ron - said all
EXTENSION found.

MESSAGE guy has to do is bring sketch of how will be
tied into sewer. All Ron gave him was a
sketch of what is in the street layout.

SIGNED nothing specific.

PHONED

RETURNED
YOUR CALL

PLEASE CALL

WILL CALL
AGAIN

CAME TO
SEE YOU

WANTS TO
SEE YOU

Universal 48003

10/16/01
Need to call .

Mr. Asanov after
speak w/ Ross +
verify that there
must only special
conditions which
need to be listed - his
nextel went out when
I last spoke w/ him
IT IN Ross all day - no luck!