

PERMIT NO.
23139



CITY OF NEW BEDFORD
SEWER AND/OR STORM DRAIN PERMIT

DATE 10/19/01
EXP 10/19/02

This certifies that permission is granted to

Paul F. & Patricia A. Pate 1391 Rockdale Ave. NBMA 02740
Property Owner Address Tel. (508) 990-8369

to connect a sewer and/or storm drain located at Rockdale Ave. #1391
Assessor's Plot 80, Lot 57, to the sewer and/or storm drain in LEMOS Street
to be laid in accordance with the conditions in this application and the City of New Bedford ordinances.

TYPE OF USE: ☒ RESIDENTIAL ☐ COMMERICAL ☐ INDUSTRIAL ☐ OTHER

If applicant other than actual property owner, attach Letter of Authorization from Property Owner.

Name N/A Tel.

Mailing Address

RECEIVED
NOV 16 2001
DEPT. OF PUBLIC WORKS
NEW BEDFORD, MASS.

The ~~Bonded~~ Contractor/Drain Layer authorized to perform this work is: Stub at Prop. Line
Jose L. Pina Robert J. Davis 3B Woodhill St. S. Dartmouth MA 02748
Name Address Tel. (508) 994-7768

Type of Pipe Required: PVC SDR 35

PERMIT EXPIRES ONE YEAR AFTER DATE OF ISSUE

- * Requires separate connections for sewage and storm drain where applicable. Storm water cannot be discharged to a sanitary sewer.
- * All work must be inspected and approved by a D.P.W. inspector before backfilling.
- * If this connection is to be part of a private service shared jointly with other building owners, attach copy of Recorded Joint Maintenance Agreement.
- * Permits can be issued to Industrial and/or Commercial Applicants only upon receipt and approval by the Commissioner of Public Works of required plans and supplemental information.
- * In addition, a City-issued Industrial User Discharge Permit and/or a Sewer Extension/Connection Permit issued by the Commonwealth of Massachusetts D.E.P. shall be required by the City for Industrial Discharge into the sewer system.

Industrial User Discharge Permit No. Date

Comm. Mass. Sewer Conn./Ext. Permit No. Date

A Filing and Inspection Fee of \$ 150.00 plus an Entrance Fee of \$ 294.00 where applicable, must accompany this application.

Bank # Flat Check # 367 Date: 10/19/01 Receipt # 4157

Other requirements: Inspection Only - Rock St. Sewer Proj. Stub FL = 30' x 14.701 ft

\$294.00 plus Permit Fee = \$150.00 Total: \$444.00

must attach letter from Dist. re: septic system abatement.

Connection made to ☒ Sewer ☐ Storm Drain
Part of jointly-shared private line ☐ Yes ☒ No

FOR INSPECTION ONLY, A 24 HOUR
NOTICE IS REQUIRED AND THE
CONTRACTOR/APPLICANT IS
REQUIRED TO NOTIFY THE
WASTEWATER DIVISION AT 991-6158

Applicant agrees to abide by the above terms, as well as all pertinent ordinances of the City of New Bedford, and such other special rules as the Commissioner of Public Works may deem necessary

Lawrence D. Woburn 1001
Commissioner of Public Works

Joseph Martin
Signature of Property Owner or Representative

INSPECTED BY: JOSEPH MARTIN

DATE: 10/17/01

COMMENTS: Stub installed during
Rock St. Sewer project and
inspected by CDW.

☒ APPROVED ☐ DISAPPROVED

Joseph Martin
SIGNATURE

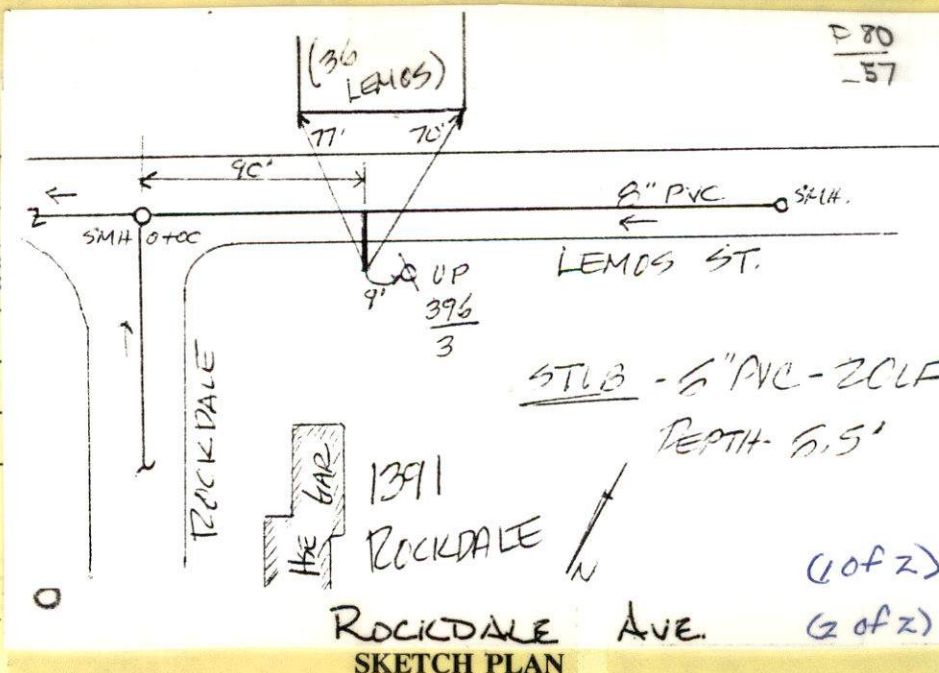

PERMIT NO.

23139



CITY OF NEW BEDFORD

SEWER AND/OR STORM DRAIN PERMIT

DATE 10/19/01
EXP 10/19/02

This certifies that permission is granted to

Paul F. & Pamela A. Ponte 1391 Rockdale Ave NBBMA 02740
Property Owner Address Tel. (508) 990-8369

to connect a sewer and/or storm drain located at Rockdale Ave. #1391
Assessor's Plot 80, Lot 57, to the sewer and/or storm drain in Lemos Street
to be laid in accordance with the conditions in this application and the City of New Bedford ordinances.

TYPE OF USE: ☒ RESIDENTIAL ☐ COMMERICAL ☐ INDUSTRIAL ☐ OTHER

330 GPD

If applicant other than actual property owner, attach Letter of Authorization from Property Owner.

Name N/A Tel. _____

Mailing Address _____

The ~~Bonded~~ Contractor/Drain Layer authorized to perform this work is: Stub at Prop. Line

Jose Braga Robert Services 32 Woodhill St. S. Dartmouth MA 02748
Name Address Tel. (508) 994-7968

Type of Pipe Required: PVC SDR 35

PERMIT EXPIRES ONE YEAR AFTER DATE OF ISSUE

- * Requires separate connections for sewage and storm drain where applicable. Storm water cannot be discharged to a sanitary sewer.
- * All work must be inspected and approved by a D.P.W. inspector before backfilling.
- * If this connection is to be part of a private service shared jointly with other building owners, attach copy of Recorded Joint Maintenance Agreement.
- * Permits can be issued to Industrial and/or Commercial Applicants only upon receipt and approval by the Commissioner of Public Works of required plans and supplemental information.
- * In addition, a City-issued Industrial User Discharge Permit and/or a Sewer Extension/Connection Permit issued by the Commonwealth of Massachusetts D.E.P. shall be required by the City for Industrial Discharge into the sewer system.

Industrial User Discharge Permit No. _____ Date _____

Comm. Mass. Sewer Conn./Ext. Permit No. _____ Date _____

A Filing and Inspection Fee of \$ 150.00 plus an Entrance Fee of \$ 294.00 where applicable, must accompany this application.

Bank # Flat Check # 367 Date: 10/19/01 Receipt # 4157

Other requirements: Inspection Only - ROW, St Sewer Proj. Stub Fee = 20' x \$14.70/ft

\$294.00, plus Permit Fee = \$150.00 Total: \$444.00

must contact Health Dept Re: septic system abandonment.

Connection made to ☒ Sewer ☐ Storm Drain
Part of jointly-shared private line ☐ Yes ☒ No

FOR INSPECTION ONLY, A 24 HOUR
NOTICE IS REQUIRED AND THE
CONTRACTOR/APPLICANT IS
REQUIRED TO NOTIFY THE
WASTEWATER DIVISION AT 991-615

Applicant agrees to abide by the above terms, as well as all pertinent ordinances of the City of New Bedford, and such other special rules as the Commissioner of Public Works may deem necessary

Lawrence D. Worden 1002
Commissioner of Public Works

Paul F. Ponte
Signature of Property Owner or Representative

INSPECTOR'S REPORT

INSPECTED BY: _____

DATE: _____

COMMENTS: _____

☐ APPROVED ☐ DISAPPROVED

SIGNATURE

SKETCH PLAN