

PERMIT NO.
23128



CITY OF NEW BEDFORD

DATE 8-30-01

SEWER AND/OR STORM DRAIN PERMIT

This certifies that permission is granted to

~~Jorge H. Verissimo~~ JORGE H. VERISSIMO - 106 WILLIAM ST. SO. DARTMOUTH MA. 02748
Property Owner Address #285 Tel. 508-999-1684 -

to connect a sewer and/or storm drain located at WILBUR ST (NS) 590± W/ROCKDALE AVE.

Assessor's Plot 80, Lot 19, to the sewer and/or storm drain in WILBUR ST Street

to be laid in accordance with the conditions in this application and the City of New Bedford ordinances.

TYPE OF USE: ☒ RESIDENTIAL ☐ COMMERICAL ☐ INDUSTRIAL ☐ OTHER

If applicant other than actual property owner, attach Letter of Authorization from Property Owner.

RECEIVED

JAN 16 2002

DEPT. OF PUBLIC WORKS
NEW BEDFORD, MASS

Name Tel.

Mailing Address

The Bonded Contractor/Drain Layer authorized to perform this work is:

JOSE BRAGA BOBCAT. 508-994-7968.
Name Address Tel.

Type of Pipe Required: PVC. 1 1/2" FORCE MAIN

PERMIT EXPIRES ONE YEAR AFTER DATE OF ISSUE

- * Requires separate connections for sewage and storm drain where applicable. Storm water cannot be discharged to a sanitary sewer.
- * All work must be inspected and approved by a D.P.W. inspector before backfilling.
- * If this connection is to be part of a private service shared jointly with other building owners, attach copy of Recorded Joint Maintenance Agreement.
- * Permits can be issued to Industrial and/or Commercial Applicants only upon receipt and approval by the Commissioner of Public Works of required plans and supplemental information.
- * In addition, a City-issued Industrial User Discharge Permit and/or a Sewer Extension/Connection Permit issued by the Commonwealth of Massachusetts D.E.P. shall be required by the City for Industrial Discharge into the sewer system.

Industrial User Discharge Permit No. Date

Comm. Mass. Sewer Conn./Ext. Permit No. Date

A Filing and Inspection Fee of \$150.00, plus an Entrance Fee of \$ where applicable, must accompany this application.

Bank # FLEET BANK Check # 224 Date: 8-30-01 Receipt # 4127

Other requirements: INSP ONLY - TO BE CONNECTED FROM

PROPERTY LINE TO A SEWER MH. BY FORCE MAIN 1 1/2"

☒ Sewer

Connection made to Part of jointly-shared private line ☐ Yes ☒ No

☐ Storm Drain

Applicant agrees to abide by the above terms, as well as all pertinent ordinances of the City of New Bedford, and such other special rules as the Commissioner of Public Works may deem necessary

Lawrence J. Worden inf.
Commissioner of Public Works

Jorge Verissimo
Signature of Property Owner or Representative

INSPECTOR'S REPORT

INSPECTED BY: JOSEPH MARTIN

DATE: 10/3/01

COMMENTS:

☒ APPROVED ☐ DISAPPROVED

SIGNATURE

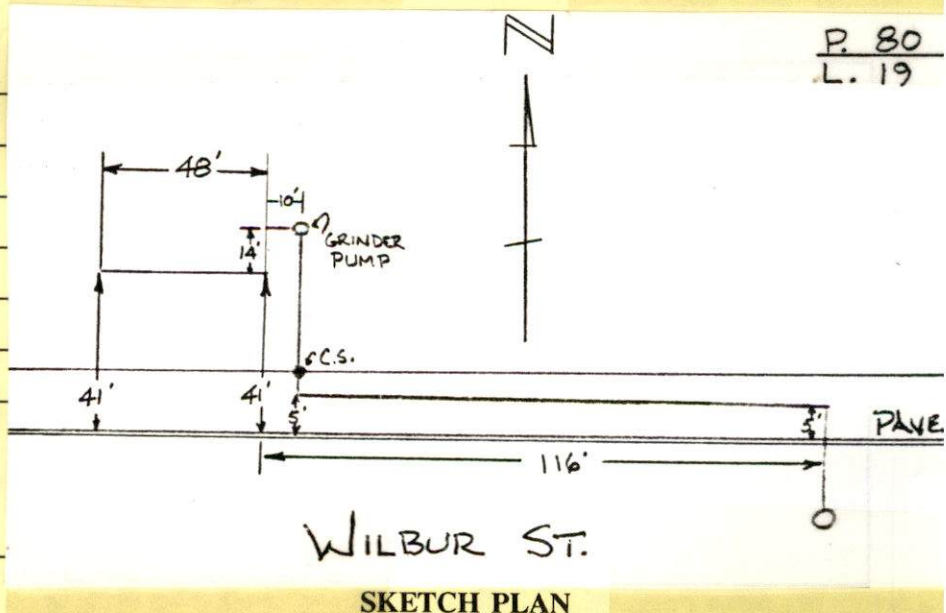

PERMIT NO:
23128



CITY OF NEW BEDFORD

DATE...8-30-01

SEWER AND/OR STORM DRAIN PERMIT

This certifies that permission is granted to

~~XXXXXXXXXX~~ JORGE H VERISSIMO - 106 WILLIAM ST. SO. DARTMOUTH MA. 02748
Property Owner Address #285 Tel. 508-999-1684 -

to connect a sewer and/or storm drain located at... WILBUR ST (NS) 590'± W/ROCKDALE AVE.
Assessor's Plot... 80..., Lot... 19..., to the sewer and/or storm drain in... WILBUR ST... Street

to be laid in accordance with the conditions in this application and the City of New Bedford ordinances.

TYPE OF USE: ☒ RESIDENTIAL ☐ COMMERICAL ☐ INDUSTRIAL ☐ OTHER

If applicant other than actual property owner, attach Letter of Authorization from Property Owner.

Name..... Tel.....

Mailing Address.....

The Bonded Contractor/Drain Layer authorized to perform this work is:

JOSE BRAGA BOBCAT. 508-994-7968.
Name Address Tel.

Type of Pipe Required: PVC. 1 1/2" FORCE MAIN -

PERMIT EXPIRES ONE YEAR AFTER DATE OF ISSUE

- * Requires separate connections for sewage and storm drain where applicable. Storm water cannot be discharged to a sanitary sewer.
- * All work must be inspected and approved by a D.P.W. inspector before backfilling.
- * If this connection is to be part of a private service shared jointly with other building owners, attach copy of Recorded Joint Maintenance Agreement.
- * Permits can be issued to Industrial and/or Commercial Applicants only upon receipt and approval by the Commissioner of Public Works of required plans and supplemental information.
- * In addition, a City-issued Industrial User Discharge Permit and/or a Sewer Extension/Connection Permit issued by the Commonwealth of Massachusetts D.E.P. shall be required by the City for Industrial Discharge into the sewer system.

Industrial User Discharge Permit No..... Date.....

Comm. Mass. Sewer Conn./Ext. Permit No..... Date.....

A Filing and Inspection Fee of \$150.00, plus an Entrance Fee of \$... where applicable, must accompany this application.

Bank # FLEET BANK Check # 224 Date: 8-30-01 Receipt # 4127

Other requirements: INSP ONLY TO BE CONNECTED FROM
PROPERTY LINE TO A SEWER MH BY FORCE MAIN 1 1/2"

FOR INSPECTION ONLY, A 24 HOUR
NOTICE IS REQUIRED AND THE
CONTRACTOR/APPLICANT IS
REQUIRED TO NOTIFY THE
WASTEWATER DIVISION AT 991-6158

Connection made to ☒ Sewer ☐ Storm Drain
Part of jointly-shared private line ☐ Yes ☒ No

Applicant agrees to abide by the above terms, as well as all pertinent ordinances of the City of New Bedford, and such other special rules as the Commissioner of Public Works may deem necessary

Lawrence J. Worden inf.
Commissioner of Public Works

Jorge Verissimo
Signature of Property Owner or Representative

INSPECTOR'S REPORT

INSPECTED BY: _____

DATE: _____

COMMENTS: _____

☐ APPROVED ☐ DISAPPROVED

SIGNATURE

SKETCH PLAN

QUITCLAIM DEED

KNOW ALL MEN BY THESE PRESENTS

That WE, KEVIN G. CHAMPAGNE and MICHEALA J. CHAMPAGNE, husband and wife,

of New Bedford,

Bristol County, Massachusetts

being married, for consideration paid, and in full consideration of FORTY THOUSAND AND NO/100 (\$40,000.00) DOLLARS

grant to JORGE H. VERISSIMO

of 106 William Street, South Dartmouth, MA

with *quitclaim covenants*

the land, in New Bedford, Bristol County, Massachusetts, being shown as Lot #6 on Plan of Property of Frances R. Vitorino, New Bedford, Mass., December 30, 1940, and filed in Bristol County (S.D.) Registry of Deeds in Plan Book 35, Page 14.

SUBJECT to a right-of-way reserved to Frank J. Lemos to pass and repass over and upon the westerly side of Lot #6 on said plan extending from the southwesterly corner of first lot described in deed dated June 7, 1926 to Frank Lemos, as set forth in a deed dated September 6, 1944, and recorded in said Registry of Deeds in Book 883, Page 24.

FOR OUR TITLE, see deed from Ivy M. Abrams to these grantors dated November 8, 1983, recorded in said Registry of Deeds in Book 1877, Page 590.

SUBJECT to the real estate taxes for fiscal year 2001 which the grantee herein agrees and assumes to pay.

Witness our hands and seals this 29th day of May, 2001.

Executed in the presence of:

Sheldon Friedland, Notary
1 Hall Ave, New Bedford

Kevin G. Champagne
 KEVIN G. CHAMPAGNE
Micheala J. Champagne
 MICHEALA J. CHAMPAGNE

The Commonwealth of Massachusetts

Bristol, ss.

New Bedford

May 29, 2001

Then personally appeared the above-named Kevin G. Champagne and Micheala J. Champagne and acknowledged the foregoing instrument to be their free act and deed, before me

Sheldon Friedland
 Sheldon Friedland, Notary Public
 My Commission Expires: 9/6/2002

REG OF DEEDS
 REG #07
 BRISTOL S

05/29/01 2:51PM
 000000 #8199

FEE \$182.40

CASH \$182.40

