

PERMIT NO.
23122



CITY OF NEW BEDFORD
SEWER AND/OR STORM DRAIN PERMIT

DATE 9/10/01
EXP 9/10/02

This certifies that permission is granted to John F. Long
Long Realty, Inc. 158 W. Campbell St. N. 02745 (508) 795-8240
Property Owner Address # 986 Tel. 145 141 E. Adams Street

to connect a sewer and/or storm drain located at Bessy St. (S.S.) Street
Assessor's Plot 134, Lot 407, to the sewer and/or storm drain in Bessy St.

to be laid in accordance with the conditions in this application and the City of New Bedford ordinances.

TYPE OF USE: ☒ RESIDENTIAL ☐ COMMERICAL ☐ INDUSTRIAL ☐ OTHER 3306P1

If applicant other than actual property owner, attach Letter of Authorization from Property Owner.

Name John F. Long Tel. (508) 795-8240 X-14

Mailing Address 30 W. Adams

The Bonded Contractor/Drain Layer authorized to perform this work is: Stub at R.

Name Long Construction Address (508) 795-8240 Tel. (508) 795-8240

Type of Pipe Required: PVC SDR 35

PERMIT EXPIRES ONE YEAR AFTER DATE OF ISSUE

RECEIVED

JAN 16 2002

DEPT. OF PUBLIC WORKS
NEW BEDFORD, MASS.

- * Requires separate connections for sewage and storm drain where applicable. Storm water cannot be discharged to a sanitary sewer.
- * All work must be inspected and approved by a D.P.W. inspector before backfilling.
- * If this connection is to be part of a private service shared jointly with other building owners, attach copy of Recorded Joint Maintenance Agreement.
- * Permits can be issued to Industrial and/or Commercial Applicants only upon receipt and approval by the Commissioner of Public Works of required plans and supplemental information.
- * In addition, a City-issued Industrial User Discharge Permit and/or a Sewer Extension/Connection Permit issued by the Commonwealth of Massachusetts D.E.P. shall be required by the City for Industrial Discharge into the sewer system.

Industrial User Discharge Permit No. _____ Date _____

Comm. Mass. Sewer Conn./Ext. Permit No. _____ Date _____

A Filing and Inspection Fee of \$ 150.00 plus an Entrance Fee of \$ _____ where applicable, must accompany this application.

* Bank # Compass Bank Check # 22972 Date: 7/10/01 Receipt # 4136

* Other requirements: Inspection Only - Connecting to Stub at R - Stub not in
building during Bessy St. Sewer Extension

Connection made to ☒ Sewer ☐ Storm Drain
Part of jointly-shared private line ☐ Yes ☒ No

FOR INSPECTION ONLY, A 24 HOUR
NOTICE IS REQUIRED AND THE
CONTRACTOR/APPLICANT IS
REQUIRED TO NOTIFY THE
WASTEWATER DIVISION AT 291-6158

Applicant agrees to abide by the above terms, as well as all pertinent ordinances of the City of New Bedford, and such other special rules as the Commissioner of Public Works may deem necessary

Laurence D. McNamee
Commissioner of Public Works

John F. Long
Signature of Property Owner or Representative

INSPECTOR'S REPORT

INSPECTED BY: JOSEPH MARTIN

DATE: 11/27/01

COMMENTS: Stub from main to R
put in as part of Bessy St.
sewer main extension done under
separate sewer permit.

☒ APPROVED ☐ DISAPPROVED

Joseph Martin
SIGNATURE

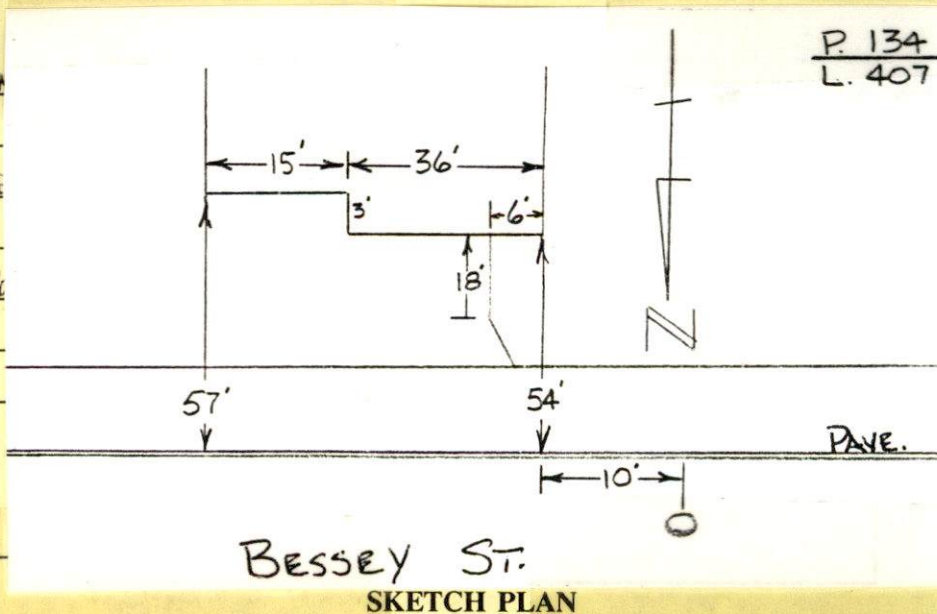

PERMIT NO.
23122



CITY OF NEW BEDFORD

DATE... 9/10/01
EXP 9/10/02

SEWER AND/OR STORM DRAIN PERMIT

This certifies that permission is granted to John F. Long
Long Realty, Inc. 158 McCombs Blvd. NIS MA 02745 (508) 995-8240
Property Owner Address #986 Tel. 145 1st E. Acushnet Ave.

to connect a sewer and/or storm drain located at Bassett St. (S.S.)
Assessor's Plot 134, Lot 407 to the sewer and/or storm drain in Bassett Street
(Builder's Lot 1)

to be laid in accordance with the conditions in this application and the City of New Bedford ordinances.

TYPE OF USE: ☒ RESIDENTIAL ☐ COMMERCIAL ☐ INDUSTRIAL ☐ OTHER 3306PI

If applicant other than actual property owner, attach Letter of Authorization from Property Owner.

Name Jim Buckles of Long Smith Homes Inc. Tel. (508) 995-8240 X-14

Mailing Address same as owners

The Bonded Contractor/Drain Layer authorized to perform this work is: Stub at IR.

Will call us. Needs to submit plan/sketch showing if stub at IR.
Name Long Built Homes Address (508) 995-8240 Tel.

Type of Pipe Required: PVC SDR 35

PERMIT EXPIRES ONE YEAR AFTER DATE OF ISSUE

- * Requires separate connections for sewage and storm drain where applicable. Storm water cannot be discharged to a sanitary sewer.
- * All work must be inspected and approved by a D.P.W. inspector before backfilling.
- * If this connection is to be part of a private service shared jointly with other building owners, attach copy of Recorded Joint Maintenance Agreement.
- * Permits can be issued to Industrial and/or Commercial Applicants only upon receipt and approval by the Commissioner of Public Works of required plans and supplemental information.
- * In addition, a City-issued Industrial User Discharge Permit and/or a Sewer Extension/Connection Permit issued by the Commonwealth of Massachusetts D.E.P. shall be required by the City for Industrial Discharge into the sewer system.

Industrial User Discharge Permit No. Date

Comm. Mass. Sewer Conn./Ext. Permit No. Date

A Filing and Inspection Fee of \$ 150.00 plus an Entrance Fee of \$ where applicable, must accompany this application.

* Bank # Compass Bank Check # 22972 Date: 9/10/01 Receipt # 4136
* Other requirements: Inspection Only - Connecting to stub at IR - stub put in by
builder during Bassett St. Sewer Extension

Connection made to ☒ Sewer ☐ Storm Drain
Part of jointly-shared private line ☐ Yes ☒ No

FOR INSPECTION ONLY, A 24 HOUR
NOTICE IS REQUIRED AND THE
CONTRACTOR/APPLICANT IS
REQUIRED TO NOTIFY THE
WASTEWATER DIVISION AT 991-6158

Applicant agrees to abide by the above terms, as well as all pertinent ordinances of the City of New Bedford, and such other special rules as the Commissioner of Public Works may deem necessary

Laurinda D. Worden/ase
Commissioner of Public Works

James M. Buckles
Signature of Property Owner or Representative

INSPECTOR'S REPORT

INSPECTED BY:

DATE:

COMMENTS:

☐ APPROVED ☐ DISAPPROVED

SIGNATURE

SKETCH PLAN



CITY OF NEW BEDFORD
MASSACHUSETTS

DEPT. OF PUBLIC WORKS

133 WILLIAM STREET

LAWRENCE D. WORDEN
COMMISSIONER

To Whom It May Concern:

I, Long Built Homes, being
Name Mailing Address
owner of property located at LOT 1, 2, 3, 4 Bessey St +
Lot 79 Randall
Plot _____, Lot _____, hereby agree to allow Jim Buckles
Name
158 Charles McCombs Blvd to act on my behalf,
Mailing Address
New Bedford, MA.
including affixing my signature, in securing permits for:

<input checked="" type="checkbox"/>	Sewer/Drain Service Permits
<input checked="" type="checkbox"/>	Water Service Permits
<input checked="" type="checkbox"/>	Driveway Installation Permits
<input checked="" type="checkbox"/>	Sidewalk Installation Permits

I further agree to confirm to, and abide by, all City rules and regulations applicable to the permits(s) being applied for.

Long Built Homes
Name Robert Long Pastore
Print
158 Charles McCombs Blvd
Address
N.B. MA 02745
Date

