

PERMIT NO.  
23113



CITY OF NEW BEDFORD

DATE 7/23/01  
DN 7/23/02

SEWER AND/OR STORM DRAIN PERMIT

This certifies that permission is granted to

Property Owner Public & Industrial Central Dist. H.C. Construction 24 West 11th St. Boston  
Address # 211 MT. VERNON ST. Tel. (617) 552-7183  
to connect a sewer and/or storm drain located at MT. Vernon St. (N.S.) 270' E. of Common St.  
Assessor's Plot 82, Lot 301, to the sewer and/or storm drain in Potter - Brown 11th St. 13 Street

to be laid in accordance with the conditions in this application and the City of New Bedford ordinances.

TYPE OF USE: ☒ RESIDENTIAL ☐ COMMERCIAL ☐ INDUSTRIAL ☐ OTHER

If applicant other than actual property owner, attach Letter of Authorization from Property Owner.

Name N/A Tel. 330642

Mailing Address —

The Bonded Contractor/Drain Layer authorized to perform this work is:

Name R.T. Conison 915 Mt Vernon Rd. N. MA Address — Tel. —

Type of Pipe Required: PVC 30" 35

PERMIT EXPIRES ONE YEAR AFTER DATE OF ISSUE

- \* Requires separate connections for sewage and storm drain where applicable. Storm water cannot be discharged to a sanitary sewer.
- \* All work must be inspected and approved by a D.P.W. inspector before backfilling.
- \* If this connection is to be part of a private service shared jointly with other building owners, attach copy of Recorded Joint Maintenance Agreement.
- \* Permits can be issued to Industrial and/or Commercial Applicants only upon receipt and approval by the Commissioner of Public Works of required plans and supplemental information.
- \* In addition, a City-issued Industrial User Discharge Permit and/or a Sewer Extension/Connection Permit issued by the Commonwealth of Massachusetts D.E.P. shall be required by the City for Industrial Discharge into the sewer system.

Industrial User Discharge Permit No. — Date —

Comm. Mass. Sewer Conn./Ext. Permit No. — Date —

A Filing and Inspection Fee of \$ 150, plus an Entrance Fee of \$ — where applicable, must accompany this application.

Bank # People's Savings Bank of Brockton Check # 4978 Date: 7/23/01 Receipt # 4091

Other requirements: Discharge City - Connection to 11" sewer on 13th St. as shown on Plan, Record 6/27/01 11:39 a.m. Boston - Brockton Conn. (Back 117/1883 Registry of Deeds Brockton Conn.)

Connection made to ☒ Sewer ☐ Storm Drain Part of jointly-shared private line ☐ Yes ☒ No

Applicant agrees to abide by the above terms, as well as all pertinent ordinances of the City of New Bedford, and such other special rules as the Commissioner of Public Works may deem necessary

Signature of Commissioner of Public Works Joseph M. ...

Signature of Property Owner or Representative —

FOR INSPECTION ONLY, A 24 HOUR NOTICE IS REQUIRED AND THE CONTRACTOR/APPLICANT IS REQUIRED TO NOTIFY THE WASTEWATER DIVISION AT 991-6158

INSPECTED BY: JOSEPH MARR

DATE: 10/19/01

COMMENTS:

☒ APPROVED ☐ DISAPPROVED

SIGNATURE Joseph M. ...

INSPECTOR'S REPORT

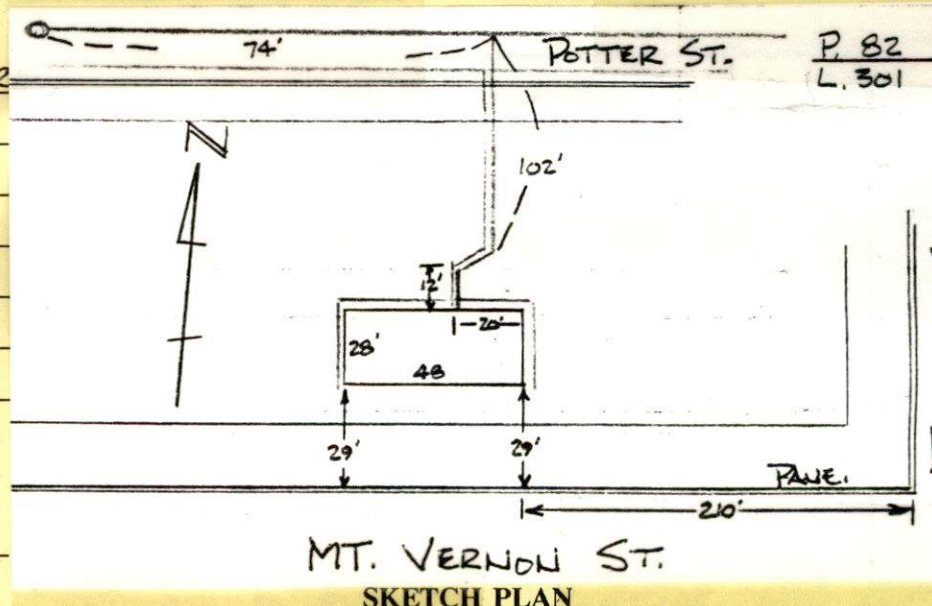



PERMIT NO.  
23113



CITY OF NEW BEDFORD  
SEWER AND/OR STORM DRAIN PERMIT

DATE 7/23/01  
EXP 7/23/02

MA 02743

This certifies that permission is granted to  
Paulo & Antonia Cabral d/b/a APC Construction 24 Restoration Rd Acushnet  
Property Owner Address Tel. (508) 985-9683  
to connect a sewer and/or storm drain located at Mt. Vernon St (N.S.) 270 W 1/2 E. / Canford St.  
Assessor's Plot 82, Lot 301, to the sewer and/or storm drain in Potter - Farm mt + mtr Lot 13 Street  
to be laid in accordance with the conditions in this application and the City of New Bedford ordinances.

TYPE OF USE: ☒ RESIDENTIAL ☐ COMMERICAL ☐ INDUSTRIAL ☐ OTHER 3306PD

If applicant other than actual property owner, attach Letter of Authorization from Property Owner.

Name N/A Tel. \_\_\_\_\_  
Mailing Address \_\_\_\_\_

The Bonded Contractor/Drain Layer authorized to perform this work is:  
RJ Conessa 915 Hawthorn Rd. N50MA 508-993-9508  
Name Address Tel.

Type of Pipe Required: PVC SDR 35  
PERMIT EXPIRES ONE YEAR AFTER DATE OF ISSUE

- \* Requires separate connections for sewage and storm drain where applicable. Storm water cannot be discharged to a sanitary sewer.
- \* All work must be inspected and approved by a D.P.W. inspector before backfilling.
- \* If this connection is to be part of a private service shared jointly with other building owners, attach copy of Recorded Joint Maintenance Agreement.
- \* Permits can be issued to Industrial and/or Commercial Applicants only upon receipt and approval by the Commissioner of Public Works of required plans and supplemental information.
- \* In addition, a City-issued Industrial User Discharge Permit and/or a Sewer Extension/Connection Permit issued by the Commonwealth of Massachusetts D.E.P. shall be required by the City for Industrial Discharge into the sewer system.

Industrial User Discharge Permit No. \_\_\_\_\_ Date \_\_\_\_\_  
Comm. Mass. Sewer Conn./Ext. Permit No. \_\_\_\_\_ Date \_\_\_\_\_

A Filing and Inspection Fee of \$ 150, plus an Entrance Fee of \$ \_\_\_\_\_ where applicable, must accompany this application.

Bank # People's Savings Bank of Brockton Check # 4978 Date: 7/23/01 Receipt # 4091

Other requirements: Inspection Only - Connecting to 10" sewer and 15" storm  
drain (S.D.) on Potter St through 15' utility easement on Lot 13. Potter St  
as shown on plan recorded 6/21/01 11:39 a.m. R of Deeds - Bristol County. (Book 147/Pg 83  
☒ Sewer ☒ Storm Drain  
Connection made to Part of jointly-shared private line ☐ Yes ☒ No  
Registry of Deeds  
Bristol County)

Applicant agrees to abide by the above terms, as well as all pertinent ordinances of the City of New Bedford, and such other special rules as the Commissioner of Public Works may deem necessary

Lawrence D. Worden Jr. \_\_\_\_\_  
Commissioner of Public Works Signature of Property Owner or Representative

FOR INSPECTION ONLY, A 24 HOUR  
NOTICE IS REQUIRED AND THE  
CONTRACTOR/APPLICANT IS  
REQUIRED TO NOTIFY THE  
WASTEWATER DIVISION AT 991-6158

INSPECTOR'S REPORT

INSPECTED BY: \_\_\_\_\_  
DATE: \_\_\_\_\_  
COMMENTS: \_\_\_\_\_  
\_\_\_\_\_  
\_\_\_\_\_  
\_\_\_\_\_  
☐ APPROVED ☐ DISAPPROVED

SIGNATURE

SKETCH PLAN



