

PERMIT NO.
23107



CITY OF NEW BEDFORD

DATE 7/13/2001

SEWER AND/OR STORM DRAIN PERMIT

RECEIVED

This certifies that permission is granted to

Manuel Rodrigues 77 Dartmouth St. New Bedford, MA 01901
Property Owner Address #107

SEP 17 2002

DEPT. OF PUBLIC WORKS
NEW BEDFORD, MASS.

to connect a sewer and/or storm drain located at Winterville Rd. (ns) 710'± W. Ridge St.
Assessor's Plot 26, Lot 247, to the sewer and/or storm drain in Winterville Rd. Street

RECEIVED

SEP 27 2001

DEPT. OF PUBLIC WORKS
NEW BEDFORD, MASS.

TYPE OF USE: ☒ RESIDENTIAL ☐ COMMERCIAL ☐ INDUSTRIAL ☐ OTHER

If applicant other than actual property owner, attach Letter of Authorization from Property Owner.

Name Jose Verissimo Tel. 508-965-6267

Mailing Address 20 Mosher St. So. Dartmouth, MA

The Bonded Contractor/Drain Layer authorized to perform this work is:

Jose Braga Bobcat Services 3 E. Woodell St. S. Dart. 508-994-7968
Name Address Tel.

Type of Pipe Required: PVC SDR-35

PERMIT EXPIRES ONE YEAR AFTER DATE OF ISSUE

- * Requires separate connections for sewage and storm drain where applicable. Storm water cannot be discharged to a sanitary sewer.
- * All work must be inspected and approved by a D.P.W. inspector before backfilling.
- * If this connection is to be part of a private service shared jointly with other building owners, attach copy of Recorded Joint Maintenance Agreement.
- * Permits can be issued to Industrial and/or Commercial Applicants only upon receipt and approval by the Commissioner of Public Works of required plans and supplemental information.
- * In addition, a City-issued Industrial User Discharge Permit and/or a Sewer Extension/Connection Permit issued by the Commonwealth of Massachusetts D.E.P. shall be required by the City for Industrial Discharge into the sewer system.

Industrial User Discharge Permit No. Date

Comm. Mass. Sewer Conn./Ext. Permit No. Date

A Filing and Inspection Fee of \$150.00, plus an Entrance Fee of \$ where applicable, must accompany this application.

Bank # Luza Community Bank Check # 003 Date: 7/13/01 Receipt # 4076

Other requirements: Insp. Only. Connect to

12" Sewer + 12" Storm Drain 3306PD

☒ Sewer

Connection made to Part of jointly-shared private line ☐ Yes ☒ No

☒ Storm Drain

FOR INSPECTION ONLY, A 24 HOUR NOTICE IS REQUIRED AND THE CONTRACTOR/APPLICANT IS REQUIRED TO NOTIFY THE WASTEWATER DIVISION AT 991-6158

Applicant agrees to abide by the above terms, as well as all pertinent ordinances of the City of New Bedford, and such other special rules as the Commissioner of Public Works may deem necessary

Lawrence D. Worden
Commissioner of Public Works

Signature of Property Owner or Representative

INSPECTOR'S REPORT

INSPECTED BY: JOSEPH MARTIN

DATE: 9/13/01

COMMENTS: Per Joe Martin, did not witness storm drain connection.

☒ APPROVED

☐ DISAPPROVED

SIGNATURE

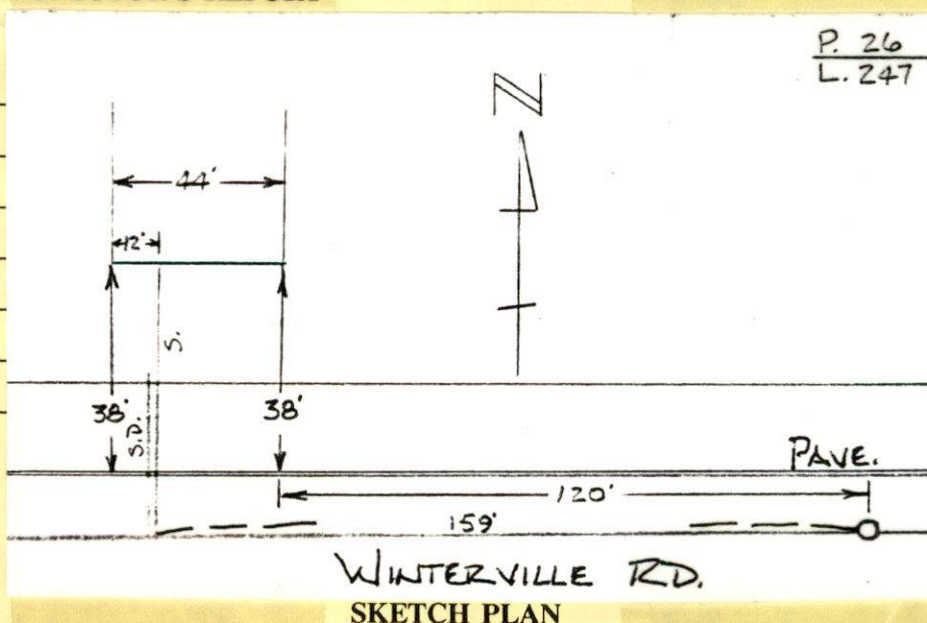

P. 26
L. 247

PERMIT NO.
23107



CITY OF NEW BEDFORD

DATE 7/13/2001

SEWER AND/OR STORM DRAIN PERMIT

This certifies that permission is granted to

Manuel Rodrigues 77 Dartmouth St. New Bedford, MA 508-999-4782
Property Owner Address Tel.

to connect a sewer and/or storm drain located at Winterville Rd. (Ns) ~~710'± W~~ x Ridge St.

Assessor's Plot 26, Lot 247, to the sewer and/or storm drain in Winterville Rd. Street

to be laid in accordance with the conditions in this application and the City of New Bedford ordinances.

TYPE OF USE: ☒ RESIDENTIAL ☐ COMMERICAL ☐ INDUSTRIAL ☐ OTHER

If applicant other than actual property owner, attach Letter of Authorization from Property Owner.

Name Jose Verissimo Tel. 508-965-6267

Mailing Address 20 Mosher St. So. Dartmouth, MA

The Bonded Contractor/Drain Layer authorized to perform this work is:

Jose Braga Bobcat Services 3 E Wardell St. S. Dart. 508-994-7968
Name Address Tel.

Type of Pipe Required: PVC SDR-35

PERMIT EXPIRES ONE YEAR AFTER DATE OF ISSUE

- * Requires separate connections for sewage and storm drain where applicable. Storm water cannot be discharged to a sanitary sewer.
- * All work must be inspected and approved by a D.P.W. inspector before backfilling.
- * If this connection is to be part of a private service shared jointly with other building owners, attach copy of Recorded Joint Maintenance Agreement.
- * Permits can be issued to Industrial and/or Commercial Applicants only upon receipt and approval by the Commissioner of Public Works of required plans and supplemental information.
- * In addition, a City-issued Industrial User Discharge Permit and/or a Sewer Extension/Connection Permit issued by the Commonwealth of Massachusetts D.E.P. shall be required by the City for Industrial Discharge into the sewer system.

Industrial User Discharge Permit No. Date

Comm. Mass. Sewer Conn./Ext. Permit No. Date

A Filing and Inspection Fee of \$ 150.00, plus an Entrance Fee of \$ — where applicable, must accompany this application.

Bank # Luza Community Bank Check # 003 Date: 7/13/01 Receipt # 4076

Other requirements: Insp. Only. Connect to 330 G.P.D.

10" Sewer + 12" Storm Drain

☒ Sewer

Connection made to Part of jointly-shared private line ☐ Yes ☒ No

☒ Storm Drain

FOR INSPECTION ONLY, A 24 HOUR
NOTICE IS REQUIRED AND THE
CONTRACTOR/APPLICANT IS
REQUIRED TO NOTIFY THE
WASTEWATER DIVISION AT 991-6158

Applicant agrees to abide by the above terms, as well as all pertinent ordinances of the City of New Bedford, and such other special rules as the Commissioner of Public Works may deem necessary

Lawrence D. Worden
Commissioner of Public Works

[Signature]
Signature of Property Owner or Representative

INSPECTOR'S REPORT

INSPECTED BY: _____

DATE: _____

COMMENTS: _____

☐ APPROVED

☐ DISAPPROVED

SIGNATURE

SKETCH PLAN



MASSACHUSETTS

DEPT. OF PUBLIC WORKS

133 WILLIAM STREET

LAWRENCE D. WORDEN
COMMISSIONER

To Whom It May Concern:

I, MANUEL RODRIGUES 77 DARTMOUTH ST. ^{N.B.} being
(Name) First Mailing Address
owner of property located at WINTERVILLE RD New Bedford
Plot 26 Lot 247 hereby agree to allow Jose Verissima
Name

20 MOSHER ST. DARTMOUTH to act on my behalf, including affixing my signature,
Mailing Address
in securing permits for:

☒ Sewer/Drain Service Permits
☒ Water Service Permits
☒ Driveway Installation Permits
☐ Sidewalk Installation Permits

I further agree to conform to, and abide by, all City rules and ask regulations applicable to the permit (s) being applied for.

Name Manuel Rodrigues
(Signature)

77 WINTERVILLE RD
(Address)

7-11-01 528 999 4782
(Date) (Telephone Number)

SCHOFIELD ST. (PROP.)

Sewer 10"

S.D. 12"

WINTERVILLE

S. 12"

S.D. 15"

43

14598-31

14572-30

16723-55

16933-56

10414-19

12955-24

11227-21

15193-47

12017-22

19053-69

30