

PERMIT NO.
23099



CITY OF NEW BEDFORD

DATE 7/11/01

SEWER AND/OR STORM DRAIN PERMIT

This certifies that permission is granted to

New Homes by Castella Inc. 1815 Acushnet Ave New Bedford

Property Owner

Address

Tel. 508-995-6291

to connect a sewer and/or storm drain located at Worcester St. (ws) 130' N x Brockton

Assessor's Plot 1278, Lot 496, to the sewer and/or storm drain in Worcester St. Street

to be laid in accordance with the conditions in this application and the City of New Bedford ordinances.

TYPE OF USE: ☒ RESIDENTIAL ☐ COMMERICAL ☐ INDUSTRIAL ☐ OTHER

RECEIVED

If applicant other than actual property owner, attach Letter of Authorization from Property Owner.

AUG - 7 2001

Name.....Tel.....

DEPT. OF PUBLIC WORKS
NEW BEDFORD, MASS.

Mailing Address.....

The Bonded Contractor/Drain Layer authorized to perform this work is:

R.J. CANESSA - EXCON 508 993 9508

Name

915 Hathaway Address

Tel.

Type of Pipe Required: PVC SDR-35

PERMIT EXPIRES ONE YEAR AFTER DATE OF ISSUE

- * Requires separate connections for sewage and storm drain where applicable. Storm water cannot be discharged to a sanitary sewer.
- * All work must be inspected and approved by a D.P.W. inspector before backfilling.
- * If this connection is to be part of a private service shared jointly with other building owners, attach copy of Recorded Joint Maintenance Agreement.
- * Permits can be issued to Industrial and/or Commercial Applicants only upon receipt and approval by the Commissioner of Public Works of required plans and supplemental information.
- * In addition, a City-issued Industrial User Discharge Permit and/or a Sewer Extension/Connection Permit issued by the Commonwealth of Massachusetts D.E.P. shall be required by the City for Industrial Discharge into the sewer system.

Industrial User Discharge Permit No.....Date.....

Comm. Mass. Sewer Conn./Ext. Permit No.....Date.....

A Filing and Inspection Fee of \$150.00, plus an Entrance Fee of \$..... where applicable, must accompany this application.

Bank # Compass Bank Check # 2499 Date: 7/11/01 Receipt # 4074

Other requirements: Insp. Only - Connect to 20" Sewer 3306PD

☒ Sewer

Connection made to

Part of jointly-shared private line ☐ Yes ☒ No

☐ Storm Drain

FOR INSPECTION ONLY, A 24 HOUR
NOTICE IS REQUIRED AND THE
CONTRACTOR/APPLICANT IS
REQUIRED TO NOTIFY THE
WASTEWATER DIVISION AT 991-6158

Applicant agrees to abide by the above terms, as well as all pertinent ordinances of the City of New Bedford, and such other special rules as the Commissioner of Public Works may deem necessary

Laurence D. Worden (ms)

Commissioner of Public Works

Joe S. Castella

Signature of Property Owner or Representative

INSPECTOR'S REPORT

INSPECTED BY: Peter Schuszka

DATE: 9/24/01 (7/24/01)

COMMENTS:

☒ APPROVED

☐ DISAPPROVED

Signature

SIGNATURE

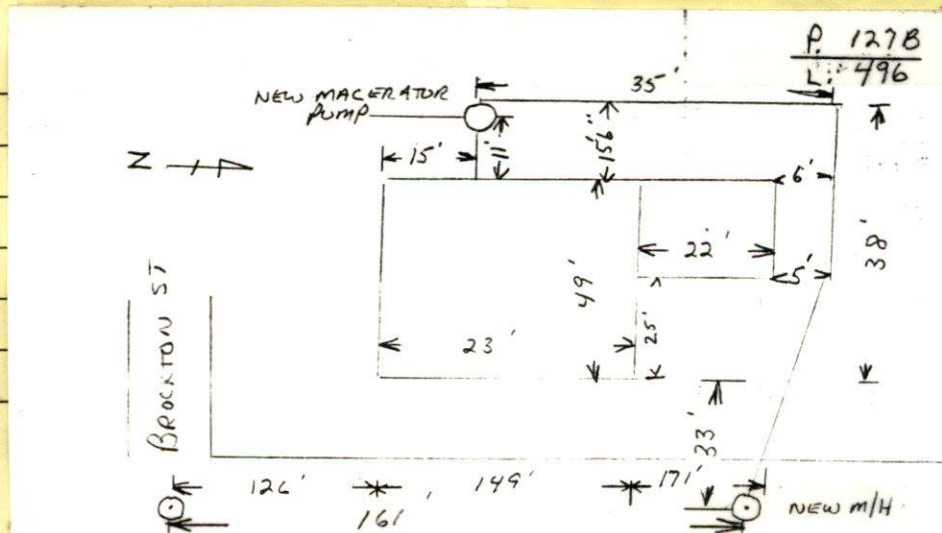

SKETCH PLAN

PERMIT NO.
23099



CITY OF NEW BEDFORD

DATE 7/11/01

SEWER AND/OR STORM DRAIN PERMIT

This certifies that permission is granted to

New Homes by Castello Inc. 1815 Acushnet Ave New Bedford

Property Owner

Address

Tel. 508-995-6291

to connect a sewer and/or storm drain located at Worcester St. (ws) 130' N x Brockton

Assessor's Plot 127B, Lot 496, to the sewer and/or storm drain in Worcester St. Street

to be laid in accordance with the conditions in this application and the City of New Bedford ordinances.

TYPE OF USE: ☒ RESIDENTIAL ☐ COMMERICAL ☐ INDUSTRIAL ☐ OTHER

If applicant other than actual property owner, attach Letter of Authorization from Property Owner.

Name Tel.

Mailing Address

The Bonded Contractor/Drain Layer authorized to perform this work is:

R.J. CANESSA - EX-CAV

Name

915 Hathaway Rd Address

508 993 9508

Tel.

Type of Pipe Required: PVC SDR-35

PERMIT EXPIRES ONE YEAR AFTER DATE OF ISSUE

- * Requires separate connections for sewage and storm drain where applicable. Storm water cannot be discharged to a sanitary sewer.
- * All work must be inspected and approved by a D.P.W. inspector before backfilling.
- * If this connection is to be part of a private service shared jointly with other building owners, attach copy of Recorded Joint Maintenance Agreement.
- * Permits can be issued to Industrial and/or Commercial Applicants only upon receipt and approval by the Commissioner of Public Works of required plans and supplemental information.
- * In addition, a City-issued Industrial User Discharge Permit and/or a Sewer Extension/Connection Permit issued by the Commonwealth of Massachusetts D.E.P. shall be required by the City for Industrial Discharge into the sewer system.

Industrial User Discharge Permit No. Date

Comm. Mass. Sewer Conn./Ext. Permit No. Date

A Filing and Inspection Fee of \$150.00 plus an Entrance Fee of \$ where applicable, must accompany this application.

Bank # Compass Bank Check # 2499 Date: 7/11/01 Receipt # 4074

Other requirements: Insp. Only - Connect to 30" Sewer 3306PD

Connection made to ☒ Sewer ☐ Storm Drain Part of jointly-shared private line ☐ Yes ☒ No

FOR INSPECTION ONLY, A 24 HOUR NOTICE IS REQUIRED AND THE CONTRACTOR/APPLICANT IS REQUIRED TO NOTIFY THE WASTEWATER DIVISION AT 991-6158

Applicant agrees to abide by the above terms, as well as all pertinent ordinances of the City of New Bedford, and such other special rules as the Commissioner of Public Works may deem necessary

Lawrence D. Worden (MS)

Commissioner of Public Works

Jos. S. Castello

Signature of Property Owner or Representative

INSPECTOR'S REPORT

INSPECTED BY:

DATE:

COMMENTS:

☐ APPROVED

☐ DISAPPROVED

SIGNATURE

SKETCH PLAN

R.J. CANESSA - Brockton St.

