

PERMIT NO.  
23096



CITY OF NEW BEDFORD

DATE 7-2-01

SEWER AND/OR STORM DRAIN PERMIT

This certifies that permission is granted to  
MARY T. CLEVELAND, 270 WILBUR ST. - NB, MA - 02740.  
Property Owner Address Tel 508-993-9454.  
to connect a sewer and/or storm drain located at WILBUR ST. (SS) W/ROCKDALE AVE.  
Assessor's Plot 80, Lot 23, to the sewer and/or storm drain in WILBUR ST. Street  
to be laid in accordance with the conditions in this application and the City of New Bedford ordinances.

TYPE OF USE: ☒ RESIDENTIAL ☐ COMMERICAL ☐ INDUSTRIAL ☐ OTHER

If applicant other than actual property owner, attach Letter of Authorization from Property Owner.

Name BRADFORD CLEVELAND. Tel. 508-993-9454.  
Mailing Address 882 OLD PLAINVILLE RD. - NB 02745.

The Bonded Contractor/Drain Layer authorized to perform this work is:

LA BONNE BROS. 508-478-1874  
Name Address Tel.

Type of Pipe Required: PVC. SDR 35 -

PERMIT EXPIRES ONE YEAR AFTER DATE OF ISSUE

- \* Requires separate connections for sewage and storm drain where applicable. Storm water cannot be discharged to a sanitary sewer.
- \* All work must be inspected and approved by a D.P.W. inspector before backfilling.
- \* If this connection is to be part of a private service shared jointly with other building owners, attach copy of Recorded Joint Maintenance Agreement.
- \* Permits can be issued to Industrial and/or Commercial Applicants only upon receipt and approval by the Commissioner of Public Works of required plans and supplemental information.
- \* In addition, a City-issued Industrial User Discharge Permit and/or a Sewer Extension/Connection Permit issued by the Commonwealth of Massachusetts D.E.P. shall be required by the City for Industrial Discharge into the sewer system.

Industrial User Discharge Permit No. \_\_\_\_\_ Date \_\_\_\_\_

Comm. Mass. Sewer Conn./Ext. Permit No. \_\_\_\_\_ Date \_\_\_\_\_

A Filing and Inspection Fee of \$ 150.00, plus an Entrance Fee of \$ 382.20 where applicable, must accompany this application.

Bank # CITIZENS BANK Check # 3370 Date: 7-2-01 Receipt # 4059

Other requirements: 1. WSP ONLY - STUB @ PROPERTY LINE

Stub: 26' x 14.70 Lft. = \$382.20 + Sewer \$150.00 - Total \$532.20

☒ Sewer

Connection made to \_\_\_\_\_ Part of jointly-shared private line ☐ Yes ☒ No

☐ Storm Drain

Applicant agrees to abide by the above terms, as well as all pertinent ordinances of the City of New Bedford, and such other special rules as the Commissioner of Public Works may deem necessary

Commissioner of Public Works

Signature of Property Owner or Representative

INSPECTED BY: JOSEPH MARTIN

DATE: 7/11/01

COMMENTS: [Inspected by CDM from main to property line - Rowe St. Sewer Project.]

☒ APPROVED

☐ DISAPPROVED

SIGNATURE

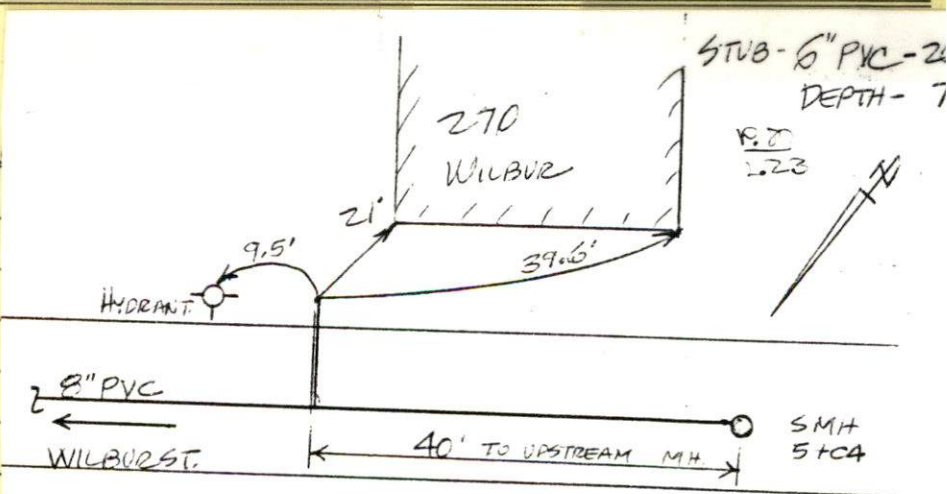

WILBUR ST.

SKETCH PLAN



PERMIT NO.  
23096



CITY OF NEW BEDFORD

DATE 7-2-01

SEWER AND/OR STORM DRAIN PERMIT

This certifies that permission is granted to  
MARY T. CLEVELAND 270 WILBUR ST - NB - MA - 02740.  
Property Owner Address Tel. 508-993-9454.  
to connect a sewer and/or storm drain located at WILBUR ST. (SS) W/ ROCKDALE AVE.  
Assessor's Plot 80, Lot 23, to the sewer and/or storm drain in WILBUR ST - Street  
to be laid in accordance with the conditions in this application and the City of New Bedford ordinances.

TYPE OF USE: ☒ RESIDENTIAL ☐ COMMERICAL ☐ INDUSTRIAL ☐ OTHER 4406P1

If applicant other than actual property owner, attach Letter of Authorization from Property Owner.

Name BRADFORD CLEVELAND Tel.

Mailing Address 882 OLD PLAINVILLE RD - NB 02745

The Bonded Contractor/Drain Layer authorized to perform this work is:

LA BONNE BROS. 508-478-1274  
Name Address Tel.

Type of Pipe Required: PVC SDR 35 -

PERMIT EXPIRES ONE YEAR AFTER DATE OF ISSUE

- \* Requires separate connections for sewage and storm drain where applicable. Storm water cannot be discharged to a sanitary sewer.
- \* All work must be inspected and approved by a D.P.W. inspector before backfilling.
- \* If this connection is to be part of a private service shared jointly with other building owners, attach copy of Recorded Joint Maintenance Agreement.
- \* Permits can be issued to Industrial and/or Commercial Applicants only upon receipt and approval by the Commissioner of Public Works of required plans and supplemental information.
- \* In addition, a City-issued Industrial User Discharge Permit and/or a Sewer Extension/Connection Permit issued by the Commonwealth of Massachusetts D.E.P. shall be required by the City for Industrial Discharge into the sewer system.

Industrial User Discharge Permit No. Date

Comm. Mass. Sewer Conn./Ext. Permit No. Date

A Filing and Inspection Fee of \$150.00, plus an Entrance Fee of \$382.20 where applicable, must accompany this application.

Bank # CITIZENS BANK Check # 3370 Date: 7-2-01 Receipt # 4059

Other requirements: 1. NO SP. ONLY - STUB @ PROPERTY LINE

Stub: 26' x 14" LF = \$382.20 + sewer \$150.00 - Total \$532.20

☒ Sewer

Rose St. Sewer Project

Connection made to

Part of jointly-shared private line ☐ Yes ☒ No

☐ Storm Drain

FOR INSPECTION ONLY, A 24 HOUR NOTICE IS REQUIRED AND THE CONTRACTOR/APPLICANT IS REQUIRED TO NOTIFY THE WASTEWATER DIVISION AT 991-6158

Applicant agrees to abide by the above terms, as well as all pertinent ordinances of the City of New Bedford, and such other special rules as the Commissioner of Public Works may deem necessary

Lawrence J. Worden Jr.  
Commissioner of Public Works

Signature of Property Owner or Representative

INSPECTOR'S REPORT

INSPECTED BY:

DATE:

COMMENTS:

☐ APPROVED

☐ DISAPPROVED

SIGNATURE

SKETCH PLAN





# MASSACHUSETTS

## DEPT. OF PUBLIC WORKS

133 WILLIAM STREET

LAWRENCE D. WORDEN  
COMMISSIONER

To Whom It May Concern:

I, Mary T. Cleveland 270 Wilbur St. NB. being  
(Name) Print Mailing Address

owner of property located at 270 Wilbur St. NB.

Plot 80, Lot 23, hereby agree to allow P. M. B. Bull  
Name

882 Old Plainville Rd. NB. 02745 to act on my behalf, including affixing my signature,  
Mailing Address  
in securing permits for:

☒ Sewer/Drain Service Permits  
☐ Water Service Permits  
☐ Driveway Installation Permits  
☐ Sidewalk Installation Permits

I further agree to conform to, and abide by, all City rules and ask regulations applicable to the permit (s) being applied for.

Name Mary T. Cleveland  
(signature)

270 Wilbur St.  
(Address)

7/2/01 508 99 39454  
(Date) (Telephone Number)

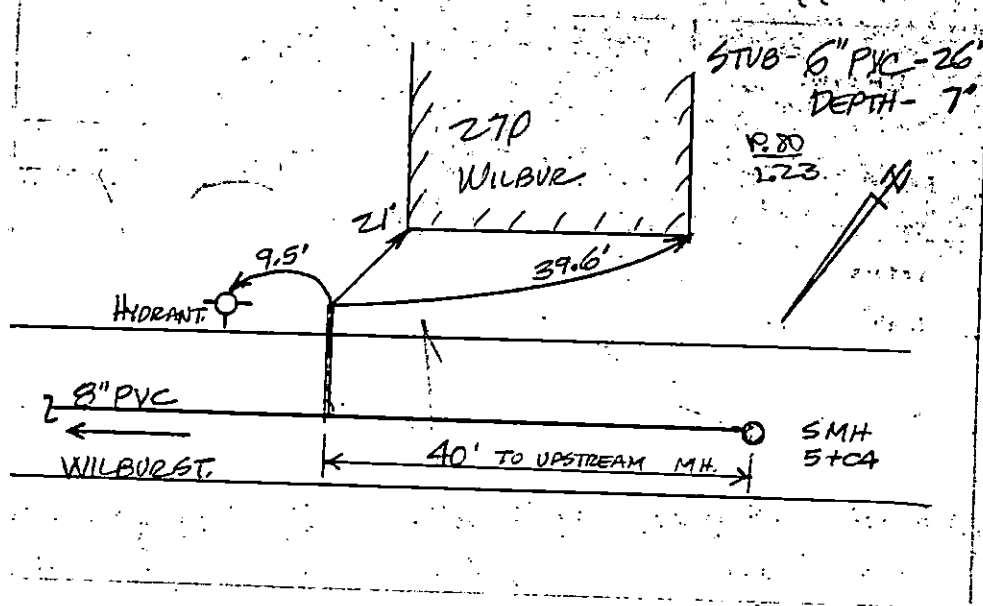

DRAIN

WILBUR ST. (#270) SOUTH SIDE

Permit

No.

Enters WILBUR ST

Drain Plot No.

From Property of