

PERMIT NO.
23083



CITY OF NEW BEDFORD
SEWER AND/OR STORM DRAIN PERMIT

DATE 5/18/01
EX. 5/18/02

This certifies that permission is granted to

Janice P. O'Neil & Russell Wright - 73 Lemos St. New Bedford, MA 01902
Property Owner Address Tel. 508-636-1148

to connect a sewer and/or storm drain located at Lemos St. #26
Assessor's Plot 80, Lot 56, to the sewer and/or storm drain in Lemos St. Street

to be laid in accordance with the conditions in this application and the City of New Bedford ordinances.

TYPE OF USE: ☒ RESIDENTIAL ☐ COMMERICAL ☐ INDUSTRIAL ☐ OTHER 220 GPD

If applicant other than actual property owner, attach Letter of Authorization from Property Owner.

Name Juliet or James O'Shea Tel. 508-994-1079
Mailing Address 26 Lemos St. New Bedford, MA 02740

The Bonded Contractor/Drain Layer authorized to perform this work is:
Will Call Co. DW-Engineering 979-1527
Name Address

RECEIVED
AUG - 7 2001
DEPT. OF PUBLIC WORKS
NEW BEDFORD, MASS.

Type of Pipe Required: PVC 545 35
PERMIT EXPIRES ONE YEAR AFTER DATE OF ISSUE

- * Requires separate connections for sewage and storm drain where applicable. Storm water cannot be discharged to a sanitary sewer.
- * All work must be inspected and approved by a D.P.W. inspector before backfilling.
- * If this connection is to be part of a private service shared jointly with other building owners, attach copy of Recorded Joint Maintenance Agreement.
- * Permits can be issued to Industrial and/or Commercial Applicants only upon receipt and approval by the Commissioner of Public Works of required plans and supplemental information.
- * In addition, a City-issued Industrial User Discharge Permit and/or a Sewer Extension/Connection Permit issued by the Commonwealth of Massachusetts D.E.P. shall be required by the City for Industrial Discharge into the sewer system.

Industrial User Discharge Permit No. --- Date ---
Comm. Mass. Sewer Conn./Ext. Permit No. --- Date ---

A Filing and Inspection Fee of \$ 150.00, plus an Entrance Fee of \$ 499.80 where applicable, must accompany this application.
Bank # Flut Check # 713 Date: 5/18/01 Receipt # 4024

Other requirements: Inspection only - Shikol ML - Rockdale Ave. Sewer Proj.
Shik: 34' x \$14.70/ft = \$499.80; Sewer: \$150.00; Total = \$649.80
Owner must call Health Dept. re: Septic System Abandonment
☒ Sewer
Connection made to Part of jointly-shared private line ☐ Yes ☒ No
☐ Storm Drain

Applicant agrees to abide by the above terms, as well as all pertinent ordinances of the City of New Bedford, and such other special rules as the Commissioner of Public Works may deem necessary

Lawrence D. Worden
Commissioner of Public Works

Juliet M. O'Shea
Signature of Property Owner or Representative

INSPECTOR'S REPORT

FOR INSPECTION ONLY, A 24 HOUR NOTICE IS REQUIRED AND THE CONTRACTOR/APPLICANT IS REQUIRED TO NOTIFY THE

INSPECTED BY: JOSEPH MARTIN
DATE: 6/5/01
COMMENTS: [CDM inspected from main in street to prop. line - Rockdale Ave. Sewer Project]

☒ APPROVED ☐ DISAPPROVED

Joseph Martin
SIGNATURE

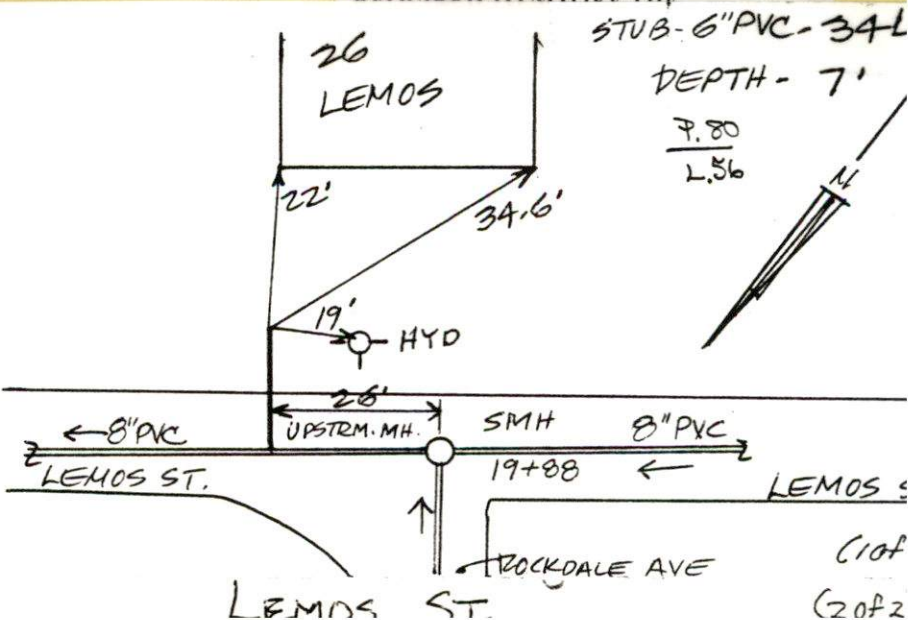

PERMIT NO.
23083



CITY OF NEW BEDFORD
SEWER AND/OR STORM DRAIN PERMIT

DATE 5/18/01
EXP. 5/18/02

This certifies that permission is granted to
Janice Mondeville & Russell D. Wright 73 White Oak Run Rd. N.D. MA
Property Owner Address Tel. 508-636-4482

to connect a sewer and/or storm drain located at Lemos St. #26
Assessor's Plot 80, Lot 56, to the sewer and/or storm drain in Lemos Street

to be laid in accordance with the conditions in this application and the City of New Bedford ordinances.

TYPE OF USE: ☒ RESIDENTIAL ☐ COMMERICAL ☐ INDUSTRIAL ☐ OTHER 220 GPD

If applicant other than actual property owner, attach Letter of Authorization from Property Owner.

Name Juliet or James O'Shea Tel. 508-994-1079
Mailing Address 26 Lemos St. New Bedford MA 02740

The Bonded Contractor/Drain Layer authorized to perform this work is:
Will call us. DPW-Engineering 979-1527 Address 662 SECOND ST. FALL RIVER MA. 02721 Tel. 508-324-089

Type of Pipe Required: PVC SDR 35
PERMIT EXPIRES ONE YEAR AFTER DATE OF ISSUE

- * Requires separate connections for sewage and storm drain where applicable. Storm water cannot be discharged to a sanitary sewer.
- * All work must be inspected and approved by a D.P.W. inspector before backfilling.
- * If this connection is to be part of a private service shared jointly with other building owners, attach copy of Recorded Joint Maintenance Agreement.
- * Permits can be issued to Industrial and/or Commercial Applicants only upon receipt and approval by the Commissioner of Public Works of required plans and supplemental information.
- * In addition, a City-issued Industrial User Discharge Permit and/or a Sewer Extension/Connection Permit issued by the Commonwealth of Massachusetts D.E.P. shall be required by the City for Industrial Discharge into the sewer system.

Industrial User Discharge Permit No. _____ Date _____
Comm. Mass. Sewer Conn./Ext. Permit No. _____ Date _____

A Filing and Inspection Fee of \$ 150.00 plus an Entrance Fee of \$ 499.80 where applicable, must accompany this application.

Bank # Fleet Check # 713 Date: 5/18/01 Receipt # 4024

Other requirements: Inspection Only - Shabat Pl - Rom St. Sewer Proj.

Shab: 34' X \$14.70/ft = \$499.80; Sewer: \$150.00; Total = \$649.80
Owner must call Health Dept. re: Septic System Abandonment

Connection made to ☒ Sewer ☐ Storm Drain
Part of jointly-shared private line ☐ Yes ☒ No

Applicant agrees to abide by the above terms, as well as all pertinent ordinances of the City of New Bedford, and such other special rules as the Commissioner of Public Works may deem necessary

Lawrence D. Worden
Commissioner of Public Works

Juliet M. O'Shea
Signature of Property Owner or Representative

INSPECTOR'S REPORT

INSPECTED BY: _____

DATE: _____

COMMENTS: _____

☐ APPROVED ☐ DISAPPROVED

SIGNATURE

FOR INSPECTION ONLY, A 24 HOUR
NOTICE IS REQUIRED AND THE
CONTRACTOR/APPLICANT IS
REQUIRED TO NOTIFY THE
WASTEWATER DIVISION AT 991-6158

SKETCH PLAN

May 17, 2001

To Whom It May Concern

Either Juliet or James
O'Shea has permission
to sign on my behalf
in order to obtain a
"Sewer Permit".

Thank you.

James Mandeville

JANICE MANDEVILLE
& RUSSELL D. WRIGHT



LAWRENCE D. WORDEN
COMMISSIONER

CITY OF NEW BEDFORD MASSACHUSETTS

DEPARTMENT OF PUBLIC WORKS
ENGINEERING DIVISION
133 WILLIAM STREET, ROOM 303
NEW BEDFORD, MA 02740
Tel: (508) 979-1527
Fax: (508) 961-3043

December 27, 2000

Attn: Janice Mandeville & Russell D. Wright
73 White Oak Run Rd.
N. Dartmouth, MA 02747

Re: Rowe Street Sewer Project Area--Properties Located Within Isolated Portions of the Sewer System Which Have Been Approved and Are Presently Operational

This letter serves as notification to you that the following property may now connect to the sewer system:

Owner(s):	Mandeville, Janice & Wright, Russell D.
Location:	26 Lemos St.
Plot/Lot:	80/56
Service Pipe Length Installed:	34
Total Cost of Service Line:	\$499.80

In addition to the cost of the service line provided for the property, which the property owner must reimburse the City for when ready to connect to the sewer system, there is also a "Sewer Permit" fee of \$150.00. Once ready to connect to the sewer system, the property owner must come to City Hall, D.P.W. Engineering office, Room 303, to obtain said permit, at which time both of these amounts are due to the City. If someone other than the property owner is going to obtain the permit, this person must have a signed permission slip from the property owner allowing the entity to sign on behalf of the property owner. Also, if the property owner is abandoning a septic system, they must make arrangements with the Health Department at (508) 991-6273.

The City has brought the sewer service pipe to your property line. The property owner is responsible for making the provisions for any work required and costs incurred on their property. Property owners should make sure that the contractor they hire knows that, although they are working on private property, the D.P.W. Waste Water Division, and possibly other City officials, must inspect all work done before the sewer trench is backfilled.

Should you have any questions or need additional information, please feel free to contact Ana Rosa or Mario Gomes in the Engineering Department at (508) 979-1527.

Sincerely,

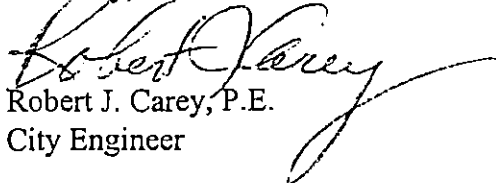
Robert J. Carey, P.E.
City Engineer

RJC/asr

DRAIN

Permit

No.

Enters LEHOS ST.

Drain Plot No.

From Property of

LEHOS ST (#26) SOUTH SIDE

