

PERMIT NO.  
23080



CITY OF NEW BEDFORD

DATE 5-7-01

SEWER AND/OR STORM DRAIN PERMIT

This certifies that permission is granted to

DAVID FALCONE OF DMF CONST. CORP. 293 TICKLE RD. WESTPORT MA. 02790.  
Property Owner Address Tel. 508-675-3105

to connect a sewer and/or storm drain located at FOXBOROUGH ST. E. 100' S. / HATHAWAY RD.  
Assessor's Plot 95, Lot 312, to the sewer and/or storm drain in FOXBOROUGH ST. Street

to be laid in accordance with the conditions in this application and the City of New Bedford ordinances

TYPE OF USE: ☒ RESIDENTIAL ☐ COMMERICAL ☐ INDUSTRIAL ☐ OTHER

If applicant other than actual property owner, attach Letter of Authorization from Property Owner.

Name \_\_\_\_\_ Tel. \_\_\_\_\_

Mailing Address \_\_\_\_\_

The Bonded Contractor/Drain Layer authorized to perform this work is:

JO BRAGA BOBCAT SERVICE 508-994-7968.  
Name Address Tel.

Type of Pipe Required: P.V.C. SDR 35

PERMIT EXPIRES ONE YEAR AFTER DATE OF ISSUE

- \* Requires separate connections for sewage and storm drain where applicable. Storm water cannot be discharged to a sanitary sewer.
- \* All work must be inspected and approved by a D.P.W. inspector before backfilling.
- \* If this connection is to be part of a private service shared jointly with other building owners, attach copy of Recorded Joint Maintenance Agreement.
- \* Permits can be issued to Industrial and/or Commercial Applicants only upon receipt and approval by the Commissioner of Public Works of required plans and supplemental information.
- \* In addition, a City-issued Industrial User Discharge Permit and/or a Sewer Extension/Connection Permit issued by the Commonwealth of Massachusetts D.E.P. shall be required by the City for Industrial Discharge into the sewer system.

Industrial User Discharge Permit No. \_\_\_\_\_ Date \_\_\_\_\_

Comm. Mass. Sewer Conn./Ext. Permit No. \_\_\_\_\_ Date \_\_\_\_\_

A Filing and Inspection Fee of \$ 150.00, plus an Entrance Fee of \$ \_\_\_\_\_ where applicable, must accompany this application.

Bank # Community Bank of Check # 1418 Date: 5-7-01 Receipt # 4017.

Other requirements: WSP ONLY WILL CONNECT TO 10" SEWER MAIN 3306

W. E. of ST. South of S.M.H. -

☒ Sewer

Connection made to Part of jointly-shared private line ☐ Yes ☒ No

☐ Storm Drain

Applicant agrees to abide by the above terms, as well as all pertinent ordinances of the City of New Bedford, and such other special rules as the Commissioner of Public Works may deem necessary

Commissioner of Public Works Signature of Property Owner or Representative

INSPECTOR'S REPORT

INSPECTED BY: Peter Scieszka

DATE: 6/27/01

COMMENTS:

☒ APPROVED ☐ DISAPPROVED

SIGNATURE

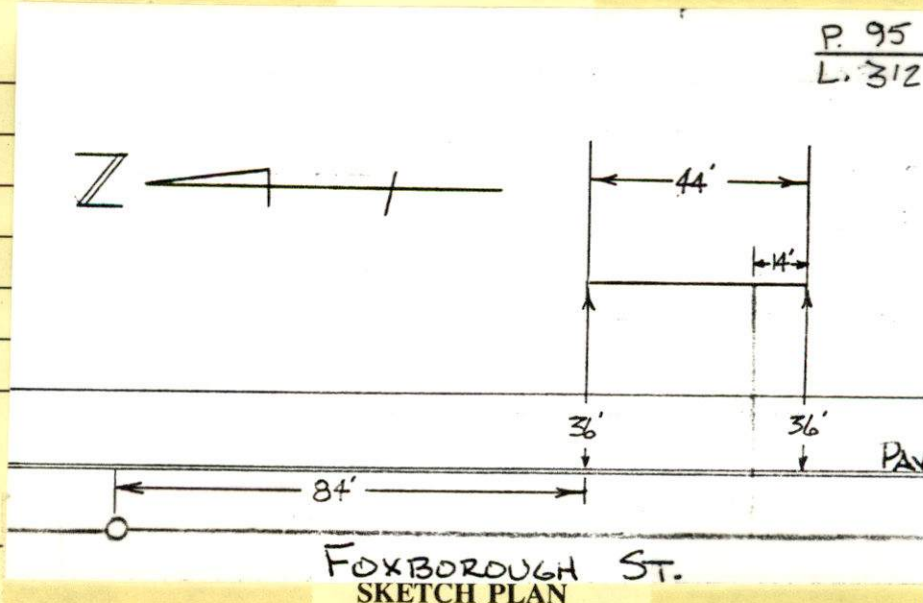



PERMIT NO.  
23080



CITY OF NEW BEDFORD

DATE.....5-7-01.....

SEWER AND/OR STORM DRAIN PERMIT

This certifies that permission is granted to

DAVID FALCONE OF DMF CONST. CORP. 293 TICKLE RD. WESTPORT MA. 02790.

Property Owner

Address

Tel. 508.675-3105

to connect a sewer and/or storm drain located at FOXBOROUGH ST. ES. 100' S. HATHAWAY RD.

Assessor's Plot.....95., Lot.....312....., to the sewer and/or storm drain in...FOXBOROUGH ST..... Street

to be laid in accordance with the conditions in this application and the City of New Bedford ordinances.

TYPE OF USE: ☒ RESIDENTIAL ☐ COMMERICAL ☐ INDUSTRIAL ☐ OTHER

If applicant other than actual property owner, attach Letter of Authorization from Property Owner.

Name.....Tel.....

Mailing Address.....

The Bonded Contractor/Drain Layer authorized to perform this work is:

JO BRAGA BOBCAT SERVICE

508-994-9968

Name

Address

Tel.

Type of Pipe Required:.....PVC - 30" 35".....

PERMIT EXPIRES ONE YEAR AFTER DATE OF ISSUE

\* Requires separate connections for sewage and storm drain where applicable. Storm water cannot be discharged to a sanitary sewer.

\* All work must be inspected and approved by a D.P.W. inspector before backfilling.

\* If this connection is to be part of a private service shared jointly with other building owners, attach copy of Recorded Joint Maintenance Agreement.

\* Permits can be issued to Industrial and/or Commercial Applicants only upon receipt and approval by the Commissioner of Public Works of required plans and supplemental information.

\* In addition, a City-issued Industrial User Discharge Permit and/or a Sewer Extension/Connection Permit issued by the Commonwealth of Massachusetts D.E.P. shall be required by the City for Industrial Discharge into the sewer system.

Industrial User Discharge Permit No.....Date.....

Comm. Mass. Sewer Conn./Ext. Permit No.....Date.....

A Filing and Inspection Fee of \$150.00, plus an Entrance Fee of \$..... where applicable, must accompany this application

Bank # Community Bank of Check # 1418 Date: 5-7-01 Receipt # 4017.

Other requirements: INSP. ONLY. WILL CONNECT TO 10" SEWER MAIN 330'

IN E of ST. South of S.M.H. -

☒ Sewer

Connection made to

Part of jointly-shared private line ☐ Yes ☒ No

☐ Storm Drain

FOR INSPECTION ONLY, A 24 HOUR NOTICE IS REQUIRED AND THE CONTRACTOR/APPLICANT IS REQUIRED TO NOTIFY THE WASTEWATER DIVISION AT 991-61

Applicant agrees to abide by the above terms, as well as all pertinent ordinances of the City of New Bedford, and such other special rules as the Commissioner of Public Works may deem necessary

Commissioner of Public Works

Signature of Property Owner or Representative

INSPECTOR'S REPORT

INSPECTED BY: \_\_\_\_\_

DATE: \_\_\_\_\_

COMMENTS: \_\_\_\_\_

\_\_\_\_\_

\_\_\_\_\_

\_\_\_\_\_

☐ APPROVED

☐ DISAPPROVED

SIGNATURE

SKETCH PLAN



AWAY

HATHAWAY RD -

RESIDENCE A.

RES. AA

|       |       |       |
|-------|-------|-------|
| 1254  | 80.29 | 96.51 |
| 169   | 28.34 | 7716  |
| 80.28 |       |       |
| 170   | 28.36 | 7721  |
| 80.28 |       |       |
| 171   | 28.36 | 7721  |
| 80.28 |       |       |
| 172   | 28.36 | 7721  |
| 80.28 |       |       |

STREET

|       |       |       |       |       |       |       |
|-------|-------|-------|-------|-------|-------|-------|
| 80.28 | 168   | 28.38 | 7726  | 80.28 | 80.29 | 96.75 |
| 96.52 |       |       |       | 96.64 | 153   | 28.42 |
| 80.28 |       |       |       | 80.28 |       | 7737  |
| 167   | 28.36 | 7721  | 80.28 | 154   | 28.36 | 7721  |
| 96.53 |       |       |       | 96.53 |       |       |
| 166   | 28.36 | 7721  | 80.28 | 155   | 28.36 | 7721  |
| 96.53 |       |       |       | 96.53 |       |       |
| 165   | 28.36 | 7721  | 80.28 | 156   | 28.36 | 7721  |
| 96.53 |       |       |       | 96.53 |       |       |

STREET

|        |       |       |       |       |       |       |
|--------|-------|-------|-------|-------|-------|-------|
| 72.58  | 313   | 29.46 | 8020  | 88.00 | 57.1  | 1558  |
| 107.33 |       |       |       |       |       |       |
| 68.48  | 312   | 30.08 | 8188  | 30.00 | 55    |       |
| 91.27  |       |       |       | 48.00 |       |       |
| 80.28  | 152   | 27.70 | 7541  | 80.28 | 141   | 27.70 |
| 94.27  |       |       |       | 94.27 |       | 7541  |
| 151    | 27.70 | 7541  | 80.28 | 142   | 27.70 | 7541  |
| 94.27  |       |       |       | 94.27 |       |       |

|       |       |       |       |       |       |
|-------|-------|-------|-------|-------|-------|
| 88.31 | 173   | 29.14 | 933   | 8.02  | 92.61 |
| 74    | 29.93 | 48    | 02    | 92.60 | 92.60 |
| 162   | 27.51 | 7490  | 80.02 | 159   | 27.51 |
| 93.63 |       |       |       | 93.63 |       |

WHITLOW

|       |       |       |       |       |       |        |
|-------|-------|-------|-------|-------|-------|--------|
| 80.28 | 164   | 28.24 | 7688  | 80.02 | 80.28 | 103.53 |
| 93.64 |       |       |       | 98.58 | 157   | 29.69  |
| 80.02 |       |       |       | 80.02 |       | 8083   |
| 163   | 27.51 | 7490  | 80.02 | 158   | 27.51 | 7490   |
| 93.63 |       |       |       | 93.63 |       |        |
| 162   | 27.51 | 7490  | 80.02 | 159   | 27.51 | 7490   |
| 93.63 |       |       |       | 93.63 |       |        |

FOXBOROUGH

|        |       |       |       |        |       |        |
|--------|-------|-------|-------|--------|-------|--------|
| 80.28  | 150   | 27.58 | 7509  | 80.02  | 80.28 | 101.26 |
| 91.37  |       |       |       | 96.32  | 143   | 29.03  |
| 80.02  |       |       |       | 80.02  |       | 7903   |
| 149    | 29.76 | 8102  | 80.02 | 144    | 29.76 | 8102   |
| 101.26 |       |       |       | 101.26 |       |        |
| 148    | 29.76 | 8102  | 80.02 | 145    | 29.76 | 8102   |
| 101.25 |       |       |       | 101.25 |       |        |

LANCASHIRE

# AVT ASSOCIATES

Civil Engineers & Surveyors

P.O. Box 80151  
South Dartmouth, MA 02748-0151  
(508) 992-0015

## AS-BUILT PLAN

Location: Foxborough St.  
AP 95 Lot 51  
New Bedford, MA  
Scale: 1" = 20' Date: 4-30-01

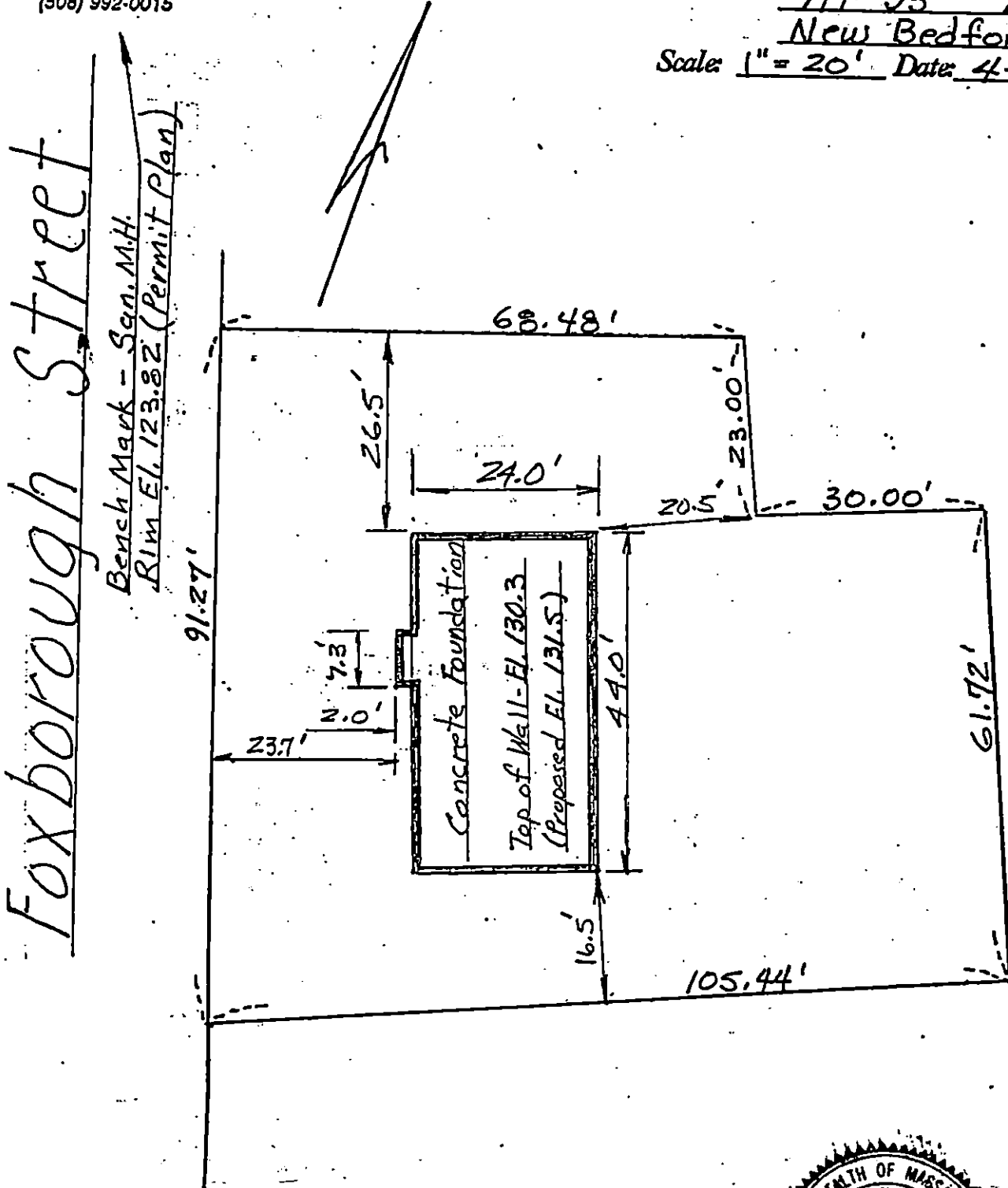

*Carl H. Bevilacqua*  
4-30-01