

PERMIT NO.
23074



CITY OF NEW BEDFORD

DATE 4/27/01

EXP 4/27/02

SEWER AND/OR STORM DRAIN PERMIT

This certifies that permission is granted to

Christine LeClair Goulet / Rich Goulet & A/B 103 North Front St.
Property Owner Address New Bedford, MA 02744 Tel. (508) 993-7661
to connect a sewer and/or storm drain located at (Obs.) N. Logan St.
Assessor's Plot 78, Lot 211, to the sewer and/or storm drain in the street
to be laid in accordance with the conditions in this application and the City of New Bedford ordinances.

TYPE OF USE: ☒ RESIDENTIAL ☒ COMMERCIAL ☐ INDUSTRIAL ☐ OTHER

If applicant other than actual property owner, attach Letter of Authorization from Property Owner.

Name Dupre, Inc. Tel. 408-993-8087

Mailing Address 369 Nash Rd. New Bedford, MA 02746-1826

The Bonded Contractor/Drain Layer authorized to perform this work is: On private property!
Dupre, Inc. 369 Nash Rd. New Bedford, MA 02746-1826 993-8087
Name Address Tel.

Type of Pipe Required: PVC 35

PERMIT EXPIRES ONE YEAR AFTER DATE OF ISSUE

- * Requires separate connections for sewage and storm drain where applicable. Storm water cannot be discharged to a sanitary sewer.
- * All work must be inspected and approved by a D.P.W. inspector before backfilling.
- * If this connection is to be part of a private service shared jointly with other building owners, attach copy of Recorded Joint Maintenance Agreement.
- * Permits can be issued to Industrial and/or Commercial Applicants only upon receipt and approval by the Commissioner of Public Works of required plans and supplemental information.
- * In addition, a City-issued Industrial User Discharge Permit and/or a Sewer Extension/Connection Permit issued by the Commonwealth of Massachusetts D.E.P. shall be required by the City for Industrial Discharge into the sewer system.

Industrial User Discharge Permit No. Date

Comm. Mass. Sewer Conn./Ext. Permit No. Date

A Filing and Inspection Fee of \$150.00, plus an Entrance Fee of \$ where applicable, must accompany this application.

Bank # Capital Bank Check # 0761 Date: 4-27-01 Receipt # 4009

Other requirements: Inspection Only - Tying into private line already existing on private property - See attached copy of plan

Connection made to ☒ Sewer ☐ Storm Drain
Part of jointly-shared private line ☐ Yes ☒ No

FOR INSPECTION ONLY, A 24 HOUR NOTICE IS REQUIRED AND THE CONTRACTOR/APPLICANT IS REQUIRED TO NOTIFY THE WASTEWATER DIVISION AT 991-6151

Applicant agrees to abide by the above terms, as well as all pertinent ordinances of other special rules as the Commissioner of Public Works may deem necessary

Commissioner of Public Works

Signature of Property Owner or Representative

INSPECTOR'S REPORT

INSPECTED BY: JOSEPH MARTIN

DATE: 5/1/01

COMMENTS:

☒ APPROVED ☐ DISAPPROVED

SIGNATURE

PAVE.

LOGAN ST.
SKETCH PLAN

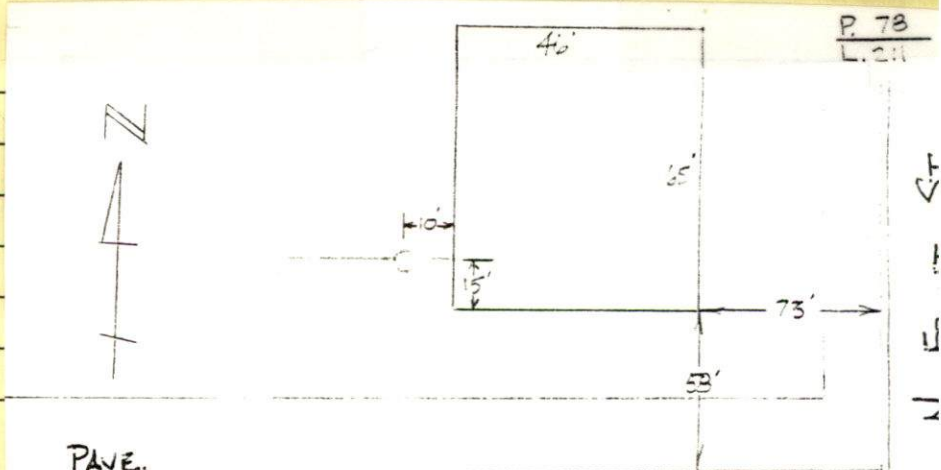

PERMIT NO.
23074



CITY OF NEW BEDFORD
SEWER AND/OR STORM DRAIN PERMIT

DATE 4/27/01
EXP 4/27/02

This certifies that permission is granted to
Christine Leck Goulart / Leck Garage & A/B 103 North Front St.
Property Owner Address New Bedford, MA 02744 Tel. (308) 993-7661
to connect a sewer and/or storm drain located at Leck Garage 103 N. Front ~ On Private Prop.
Assessor's Plot 78, Lot 211, to the sewer and/or storm drain in tying in to existing line Street
on private property
to be laid in accordance with the conditions in this application and the City of New Bedford ordinances.

TYPE OF USE: ☒ RESIDENTIAL ☒ COMMERICAL ☐ INDUSTRIAL ☐ OTHER

If applicant other than actual property owner, attach Letter of Authorization from Property Owner.

Name Dupre Inc. Tel. 508-993-8088

Mailing Address 369 Nash Rd. New Bedford, MA 02746 - 1826

The Bonded Contractor/Drain Layer authorized to perform this work is: On private property!
Dupre, Inc. 369 Nash Rd. New Bedford MA 02746 - 1826 993-8088
Name Address Tel.

Type of Pipe Required: PVC SDK 35

PERMIT EXPIRES ONE YEAR AFTER DATE OF ISSUE

- * Requires separate connections for sewage and storm drain where applicable. Storm water cannot be discharged to a sanitary sewer.
- * All work must be inspected and approved by a D.P.W. inspector before backfilling.
- * If this connection is to be part of a private service shared jointly with other building owners, attach copy of Recorded Joint Maintenance Agreement.
- * Permits can be issued to Industrial and/or Commercial Applicants only upon receipt and approval by the Commissioner of Public Works of required plans and supplemental information.
- * In addition, a City-issued Industrial User Discharge Permit and/or a Sewer Extension/Connection Permit issued by the Commonwealth of Massachusetts D.E.P. shall be required by the City for Industrial Discharge into the sewer system.

Industrial User Discharge Permit No. _____ Date _____

Comm. Mass. Sewer Conn./Ext. Permit No. _____ Date _____

A Filing and Inspection Fee of \$ 150.00 plus an Entrance Fee of \$ _____ where applicable, must accompany this application.

Bank # Compass Bank Check # 0761 Date: 4-27-01 Receipt # 4009

Other requirements: Inspection Only - Tying into private line already

existing on private property - see attached copy of plan

Per Memo Goulart - Putting in new trap for plumbing

Connection made to ☒ Sewer requiring new trap line tying Part of jointly-shared private line ☐ Yes ☒ No

☐ Storm Drain

FOR INSPECTION ONLY, A 24 HOUR
NOTICE IS REQUIRED AND THE
CONTRACTOR/APPLICANT IS
REQUIRED TO NOTIFY THE
WASTEWATER DIVISION AT 991-6151

Applicant agrees to abide by the above terms, as well as all pertinent ordinances of
other special rules as the Commissioner of Public Works may deem necessary

Ramona D. Worda
Commissioner of Public Works

[Signature]
Signature of Property Owner or Representative

INSPECTOR'S REPORT

INSPECTED BY: _____

DATE: _____

COMMENTS: _____

☐ APPROVED ☐ DISAPPROVED

SIGNATURE

SKETCH PLAN



CITY OF NEW BEDFORD MASSACHUSETTS

DEPT. OF PUBLIC WORKS

133 WILLIAM STREET

LAWRENCE D. WORDEN
COMMISSIONER

To Whom It May Concern:

I, Christine Lech Goulart/Lech Garage & A/B 103 North Front St., being
(Name) Print Mailing Address

owner of property located at Lech Garage

Plot 78, Lot 211, hereby agree to allow Dupre, Inc.
Name

369 Nash Rd. W.B. to act on my behalf, including affixing my signature,
Mailing Address
in securing permits for:

☒ Sewer/Drain Service Permits
☐ Water Service Permits
☐ Driveway Installation Permits
☐ Sidewalk Installation Permits

I further agree to conform to, and abide by, all City rules and ask regulations applicable to the permit (s) being applied for.

Name Christine Lech Goulart Christine Lech Goulart
(signature)
103 North Front St
(Address)
9/27/01 (508) 993-7661
(Date) (Telephone Number)