

PERMIT NO.  
23066



CITY OF NEW BEDFORD

DATE 4.9.01

SEWER AND/OR STORM DRAIN PERMIT

This certifies that permission is granted to  
R.L.G. Associates, Exc. Co. 17 Gray St. N. Providence 02904  
Property Owner Address #1075 750' (41-1) Tel. 401-641-6494  
to connect a sewer and/or storm drain located at Forbes St. Ext. 4 (N.S.) W. Acushnet Ave.  
Assessor's Plot 132 I, Lot 8, to the sewer and/or storm drain in Forbes St. Ext. 4 (N.S.) W. Acushnet Ave.  
to be laid in accordance with the conditions in this application and the City of New Bedford ordinances.

TYPE OF USE: ☐ RESIDENTIAL ☐ COMMERICAL ☐ INDUSTRIAL ☐ OTHER

If applicant other than actual property owner, attach Letter of Authorization from Property Owner.

Name Robert Gilliano Tel. 401-641-6494

Mailing Address 17 Gray St. N. Providence RI

The Bonded Contractor/Drain Layer authorized to perform this work is:

R. J. Carassa 915 Hathaway Rd. NB 508-993-9508  
Name Address Tel.

Type of Pipe Required: PVC SDR-35

PERMIT EXPIRES ONE YEAR AFTER DATE OF ISSUE

- \* Requires separate connections for sewage and storm drain where applicable. Storm water cannot be discharged to a sanitary sewer.
- \* All work must be inspected and approved by a D.P.W. inspector before backfilling.
- \* If this connection is to be part of a private service shared jointly with other building owners, attach copy of Recorded Joint Maintenance Agreement.
- \* Permits can be issued to Industrial and/or Commercial Applicants only upon receipt and approval by the Commissioner of Public Works of required plans and supplemental information.
- \* In addition, a City-issued Industrial User Discharge Permit and/or a Sewer Extension/Connection Permit issued by the Commonwealth of Massachusetts D.E.P. shall be required by the City for Industrial Discharge into the sewer system.

Industrial User Discharge Permit No. Date

Comm. Mass. Sewer Conn./Ext. Permit No. Date

A Filing and Inspection Fee of \$150.00 plus an Entrance Fee of \$ where applicable, must accompany this application.

Bank # 57-1/115 Check # 1122 Date: 4-9-01 Receipt #

Other requirements: Fleet 3306 PD

Connection made to ☒ Sewer ☐ Storm Drain Part of jointly-shared private line ☐ Yes ☐ No

Applicant agrees to abide by the above terms, as well as all pertinent ordinances of the City of New Bedford, and such other special rules as the Commissioner of Public Works may deem necessary

Lawrence D. Worden  
Commissioner of Public Works

Signature of Property Owner or Representative

INSPECTOR'S REPORT

INSPECTED BY: JOSEPH MARTIN  
DATE: 5/30/01  
COMMENTS: Inspected by Joseph Martin on 7/16/01 from prop. line to house. Stubs were installed as part of Forbes St. Ext. subdivision.

☒ APPROVED ☐ DISAPPROVED

Signature of Inspector

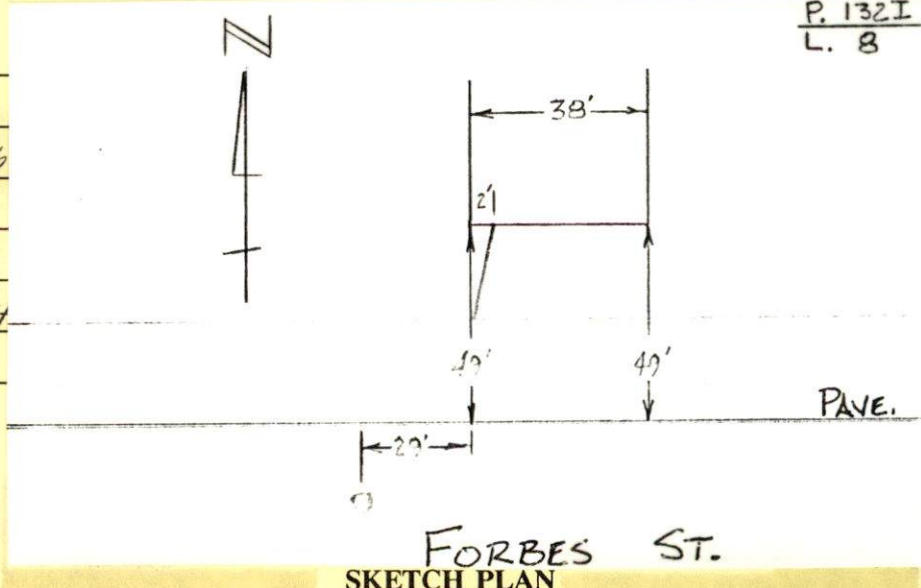



PERMIT NO.  
23066



CITY OF NEW BEDFORD

DATE 4.9.01

SEWER AND/OR STORM DRAIN PERMIT

This certifies that permission is granted to  
R. L. G. Associates, Inc. Co. 17 Gray St. N. Providence 02904  
Property Owner Address Tel. 401-641-6494

to connect a sewer and/or storm drain located at Forbes St. Ext.  
Assessor's Plot 132I, Lot 8, to the sewer and/or storm drain in Forbes St. Ext. Street  
to be laid in accordance with the conditions in this application and the City of New Bedford ordinances.

TYPE OF USE: ☐ RESIDENTIAL ☐ COMMERICAL ☐ INDUSTRIAL ☐ OTHER

If applicant other than actual property owner, attach Letter of Authorization from Property Owner.

Name Robert Giuliano Tel. 401-641-6494  
Mailing Address 17 Gray St. N. Providence RI

The Bonded Contractor/Drain Layer authorized to perform this work is:

\* R. J. Canessa 915 Hathaway Rd. NB 508-723-7508 672-7248  
Double Name T. Corp. 1449 Brayton Point Rd. Address Somerset, Ma. Tel.

Type of Pipe Required: PVC SDR-35 \* Changed by Bob Giuliano 6/22/01  
PERMIT EXPIRES ONE YEAR AFTER DATE OF ISSUE

- \* Requires separate connections for sewage and storm drain where applicable. Storm water cannot be discharged to a sanitary sewer.
- \* All work must be inspected and approved by a D.P.W. inspector before backfilling.
- \* If this connection is to be part of a private service shared jointly with other building owners, attach copy of Recorded Joint Maintenance Agreement.
- \* Permits can be issued to Industrial and/or Commercial Applicants only upon receipt and approval by the Commissioner of Public Works of required plans and supplemental information.
- \* In addition, a City-issued Industrial User Discharge Permit and/or a Sewer Extension/Connection Permit issued by the Commonwealth of Massachusetts D.E.P. shall be required by the City for Industrial Discharge into the sewer system.

Industrial User Discharge Permit No. Date

Comm. Mass. Sewer Conn./Ext. Permit No. Date

A Filing and Inspection Fee of \$150.00 plus an Entrance Fee of \$ where applicable, must accompany this application.

Bank # 57-1/115 Check # 1122 Date: 4-9-01 Receipt #

Other requirements: Fleet 3306 PD

Connection made to ☒ Sewer ☐ Storm Drain Part of jointly-shared private line ☐ Yes ☐ No

Applicant agrees to abide by the above terms, as well as all pertinent ordinances of the City of New Bedford, and such other special rules as the Commissioner of Public Works may deem necessary

Lawrence D. Worden  
Commissioner of Public Works

Signature of Property Owner or Representative

INSPECTOR'S REPORT

INSPECTED BY:

DATE:

COMMENTS:

☐ APPROVED ☐ DISAPPROVED

SIGNATURE

SKETCH PLAN